

**APPLETON STREET - DRAIN**  
SCALE: HORIZONTAL 1"=40'

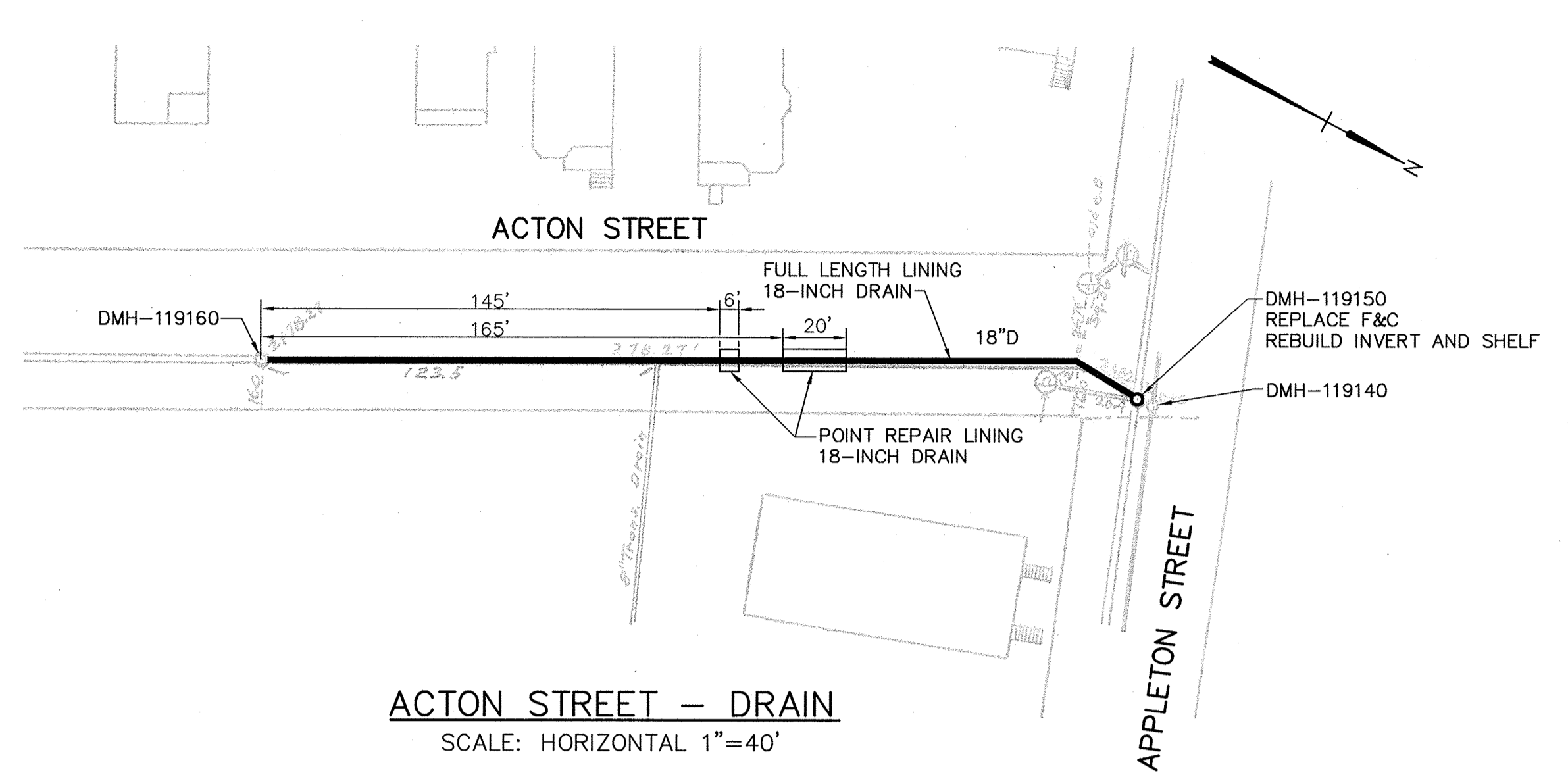

**ACTON STREET - DRAIN**  
SCALE: HORIZONTAL 1"=40'

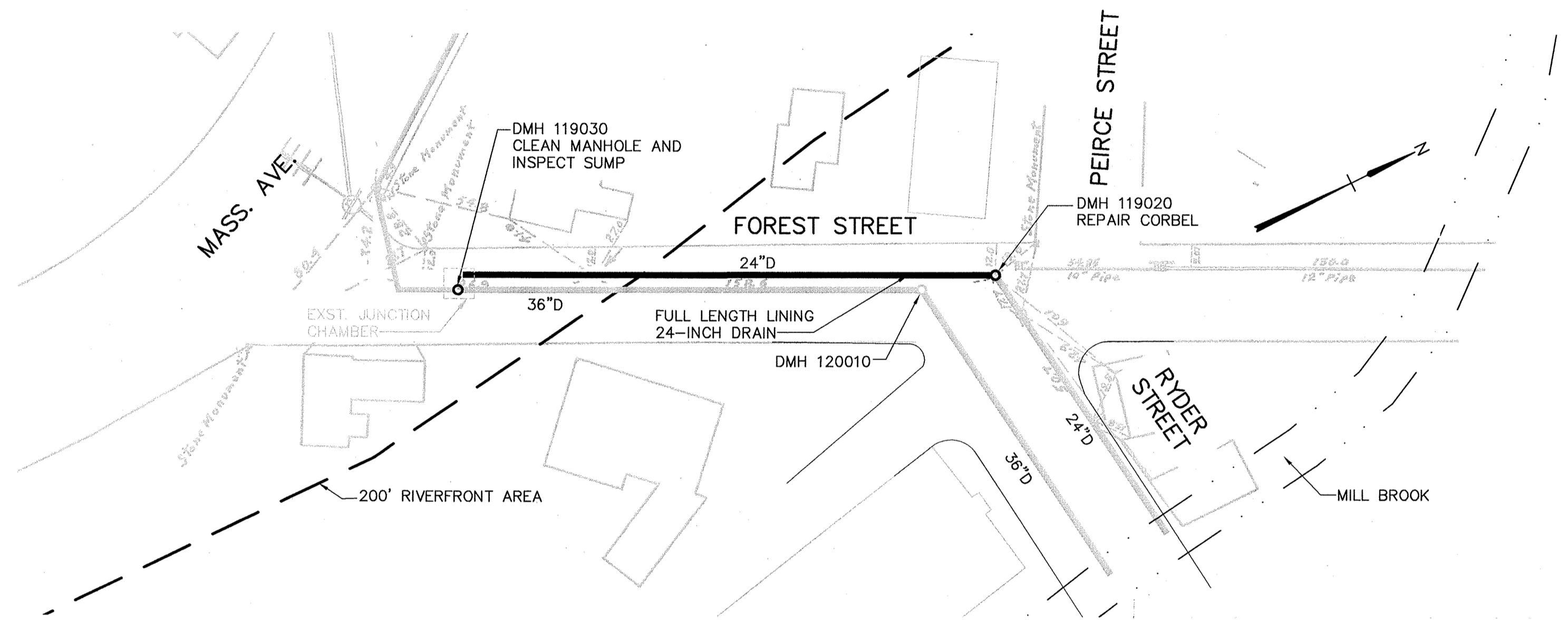

**FOREST STREET - DRAIN**  
SCALE: HORIZONTAL 1"=40'

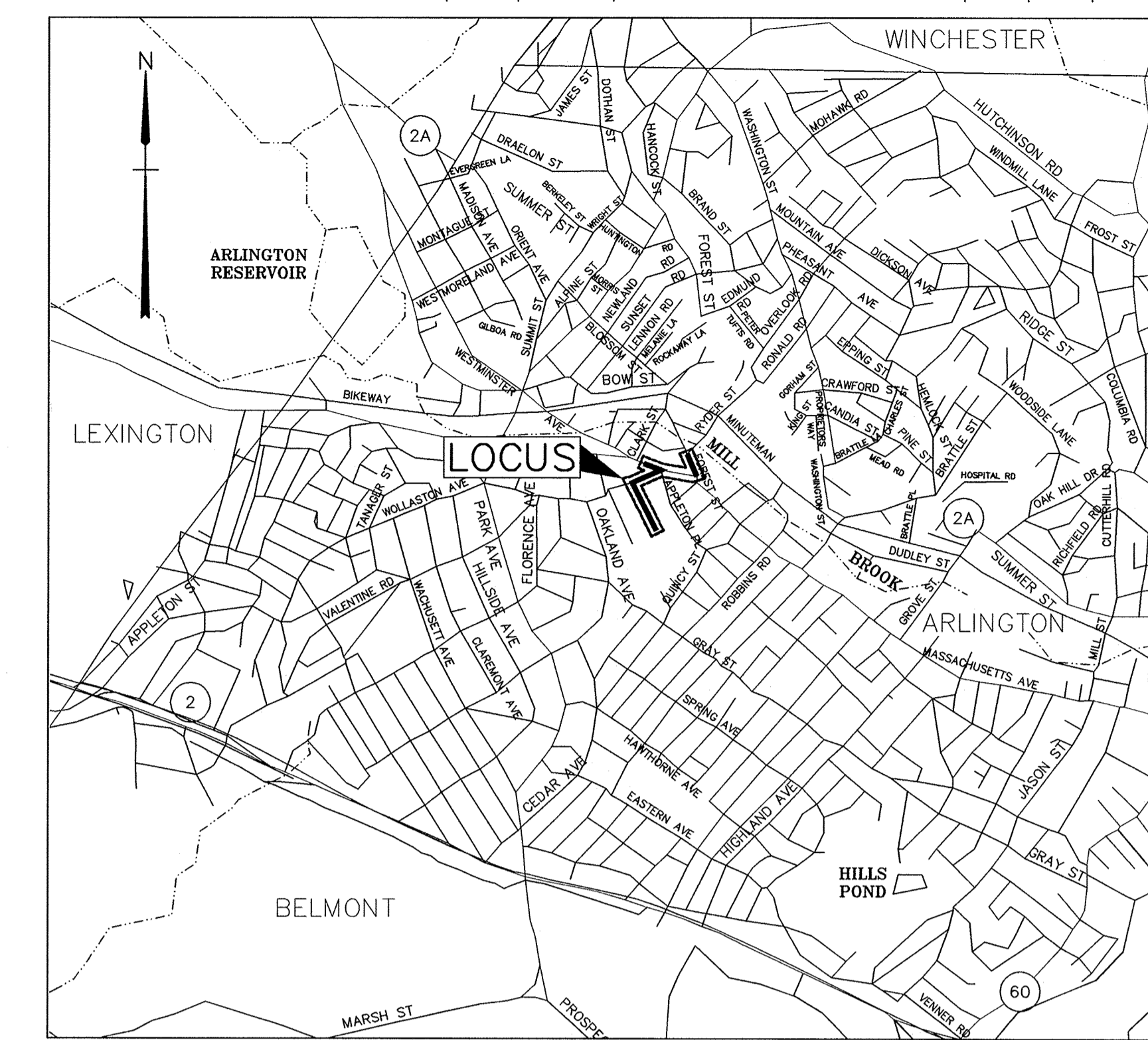

**LOCATION PLAN**  
SCALE: NOT TO SCALE

**LEGEND**

**NEW WORK**

- CIPP LINER
- PIPE REPLACEMENT
- POINT REPAIR LINING
- TEST & SEAL PIPE JOINTS

**EXISTING**

- DMH-119150 DRAIN MANHOLE & NUMBER
- SMH-20007 SEWER MANHOLE & NUMBER
- 12"D DRAIN
- 8"S SEWER
- CATCH BASIN

**ABBREVIATIONS**

- F&C MANHOLE FRAME & COVER
- PC PIPE CONNECTION
- CB CATCH BASIN
- DMH DRAIN MANHOLE
- SMH SEWER MANHOLE

**GENERAL NOTES**

- THIS PLAN HAS BEEN COMPILED FROM EXISTING PLANS AND ON-SITE OBSERVATIONS.
- PROFILES OF EXISTING GROUND SURFACES ARE BASED ON DATA OBTAINED FROM EXISTING TOWN PLANS.
- THE LOCATIONS OF EXISTING DRAINS AND SEWERS ARE APPROXIMATE ONLY. CONTRACTOR SHALL PROVIDE SUPPORT AND PROTECTION OF UTILITIES AS REQUIRED AT NO ADDITIONAL COST.
- ANY AREA DISTURBED BY THE CONTRACTOR OUTSIDE THE LIMIT OF WORK SHALL BE RESTORED TO ORIGINAL CONDITION AT NO COST TO THE OWNER.
- ALL GROUND SURFACES SHALL BE PROTECTED TO PREVENT EROSION AND SEDIMENT ON SITE.
- THE CONTRACTOR SHALL PROVIDE DUST CONTROL FOR EXCAVATION AND CONSTRUCTION OPERATIONS.
- WHERE NEW PAVEMENT MEETS EXISTING PAVEMENT, THE JOINTS SHALL BE SAWCUT TO A NEAT HORIZONTAL/VERTICAL LINE. TEMPORARY PAVEMENT SHALL BE LEFT IN PLACE FOR A MINIMUM OF 90 DAYS OR AS DIRECTED BY THE TOWN ENGINEER.
- THE LOCATIONS OF UNDERGROUND UTILITIES SHOWN ARE APPROXIMATE ONLY AND ARE BASED UPON A LIMITED FIELD SURVEY AND COMPILATION OF SURFACE EVIDENCE. THE ENGINEER DOES NOT WARRANT NOR GUARANTEE THE LOCATION OR DEPTHS OF UTILITIES DEPICTED OR NOT DEPICTED. THE CONTRACTOR, PRIOR TO COMMENCEMENT OF CONSTRUCTION, SHALL VERIFY THE LOCATION AND DEPTH OF ALL UTILITIES AND CONTACT DIG SAFE AT 1-800-344-7233 A MINIMUM OF THREE WORKING DAYS PRIOR TO ANY EXCAVATION. FOR LOCATIONS OF UTILITIES NOT ON THE DIG SAFE PROGRAM, CONTACT THE AGENCIES THREE WORKING DAYS PRIOR TO ANY EXCAVATION. THE TOWN OF ARLINGTON IS NOT A MEMBER OF DIG SAFE AND MUST BE NOTIFIED DIRECTLY AT LEAST 72 HOURS PRIOR TO ANY EXCAVATION. (ARLINGTON DPW PHONE NO. 781-316-3301).
- COORDINATE SUPPORT OF UTILITY POLES AND OVERHEAD WIRES W/TELEPHONE CO., POWER CO. AND OTHERS AS REQUIRED.
- ANNULAR SPACE AT PIPE CONNECTION TO MANHOLE SHALL BE FILLED WITH NON-SHRINK MORTAR AS SPECIFIED.
- TRENCHES SHALL BE PLATED AT THE END OF EACH WORKDAY.
- NO EQUIPMENT SHALL BE PARKED ON TOWN STREETS OVERNIGHT.
- TRENCHES SHALL BE BACKFILLED WITH SUITABLE MATERIAL AND COMPACTED IN LAYERS NOT OVER 6 INCHES DEEP USING MECHANICAL COMPACTORS OR JET-RODDING. BACKFILL MATERIAL SHALL BE COMPACTED TO 95% OF MAXIMUM DRY DENSITY AS DETERMINED BY AASHTO STANDARD TEST T99 METHOD C.
- FURNISH AND MAINTAIN TRAFFIC SAFETY AND/OR REGULATION SIGNS FOR THE DURATION OF THE WORK AT LOCATIONS DESIGNATED BY THE TOWN.
- THE CONTRACTOR SHALL MAKE HIS OWN EXAMINATION OF THE PROJECT SITE AND THE LOCATIONS OF WORK TO BE DONE UNDER THIS CONTRACT TO INFORM HIMSELF FULLY IN REGARD TO ALL CONDITIONS PERTAINING TO THE WORK AND THE PLACE WHERE IT IS TO BE DONE. BY SIGNING AND SUBMITTING HIS BID, THE CONTRACTOR CERTIFIES THAT HE HAS MADE HIS OWN EXAMINATION AND ESTIMATES OF COST FOR HIS BID FROM THAT ON-SITE EXAMINATION.
- EXISTING TRAFFIC SIGNAL BURIED CONDUIT IS NOT SHOWN AND MAY NOT BE VISUALLY DISCERNIBLE. CONTRACTOR IS TO ASSUME THAT SIGNAL CONDUIT ARE PRESENT AT ALL INTERSECTIONS WITH TRAFFIC SIGNALS. IF EXCAVATION IS REQUIRED AT THE INTERSECTION, SIGNAL CONDUIT SHALL BE PROTECTED AS PRACTICABLE. SIGNAL CONDUIT THAT NEEDS TO BE REMOVED AND REPLACED, SHALL BE DONE IN ACCORDANCE WITH OWNER'S TRAFFIC SIGNAL STANDARDS.
- PARALLEL INSTALLATION: MAINTAIN 10' MINIMUM LATERAL DISTANCE BETWEEN SEWER AND WATER LINES. THESE DISTANCES SHALL BE MEASURED EDGE TO EDGE. IN CASES WHERE IT IS NOT PRACTICAL TO MAINTAIN THESE SEPARATIONS, THE ENGINEER AND OWNER MAY ALLOW DEVIATION ON A CASE-BY-CASE BASIS.
- WATER MAIN CROSSING SEWERS SHALL BE LAID TO PROVIDE A MINIMUM VERTICAL DISTANCE OF 18" BETWEEN OUTSIDE OF THE WATER MAIN AND THE OUTSIDE OF THE SEWER. IF THE SEWER MAIN IS OVER THE WATER MAIN, THE FIRST SEWER PIPE JOINTS ON EACH SIDE OF THE WATER MAIN MUST BE CONCRETE ENCASED. SPECIAL STRUCTURAL SUPPORT FOR THE WATER AND SEWER PIPES MAY BE REQUIRED. THE WATER AND SEWER WILL BE TESTED FOR WATERTIGHTNESS BY THE CONTRACTOR.
- IF IT IS IMPOSSIBLE TO OBTAIN PROPER HORIZONTAL (10 FEET) AND VERTICAL SEPARATION AS DESCRIBED ABOVE, BOTH WATER MAIN AND SEWER MUST BE CONSTRUCTED OF PRESSURE TYPE PIPE AND BOTH BE PRESSURE TESTED TO 200 PSI TO ASSURE WATER TIGHTNESS BEFORE BACKFILLING.

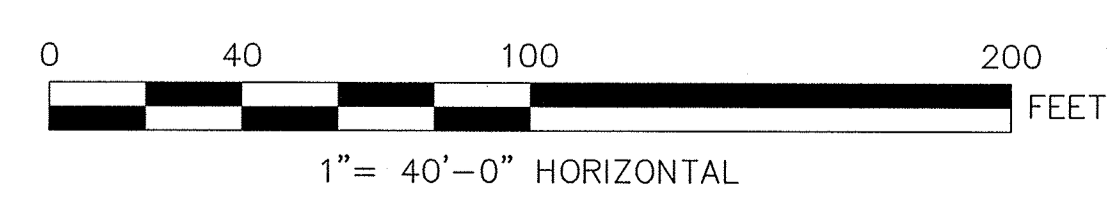
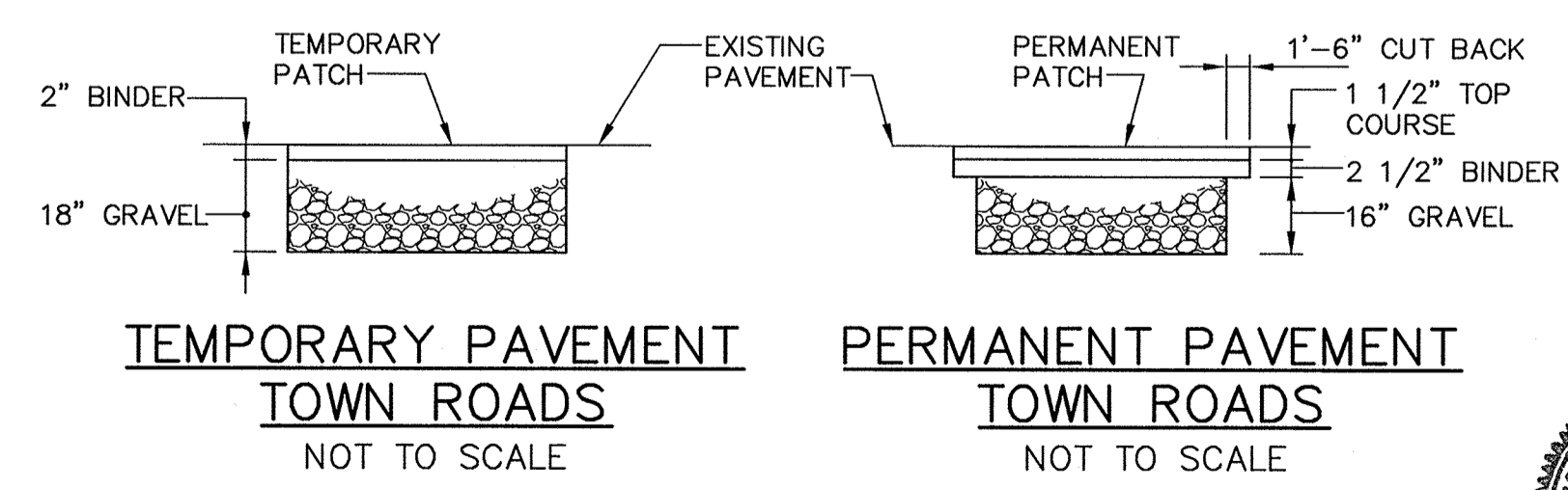

FS&T PROJECT NUMBER <b>JA-088</b>	SCALE: AS NOTED	DES. RHL	CHK. RHL	APPROVED	DRAWING NO. <b>C-1</b>
	DATE: JULY 2013	DR. JLD	PROJ. ENGR.		

**BID NO. 13-19**

**TOWN OF ARLINGTON, MASSACHUSETTS**  
DEPARTMENT OF PUBLIC WORKS

**SEWER AND DRAIN IMPROVEMENTS**  
**OTTOSON MIDDLE SCHOOL AREA**

LOCATION PLAN,  
LEGEND, GENERAL NOTES  
STORM DRAIN REHABILITATION

**FST**  
ENGINEERS  
FAY, SPOFFORD & THORNDIKE  
ENGINEERS · PLANNERS · SCIENTISTS  
BURLINGTON, MA

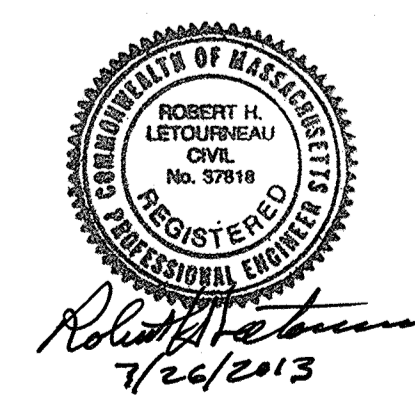



REV.	DATE	DESCRIPTION	BY	CHK.	APPD.

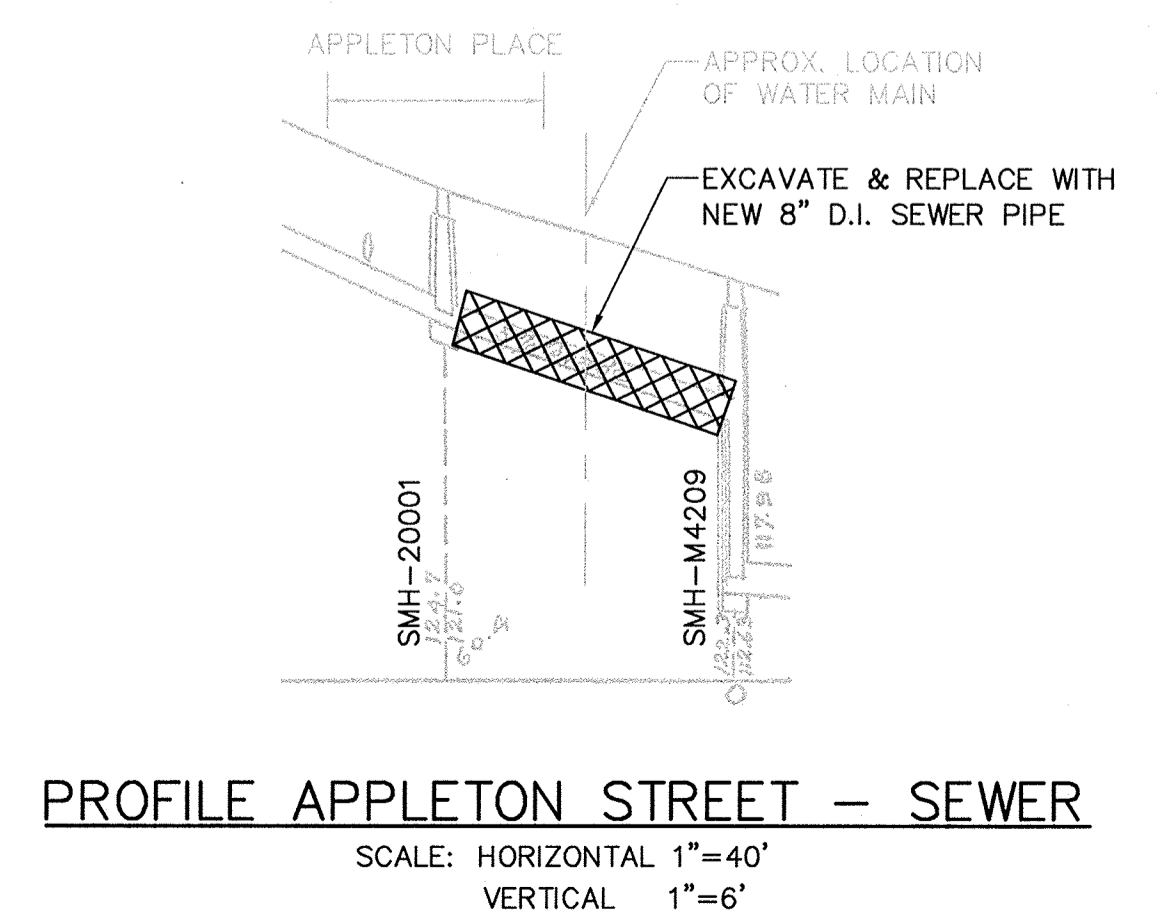
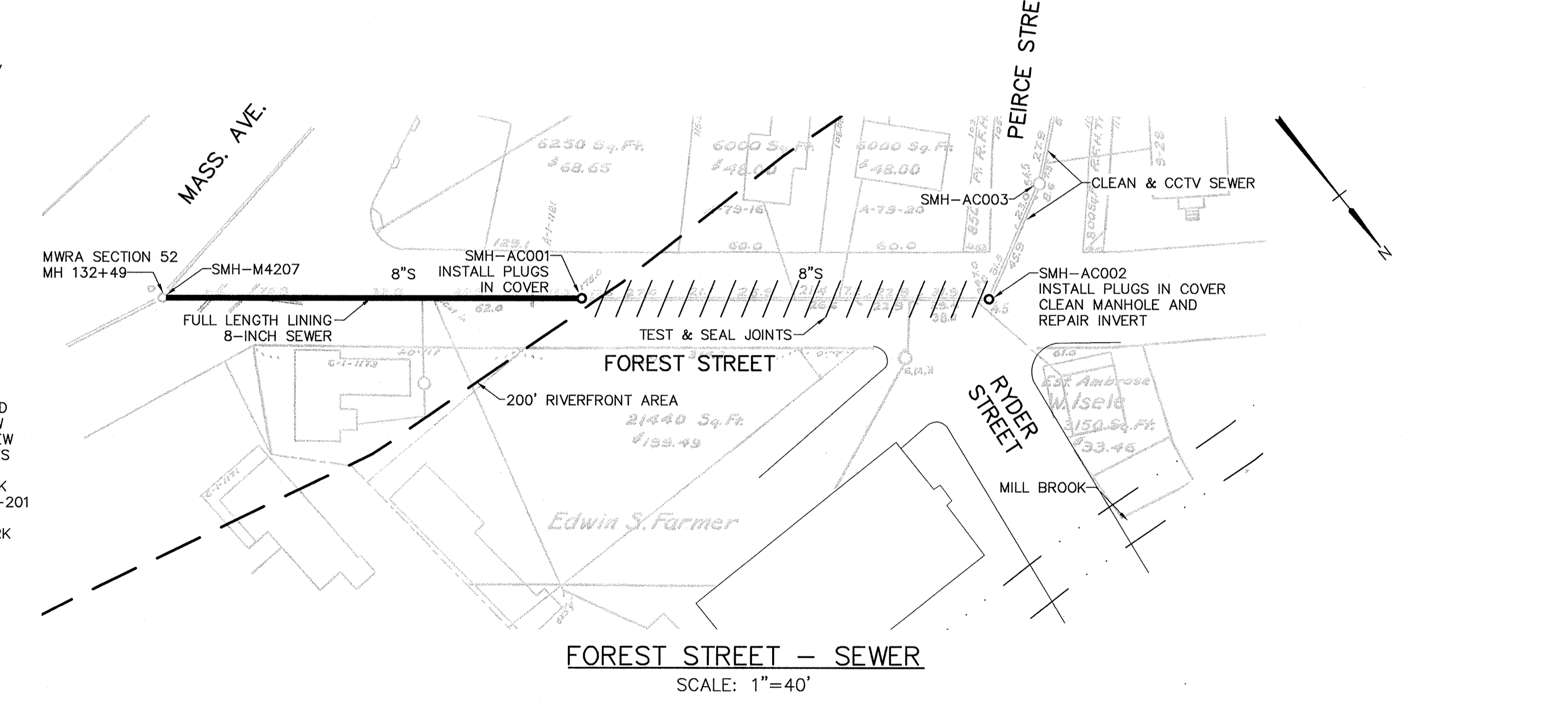
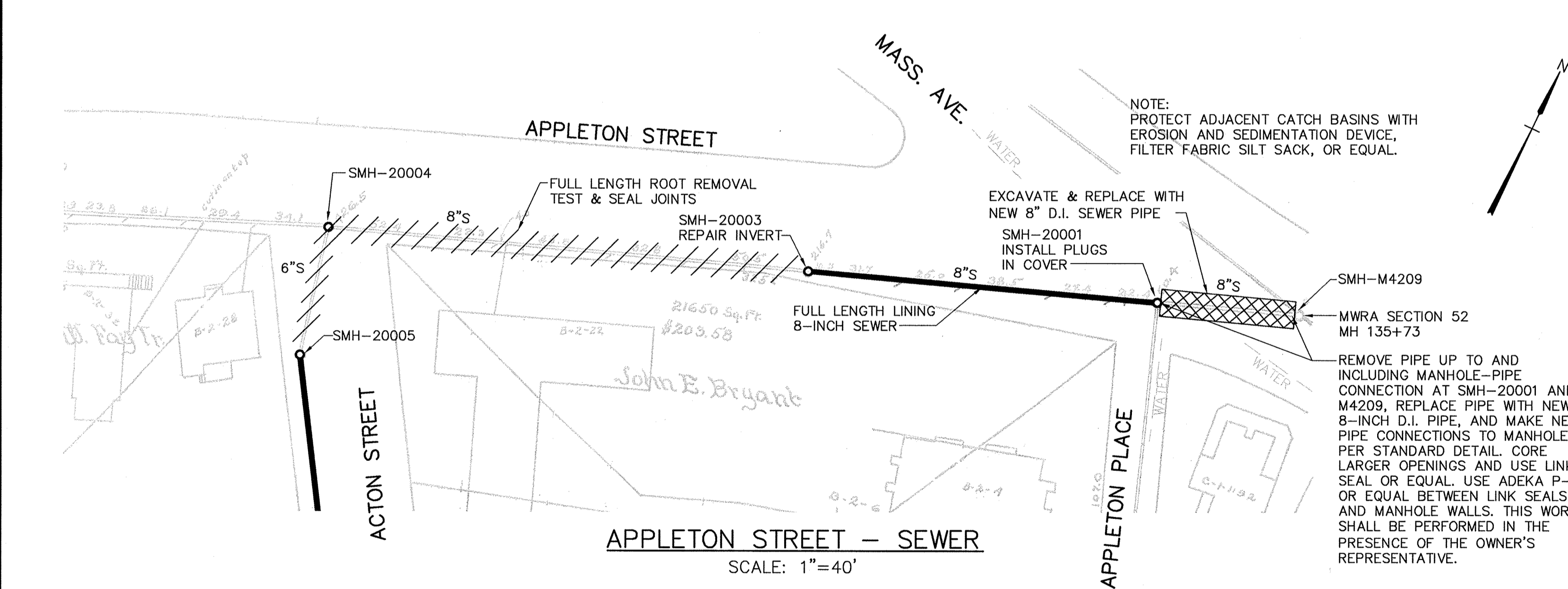
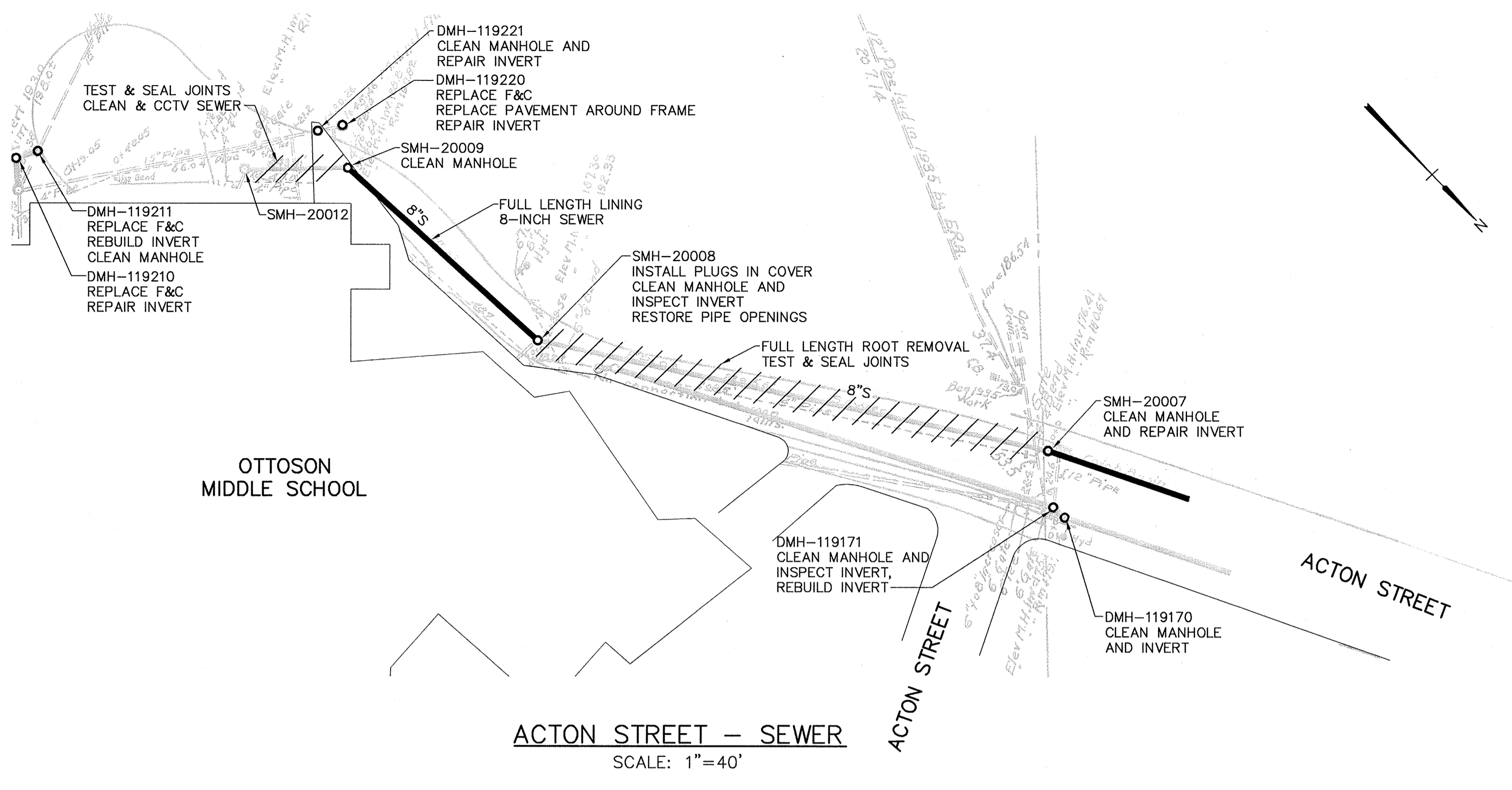
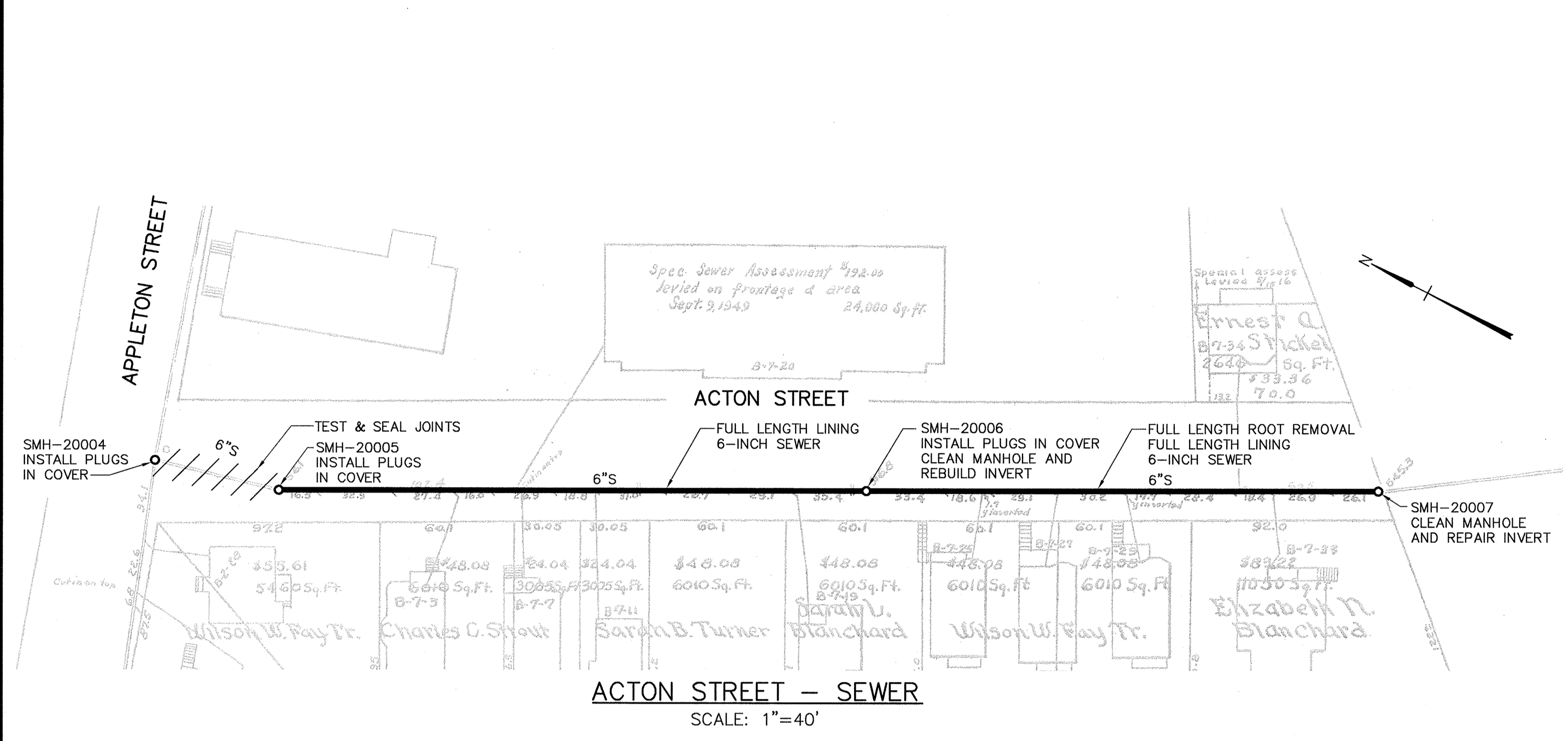

**BID NO. 13-19**  
**TOWN OF ARLINGTON, MASSACHUSETTS**  
 DEPARTMENT OF PUBLIC WORKS  
**SEWER AND DRAIN IMPROVEMENTS**  
**OTTESON MIDDLE SCHOOL AREA**  
 ACTON STREET, APPLETON STREET,  
 AND FOREST STREET  
 SEWER AND STORM DRAIN REHABILITATION

**FST** ENGINEERS  
 FAY, SPOFFORD & THORNDIKE  
 ENGINEERS · PLANNERS · SCIENTISTS  
 BURLINGTON, MA

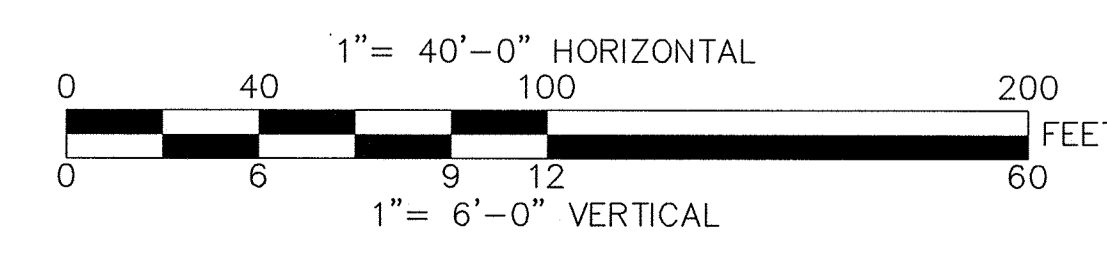
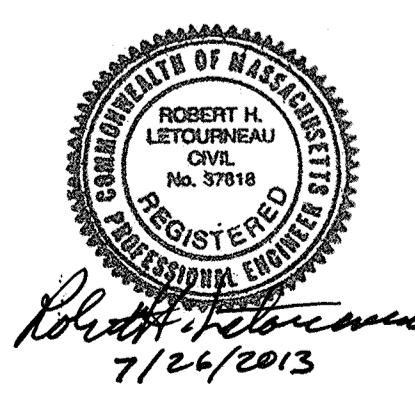

FS&T PROJECT NUMBER <b>JA-088</b>	SCALE: AS NOTED	DES. RHL	CHK. RHL	APPROVED	DRAWING NO. <b>C-2</b>
DATE: JULY 2013	DR. JLD	PROJ. ENGR. <i>RHL</i>			

S:\JA-088 Ottoson School Sewer-Drain Rehab\CADD\Civil\JA-088-C-2-SSWR-PLAN.dwg 7/26/2013 1:06:38 PM