

# **Cambridge/Arlington Intersection Reconstruction**

## **Public Information Meeting June 16, 2015**

# Project Location

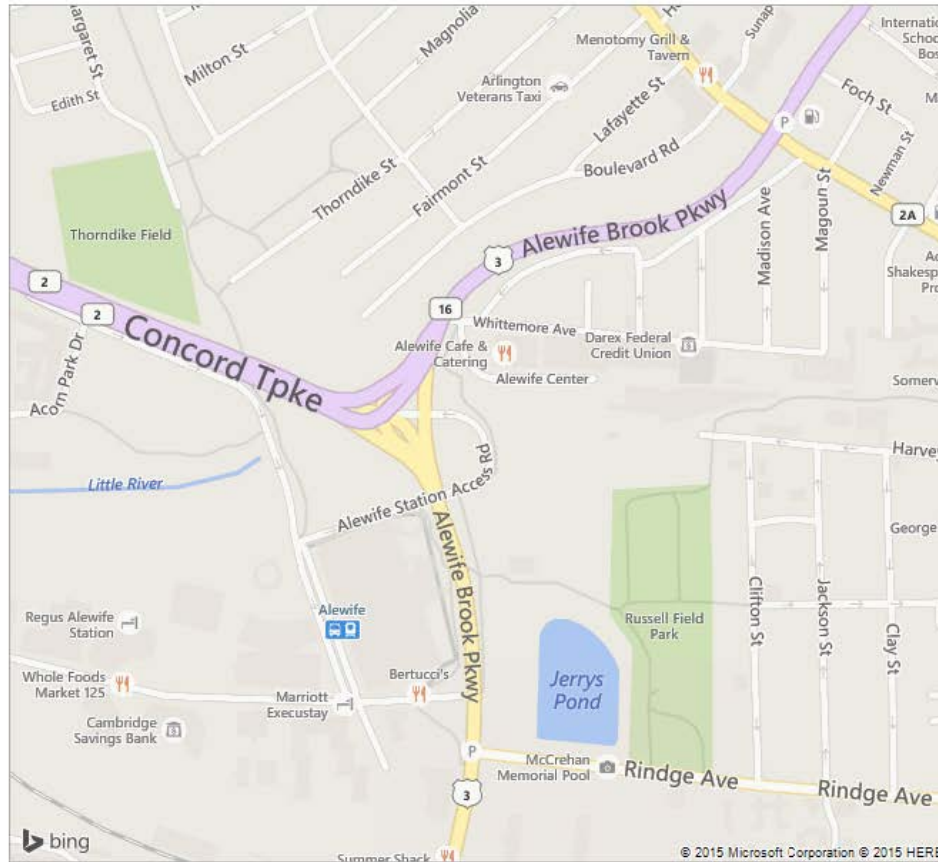

# Background

- Transportation Planning Staff (CTPS) completed a study in July 2007
- A working group was formed to expand the previous study. The Alewife Working Group met four times in 2008
- Second study completed in April 2009 which provided 8 recommendations for improvements
- 25% Design Hearing in March 2011 by MassDOT

# Proposed Improvements

The purpose of this project is to perform minor widening, eliminate a merge condition on Route 2 westbound, and to improve through capacity and vehicle queue storage at the intersection.

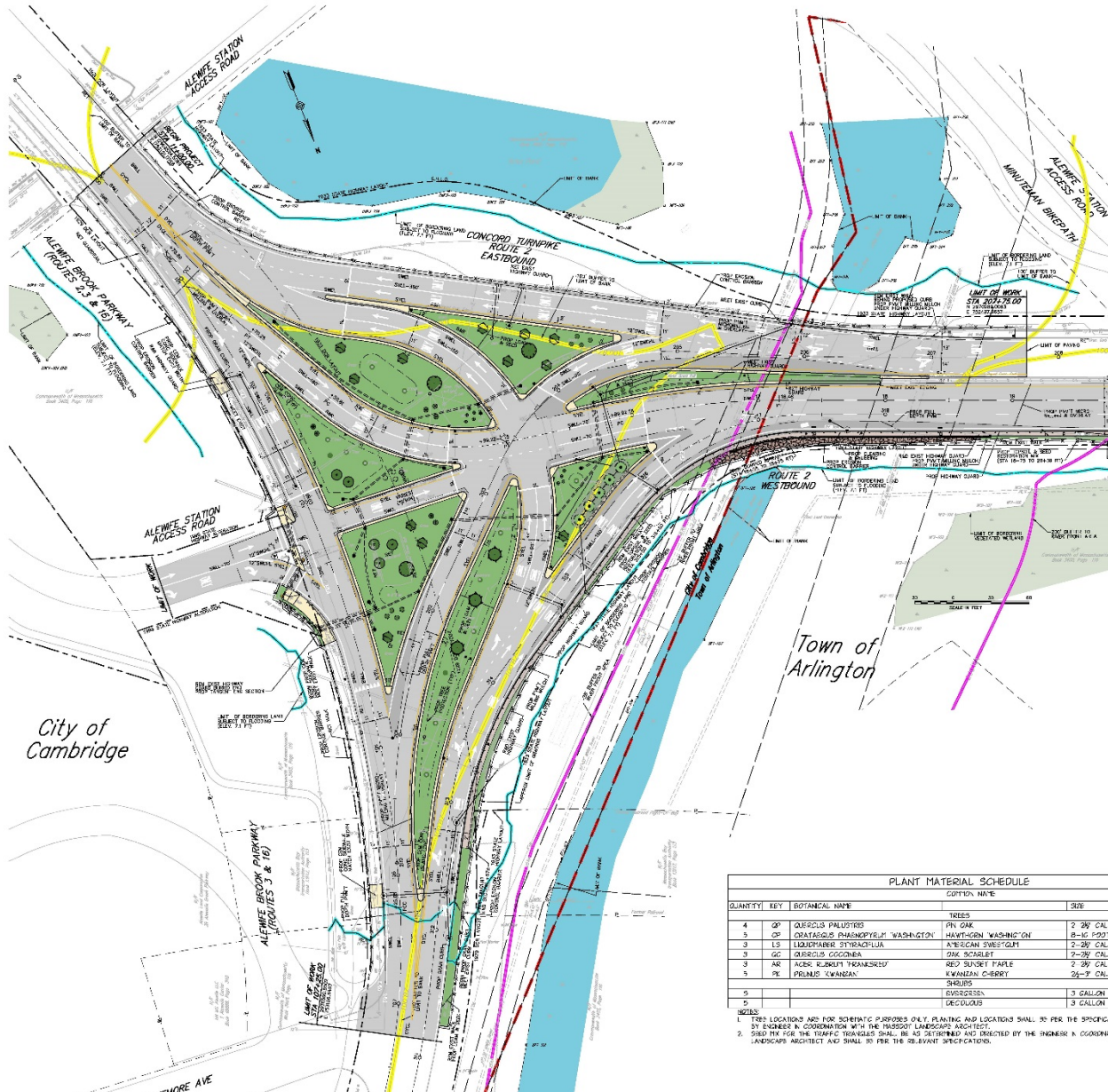

Town of  
Arlington

City of  
Cambridge

PLANT MATERIAL SCHEDULE

QUANTITY	KEY	BOTANICAL NAME	COMMON NAME	DATE
TREES				
4	QP	QUERCUS PALUSTRIS	PN OAK	2-26' CAL.
5	QP	QUERCUS PHAEOPHYLLA WASHINGTON	HAWTHORN WASHINGTON	8-16' 220' CLUMP
3	LS	LINDERA STRYCHNOLIA	AMERICAN SWEETGUM	2-26' CAL.
3	QC	QUERCUS COCCINEA	OAK SCARLET	2-26' CAL.
3	AR	ACER RUBRUM 'FRANKSRED'	RED SUNSET MAPLE	2-26' CAL.
5	PC	PRUNUS CANADENSIS	BURNING BERRY	26-32' CAL.
SHRUBS				
5			EVERGREEN	3' GALLON
5			DECIDUOUS	3' GALLON

NOTES:  
 1. TREE LOCATIONS AND FOR SCHEMATIC PURPOSES ONLY. PLANTING AND LOCATIONS SHALL BE PER THE SPECIFICATIONS AND AS DIRECTED BY ENGINEER IN COORDINATION WITH THE PROJECT LANDSCAPE ARCHITECT.  
 2. SIZED PER FOR THE TRAFFIC TRIANGLES SHALL BE AS DETERMINED AND DIRECTED BY THE ENGINEER IN COORDINATION WITH THE PROJECT LANDSCAPE ARCHITECT AND SHALL BE PER THE RELEVANT SPECIFICATIONS.

# Proposed Improvements

- \* Widen the departure of Route 2 westbound to provide three travel lanes.
- \* Widen the existing left turn lane on Route 2 eastbound to Alewife Brook Parkway (Route 16) northbound approach to formalize a 2-lane approach to prevent the queue of the left turns from blocking the lanes continuing through on Route 2 eastbound. The single wide acceptance lane will also be widened to accommodate 2-lanes to Alewife Brook Parkway northbound.



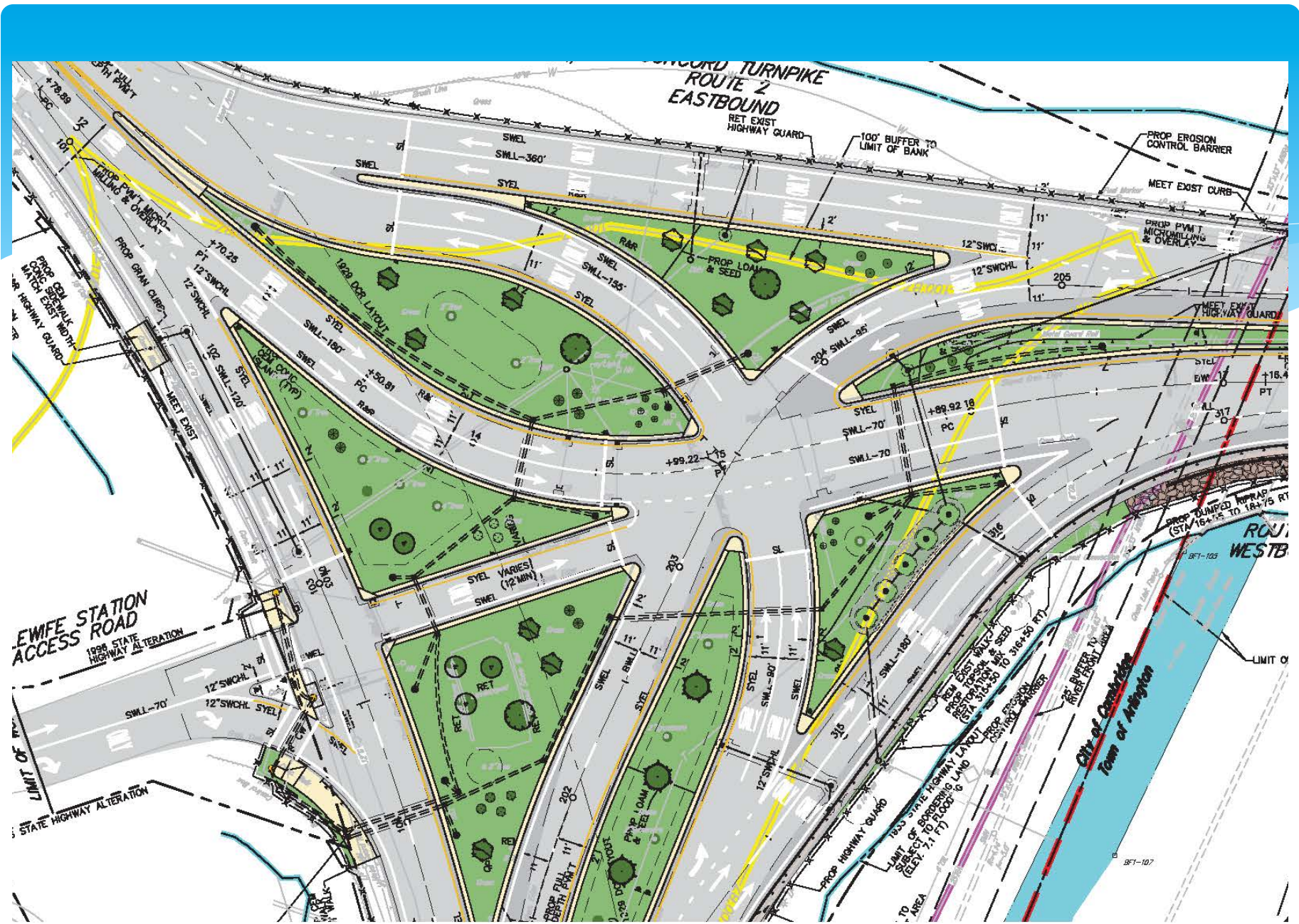

# Proposed Improvements

- \* Widen the right turn lane from Alewife Brook Parkway southbound to Route 2 westbound to provide double right turn lanes.
- \* Slight sliver widening to existing roadways to provide 2-11 foot lanes with 2 foot shoulders.
- \* Improve LOS
- \* Reconstruct wheelchair ramps



# Coordination

- \* Construction permit from DCR
- \* Order of Condition from Cambridge & Arlington Conservation
- \* Coordination with MBTA (Alewife Station)

# Pedestrian Detour

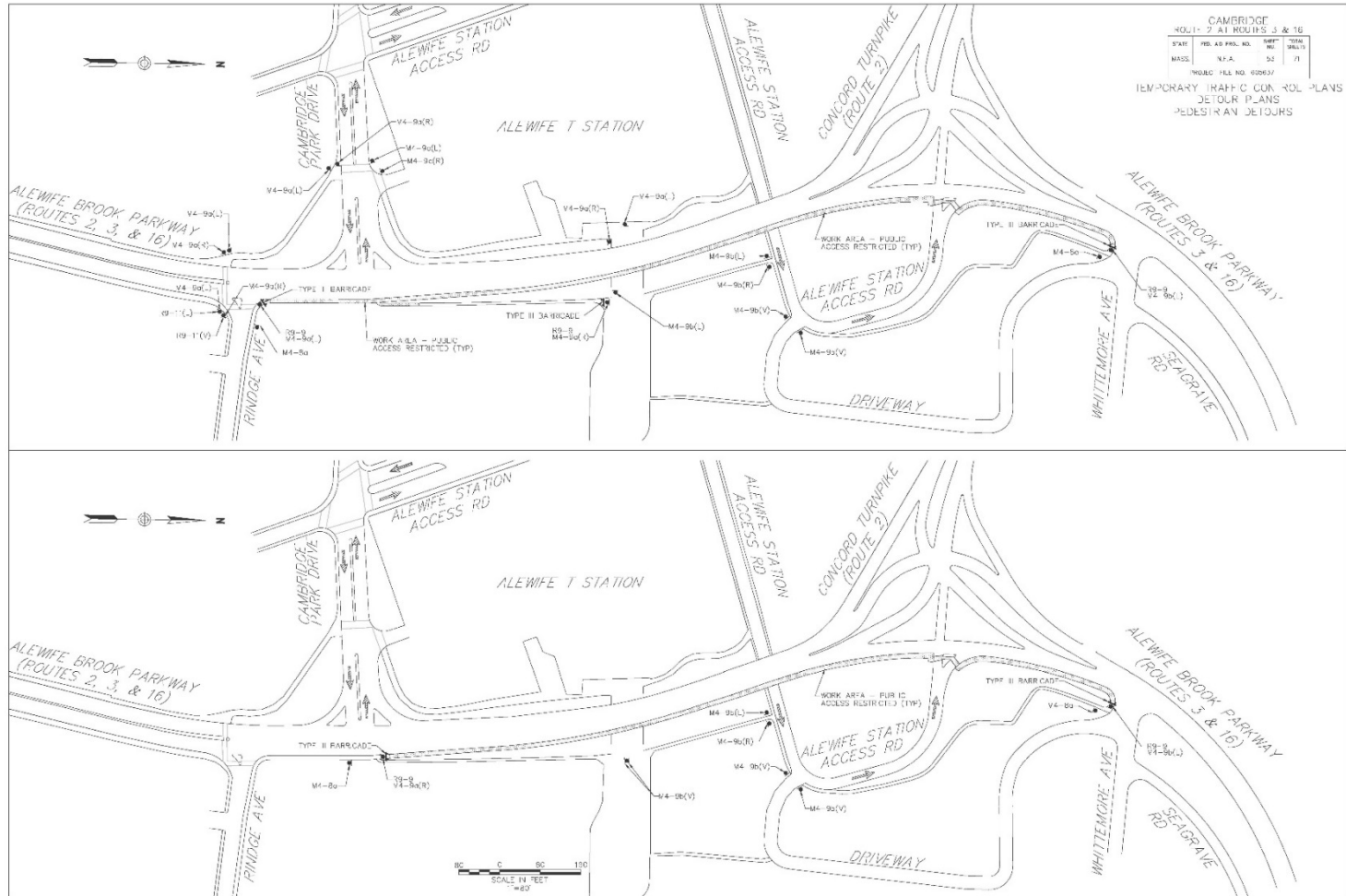

# Route 2 Westbound Detour

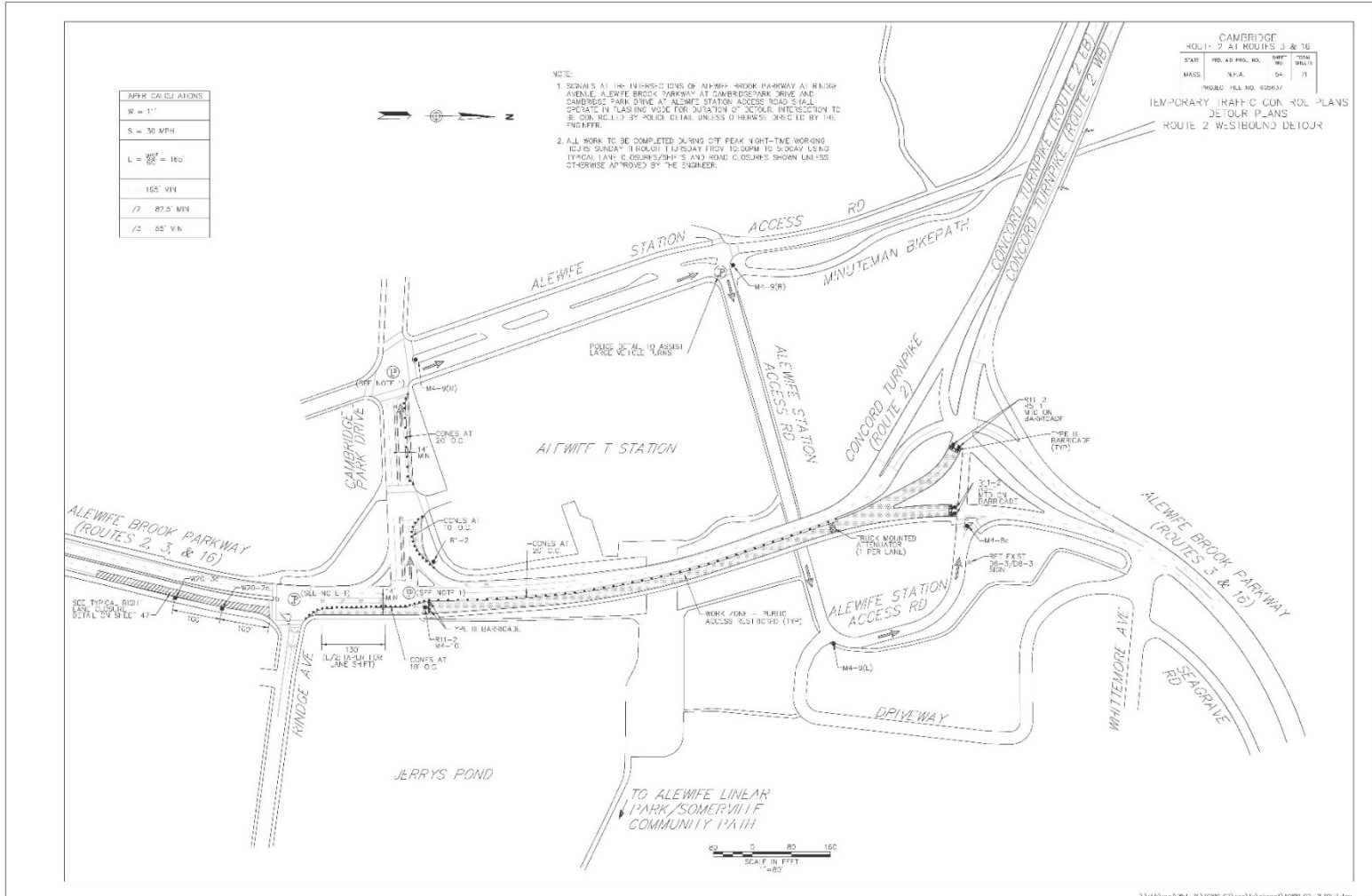

# Route 2 Eastbound Detour

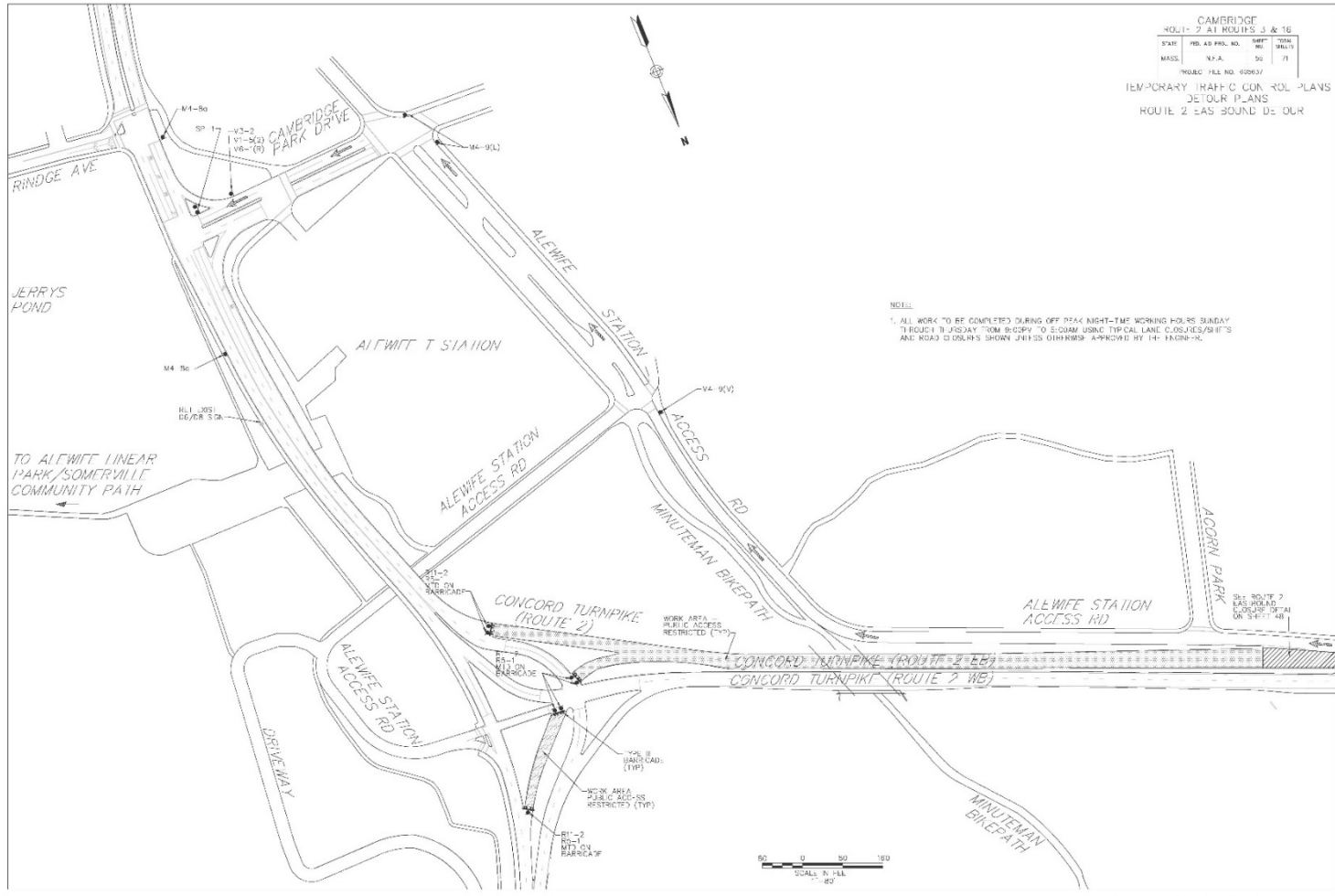

CAMBRIDGE  
ROUTE 2 AT ROUTES 3 & 16

STATE	FED. AID PROJ. NO.	SHEET NO.	TOTAL SHEETS
MASS.	N.F.A.	56	71

PROJECT FILE NO. 020637

TEMPORARY TRAFFIC CONTROL PLANS  
DETOUR PLANS  
ROUTE 2 EASTBOUND DETOUR

NOTE:  
1. ALL WORK TO BE COMPLETED DURING OFF PEAK NIGHT-TIME WORKING HOURS SUNDAY THROUGH THURSDAY FROM 9:00PM TO 5:00AM USING TYPICAL LANE CLOSURE SHIFTS AND ROAD CLOSURES SHOWN UNLESS OTHERWISE APPROVED BY THE ENGINEER.



# Work Hours & Construction Duration

- \* MassDOT - Managing reconstruction by Newport Construction
- \* Construction started April 21, 2015
- \* Sunday thru Thursday 7:00PM to 5:00AM
- \* No work shall be done affecting public way on Route 2 Westbound between Cambridge Park Drive and Lake St between 7:00PM and 10:00PM
- \* Completion: Spring 2016