

LAYOUT AND MATERIALS NOTES

1. Contractor shall lay out paths, walls and site improvements for review by the Landscape Architect prior to proceeding with the work. Make adjustments to layout as directed. Provide proposed grades at all corners and site features as directed.
2. All lines are parallel or perpendicular to lines from which they are measured, unless otherwise noted. Dimensions are to face of wall, to face of curb, to edge of pavement; to edge of improvement or as otherwise noted.

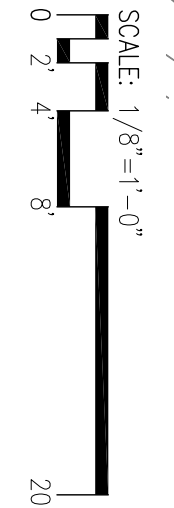
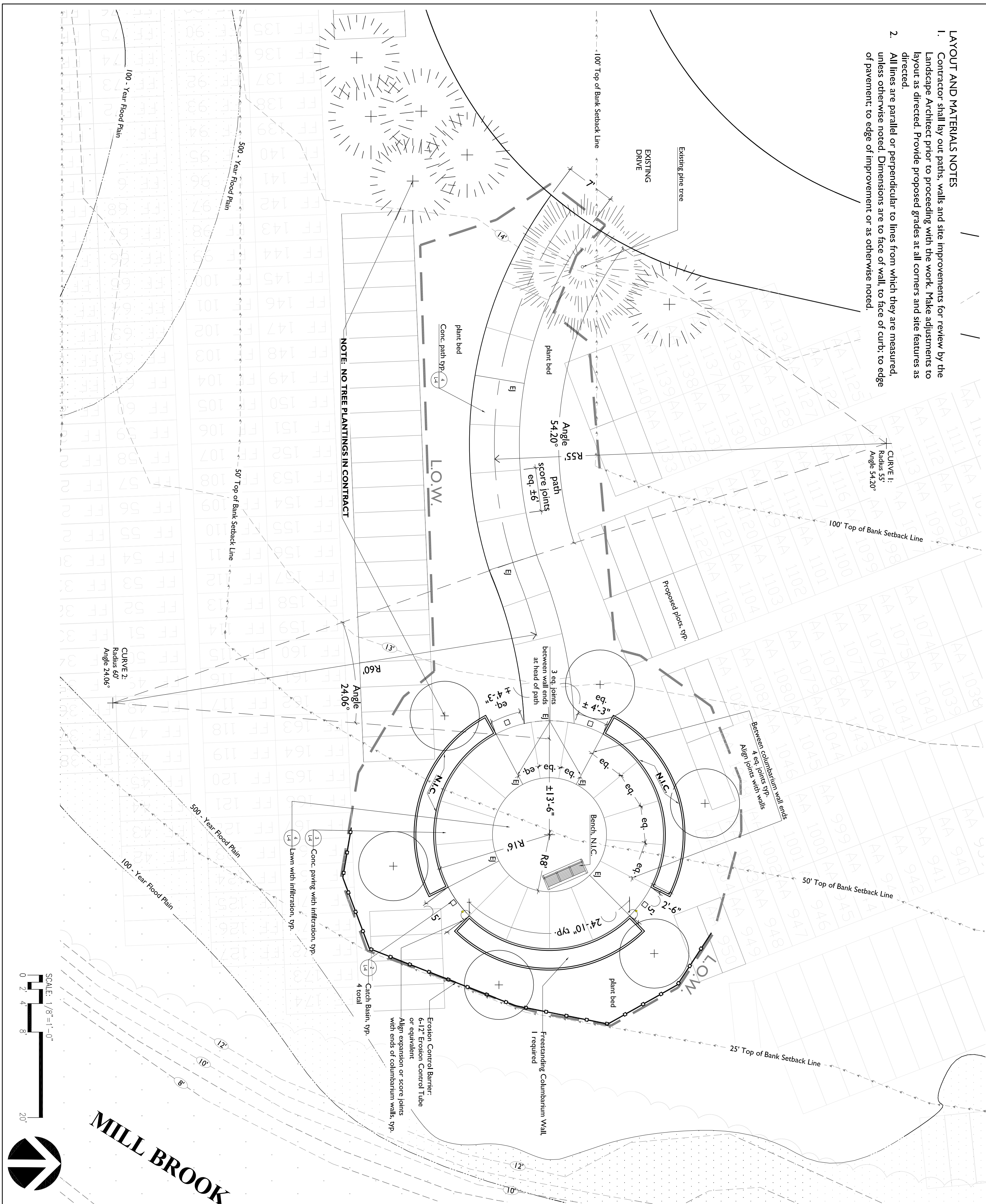

MILL BROOK

<p>Blair Hines Design Associates LANDSCAPE ARCHITECTS</p> <p>318 Harvard Street, Suite 25, Brookline, MA 02146 tel: 617.251.1181 fax: 617.268.5025 www.blairhinesdesignassociates.com</p>		<p>MT. PLEASANT CEMETERY ARLINGTON, MA</p> <hr/> <p>LAYOUT PLAN</p>	<p>Project #: 1315 Date: 2015.07.10 Drawn by: KL Reviewed: BH Scale: as noted</p> <p>Revisions:</p> <table border="1"> <tr><td> </td><td> </td></tr> <tr><td> </td><td> </td></tr> <tr><td> </td><td> </td></tr> <tr><td> </td><td> </td></tr> <tr><td> </td><td> </td></tr> <tr><td> </td><td> </td></tr> <tr><td> </td><td> </td></tr> <tr><td> </td><td> </td></tr> <tr><td> </td><td> </td></tr> <tr><td> </td><td> </td></tr> </table>																					<p>SCALE: 1/8"=1'-0"</p> <p>0 2 4 8 20'</p> <p>© Blair Hines Design Associates, LLC</p>

- GRADING NOTES**
1. The Contractor shall verify all existing conditions and grades in the field. Report discrepancies immediately to Landscape Architect for decision prior to construction.
 2. The Contractor shall fully coordinate grading with drainage.
 3. The Contractor shall layout and determine the elevations of all site elements and proposed drains for approval by Landscape Architect prior to the start of construction.
 4. Contractor shall blend grades to provide a smooth transition between new and existing work.
 5. Grade surfaces to assure positive drainage away from the columbarium; slope pavement ready to drain inlets.
 6. Pitch evenly between spot grades. All paved areas must pitch to drain at a minimum 1/8" per foot. Any discrepancies not allowing this to occur shall be reported to the Landscape Architect.

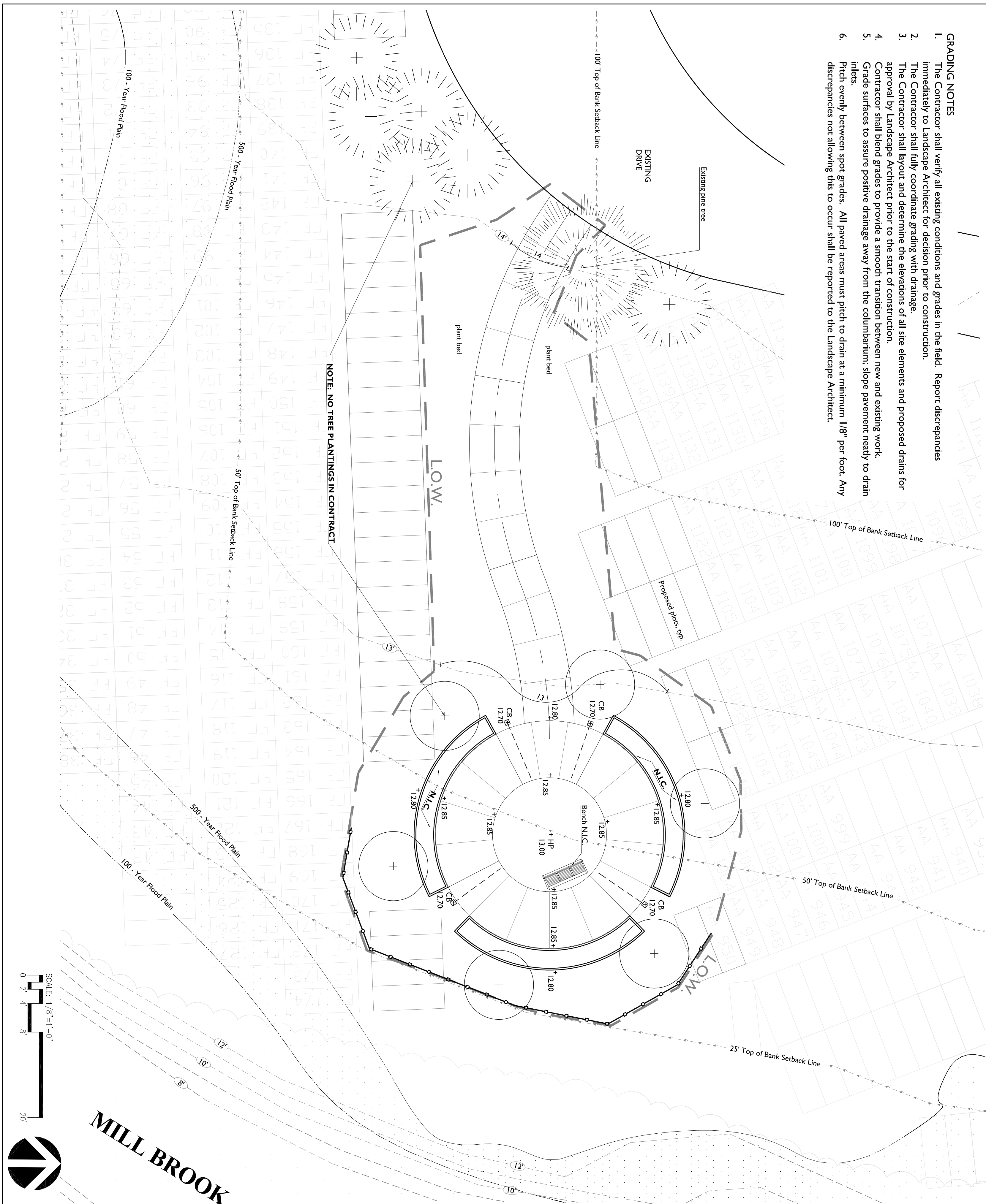

NOTE: NO TREE PLANTINGS IN CONTRACT

MILL BROOK

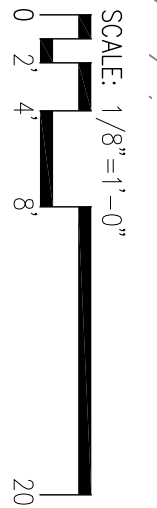

<p>Blair Hines Design Associates LANDSCAPE ARCHITECTS 318 Harvard Street, Suite 25, Brookline, MA 02146 Tel: 617.251.1188 Fax: 617.268.5025 www.blairhinesdesignassociates.com</p>		<p>MT. PLEASANT CEMETERY ARLINGTON, MA</p> <p>GRADING PLAN</p>	<p>Project #: 1315 Date: 2015.07.10 Drawn by: KL Reviewed: BH Scale: as noted</p> <p>Revisions:</p> <table border="1"> <tr><td> </td><td> </td></tr> <tr><td> </td><td> </td></tr> <tr><td> </td><td> </td></tr> <tr><td> </td><td> </td></tr> <tr><td> </td><td> </td></tr> </table>											<p>L-2</p> <p>© Blair Hines Design Associates, LLC</p>

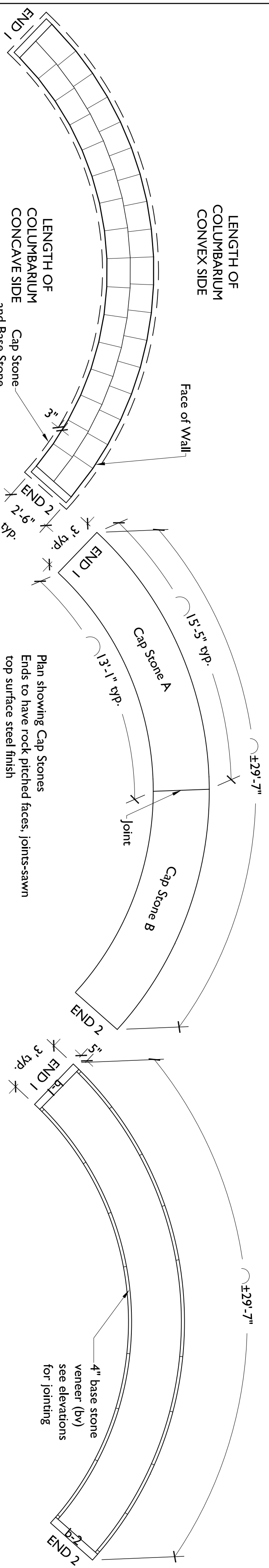

1 CURVED COLUMBARIUM PLAN - Overall
scale: $\frac{1}{4}'' = 1'-0''$

2 CURVED COLUMBARIUM PLAN - Cap Stones (2 total)
scale: $\frac{1}{4}'' = 1'-0''$

3 CURVED COLUMBARIUM PLAN - Showing Base Stones
scale: $\frac{1}{4}'' = 1'-0''$

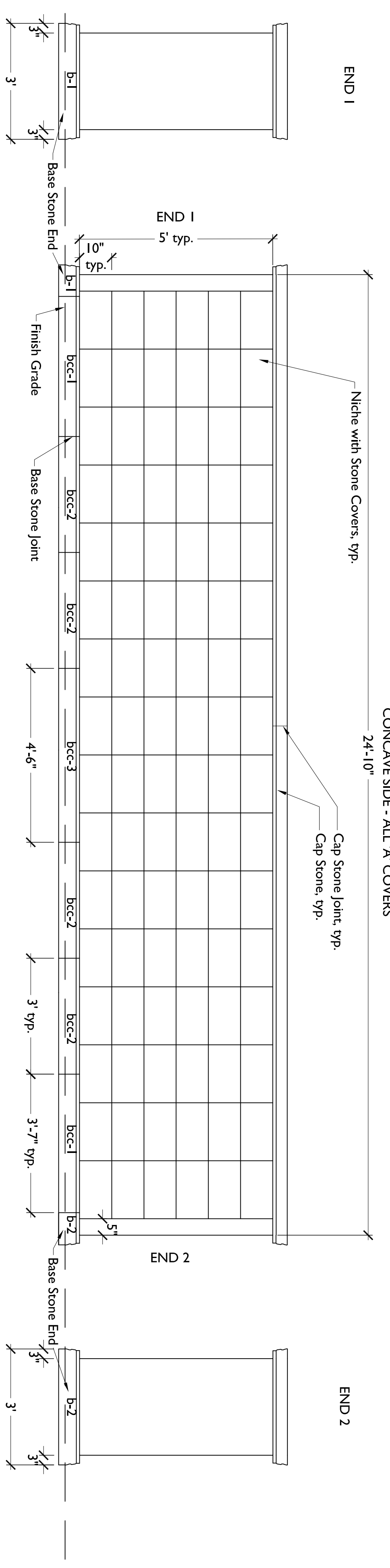

4 CONCAVE SIDE - 6 ROWS TALL - 24'-10" long - 96 niches
scale: $\frac{1}{2}'' = 1'-0''$

NOTES:
1. Provide complete shop drawings for all stone prior to manufacture.

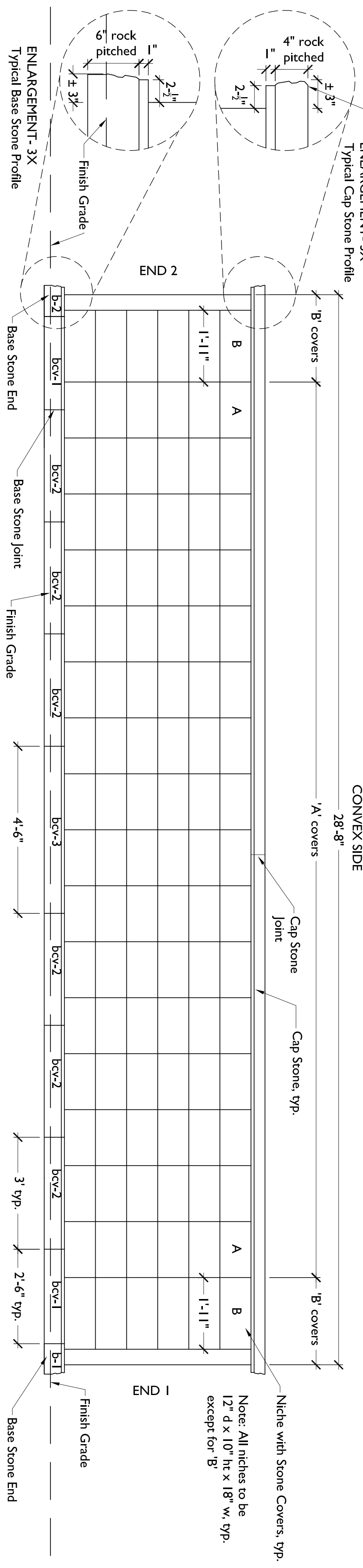

5 CONVEX SIDE - 6 ROWS TALL - 28'-8" long - 108 niches
scale: $\frac{1}{2}'' = 1'-0''$



Revisions:

note: provide geo-tech test of the bearing capacity of the subgrade soil. expense will be reimbursed at cost by the Town of Arlington

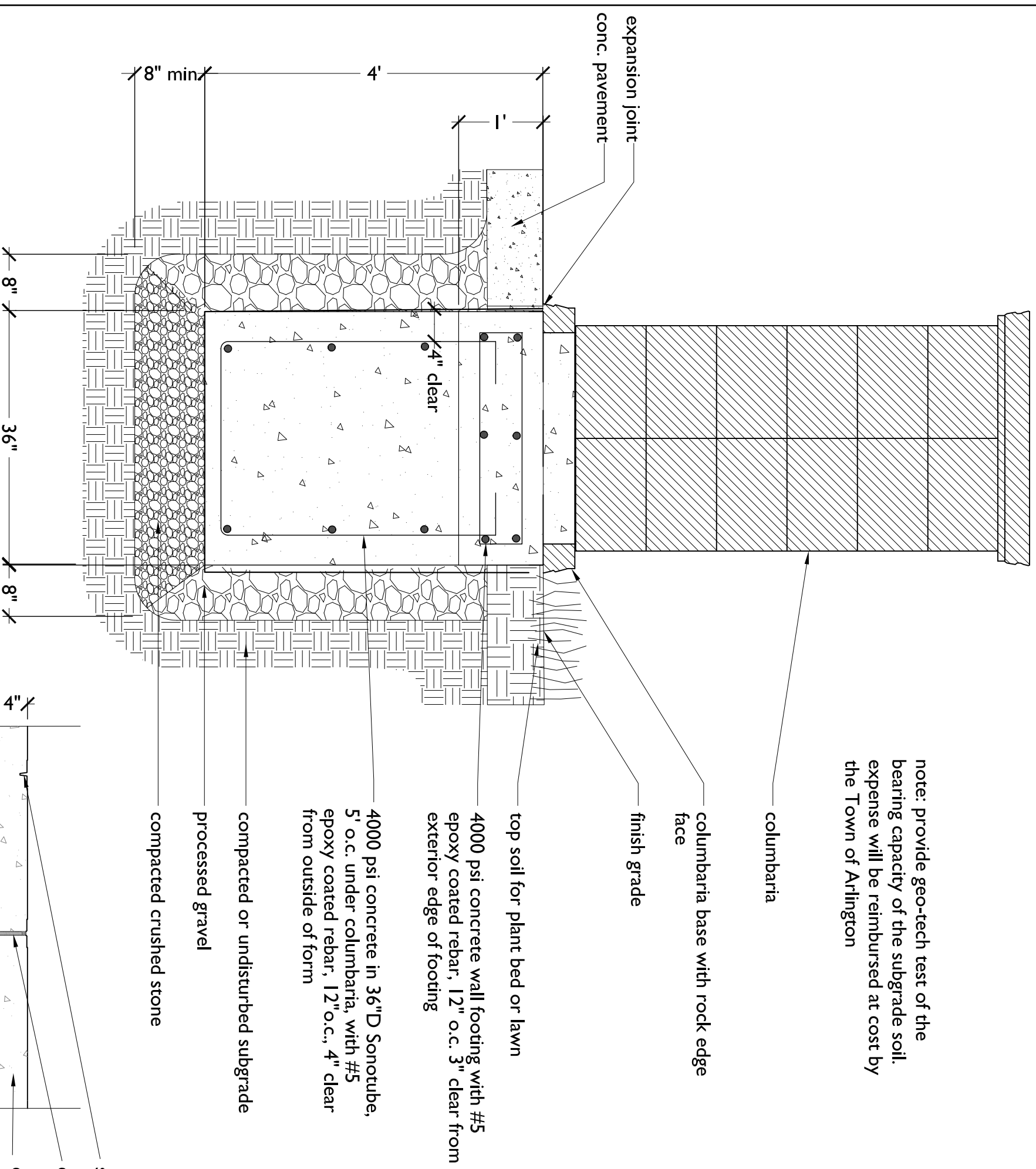

1 COLUMBARIUM FOUNDATION SECTION
scale: 3/4" = 1'-0"

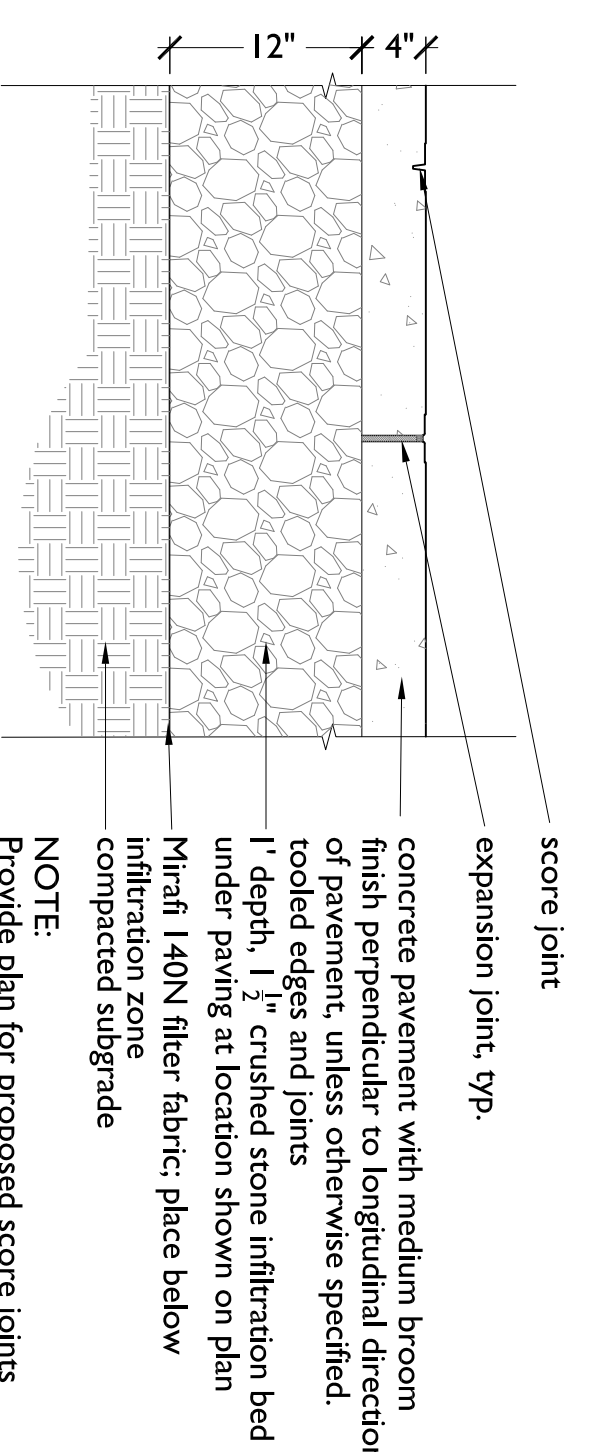

3 CONCRETE PAVING WITH INFILTRATION - SECTION
scale: 1" = 1'-0"

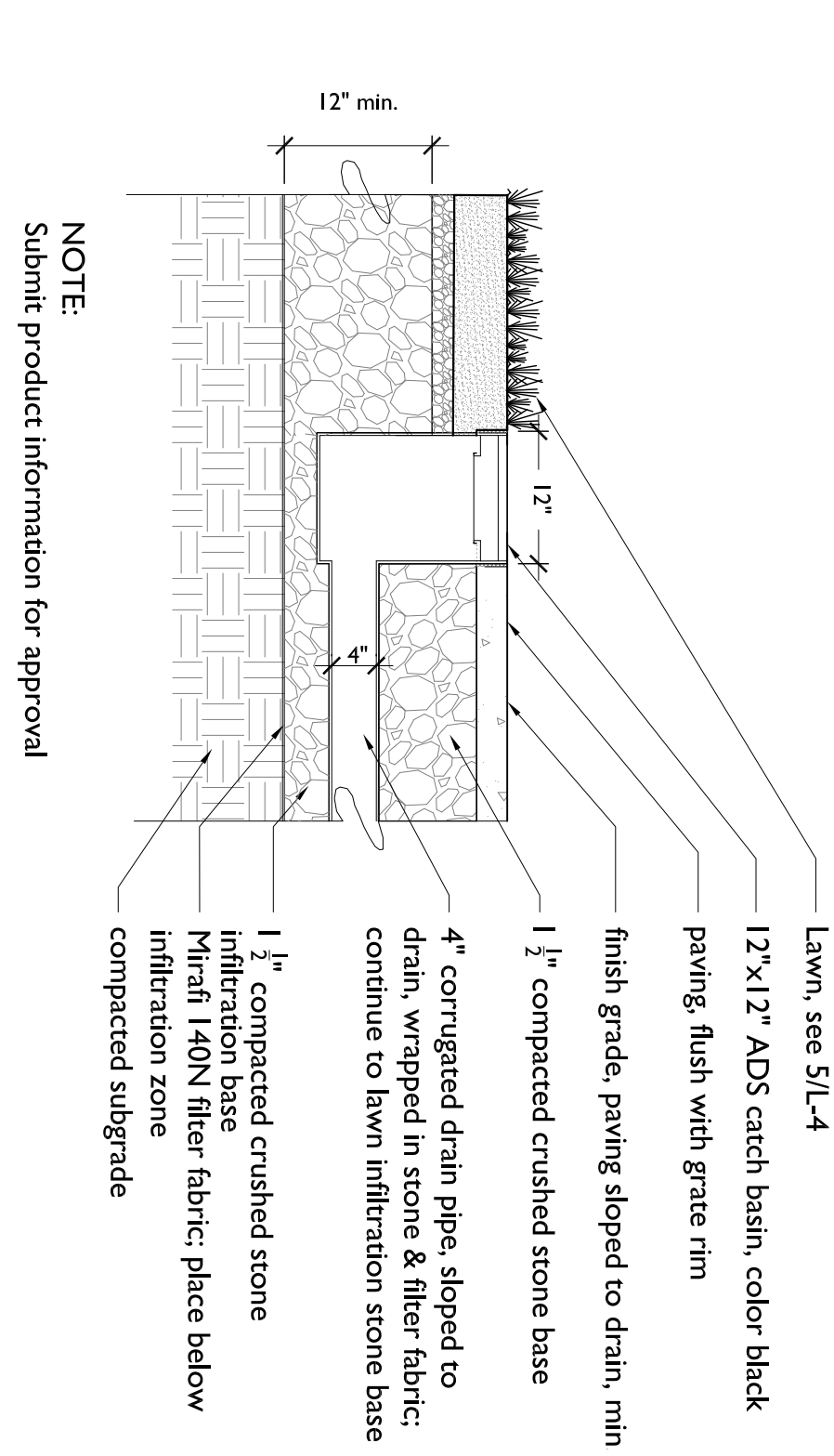

2 12" ADS CATCH BASIN SECTION - (4 total)
scale: NTS

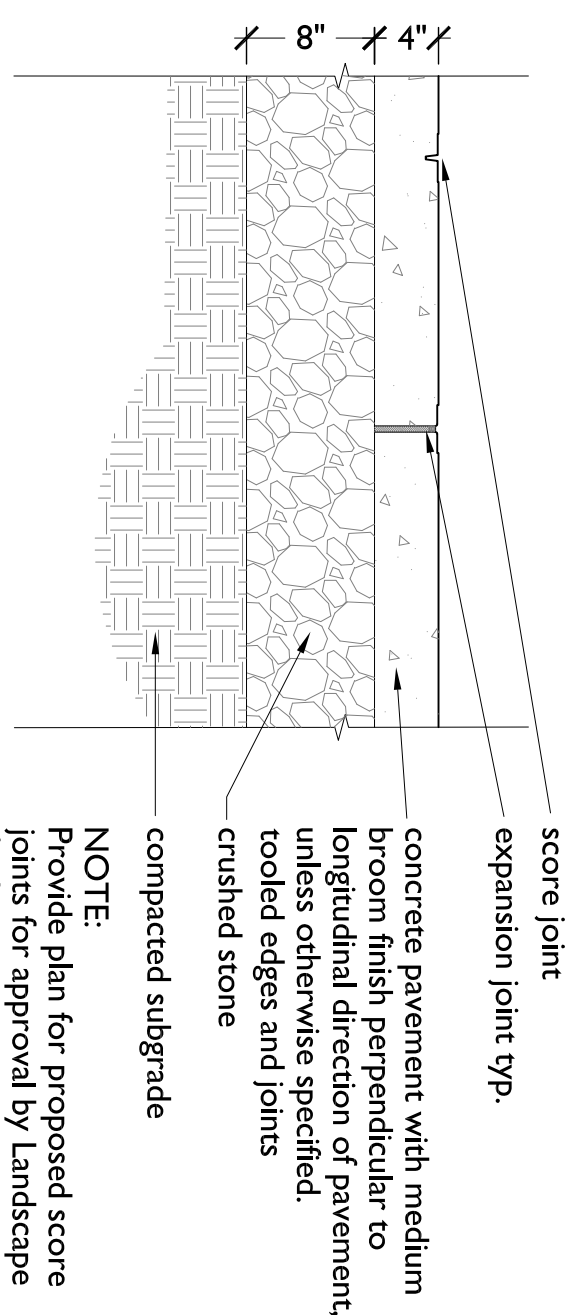

4 CONCRETE PATH PAVING - SECTION
scale: 1" = 1'-0"

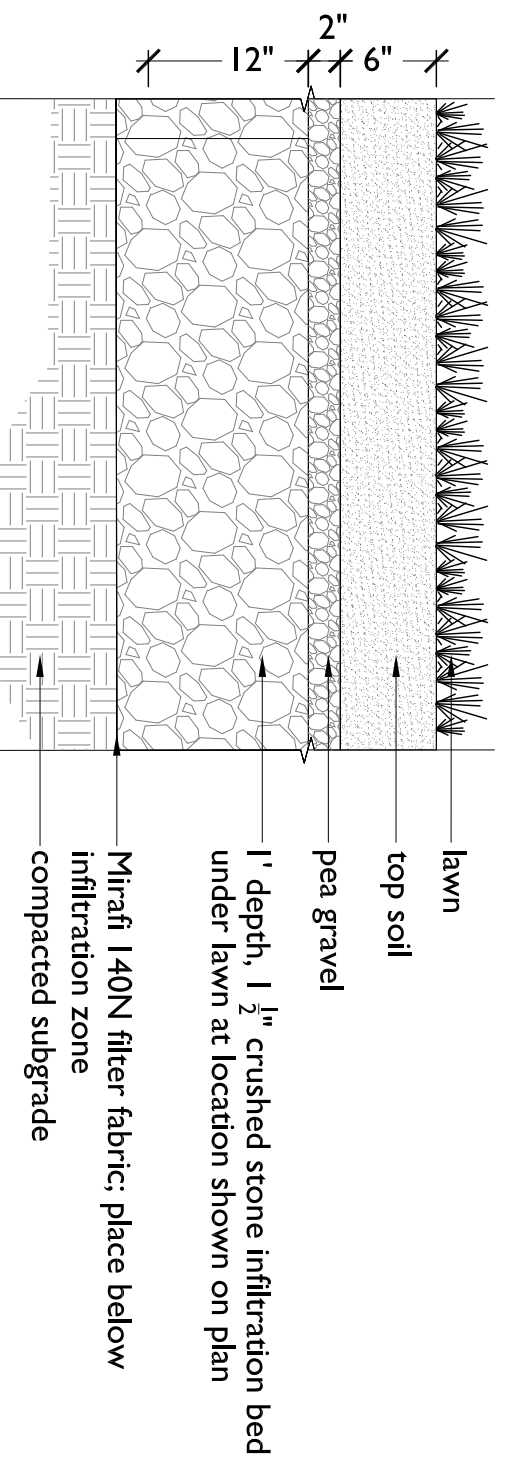

5 LAWN WITH INFILTRATION BELOW - SECTION
scale: 1" = 1'-0"

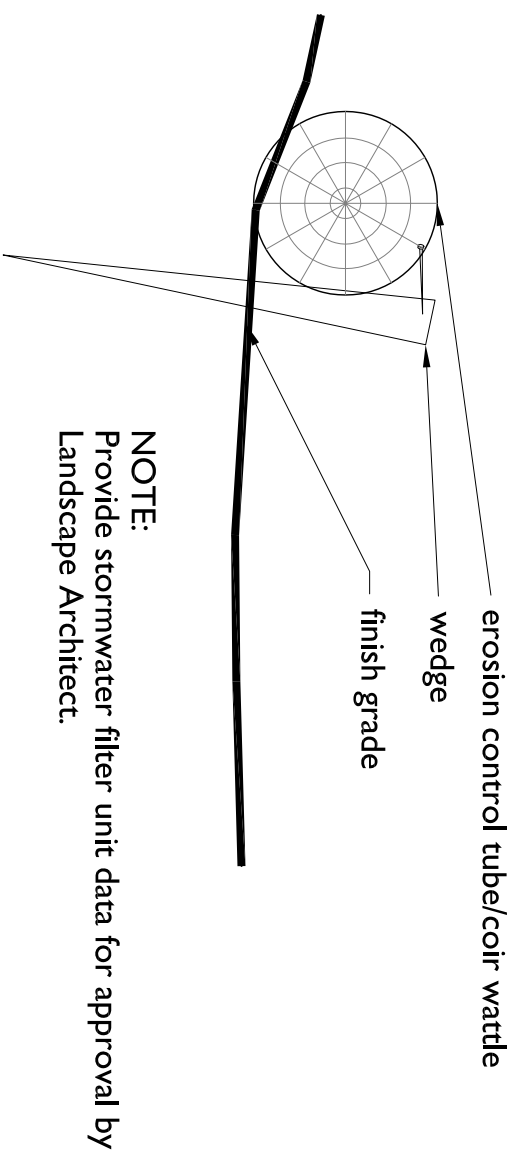

6 EROSION CONTROL TUBE - SECTION
scale: 1" = 1'-0"



Project #: 1315	Date: 2015-07-10
Drawn by: KIL	Reviewed: BH
Scale: as noted	

Revisions:	

EROSION CONTROL NOTES

1. **GENERAL:** PRIOR TO ANY WORK, CONTRACTOR SHALL CONTACT DIGSAFE TO VERIFY SUBGRADE SITE CONDITIONS.
2. THE CONTRACTOR SHALL BE RESPONSIBLE TO TAKE ALL NECESSARY MEASURES ON-SITE TO PROTECT ON-SITE AND OFF-SITE AREAS FROM DAMAGE DUE TO EROSION AND SILTATION GENERATED DURING THE CONSTRUCTION OF THIS PROJECT. THE CONTRACTOR SHALL INSTALL EROSION AND SILTATION CONTROLS IN ACCORDANCE WITH FIELD CONDITIONS SO AS TO ENSURE THAT THE CONSTRUCTION ACTIVITIES DO NOT NEGATIVELY IMPACT ON THE ENVIRONMENTAL AND HYDRAULIC CHARACTERISTICS OF THE SITE AND ADJACENT PROPERTIES.
3. **SILT FENCING AND HAY BALES:** THE CONTRACTOR SHALL INSTALL STORMWATER FILTER AND ALL OTHER EROSION CONTROL STRUCTURES PRIOR TO SITE PREPARATION ACTIVITIES. THE CONTRACTOR SHALL MAINTAIN EROSION CONTROL STRUCTURES THROUGHOUT THE PROJECT. MAINTENANCE SHALL INCLUDE REGULAR INSPECTION OF SILT BARRIERS AND OTHER EROSION CONTROL STRUCTURES THROUGHOUT THE PERIOD OF CONSTRUCTION.
4. ALL SOIL EROSION STRUCTURES SHALL BE CLEANED AFTER EACH RAIN EVENT. MAINTENANCE OF EROSION CONTROL STRUCTURES SHALL INCLUDE REMOVAL OF ACCUMULATIONS OF SILT AND OTHER MIGRATING SOILS. STABILIZING, BACKFILLING AND MULCHING ANY EROSION CHANNELS, OR RILLS OR GULLYING. ANY AREAS OR MANMADE STRUCTURES THAT HAVE BEEN AFFECTED BY SILTATION OR EROSION DUE TO CONSTRUCTION ACTIVITIES SHALL BE RESTORED TO THEIR PRE-CONSTRUCTION CONDITION.
5. SILT THAT LEAVES THE SITE IN SPITE OF THE REQUIRED PRECAUTIONS SHALL BE COLLECTED AND REMOVED BY THE CONTRACTOR AS DIRECTED BY APPROPRIATE MUNICIPAL AUTHORITIES.
6. **CLEANING OF PAVEMENTS:** CONTRACTOR SHALL REGULARLY "STREET SWEEP" EXISTING ON-SITE PAVEMENTS. CONSTRUCTION ENTRY/EXIT POINTS IN THE PUBLIC WAY AND PUBLIC WALKWAYS ADJACENT TO THE SITE TO REMOVE SOIL MATERIALS. KEEPING PAVED AREAS FREE OF ACCUMULATING SOILS IS AN ESSENTIAL COMPONENT OF DUST CONTROL AND EROSION/SEDIMENTATION CONTROL.
7. **RESEEDING:** RESPREAD TOPSOIL AND RESEED ALL AREAS OF THE SITE AS SOON AS FINAL GRADES ARE ESTABLISHED. IF REGRADED/ EXCAVATED AREAS OF THE SITE CANNOT BE IMMEDIATELY RESEED AS FINISHED LAWN, SPREAD MULCH AND EROSION CONTROL MATTING AND RESEED USING ECOAEGIS 14 DAY GERMINATION SEED MIX.
8. **COMPLETION OF WORK:** EROSION CONTROL BARRIERS SHALL BE MAINTAINED UNTIL NEW VEGETATION HAS BEEN ESTABLISHED ON ALL DISTURBED AREAS OF THE SITE. AFTER FINAL INSPECTION AND APPROVAL, REMOVE SILTATION BARRIERS AND EROSION CONTROL STRUCTURES AND MULCH, SEED, OR OTHERWISE TREAT THE DISTURBED AREAS IN ACCORDANCE WITH THE APPROVED PLANS.
9. **PROTECTION OF EXISTING VEGETATION:** INSTALL 4' ORANGE PLASTIC SNOW FENCE AROUND ALL AREAS OF LAWN, TREES, MONUMENTS AND VEGETATION ALONG THE LIMIT-OF-WORK LINE THAT ARE OFF LIMITS TO CONSTRUCTION. PROVIDE ADDITIONAL FENCE AS DIRECTED BY ARCHITECT.
10. **PROTECTION OF EXISTING DRAINAGE STRUCTURES:** PLACE SILT SACK AND HAY BALES AROUND ALL EXISTING AND NEW AREA DRAINS AND DRAIN INLETS WITHIN LIMIT OF WORK.
11. NO STORAGE OF CONSTRUCTION EQUIPMENT OR FUELING SHALL OCCUR WITHIN 100' TOP OF BANK SETBACK LINE.

1 DRAWING NOTES

2 COMPENSATORY RIVERBANK PLANTING - PLAN, Alternative #2
scale: 1"=20'-0"

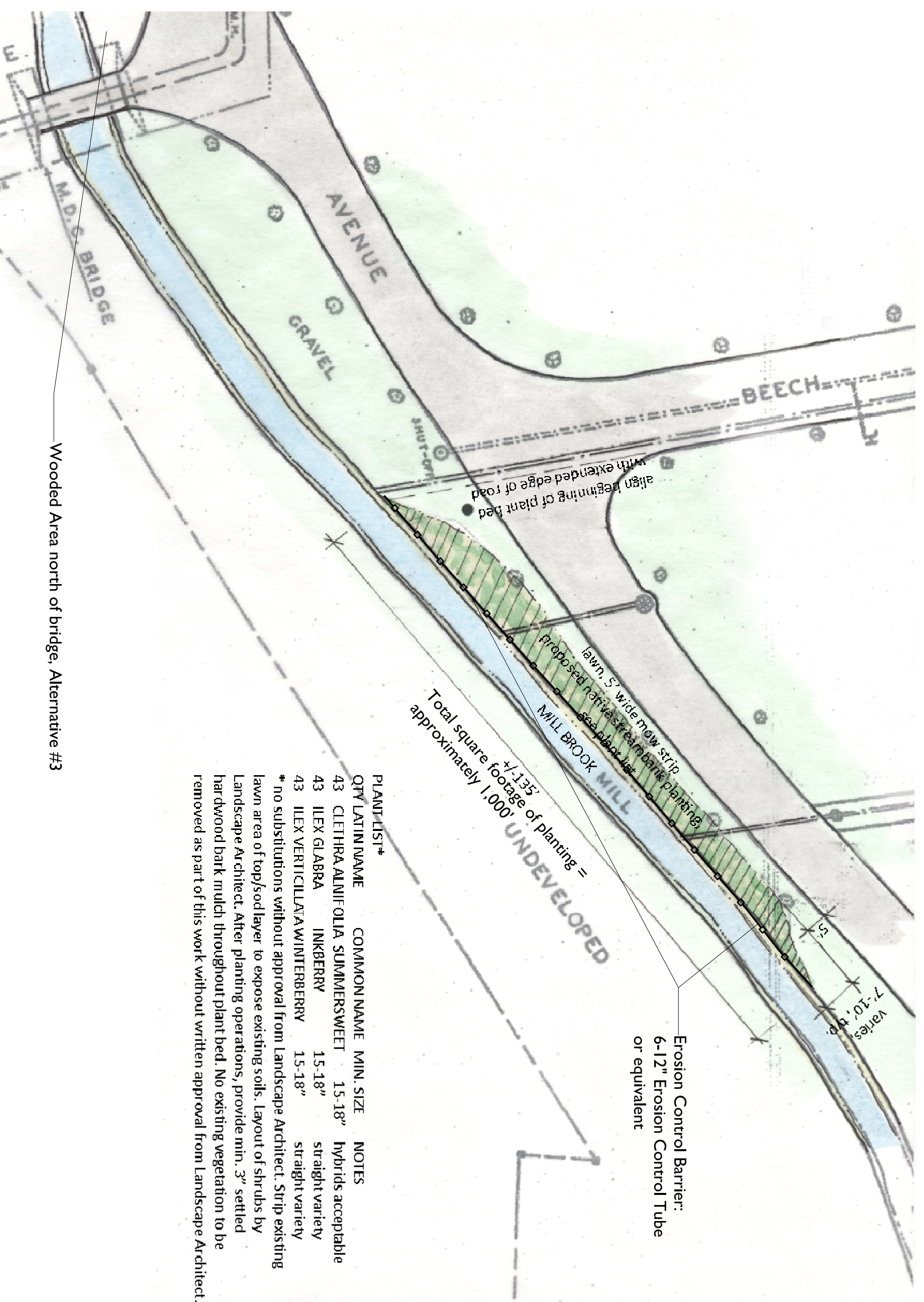

MT. PLEASANT CEMETERY
ARLINGTON, MA
COMPENSATORY RIVERBANK
EROSION CONTROL,
PLANTING PLAN & NOTES

Project #: 1315	Date: 2015.07.10
Drawn by: KL	Reviewed: BH
Scale: as noted	

Revisions:	

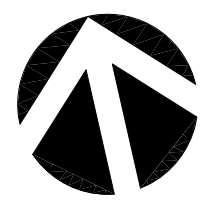

L-5

note:
contractor shall provide wooden stakes (3 per tree) in windy locations and as site conditions require as directed by Landscape Architect

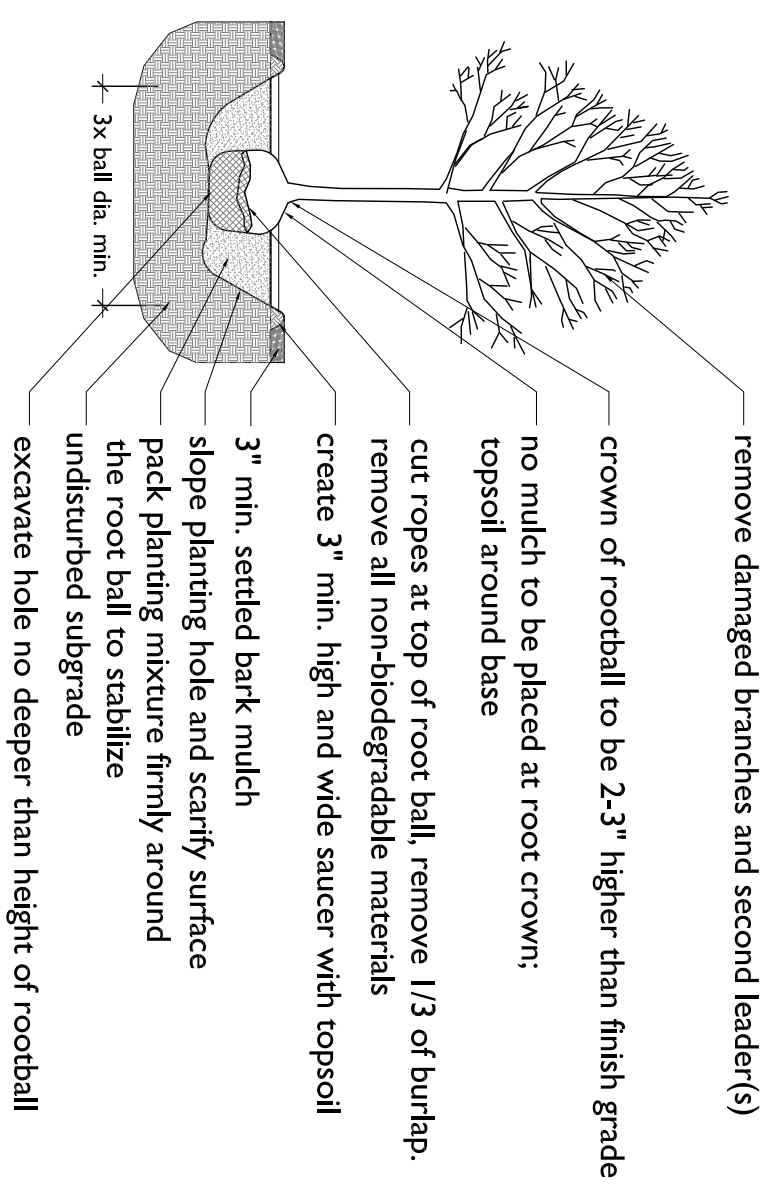

1 TREE PLANTING - SECTION
scale: 1/4" = 1'-0"

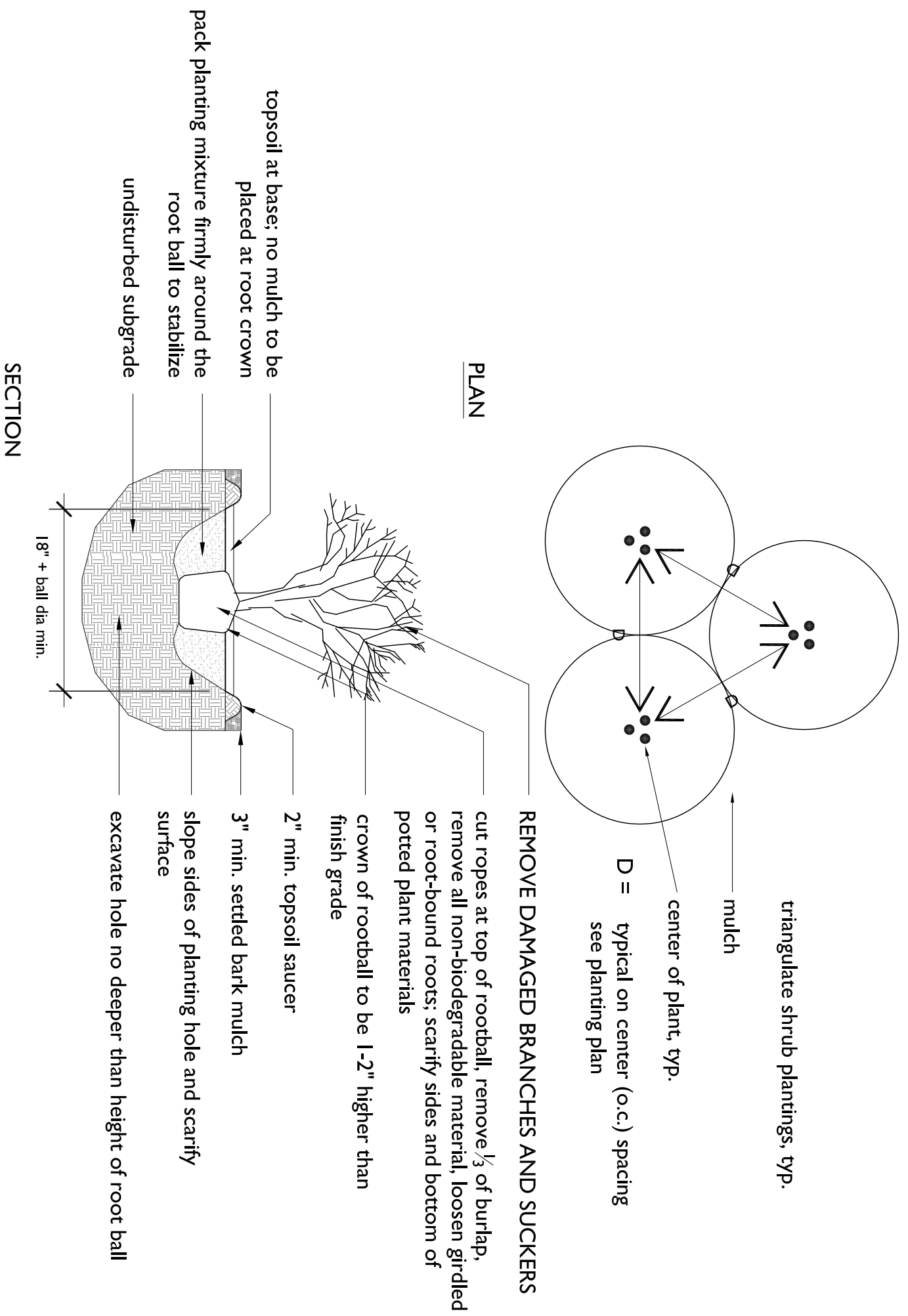

2 SHRUB PLANTING - SECTION
scale: 1/2" = 1'-0"



Project #: 1315	Date: 2015-07-10
Drawn by: KIL	Reviewed: BH
Scale: as noted	

Revisions: