



TOWN OF ARLINGTON

BID # 17-32
2017 WATER DISTRIBUTION
SYSTEM IMPROVEMENTS -
VARIOUS LOCATIONS

MAY 16, 2017

PLAN LIST:

COVER - SHEET 1

BOW STREET - SHEETS 2-4

MILL STREET - SHEETS 5-6

BID ALTERNATE #1: SPRING STREET - SHEET 7

BID ALTERNATE #2: BURCH STREET - SHEETS 8-9

TYPICAL CONSTRUCTION DETAILS: SHEET 10

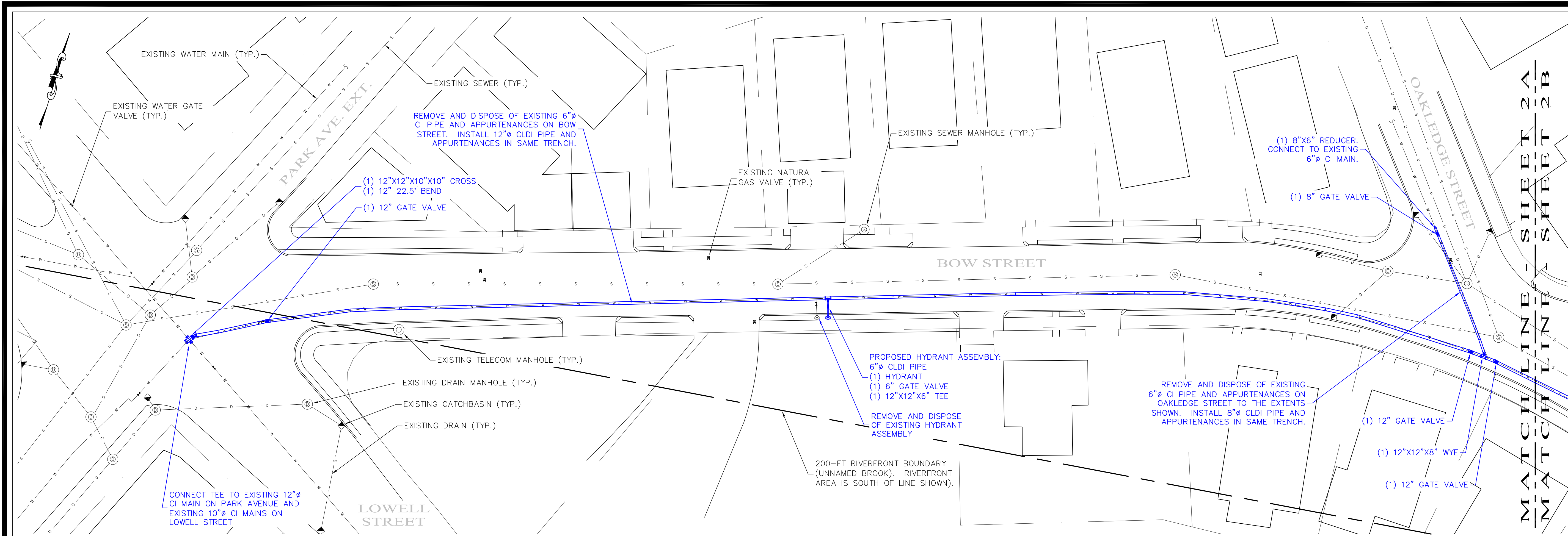

PLAN 2A - BOW STREET
SCALE: 1"=20'

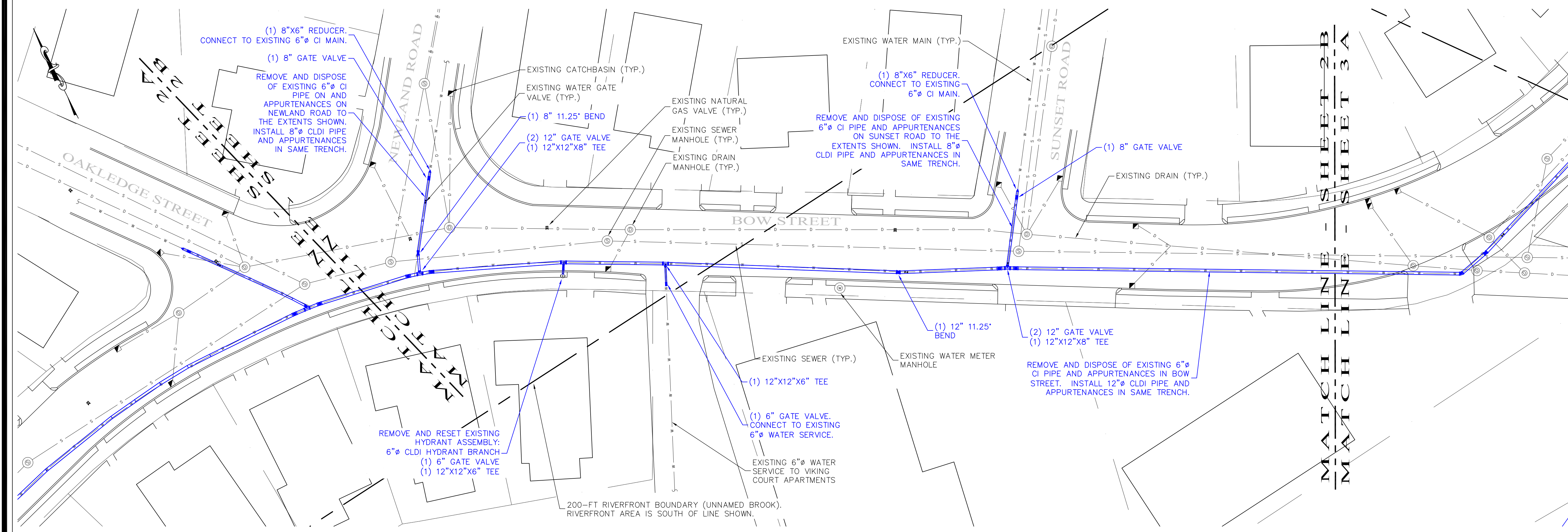

PLAN 2B - BOW STREET
SCALE: 1"=20'

MATCH LINE - SHEET 2A
 MATCH LINE - SHEET 2B

NOTES

- This plan was developed using available aerial imagery, existing plans & on-site observations.
- An on-the-ground survey was not conducted during the development of this plan. The location and dimensions of features shown on this plan are approximate. It shall be the sole responsibility of the contractor to determine locations of any existing utilities and/or features not shown on this plan.
- The contractor shall notify the Town of Arlington Engineering Division and/or Water/Sewer Division of all discrepancies from this plan identified in the field.
- All on-site drainage catch basins shall be equipped with an inlet protection device during all construction activities. Any sediment that enters the Town's Stormwater Sewer System as a result of this work shall be removed by the contractor at his cost.
- No fueling of equipment shall be allowed within the 200-FT Riverfront Resource Area Boundaries.
- Streets shall be swept and cleaned of sediment debris at end of each work day.
- Any areas disturbed by the contractor outside the limits of work shall be restored to original condition at no cost to the owner.
- The contractor must notify all utilities prior to performing any excavation work. The Town of Arlington is not a member of "Dig-Safe" and must be notified directly at least 72-Hours prior to any excavation at 781-316-3310 or 781-316-3301.
- The location, number, & type of proposed fittings shown on this plan are intended for illustrative purposes only. Field conditions will dictate the location, number, & type of fittings required. All installations shall be to the full satisfaction of the Town of Arlington.
- The location of proposed water service laterals are not shown on this plan. The location of new 3/4" copper service laterals shall be field determined and laid out to the satisfaction/approval of the Town of Arlington.
- Trenches shall be backfilled with suitable material and compacted in layers not over 6" deep using mechanical compactors or jet-rodging. Backfill material shall be compacted to 95% of maximum dry density as determined by AASHTO Standard Test T99 Method C.

No.	Revision/Issue	Date

Town of
ARLINGTON
 Engineering Division
 51 Grove Street
 Arlington, MA 02476

2017 WATER DISTRIBUTION SYSTEM IMPROVEMENTS

BOW STREET

Project: BID #17-32	Sheet:
Drawn By: WCC	2 of 10
Scale: 1" = 20'	
Date: MAY 2017	

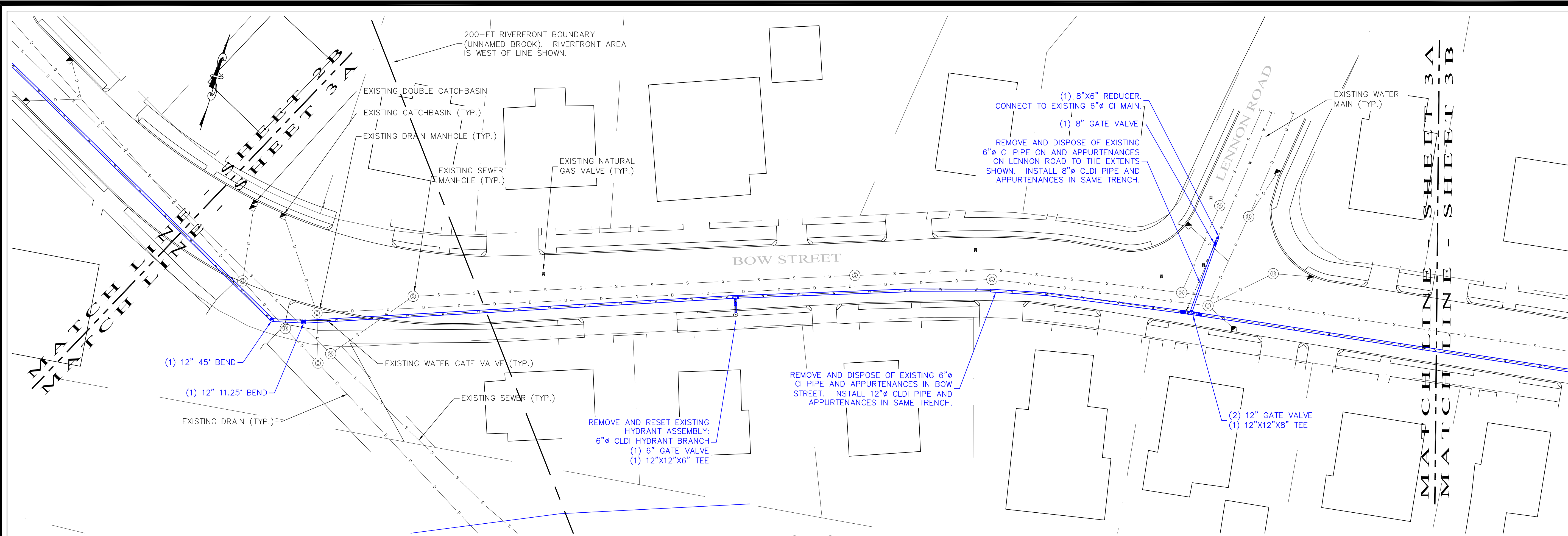

PLAN 3A - BOW STREET
SCALE: 1"=20'

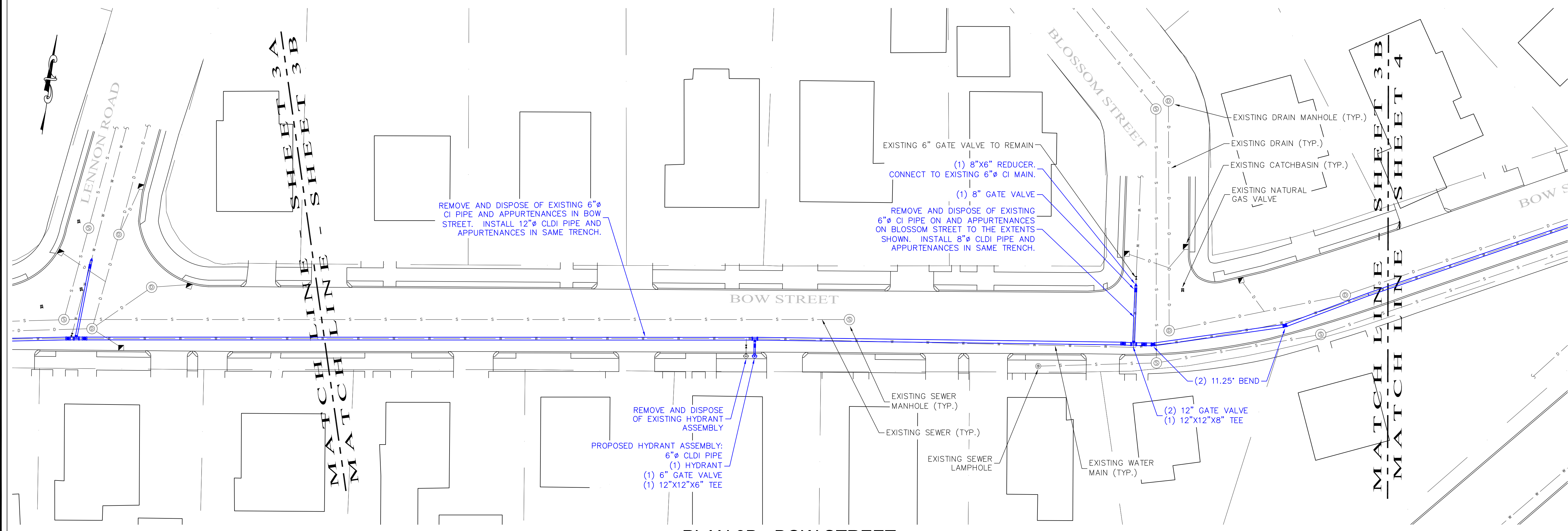

PLAN 3B - BOW STREET
SCALE: 1"=20'

NOTES

1. This plan was developed using available aerial imagery, existing plans & on-site observations.
2. An on-the-ground survey was not conducted during the development of this plan. The location and dimensions of features shown on this plan are approximate. It shall be the sole responsibility of the contractor to determine locations of any existing utilities and/or features not shown on this plan.
3. The contractor shall notify the Town of Arlington Engineering Division and/or Water/Sewer Division of all discrepancies from this plan identified in the field.
4. All on-site drainage catch basins shall be equipped with an inlet protection device during all construction activities. Any sediment that enters the Town's Stormwater Sewer System as a result of this work shall be removed by the contractor at his cost.
5. No fueling of equipment shall be allowed within the 200-FT Riverfront Resource Area Boundaries.
6. Streets shall be swept and cleaned of sediment debris at end of each work day.
7. Any areas disturbed by the contractor outside the limits of work shall be restored to original condition at no cost to the owner.
8. The contractor must notify all utilities prior to performing any excavation work. The Town of Arlington is not a member of "Dig-Safe" and must be notified directly at least 72-Hours prior to any excavation at 781-316-3310 or 781-316-3301.
9. The location, number, & type of proposed fittings shown on this plan are intended for illustrative purposes only. Field conditions will dictate the location, number, & type of fittings required. All installations shall be to the full satisfaction of the Town of Arlington.
10. The location of proposed water service laterals are not shown on this plan. The location of new 3/4" copper service laterals shall be field determined and laid out to the satisfaction/approval of the Town of Arlington.
11. Trenches shall be backfilled with suitable material and compacted in layers not over 6" deep using mechanical compactors or jet-rodding. Backfill material shall be compacted to 95% of maximum dry density as determined by AASHTO Standard Test T99 Method C.

No.	Revision/Issue	Date

Town of
ARLINGTON
Engineering Division
51 Grove Street
Arlington, MA 02476

2017 WATER DISTRIBUTION SYSTEM IMPROVEMENTS

BOW STREET

Project: BID #17-32	Sheet:
Drawn By: WCC	3 of 10
Scale: 1" = 20'	
Date: MAY 2017	

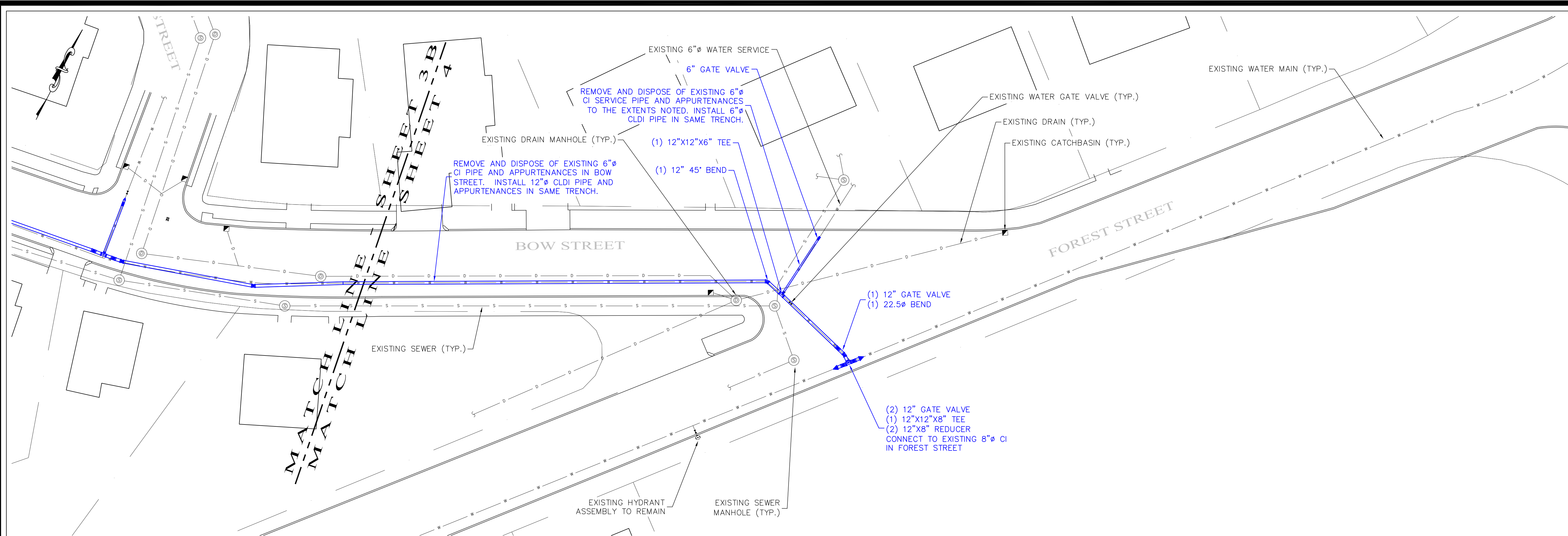

PLAN 4 - BOW STREET
SCALE: 1"=20'

NOTES

1. This plan was developed using available aerial imagery, existing plans & on-site observations.
2. An on-the-ground survey was not conducted during the development of this plan. The location and dimensions of features shown on this plan are approximate. It shall be the sole responsibility of the contractor to determine locations of any existing utilities and/or features not shown on this plan.
3. The contractor shall notify the Town of Arlington Engineering Division and/or Water/Sewer Division of all discrepancies from this plan identified in the field.
4. All on-site drainage catch basins shall be equipped with an inlet protection device during all construction activities. Any sediment that enters the Town's Stormwater Sewer System as a result of this work shall be removed by the contractor at his cost.
5. No fueling of equipment shall be allowed within the 200-FT Riverfront Resource Area Boundaries.
6. Streets shall be swept and cleaned of sediment debris at end of each work day.
7. Any areas disturbed by the contractor outside the limits of work shall be restored to original condition at no cost to the owner.
8. The contractor must notify all utilities prior to performing any excavation work. The Town of Arlington is not a member of "Dig-Safe" and must be notified directly at least 72-Hours prior to any excavation at 781-316-3310 or 781-316-3301.
9. The location, number, & type of proposed fittings shown on this plan are intended for illustrative purposes only. Field conditions will dictate the location, number, & type of fittings required. All installations shall be to the full satisfaction of the Town of Arlington.
10. The location of proposed water service laterals are not shown on this plan. The location of new 3/4" copper service laterals shall be field determined and laid out to the satisfaction/approval of the Town of Arlington.
11. Trenches shall be backfilled with suitable material and compacted in layers not over 6" deep using mechanical compactors or jet-rodding. Backfill material shall be compacted to 95% of maximum dry density as determined by AASHTO Standard Test T99 Method C.

No.	Revision/Issue	Date

Town of
ARLINGTON
Engineering Division
51 Grove Street
Arlington, MA 02476

2017 WATER DISTRIBUTION SYSTEM IMPROVEMENTS

BOW STREET

Project:	BID #17-32	Sheet:	4 of 10
Drawn By:	WCC		
Scale:	1" = 20'		
Date:	MAY 2017		

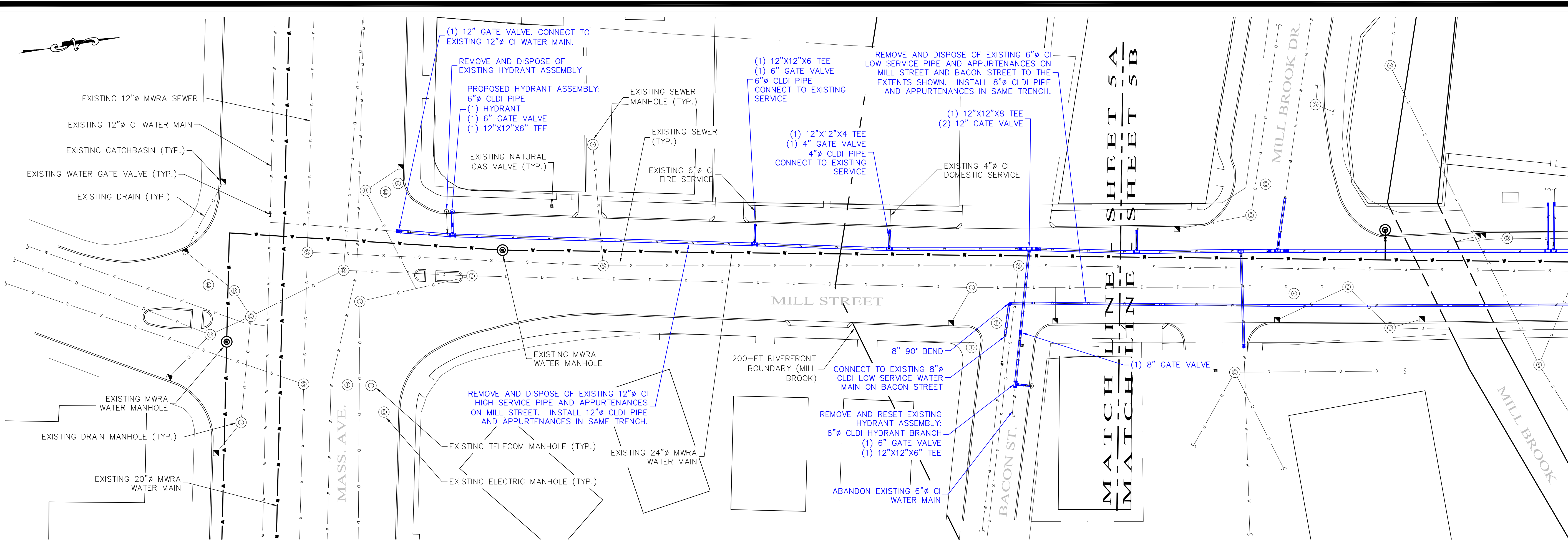

PLAN 5A - MILL STREET

SCALE: 1"=20'

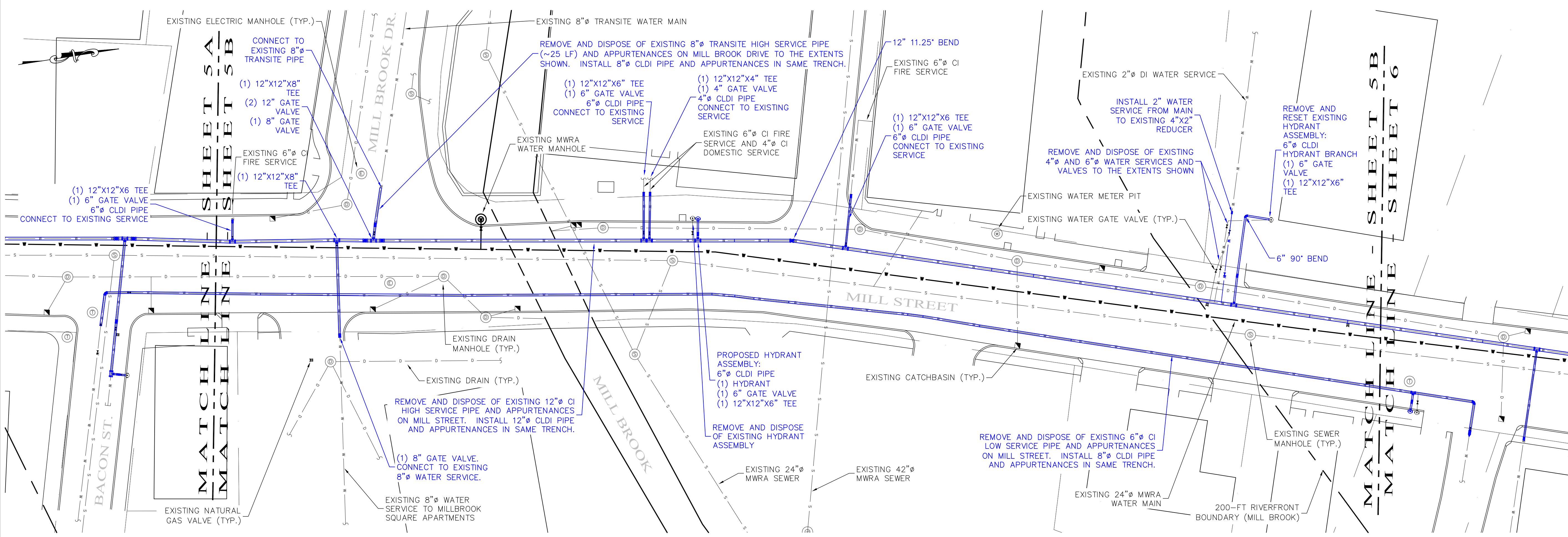

PLAN 5B - MILL STREET

SCALE: 1"=20'

NOTES

- This plan was developed using available aerial imagery, existing plans & on-site observations.
- An on-the-ground survey was not conducted during the development of this plan. The location and dimensions of features shown on this plan are approximate. It shall be the sole responsibility of the contractor to determine locations of any existing utilities and/or features not shown on this plan.
- The contractor shall notify the Town of Arlington Engineering Division and/or Water/Sewer Division of all discrepancies from this plan identified in the field.
- All on-site drainage catch basins shall be equipped with an inlet protection device during all construction activities. Any sediment that enters the Town's Stormwater Sewer System as a result of this work shall be removed by the contractor at his cost.
- No fueling of equipment shall be allowed within the 200-FT Riverfront Resource Area Boundaries.
- Streets shall be swept and cleaned of sediment debris at end of each work day.
- Any areas disturbed by the contractor outside the limits of work shall be restored to original condition at no cost to the owner.
- The contractor must notify all utilities prior to performing any excavation work. The Town of Arlington is not a member of "Dig-Safe" and must be notified directly at least 72-Hours prior to any excavation at 781-316-3310 or 781-316-3301.
- The location, number, & type of proposed fittings shown on this plan are intended for illustrative purposes only. Field conditions will dictate the location, number, & type of fittings required. All installations shall be to the full satisfaction of the Town of Arlington.
- The location of proposed water service laterals are not shown on this plan. The location of new 3/4" copper service laterals shall be field determined and laid out to the satisfaction/approval of the Town of Arlington.
- Trenches shall be backfilled with suitable material and compacted in layers not over 6" deep using mechanical compactors or jet-rodding. Backfill material shall be compacted to 95% of maximum dry density as determined by AASHTO Standard Test T99 Method C.

No.	Revision/Issue	Date

Town of
ARLINGTON
Engineering Division
51 Grove Street
Arlington, MA 02476

2017 WATER DISTRIBUTION SYSTEM IMPROVEMENTS

MILL STREET

Project:	BID #17-32	Sheet:	5 of 10
Drawn By:	WCC		
Scale:	1" = 20'		
Date:	MAY 2017		

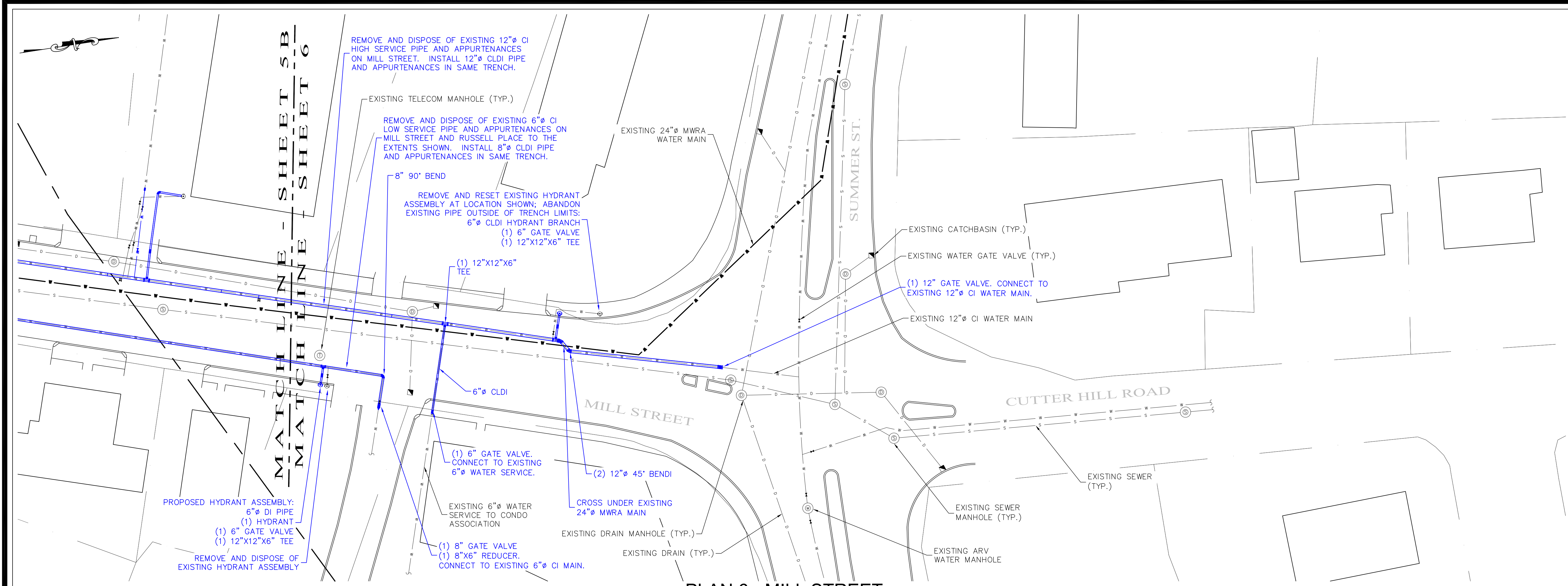

PLAN 6 - MILL STREET

SCALE: 1"=20'

NOTES

1. This plan was developed using available aerial imagery, existing plans & on-site observations.
2. An on-the-ground survey was not conducted during the development of this plan. The location and dimensions of features shown on this plan are approximate. It shall be the sole responsibility of the contractor to determine locations of any existing utilities and/or features not shown on this plan.
3. The contractor shall notify the Town of Arlington Engineering Division and/or Water/Sewer Division of all discrepancies from this plan identified in the field.
4. All on-site drainage catch basins shall be equipped with an inlet protection device during all construction activities. Any sediment that enters the Town's Stormwater Sewer System as a result of this work shall be removed by the contractor at his cost.
5. No fueling of equipment shall be allowed within the 200-FT Riverfront Resource Area Boundaries.
6. Streets shall be swept and cleaned of sediment debris at end of each work day.
7. Any areas disturbed by the contractor outside the limits of work shall be restored to original condition at no cost to the owner.
8. The contractor must notify all utilities prior to performing any excavation work. The Town of Arlington is not a member of "Dig-Safe" and must be notified directly at least 72-Hours prior to any excavation at 781-316-3310 or 781-316-3301.
9. The location, number, & type of proposed fittings shown on this plan are intended for illustrative purposes only. Field conditions will dictate the location, number, & type of fittings required. All installations shall be to the full satisfaction of the Town of Arlington.
10. The location of proposed water service laterals are not shown on this plan. The location of new 3/4" copper service laterals shall be field determined and laid out to the satisfaction/approval of the Town of Arlington.
11. Trenches shall be backfilled with suitable material and compacted in layers not over 6" deep using mechanical compactors or jet-rodding. Backfill material shall be compacted to 95% of maximum dry density as determined by AASHTO Standard Test T99 Method C.

No.	Revision/Issue	Date

Town of
ARLINGTON
Engineering Division
51 Grove Street
Arlington, MA 02476

2017 WATER DISTRIBUTION SYSTEM IMPROVEMENTS

MILL STREET

Project:	BID #17-32	Sheet:	6 of 10
Drawn By:	WCC		
Scale:	1" = 20'		
Date:	MAY 2017		

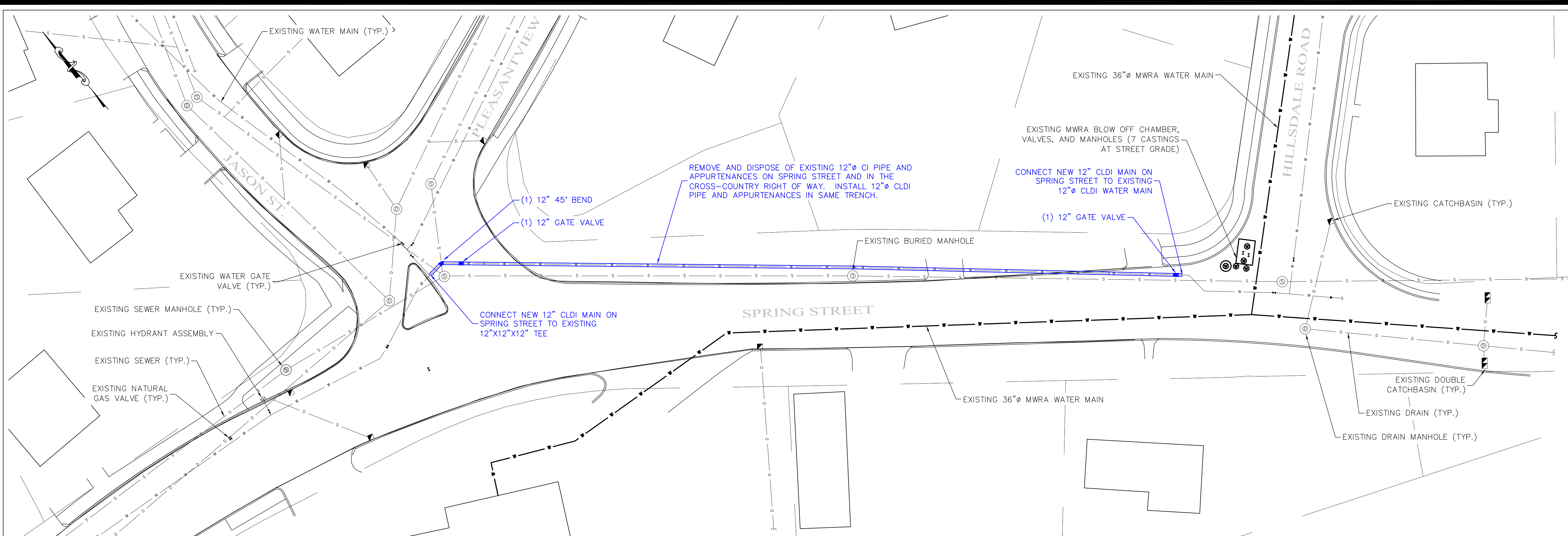

PLAN 7A - SPRING STREET - BID ALTERNATE #1
SCALE: 1"=20'

NOTES

1. This plan was developed using available aerial imagery, existing plans & on-site observations.
2. An on-the-ground survey was not conducted during the development of this plan. The location and dimensions of features shown on this plan are approximate. It shall be the sole responsibility of the contractor to determine locations of any existing utilities and/or features not shown on this plan.
3. The contractor shall notify the Town of Arlington Engineering Division and/or Water/Sewer Division of all discrepancies from this plan identified in the field.
4. All on-site drainage catch basins shall be equipped with an inlet protection device during all construction activities. Any sediment that enters the Town's Stormwater Sewer System as a result of this work shall be removed by the contractor at his cost.
5. No fueling of equipment shall be allowed within the 200-FT Riverfront Resource Area Boundaries.
6. Streets shall be swept and cleaned of sediment debris at end of each work day.
7. Any areas disturbed by the contractor outside the limits of work shall be restored to original condition at no cost to the owner.
8. The contractor must notify all utilities prior to performing any excavation work. The Town of Arlington is not a member of "Dig-Safe" and must be notified directly at least 72-Hours prior to any excavation at 781-316-3310 or 781-316-3301.
9. The location, number, & type of proposed fittings shown on this plan are intended for illustrative purposes only. Field conditions will dictate the location, number, & type of fittings required. All installations shall be to the full satisfaction of the Town of Arlington.
10. The location of proposed water service laterals are not shown on this plan. The location of new 3/4" copper service laterals shall be field determined and laid out to the satisfaction/approval of the Town of Arlington.
11. Trenches shall be backfilled with suitable material and compacted in layers not over 6" deep using mechanical compactors or jet-rodging. Backfill material shall be compacted to 95% of maximum dry density as determined by AASHTO Standard Test T99 Method C.

No.	Revision/Issue	Date

Town of
ARLINGTON
Engineering Division
51 Grove Street
Arlington, MA 02476

2017 WATER DISTRIBUTION SYSTEM IMPROVEMENTS

SPRING STREET BID ALTERNATE #1

Project:	BID #17-32	Sheet:	7 of 10
Drawn By:	WCC		
Scale:	1" = 20'		
Date:	MAY 2017		

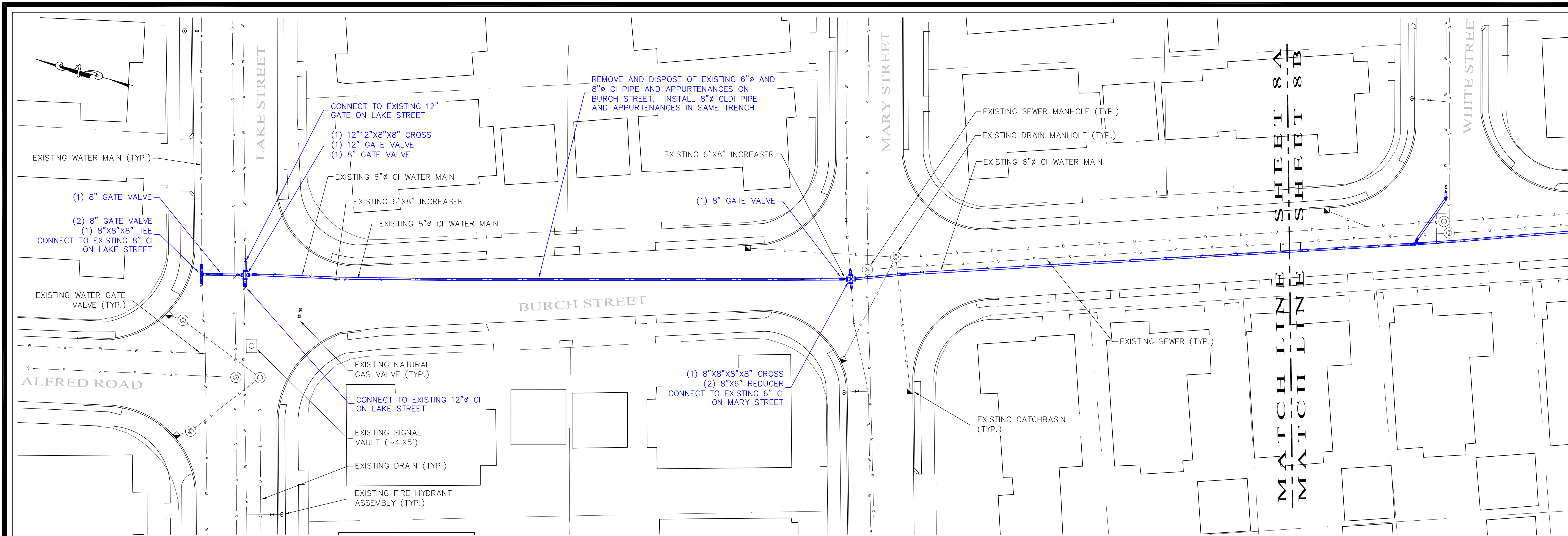

PLAN 8A - BURCH STREET - BID ALTERNATE #2
SCALE: 1"=20'

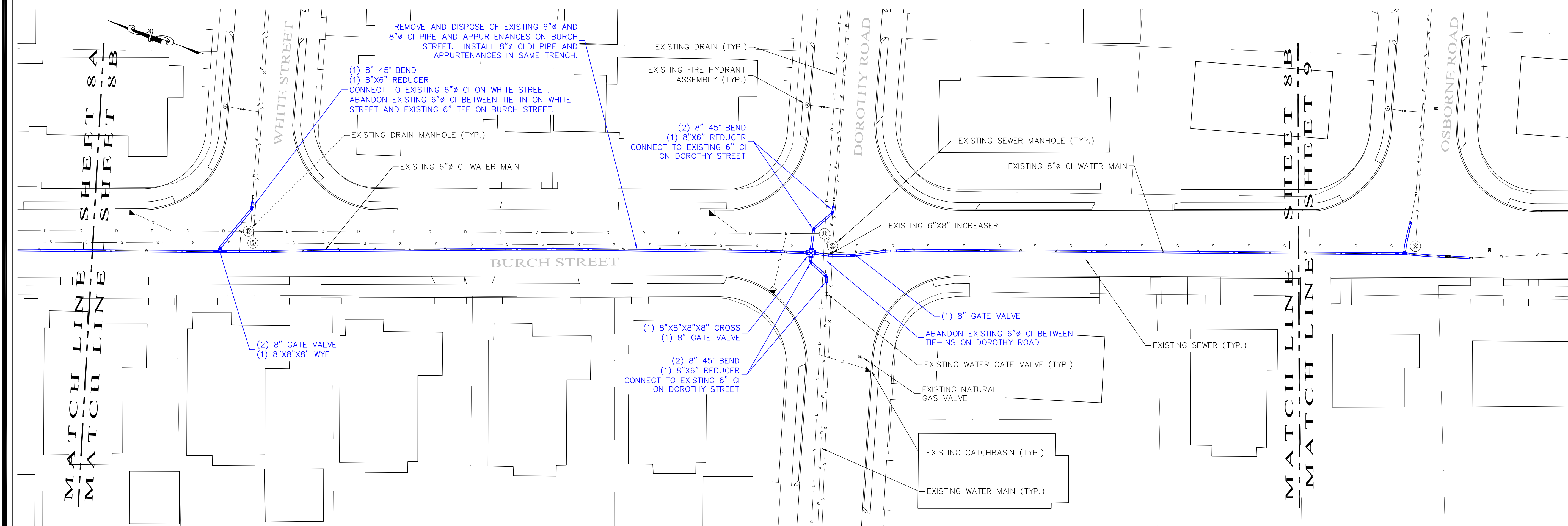

PLAN 8B - BURCH STREET - BID ALTERNATE #2
SCALE: 1"=20'

NOTES

- This plan was developed using available aerial imagery, existing plans & on-site observations.
- An on-the-ground survey was not conducted during the development of this plan. The location and dimensions of features shown on this plan are approximate. It shall be the sole responsibility of the contractor to determine locations of any existing utilities and/or features not shown on this plan.
- The contractor shall notify the Town of Arlington Engineering Division and/or Water/Sewer Division of all discrepancies from this plan identified in the field.
- All on-site drainage catch basins shall be equipped with an inlet protection device during all construction activities. Any sediment that enters the Town's Stormwater Sewer System as a result of this work shall be removed by the contractor at his cost.
- No fueling of equipment shall be allowed within the 200-FT Riverfront Resource Area Boundaries.
- Streets shall be swept and cleaned of sediment debris at end of each work day.
- Any areas disturbed by the contractor outside the limits of work shall be restored to original condition at no cost to the owner.
- The contractor must notify all utilities prior to performing any excavation work. The Town of Arlington is not a member of "Dig-Safe" and must be notified directly at least 72-Hours prior to any excavation at 781-316-3310 or 781-316-3301.
- The location, number, & type of proposed fittings shown on this plan are intended for illustrative purposes only. Field conditions will dictate the location, number, & type of fittings required. All installations shall be to the full satisfaction of the Town of Arlington.
- The location of proposed water service laterals are not shown on this plan. The location of new 3/4" copper service laterals shall be field determined and laid out to the satisfaction/approval of the Town of Arlington.
- Trenches shall be backfilled with suitable material and compacted in layers not over 6" deep using mechanical compactors or jet-rodding. Backfill material shall be compacted to 95% of maximum dry density as determined by AASHTO Standard Test T99 Method C.

No.	Revision/Issue	Date

Town of
ARLINGTON
Engineering Division
51 Grove Street
Arlington, MA 02476

2017 WATER DISTRIBUTION SYSTEM IMPROVEMENTS

BURCH STREET BID ALTERNATE #2

Project: BID #17-32	Sheet:
Drawn By: WCC	8 of 10
Scale: 1" = 20'	
Date: MAY 2017	

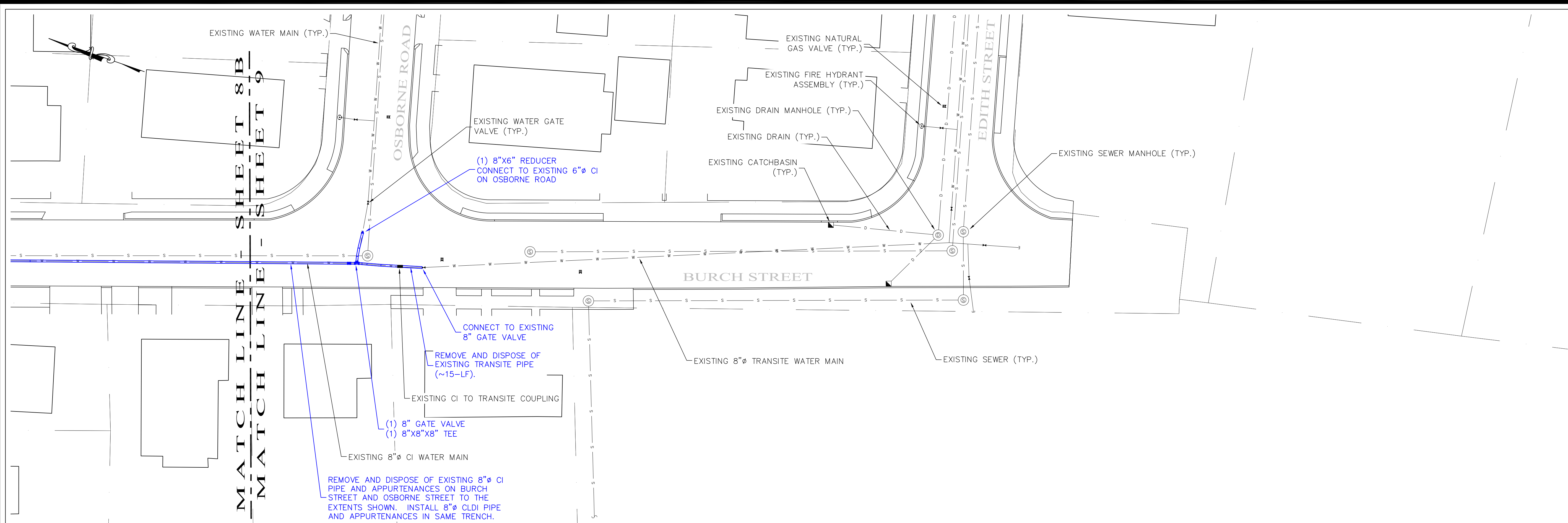

MATCH LINE SHEET 8B - SHEET 9 - MATCH LINE

PLAN 9 - BURCH STREET - BID ALTERNATE #2

SCALE: 1"=20'

NOTES

1. This plan was developed using available aerial imagery, existing plans & on-site observations.
2. An on-the-ground survey was not conducted during the development of this plan. The location and dimensions of features shown on this plan are approximate. It shall be the sole responsibility of the contractor to determine locations of any existing utilities and/or features not shown on this plan.
3. The contractor shall notify the Town of Arlington Engineering Division and/or Water/Sewer Division of all discrepancies from this plan identified in the field.
4. All on-site drainage catch basins shall be equipped with an inlet protection device during all construction activities. Any sediment that enters the Town's Stormwater Sewer System as a result of this work shall be removed by the contractor at his cost.
5. No fueling of equipment shall be allowed within the 200-FT Riverfront Resource Area Boundaries.
6. Streets shall be swept and cleaned of sediment debris at end of each work day.
7. Any areas disturbed by the contractor outside the limits of work shall be restored to original condition at no cost to the owner.
8. The contractor must notify all utilities prior to performing any excavation work. The Town of Arlington is not a member of "Dig-Safe" and must be notified directly at least 72-Hours prior to any excavation at 781-316-3310 or 781-316-3301.
9. The location, number, & type of proposed fittings shown on this plan are intended for illustrative purposes only. Field conditions will dictate the location, number, & type of fittings required. All installations shall be to the full satisfaction of the Town of Arlington.
10. The location of proposed water service laterals are not shown on this plan. The location of new 3/4" copper service laterals shall be field determined and laid out to the satisfaction/approval of the Town of Arlington.
11. Trenches shall be backfilled with suitable material and compacted in layers not over 6" deep using mechanical compactors or jet-rodging. Backfill material shall be compacted to 95% of maximum dry density as determined by AASHTO Standard Test T99 Method C.

No.	Revision/Issue	Date

Town of
ARLINGTON
Engineering Division
51 Grove Street
Arlington, MA 02476

2017 WATER DISTRIBUTION SYSTEM IMPROVEMENTS

**BURCH STREET
BID ALTERNATE #2**

Project:	BID #17-32	Sheet:	9 of 10
Drawn By:	WCC		
Scale:	1" = 20'		
Date:	MAY 2017		

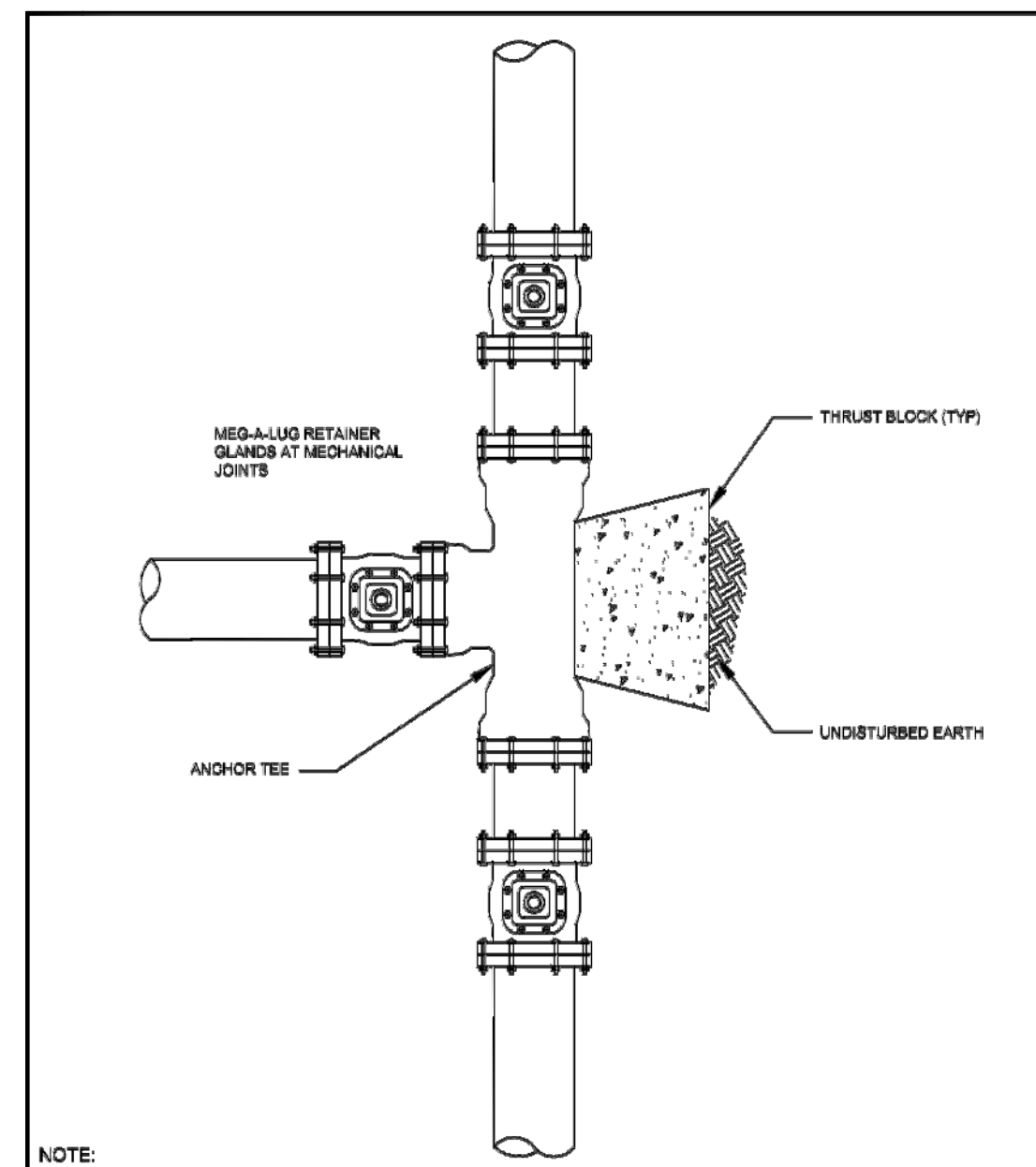

NOTE:
1. ALL INSTALLATIONS SHALL CONFORM TO TOWN OF ARLINGTON STANDARD WATER REGULATIONS & SPECIFICATIONS.

ARLINGTON ENGINEERING DIVISION	TYPICAL ANCHOR TEE INSTALLATION	OCT. 2014	W-0007
		NOT TO SCALE REVISION ①	

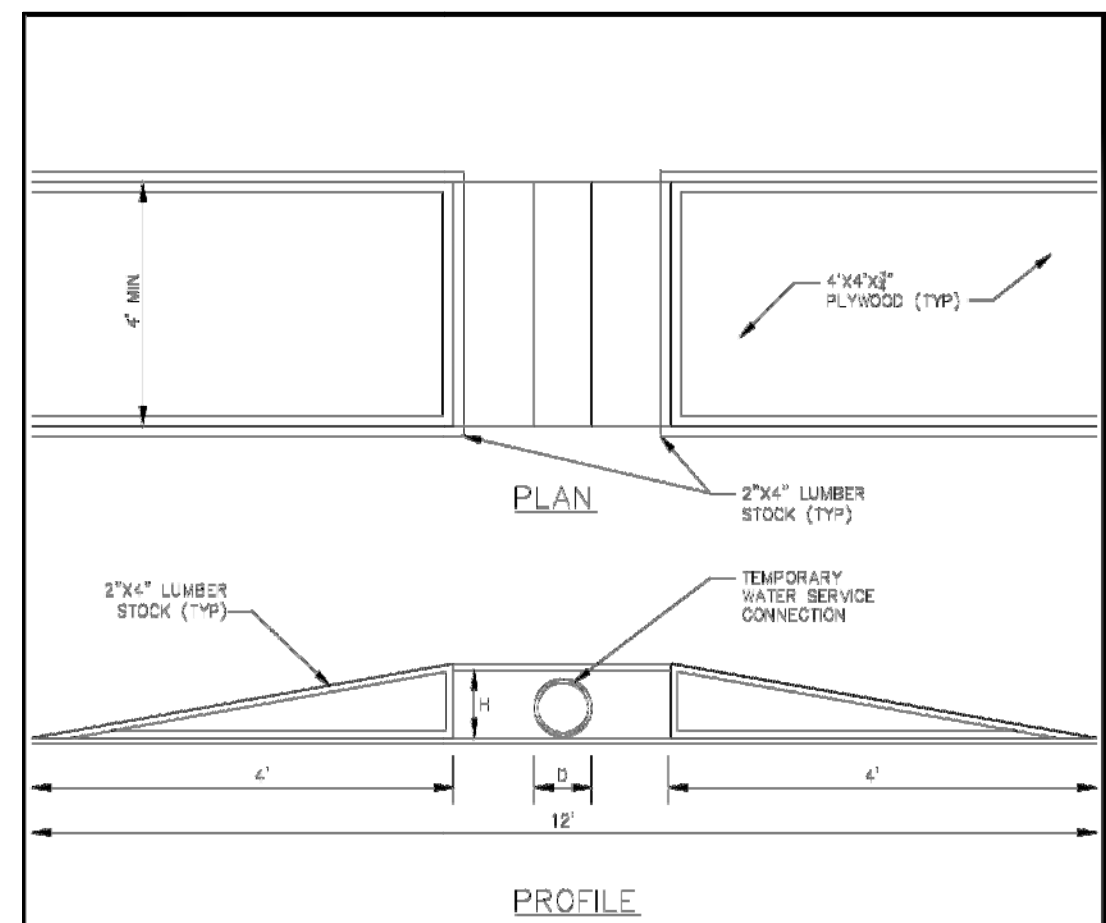

NOTES:
1. ADDITIONAL RAMP SECTIONS SHALL BE FASTENED TOGETHER TO PROVIDE STABILITY.
2. FLARING BARRIERS ARE REQUIRED ON STREET SIDE OF ALL RAMP SECTIONS.
3. RAMP SECTIONS SHALL BE FASTENED TOGETHER TO PROVIDE STABILITY.

TABLE A:	
D	4"
H	8"

ARLINGTON ENGINEERING DIVISION	WATER MAIN BYPASS TEMPORARY PEDESTRIAN RAMP	OCT. 2014	W-0013
		NOT TO SCALE REVISION ①	

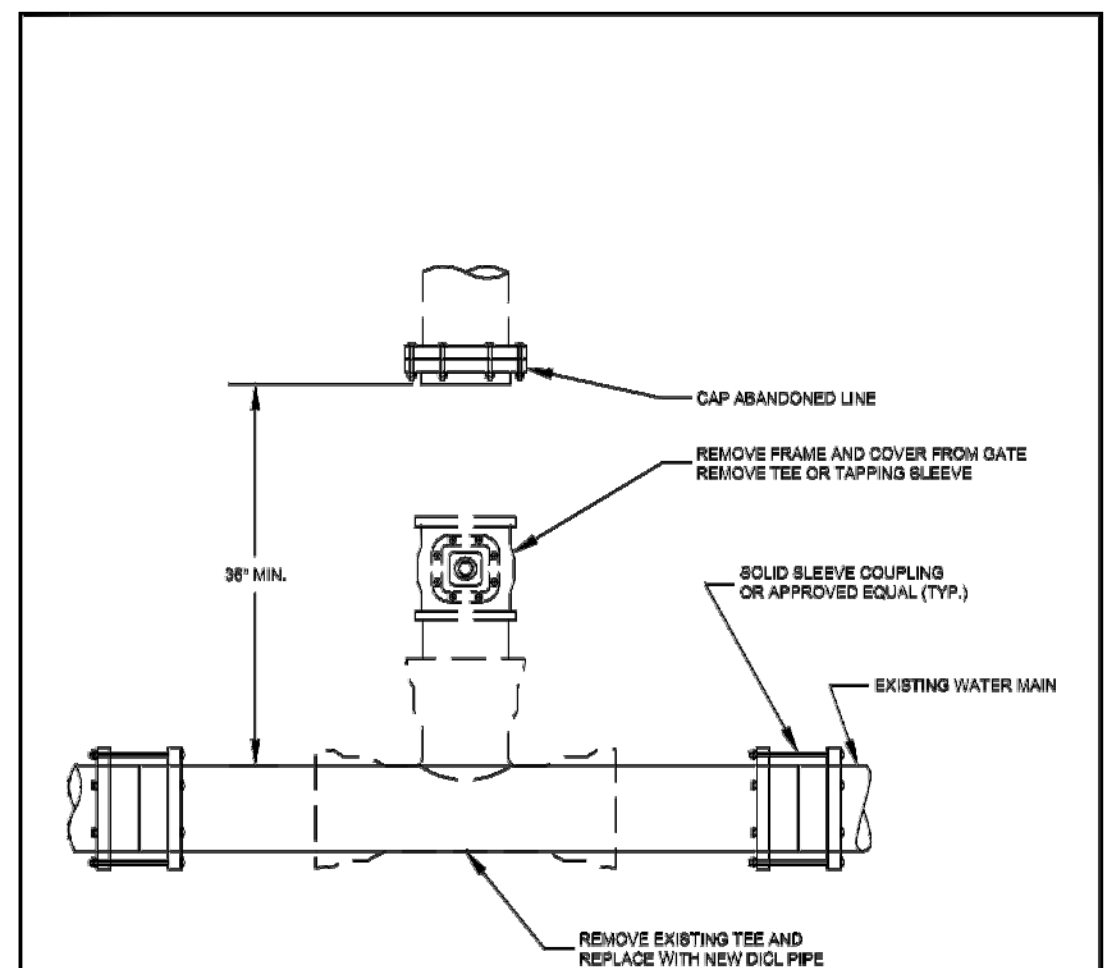

NOTE:
1. ALL INSTALLATIONS SHALL CONFORM TO TOWN OF ARLINGTON STANDARD WATER REGULATIONS & SPECIFICATIONS.

ARLINGTON ENGINEERING DIVISION	TYPICAL CUT & REMOVE EXISTING CONNECTION OVER 2"	OCT. 2014	W-0009
		NOT TO SCALE REVISION ①	

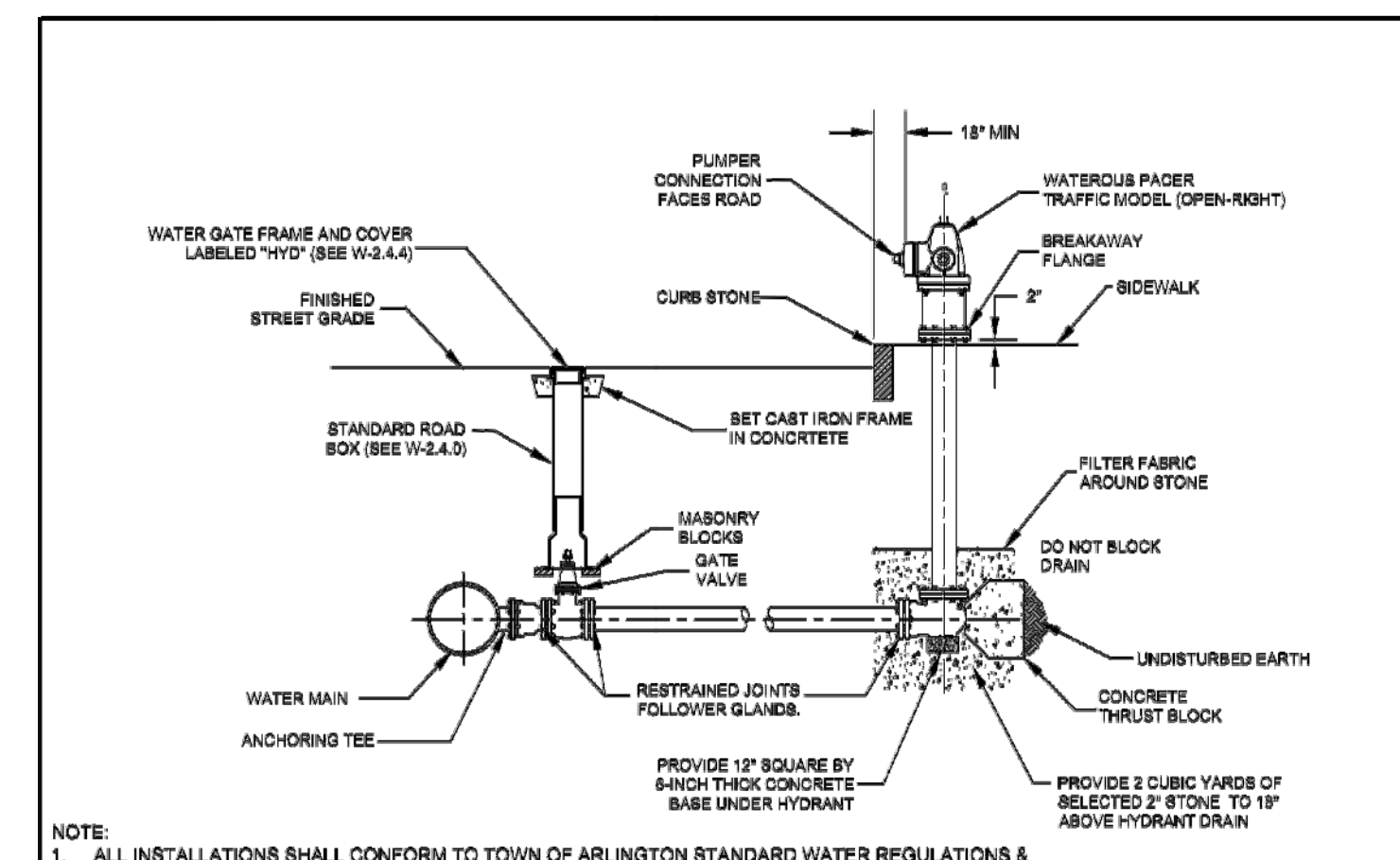

NOTE:
1. ALL INSTALLATIONS SHALL CONFORM TO TOWN OF ARLINGTON STANDARD WATER REGULATIONS & SPECIFICATIONS.

ARLINGTON ENGINEERING DIVISION	TYPICAL FIRE HYDRANT INSTALLATION	OCT. 2014	W-0008
		NOT TO SCALE REVISION ①	

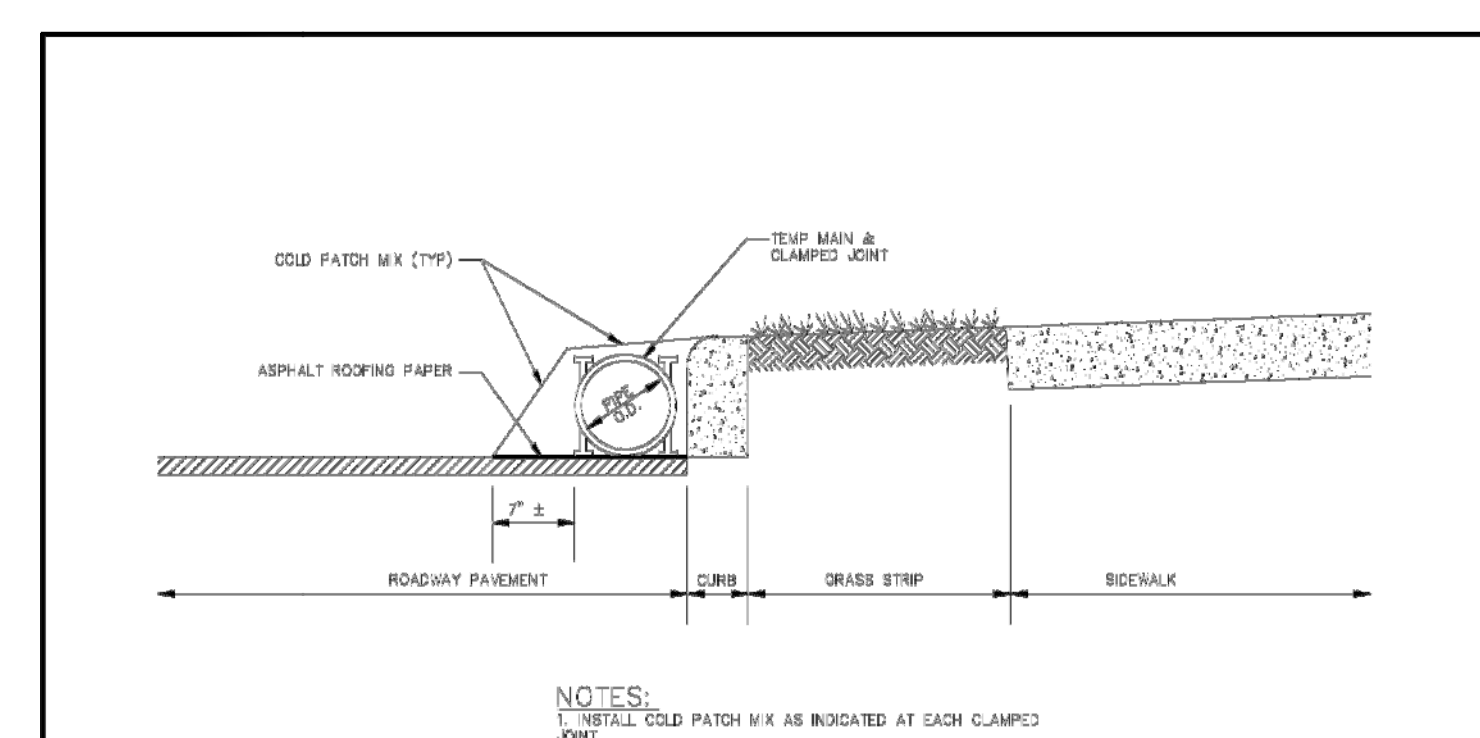

NOTE:
1. REPAIR OLD PATCH MIX AS INDICATED AT EACH CLAMPED JOINT.

ARLINGTON ENGINEERING DIVISION	WATER MAIN BYPASS TEMPORARY PIPE PROTECTION	OCT. 2014	W-0012
		NOT TO SCALE REVISION ①	

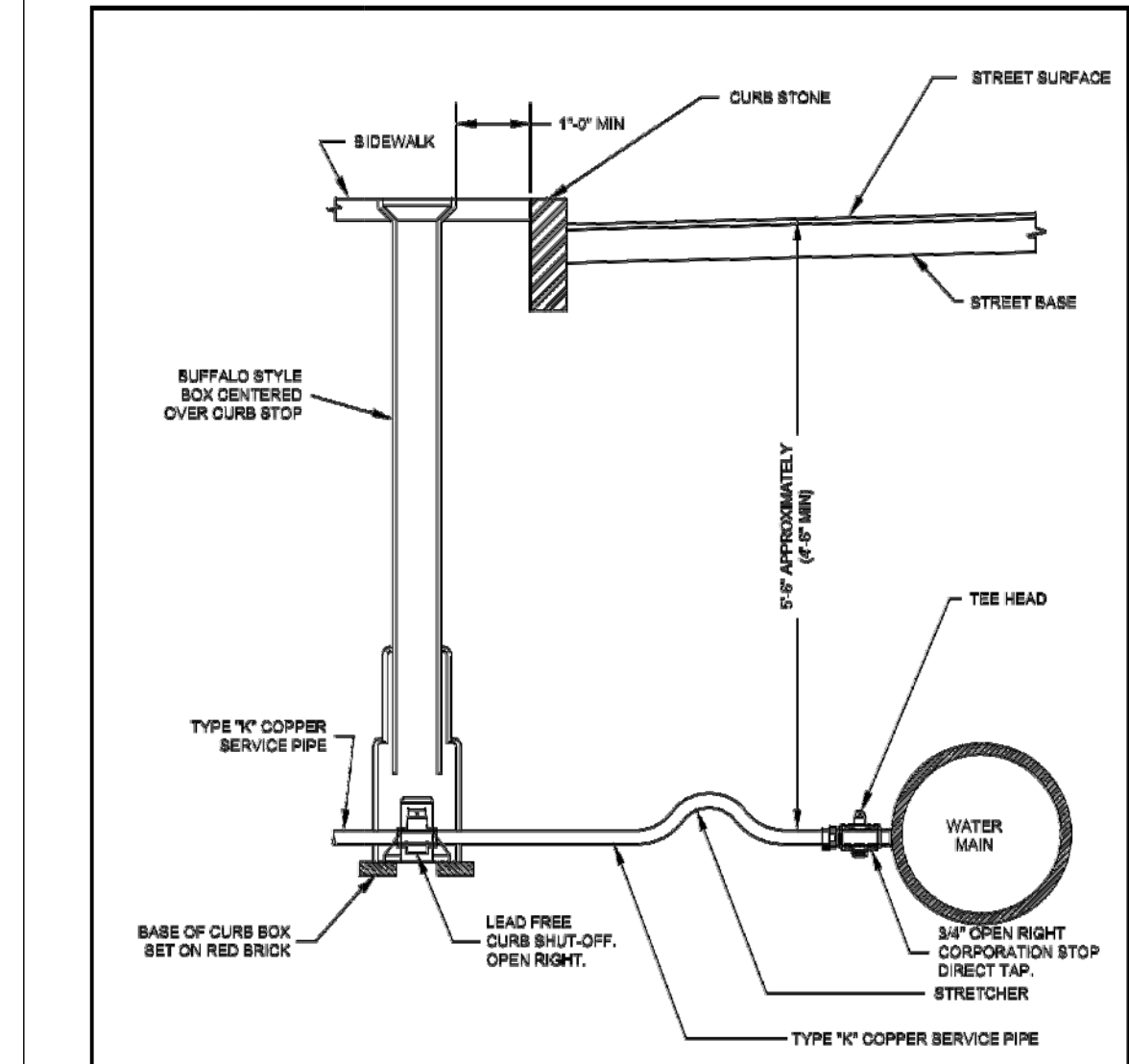

NOTE:
1. ALL INSTALLATIONS SHALL CONFORM TO TOWN OF ARLINGTON STANDARD WATER REGULATIONS & SPECIFICATIONS.

ARLINGTON ENGINEERING DIVISION	TYPICAL WATER CONNECTION FOR 3/4\"/>	
		OCT. 2014 NOT TO SCALE REVISION ①

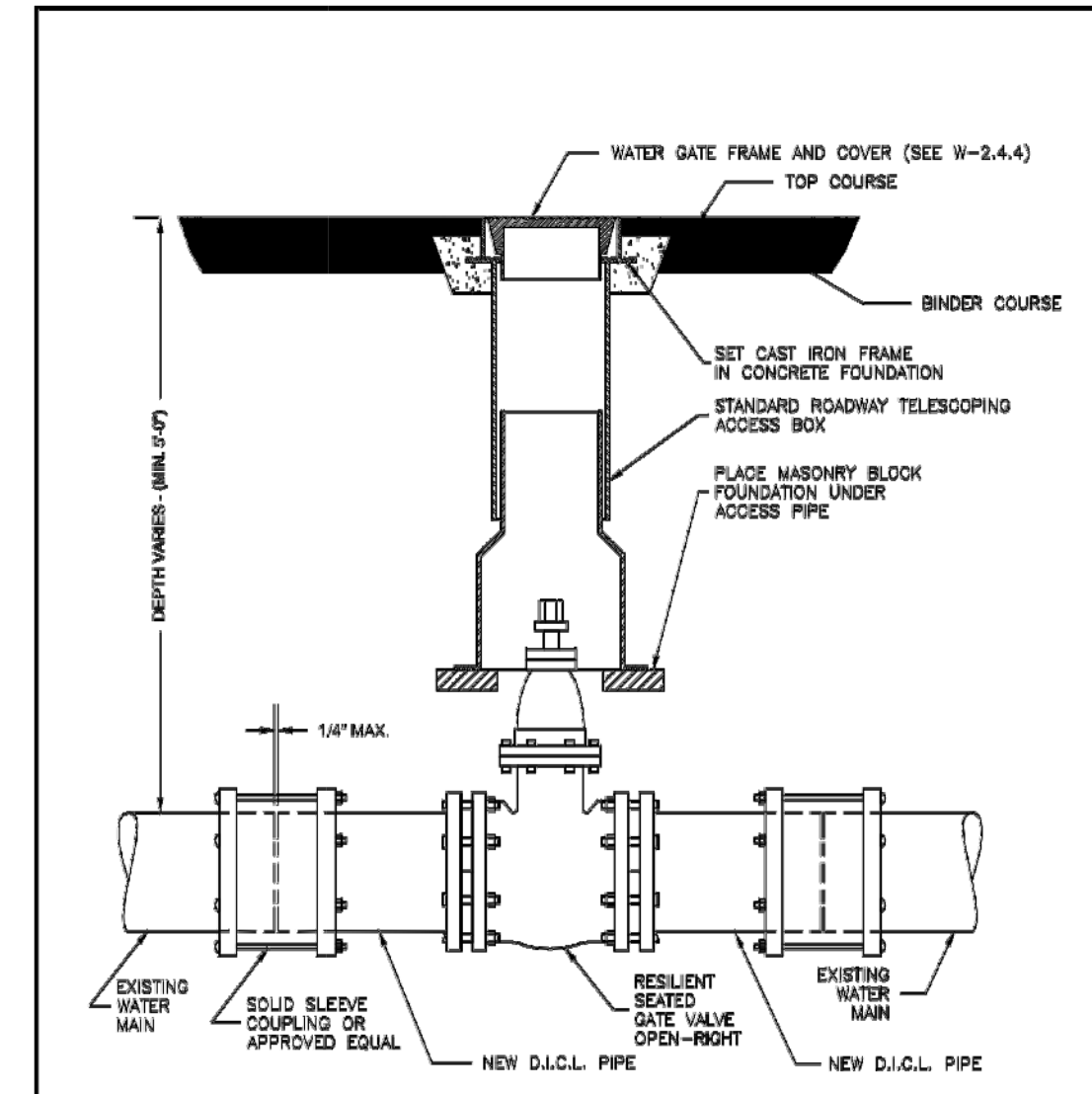

NOTE:
1. ALL INSTALLATIONS SHALL CONFORM TO TOWN OF ARLINGTON STANDARD WATER REGULATIONS & SPECIFICATIONS.

ARLINGTON ENGINEERING DIVISION	TYPICAL GATE VALVE INSTALLATION ON EXISTING MAIN	OCT. 2014	W-0004
		NOT TO SCALE REVISION ①	

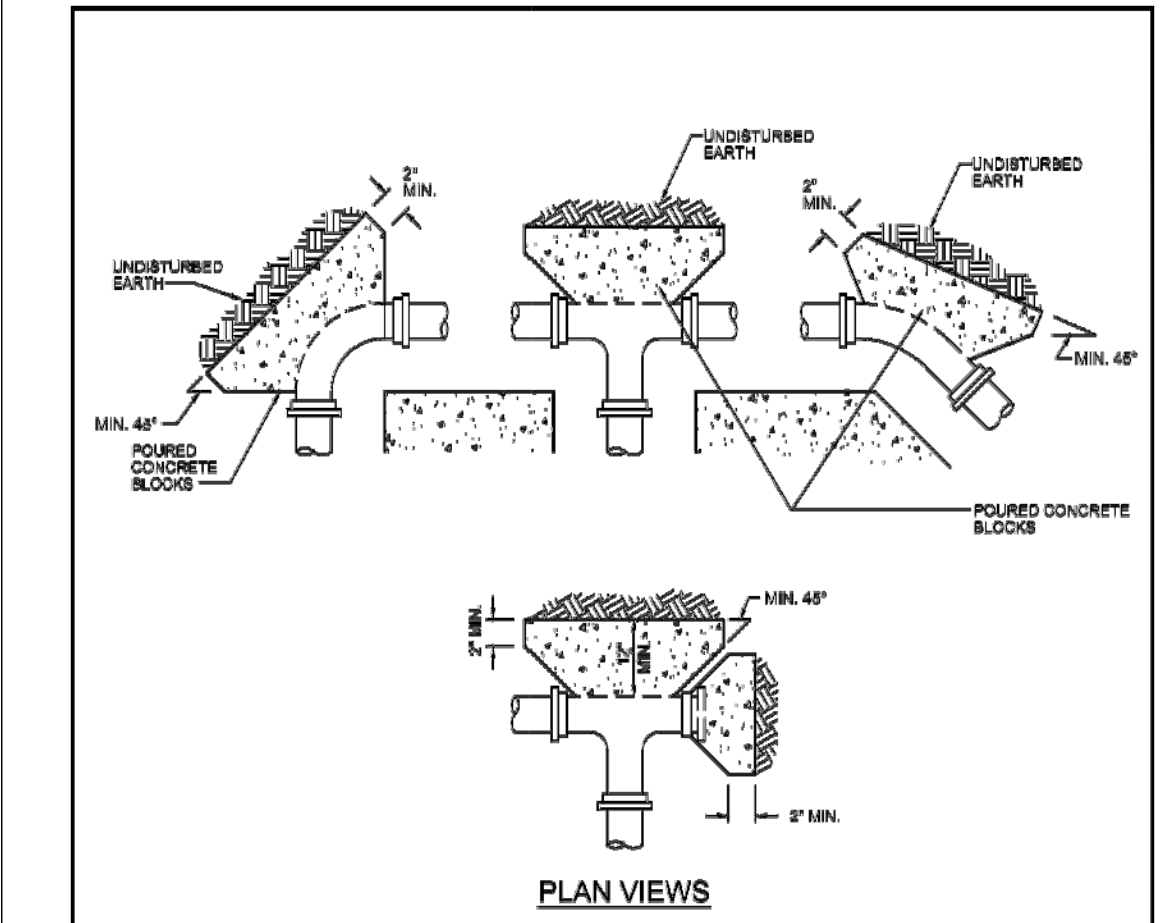

NOTE:
1. ALL INSTALLATIONS SHALL CONFORM TO TOWN OF ARLINGTON STANDARD WATER REGULATIONS & SPECIFICATIONS.
2. SPECIFIC THRUST BLOCK DESIGN SHALL CONFORM TO AWWA GUIDELINES.
3. PLACE 4 mil. POLYETHYLENE BETWEEN CONCRETE AND FITTING (CONCRETE SHALL NOT INTERFERE WITH JOINT).
4. MINIMUM CONCRETE THICKNESS SHALL BE 12 INCHES.
5. THRUST BLOCK ORIENTATION SHALL BE SUCH THAT THE CENTER OF THE FITTING CORRESPONDS WITH THE CENTER OF THE THRUST BLOCK.
6. THE MINIMUM ALLOWABLE ANGLE (EITHER VERTICAL OR HORIZONTAL) SHALL BE 45 DEGREES.

ARLINGTON ENGINEERING DIVISION	TYPICAL THRUST BLOCK DETAIL	OCT. 2014	W-0005
		NOT TO SCALE REVISION ①	

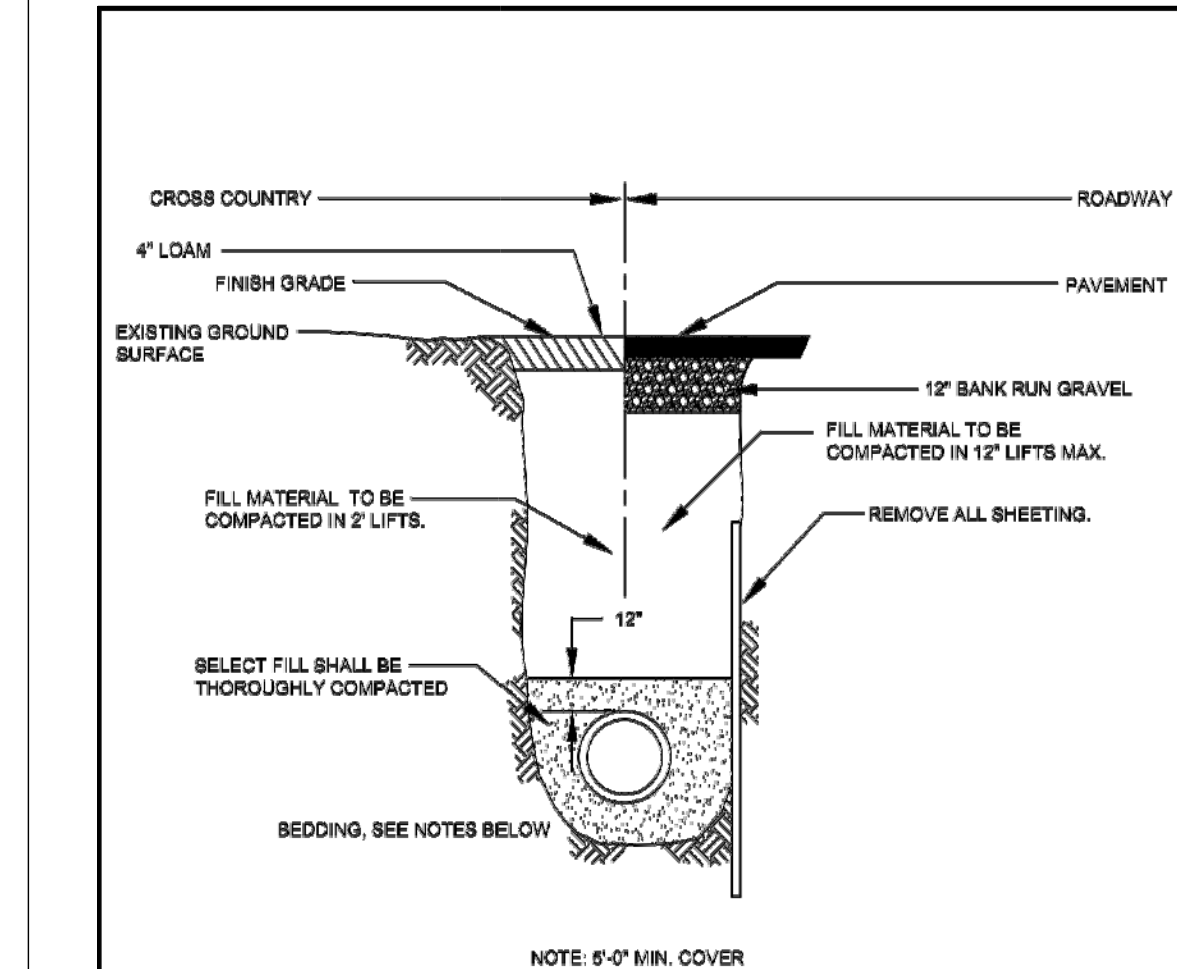

NOTE:
1. ALL INSTALLATIONS SHALL CONFORM TO TOWN OF ARLINGTON STANDARD WATER REGULATIONS & SPECIFICATIONS.
2. TOWN OF ARLINGTON MAY REQUIRE FLOWABLE FILL AT ITS DISCRETION.
3. FOR LOCATIONS WHERE LEDGE IS NOT ENCOUNTERED IN TRENCH, PIPE SHALL BE LAID ON SAND BEDDING CONSISTENT WITH AWWA GUIDELINES.
4. FOR LOCATIONS WHERE LEDGE IS ENCOUNTERED, SAND BEDDING SHALL BE MINIMUM OF 12\"/>

ARLINGTON ENGINEERING DIVISION	TYPICAL WATER MAIN TRENCH DETAIL	OCT. 2014	W-0006
		NOT TO SCALE REVISION ①	

NOTES

No.	Revision/Issue	Date

Town of
ARLINGTON
Engineering Division
51 Grove Street
Arlington, MA 02476

2017 WATER DISTRIBUTION SYSTEM IMPROVEMENTS
STANDARD CONSTRUCTION DETAILS

Project:	BID #17-32	Sheet:	10 of 10
Drawn By:	WCC		
Scale:	N.T.S.		
Date:	MAY 2017		