

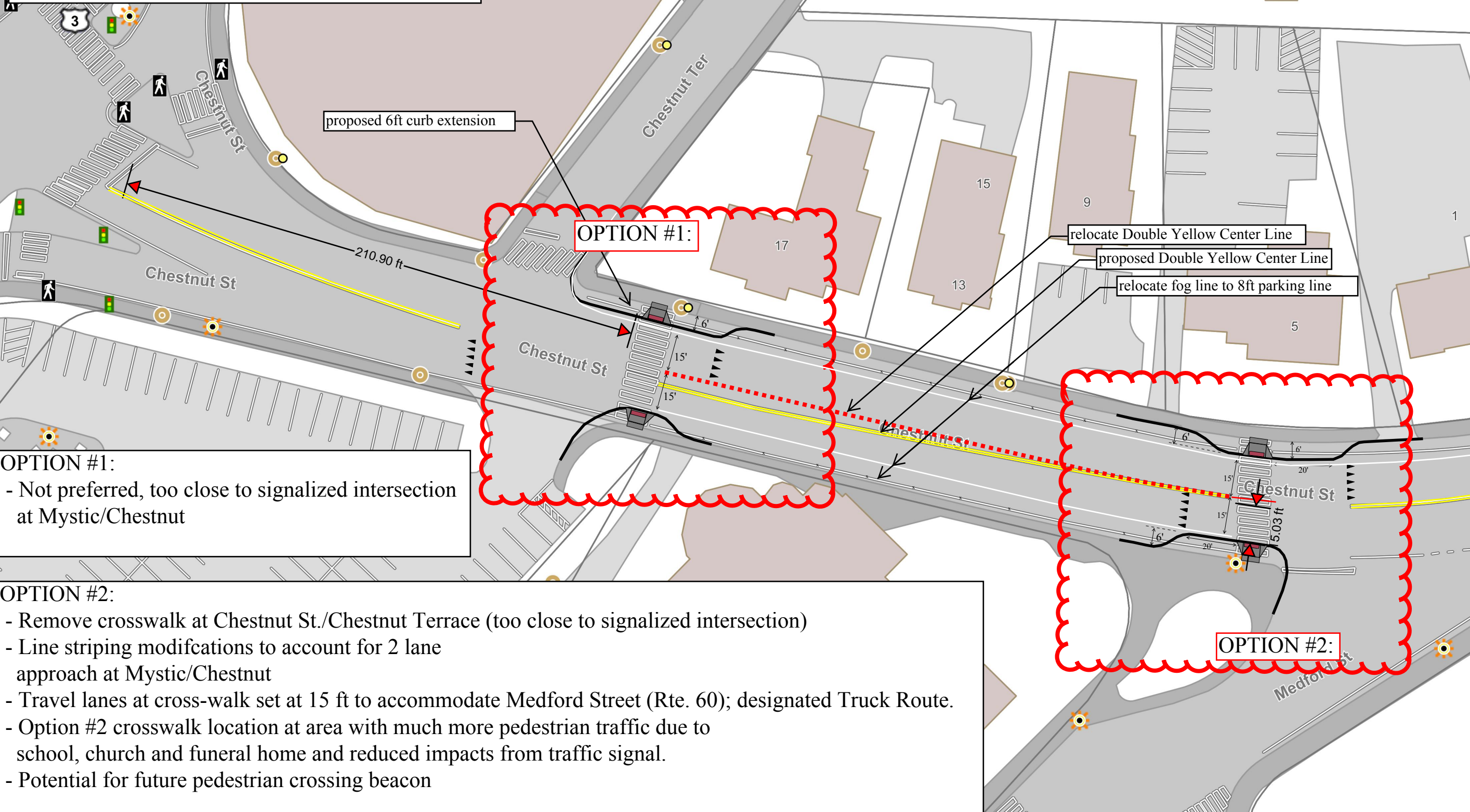

- Places by Category
 - Police Station
 - Fire Station
 - School
 - Library
 - Public Works
- Poles (All Pole Uses)
 - Lamp Pole
 - Utility Pole
 - Utility Pole with Street Light
 - Pedestrian Signal Pole
 - Traffic Signal Pole
 - Engineering - Drainage Plate Indicator
- Parcels
- Buildings
- Pavement Markings
 - MA Highways
 - Interstate
 - US Highway
 - Numbered Routes
 - Town Boundary
 - Abutting Towns
 - Cemetery - Roads
 - Road1
 - Road2
 - Road3
 - Road4
 - Impervious Surface - For Base Map
 - Street
 - Sidewalk
 - Street Island
 - Driveway
 - Parking Lot
 - Bike Path
 - Roads - For Large Scale (for Town)
 - Major Road
 - Local Road
 - Master Plan Base Map - Minutemen
 - Water Line
 - Water Body

Curb Extension Standards:

- 1) 6 ft extension form existing curb line
- 2) 20ft clear area for sight visibility approaching cross-walk



OPTION #1:

relocate Double Yellow Center Line

proposed Double Yellow Center Line

relocate fog line to 8ft parking line

OPTION #1:

- Not preferred, too close to signalized intersection at Mystic/Chestnut

OPTION #2:

- Remove crosswalk at Chestnut St./Chestnut Terrace (too close to signalized intersection)
- Line striping modifications to account for 2 lane approach at Mystic/Chestnut
- Travel lanes at cross-walk set at 15 ft to accommodate Medford Street (Rte. 60); designated Truck Route.
- Option #2 crosswalk location at area with much more pedestrian traffic due to school, church and funeral home and reduced impacts from traffic signal.
- Potential for future pedestrian crossing beacon

OPTION #2: