



Reservoir Committee of Envision Arlington

Date: Tuesday, August 18, 2020.

Time: 7:30 PM.

Location: Via Zoom

Attendance: Michael Ratner, George Stephans, Stephan Miller, Cathy Garnett, Johanna Meyer.

1. Check-ins and Observations from around the Res.
 - It is dry and the water is low everywhere.
 - There are ducks and geese-
 - The Sunny Garden is dry
 - Goldenrod and a purple Bee Balm were blooming in the Sunny Garden.
 - New Kiosk in the Rindge Park created by Owen Emsbo-Mattingly, Eagle Project from Troop 119
2. Review previous meeting notes. Reviewed and voted on Notes- Could be reviewed again if we did not meet quorum.
3. Updates:

- a. Reviewed Reservoir Masterplan

Two Public meetings since our last meeting.

Public Meeting #1

July 28th

Public Meeting #2

August 11th

Permitting

September – October

Construction Documentation

September – November

Construction Phase

October 2020 – October 2021

**Phase work to open beach for 2021 season

Project Completion

November 1, 2021

Why do you come to the Res?

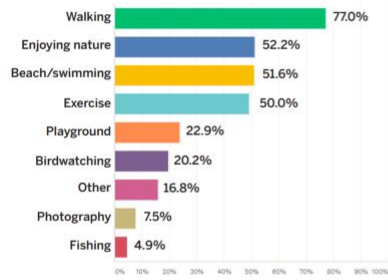

Other responses (write ins):

- Dog walking 81
- Jogging/running 10
- Bicycling 7
- Watching cross-country races 6

Do you typically buy a seasonal pass for the beach?

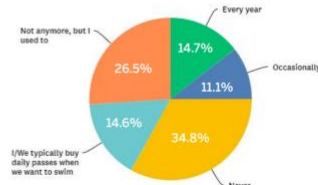

TOWN OF ARLINGTON

Playground Option 2 was recommended- separating by age areas and a tricycle path

- Combined play
- Several components
- Wooden equipment
- Rope course
- Shade via trees
- Paved walking path

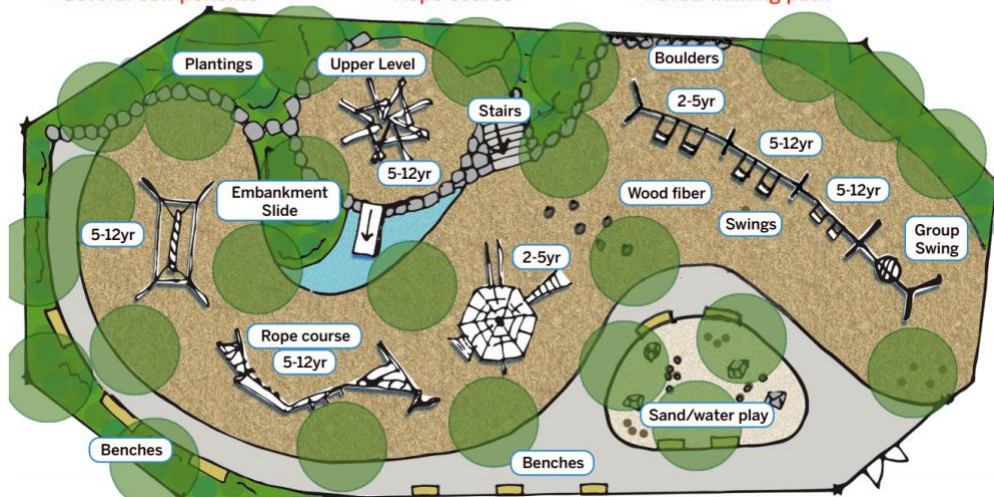

Parking Option 3 was recommended. With the walkway on the inside near the reservoir and one-way traffic through the lot. 67 spaces

67 Total Spaces



b. Beach Option 3 was recommended.

BEACH AREA CONCEPTS - FEEDBACK

PUBLIC MEETING #2
August 11, 2020

Preferred option:

- Allows access to berm for year-round walking
- Centralized playground with access to Lowell Street sidewalk
- Access to playground for non-beach-goers
- Maximize beach area
- Reconsider retaining walls at trees
- Location of picnic pavilion
- Location of volleyball

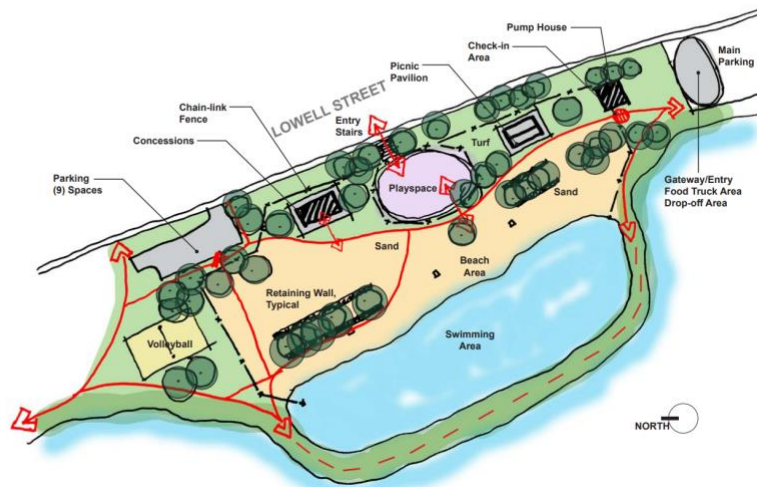

- c. Accessible path pilot- may start later this summer adjacent to the beach area.
- d. Water Chestnut harvesting $\frac{3}{4}$ or the area looks complete or all the higher water areas. The shallow water areas make it difficult to harvest especially as the water level is now down about a foot.

4. Ending Nature Deficit Disorder – We will review the materials more thoroughly and would like to know how they are engaged with the AMC nature education program or how they would integrate best with the Reservoir specifically. We would consider a short explanation of their work and a link to their website for more specific activities

5. Garden report. Watering need? Yes, seedlings- blue flags. Very Dry but there are flowers in the sunny garden. The shade garden seemed to be doing well.

6. Workday – Saturday, Aug **29, 9 to 12**

--Watering, Light weeding-Bindweed

7. Other Notes

Could one of the scout troops maintain the kiosk? No, scouts usually cannot commit to longer term maintenance projects.

Could there be another kiosk at the Rawson entrance or the Lowell entrance near the playground? There is some concern about who will maintain these structures and keep postings up to date.

Could we share splits from the Water St Park Herb Garden? Onions, sage, mint Lavender or other fragrant herbs?

Not discussed by group but for committee overview of Reservoir Plan

TRAIL MATERIALS

PUBLIC MEETING #1
July 28, 2020



- Needs re-grading, weeding and topdressing.
- Can be soft in spring thaw.
- Avoid installation on long pitches of 6% or greater



- Needs re-grading, weeding and topdressing.
- Can be soft in spring thaw.
- Avoid installation on long pitches of 6% or greater



- Slip resistant
- Resistant to freeze-thaw
- Accessibility: full
- Permeable system



- Slip resistant
- Resistant to freeze-thaw
- Accessibility: full
- Permeable system

Boating at the Res...

Do you boat at the Res?

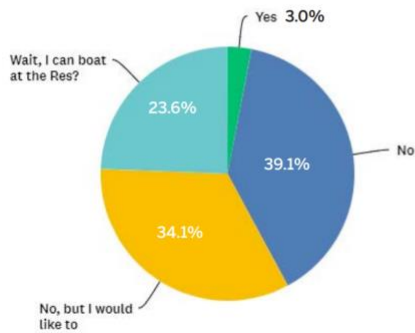

What kind of boat do you (or would you) bring to the Res?

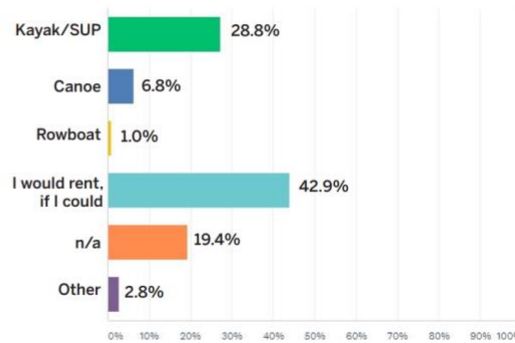

*Most popular write-in response was small sailboats

What age are the children that you bring to the playground?

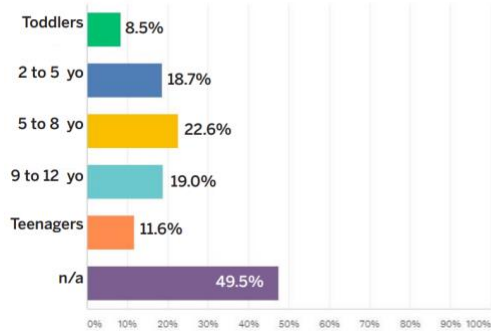

What type of playground would you like to see?

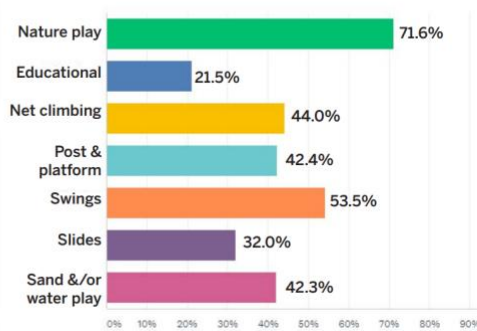

Interpretive signage

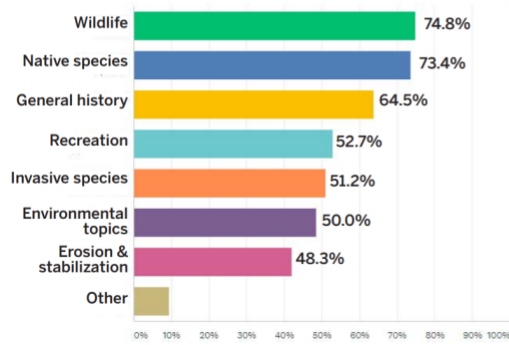

Other responses (write ins):

- Dog rules 15
- Less signage, more nature 9
- No signage, please 7
- Mile markers 5
- Wayfinding to destinations 5