

ARLINGTON RESERVOIR

Phase 2 Design & Implementation

PUBLIC MEETING #3

September 8, 2020



kzla

IMAGE COURTESY OF THE TOWN OF ARLINGTON

- **Main parking**
- **Beach area**
- **Playground**
- **Perimeter trail**
- **Reservoir bank**



THE PHASE 2 PROJECT

PUBLIC MEETING #3

September 8, 2020

- Filtration building
- Concession/bath house
- Picnic pavilion
- Seating
- Trail amenities
- Invasive species
- Fencing
- Access to beach
- Accessibility/inclusivity
- Playground
- Boating
- Fishing
- Volleyball
- Pickleball
- Signage
- New plantings
- Connections around the pond



PROJECT SCHEDULE

PUBLIC MEETING #3
September 8, 2020

Design & Community Engagement Process

June – August

Design Development (6 weeks)

July 1st – September 4th

Playground working group meeting #1

July 13th

Playground working group meeting #2

July 27th

Public Meeting #1

July 28th

Public Meeting #2

August 11th

Site walk with Commissioners

August 21st

Playground working group (Commissioners)

August 24th

Public Hearing

September 8th

Permitting

September – October

Site walk with Commissioners

September 4th

Construction Documentation

October – January

Construction Phase

January 2021 – October 2021

**Phase work to open beach for 2021 season

Project Completion

November 1, 2021



MAIN PARKING CONCEPTS

PUBLIC MEETING #3

September 8, 2020



TOWN OF ARLINGTON ARLINGTON RESERVOIR - PHASE 2



MAIN PARKING CONCEPTS - BOAT RAMP (ALTERNATIVE)

PUBLIC MEETING #3

September 8, 2020

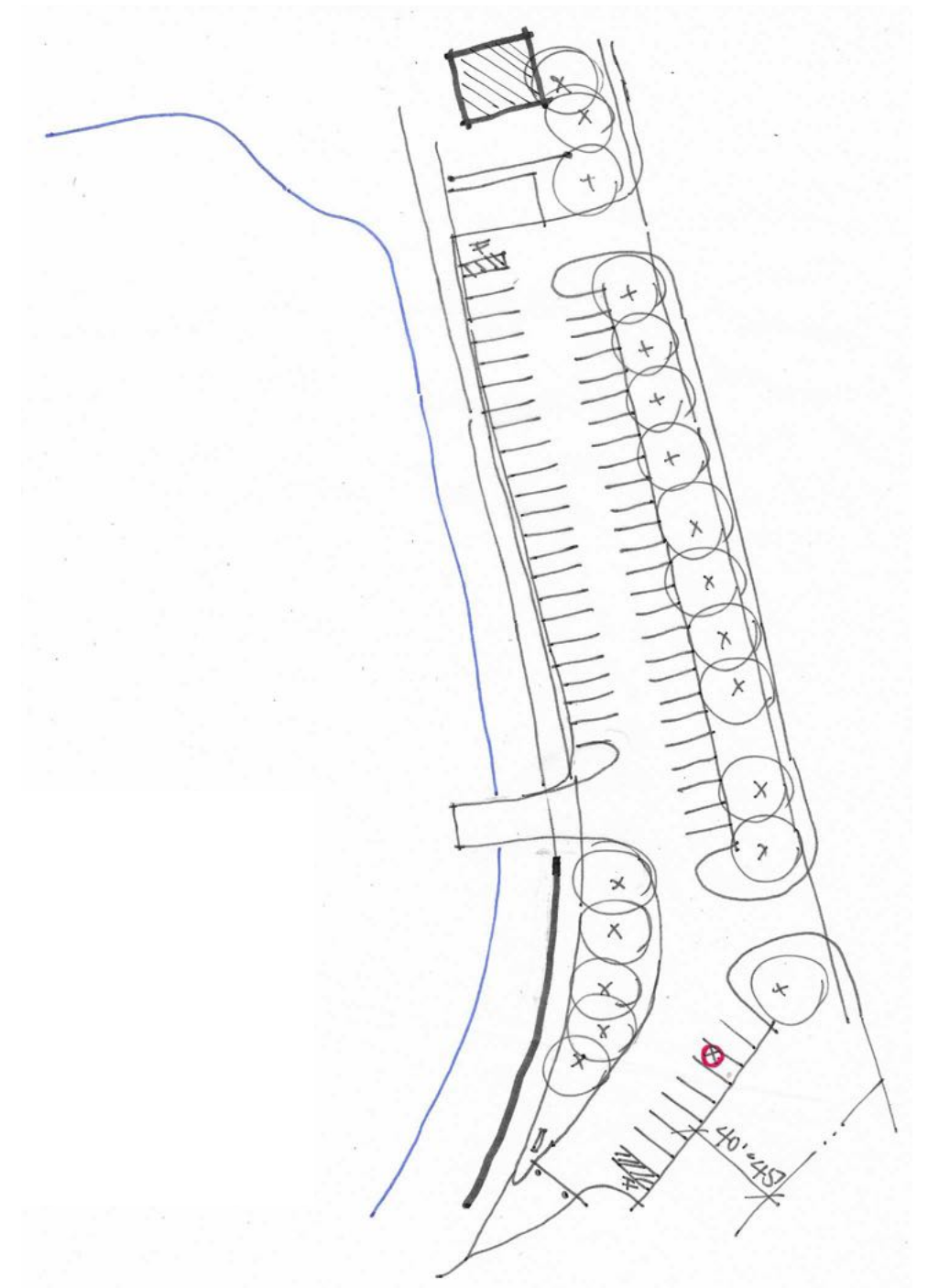
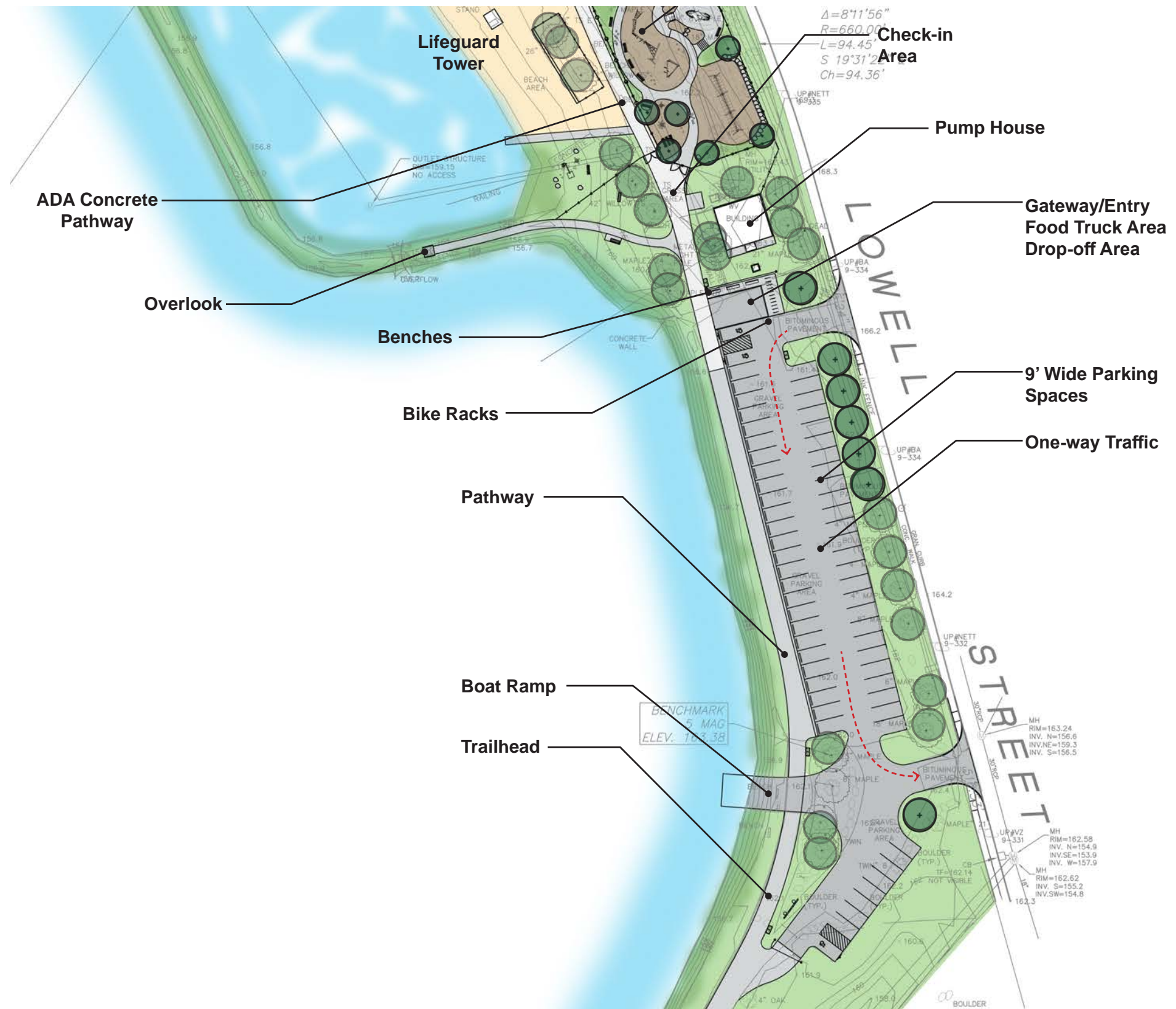

MAIN PARKING CONCEPTS - BOAT RAMP

PUBLIC MEETING #3
September 8, 2020



BEACH AREA CONCEPTS

PUBLIC MEETING #3
September 8, 2020



TOWN OF ARLINGTON ARLINGTON RESERVOIR - PHASE 2



TREES AT THE BEACH

PUBLIC MEETING #3
September 8, 2020



TOWN OF ARLINGTON
ARLINGTON RESERVOIR - PHASE 2



TREES AT THE BEACH

PUBLIC MEETING #3
September 8, 2020

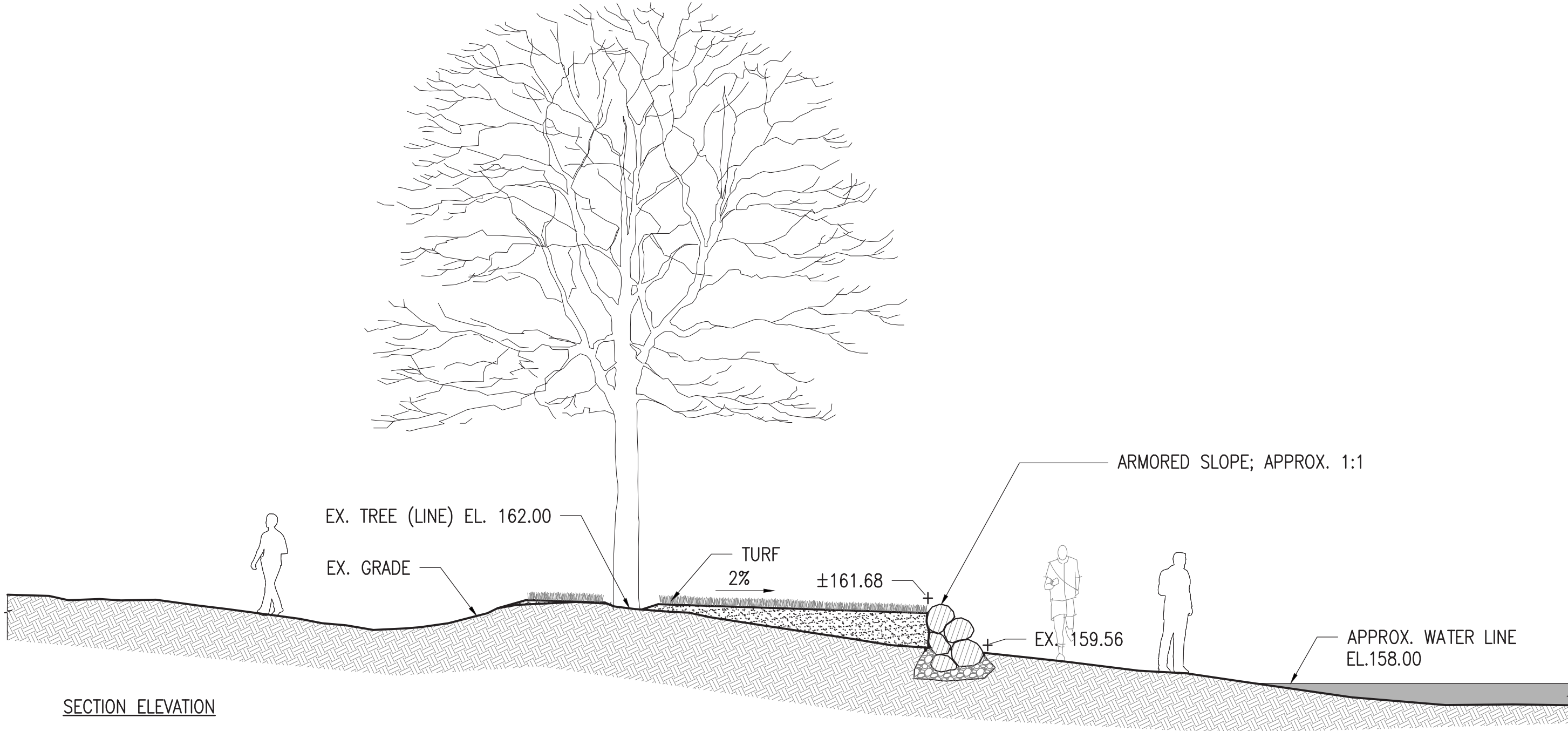

TREES AT THE BEACH

PUBLIC MEETING #3
September 8, 2020

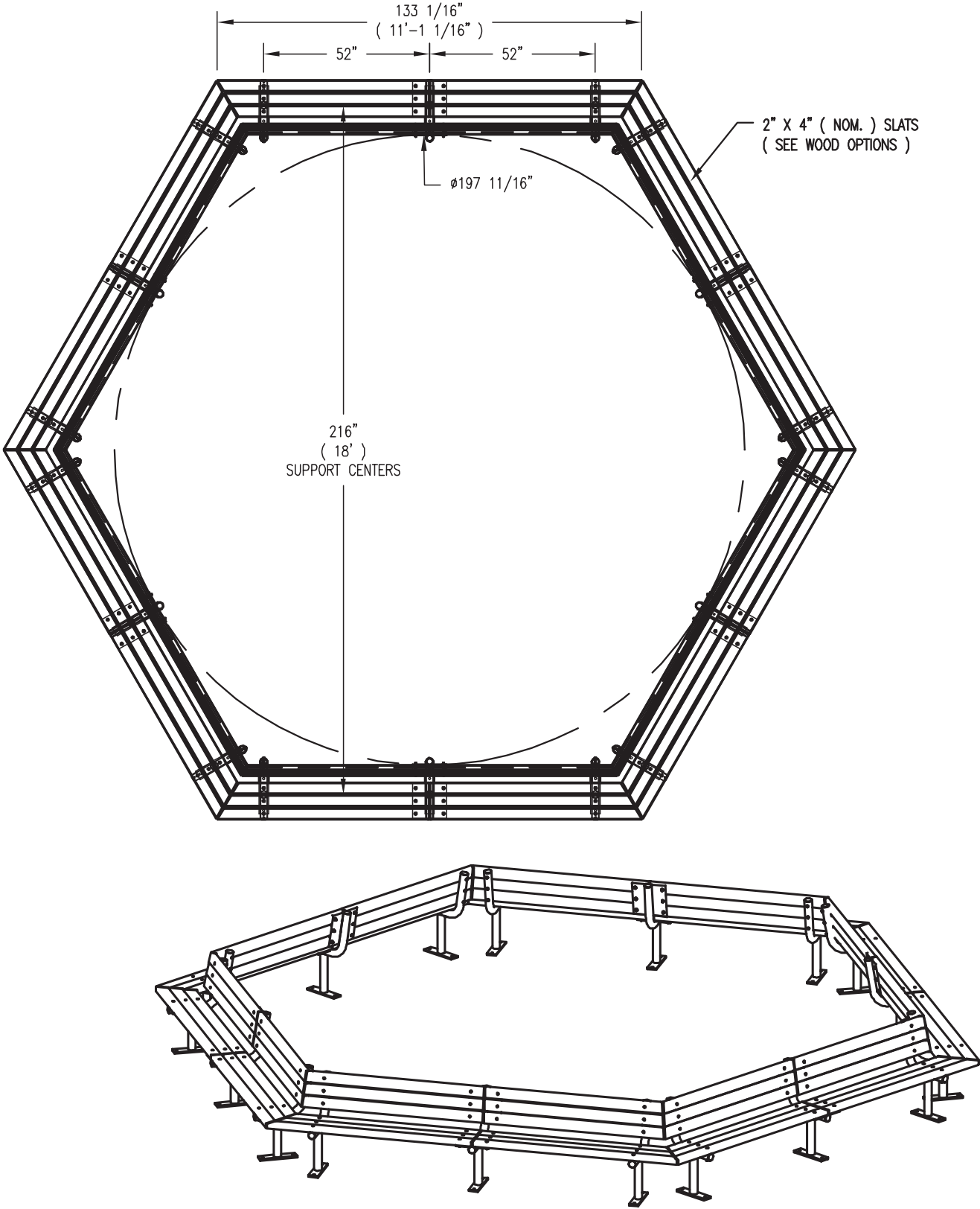

TREES AT THE BEACH

PUBLIC MEETING #3
September 8, 2020



TOWN OF ARLINGTON
ARLINGTON RESERVOIR - PHASE 2



SITE FURNISHINGS

PUBLIC MEETING #3
September 8, 2020



TOWN OF ARLINGTON
ARLINGTON RESERVOIR - PHASE 2



FLEXIBLE PLAY SPACE

PUBLIC MEETING #3

September 8, 2020



Image 1



Image 2



Image 3

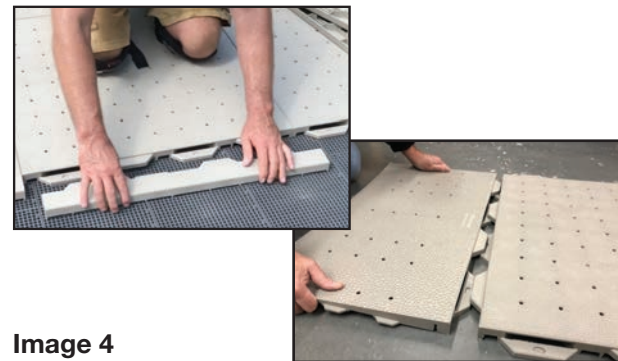
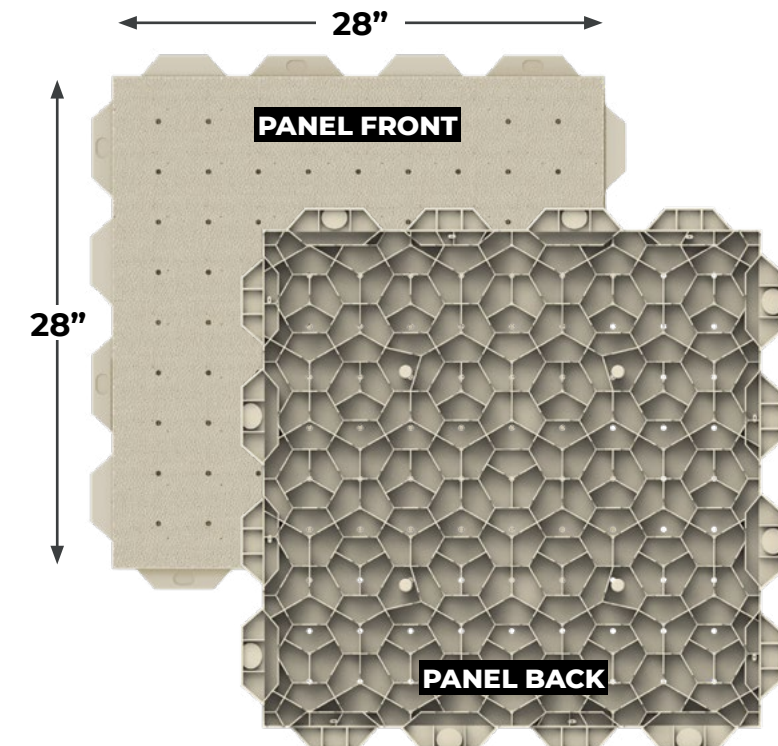
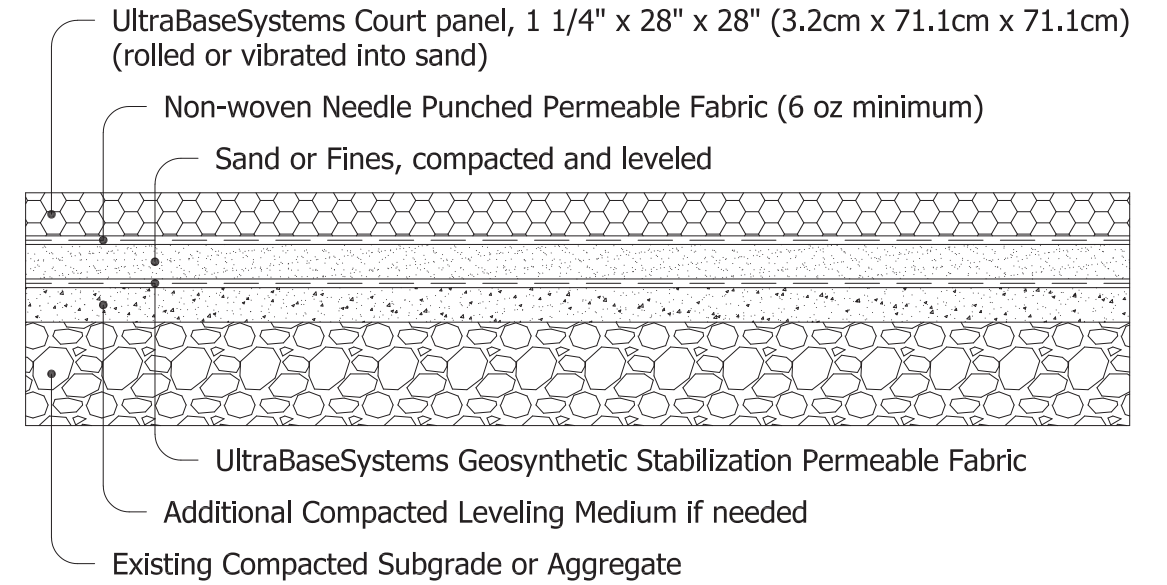

Image 4



TOWN OF ARLINGTON ARLINGTON RESERVOIR - PHASE 2



BEACH AREA CONCEPTS

PUBLIC MEETING #3

September 8, 2020



TOWN OF ARLINGTON
ARLINGTON RESERVOIR - PHASE 2



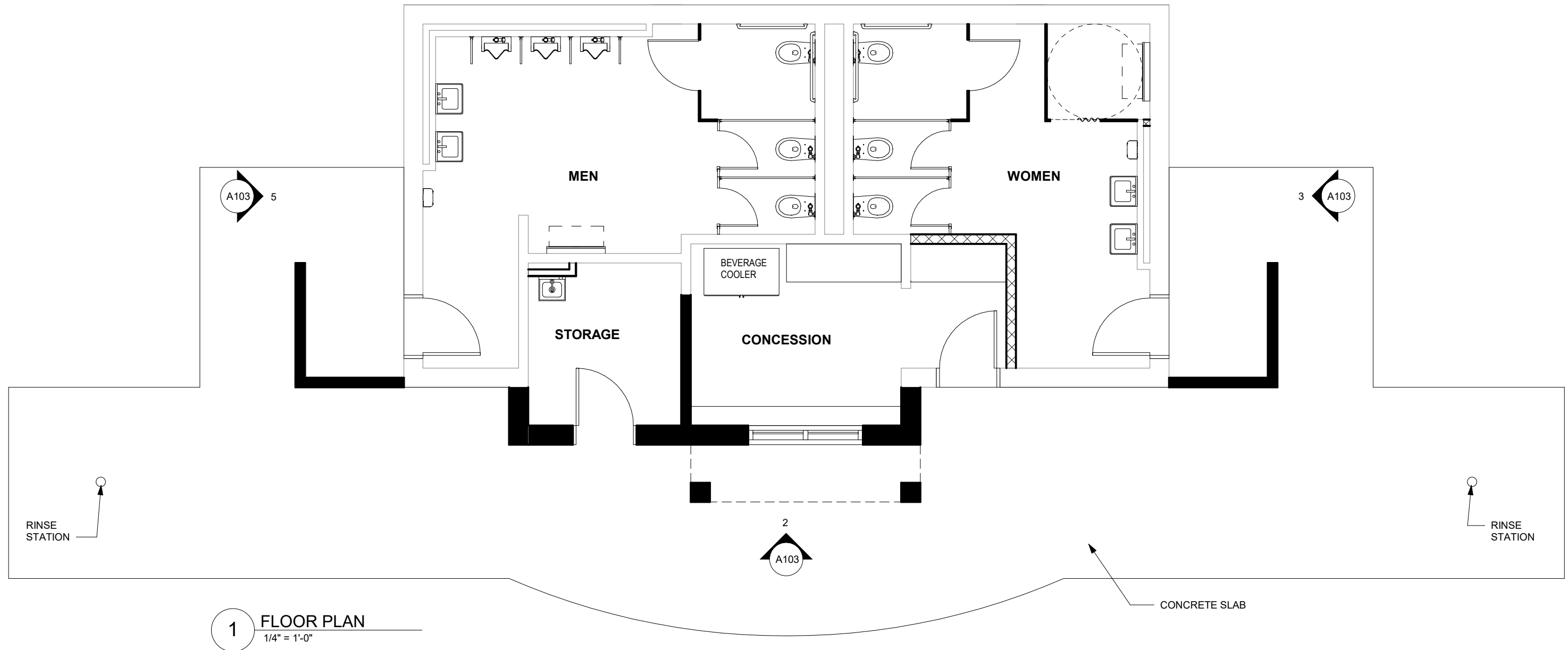

BEACH AREA CONCEPTS

PUBLIC MEETING #3
September 8, 2020

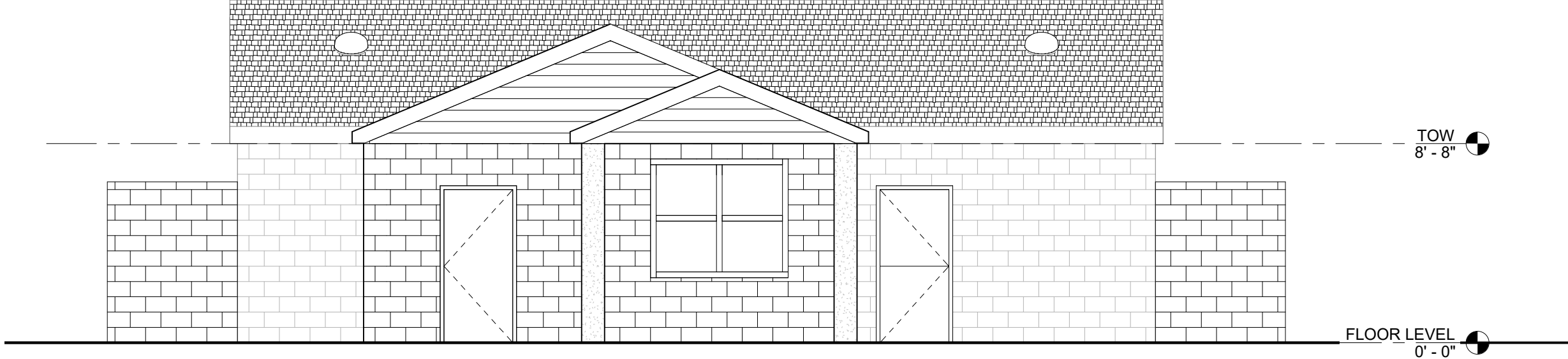

2 WEST ELEVATION
1/4" = 1'-0"

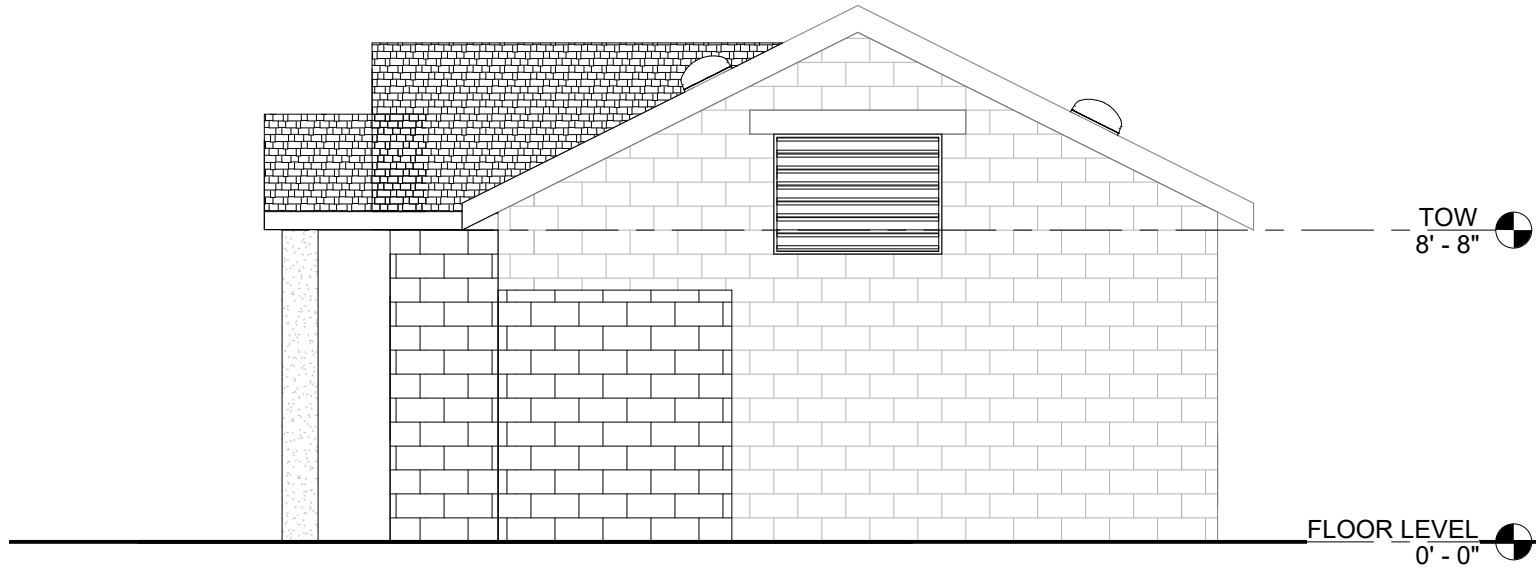

3 NORTH ELEVATION
1/4" = 1'-0"

PLAYGROUND CONCEPT

PUBLIC MEETING #3

September 8, 2020

- Combined play
- Several components
- Wooden equipment
- Rope course
- Shade via trees
- Paved walking path

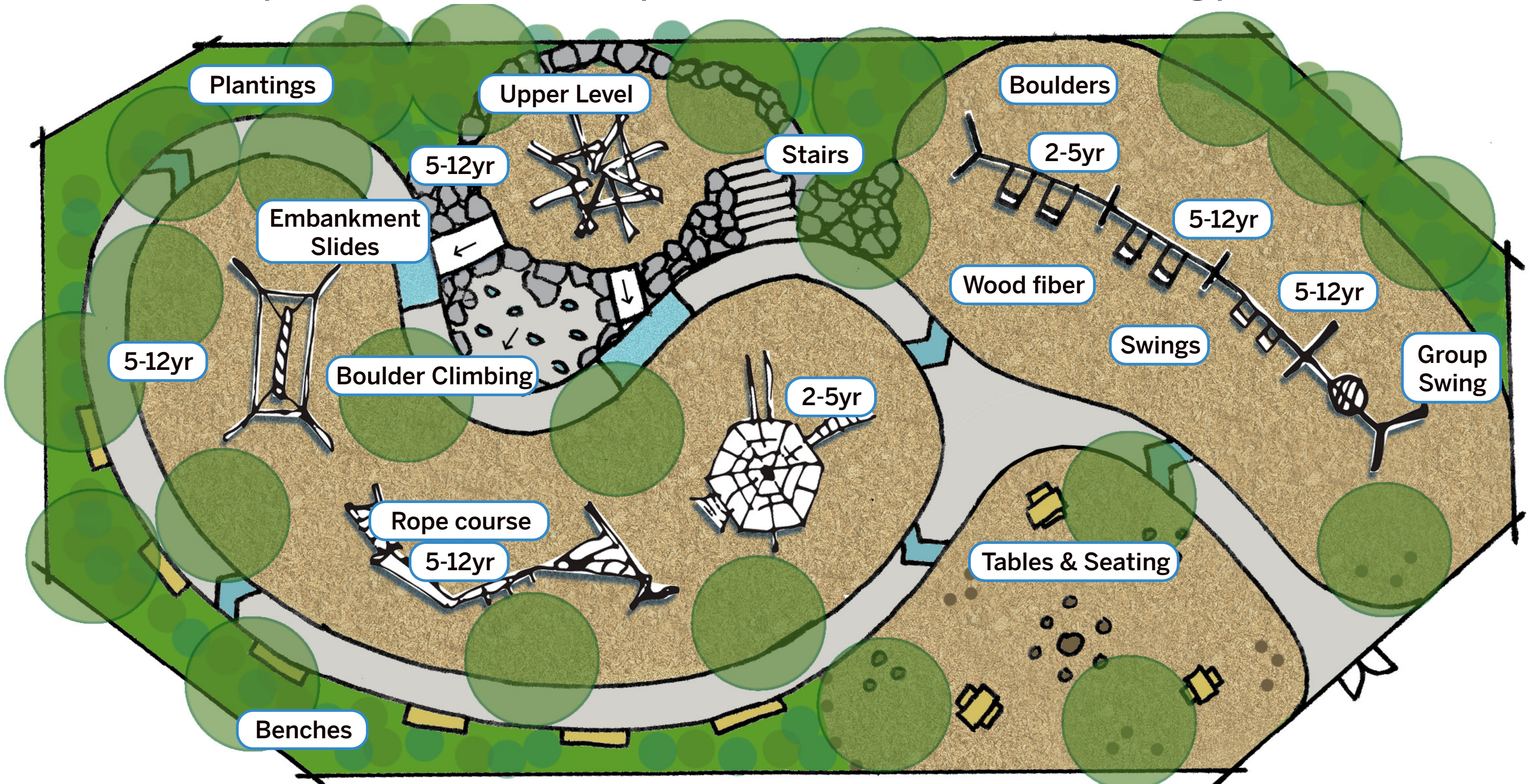

PLAYGROUND CONCEPT - EQUIPMENT

PUBLIC MEETING #3
September 8, 2020



Boat (8' ht)



Parkour (9' ht)



Climbing structure



Spring riders



Belt Swings

**Group Swings (nest)
(accessible)**

*Available with traditional
ADA molded seat



Pendulum Swing

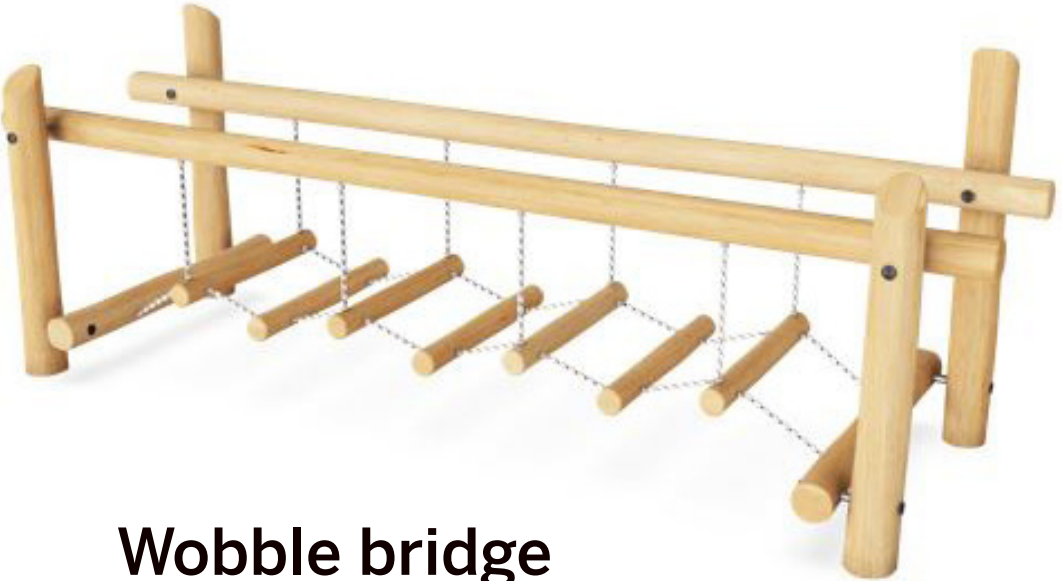

Wobble bridge

PLAYGROUND CONCEPT - EQUIPMENT

PUBLIC MEETING #3

September 8, 2020



Boulders/climbing



Playful seating

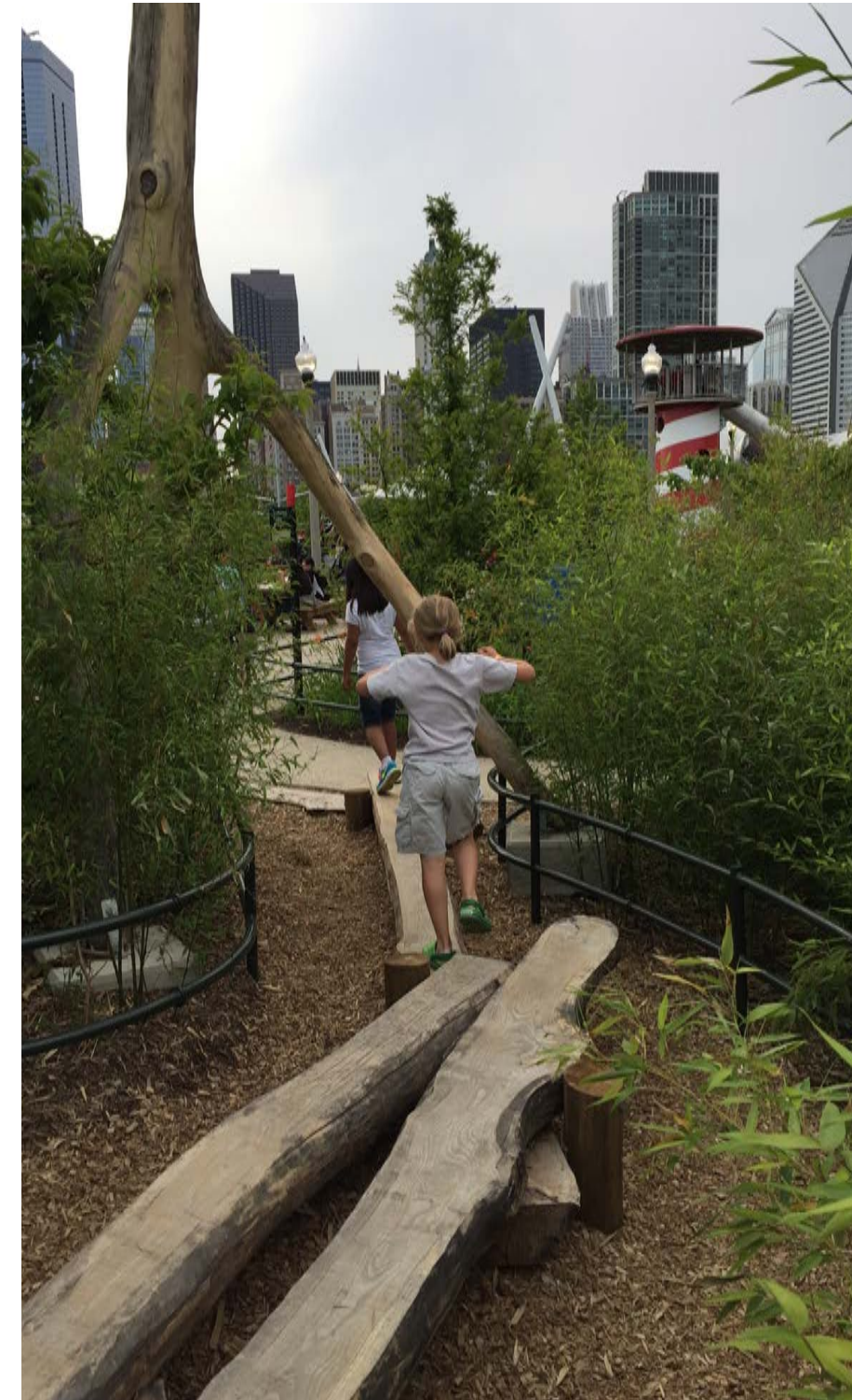

Nature play



Picnic tables & benches



Tricycle track

PLAYGROUND CONCEPTS - SAND & WATER PLAY

PUBLIC MEETING #3
September 8, 2020



PERIMETER TRAIL - CONNECTIONS

PUBLIC MEETING #3

September 8, 2020



TOWN OF ARLINGTON ARLINGTON RESERVOIR - PHASE 2



PERIMETER TRAIL - SURFACES

PUBLIC MEETING #3

September 8, 2020



Stonedust
Approximately
\$6/sf

- Needs re-grading, weeding and topdressing.
- Can be soft in spring thaw.
- Avoid installation on long pitches of 6% or greater
- Accessibility: full with maintenance



Stabilized Stonedust
Approximately
\$8/sf

- Needs re-grading, weeding and topdressing.
- Can be soft in spring thaw.
- Avoid installation on long pitches of 6% or greater
- Accessibility: full with maintenance

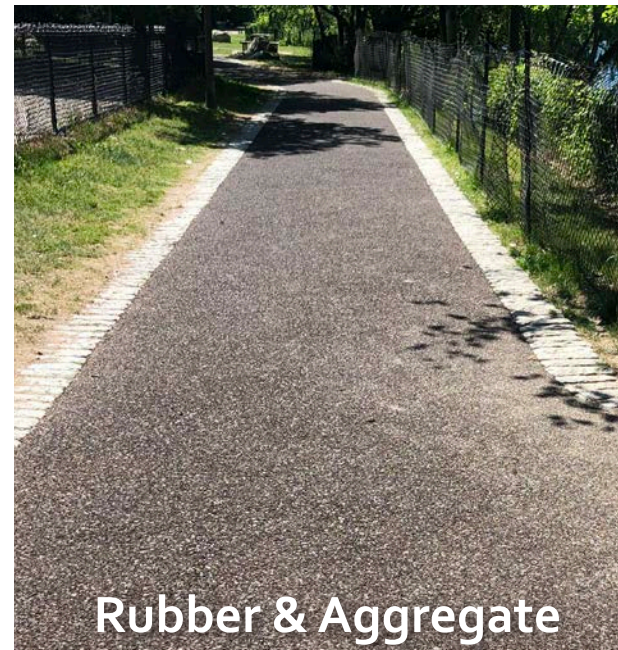

Rubber & Aggregate
Approximately
\$20/sf

- Slip resistant
- Resistant to freeze-thaw
- Accessibility: full
- Permeable system



Poured Rubber
Approximately
\$25/sf

- Slip resistant
- Resistant to freeze-thaw
- Accessibility: full
- Permeable system

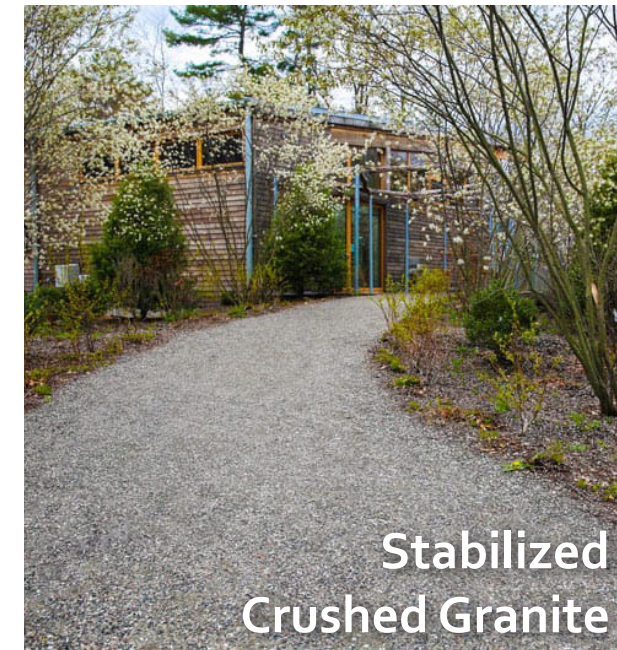

**Stabilized
Crushed Granite**
Approximately
\$8/sf

- Needs re-grading, weeding and topdressing.
- Can be soft in spring thaw.
- Avoid installation on long pitches of 6% or greater
- Accessibility: full with maintenance

PERIMETER TRAIL - OVERLOOK/FISHING PIER

PUBLIC MEETING #3
September 8, 2020

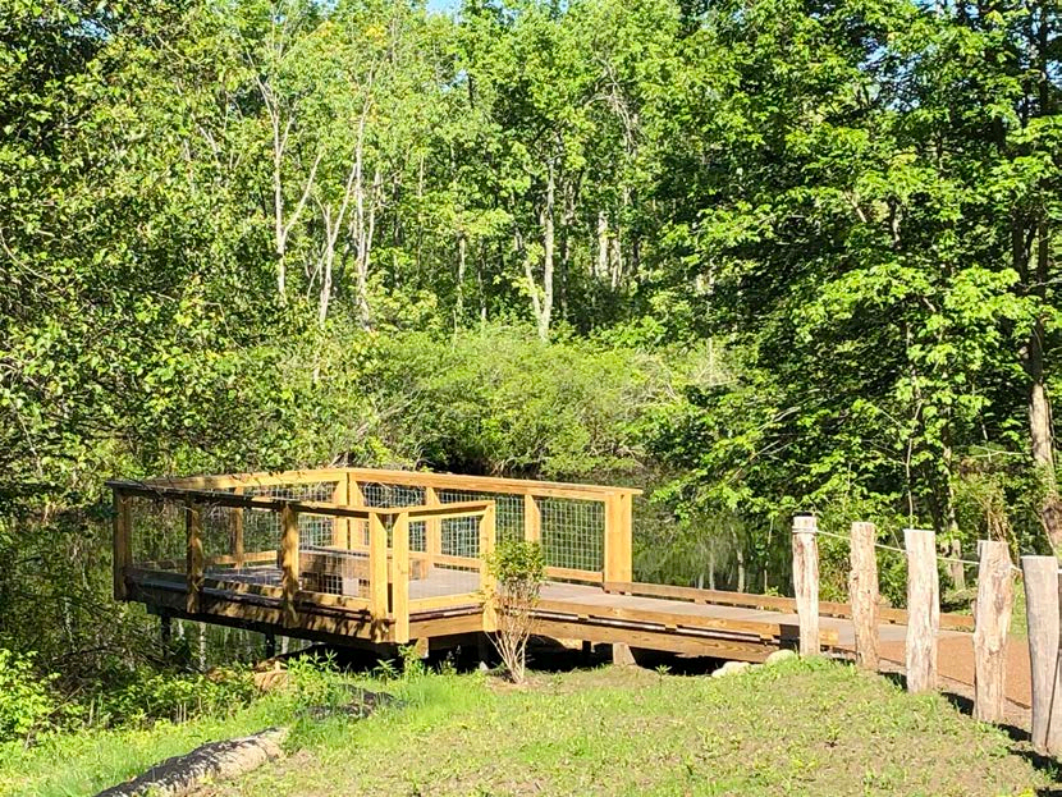

TOWN OF ARLINGTON
ARLINGTON RESERVOIR - PHASE 2











RESERVOIR BANK

PUBLIC MEETING #3

September 8, 2020

LEGEND

-  PROPERTY LINES
-  EX. MAJOR CONTOUR (5' INTERVAL)
-  EX. MINOR CONTOUR (1' INTERVAL)
-  AREA 'A' BANK RESTORATION: > 12" VERTICAL BANK CUT - ACTION PROPOSED
-  AREA 'B' BANK RESTORATION: < 12" VERTICAL BANK CUT - ACTION PROPOSED
-  AREA 'C' BANK RESTORATION: STABLE SLOPE - REVEGETATION PROPOSED
-  AREA 'D' BANK RESTORATION: STABLE SLOPE - NO ACTION PROPOSED
-  SIGNIFICANT INVASIVE POPULATION AREA



TOWN OF ARLINGTON ARLINGTON RESERVOIR - PHASE 2



RESERVOIR BANK

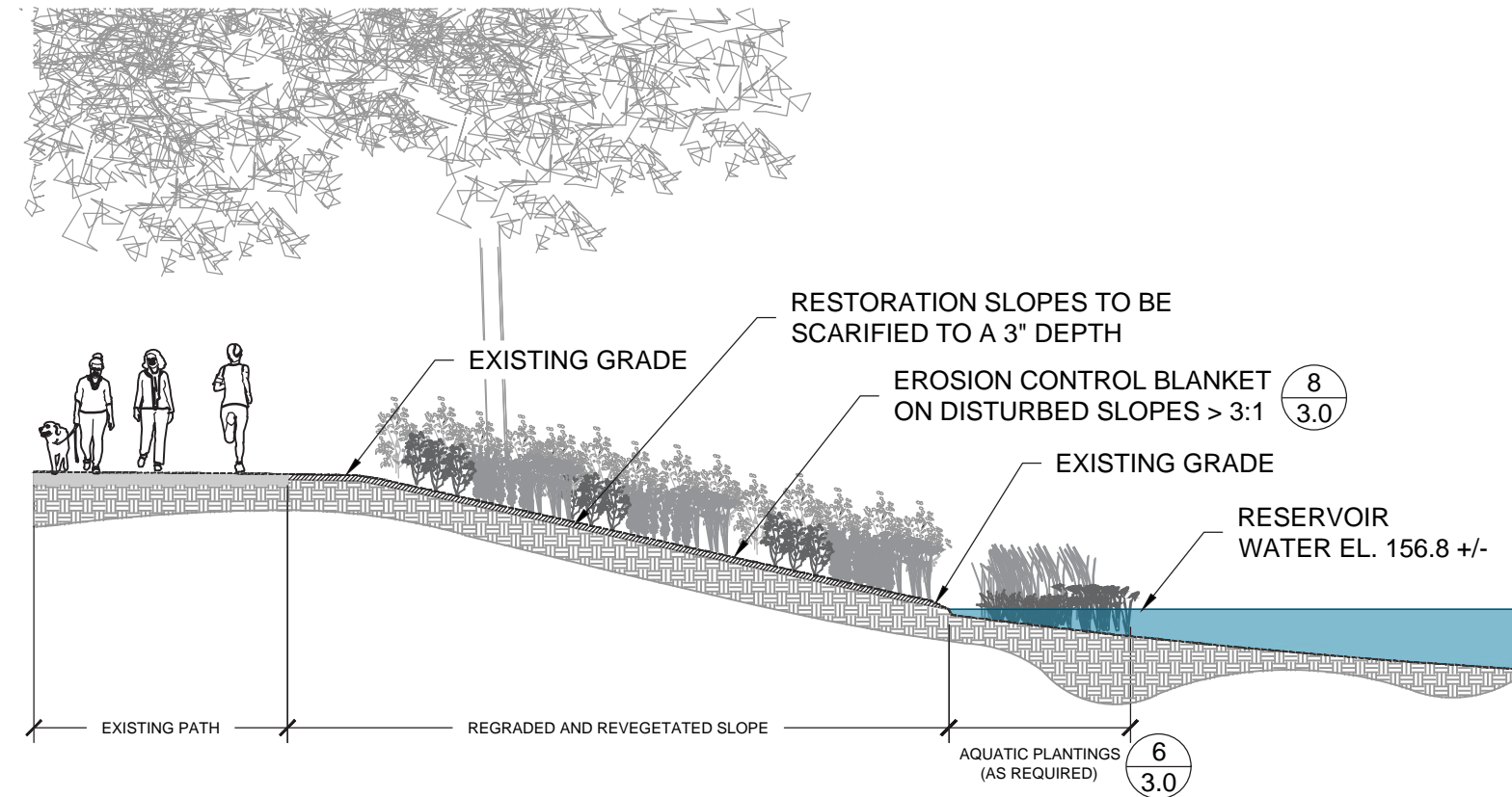
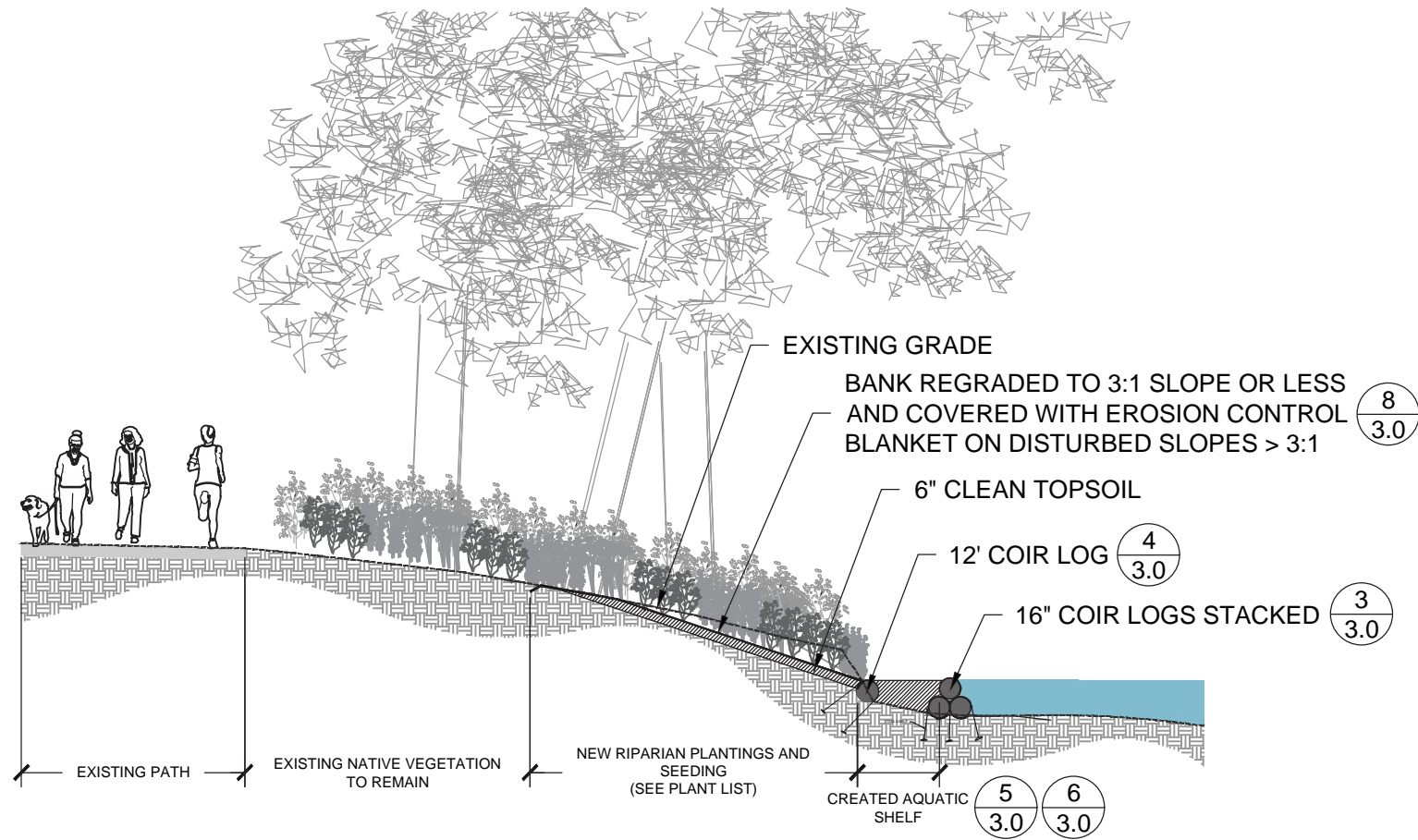

1 AREA 'A' BANK RESTORATION: > 12" VERTICAL BANK CUT (TYP.)
Scale: NTS

3 AREA 'C' BANK RESTORATION: STABLE SLOPE - REVEGETATION (TYP.)
Scale: NTS

PROJECT SCHEDULE - NEXT STEPS

PUBLIC MEETING #3
September 8, 2020

Design & Community Engagement Process	June – August
Design Development	July – September
100% DD Set	September 18 th
Cost Estimate	Early October
Permitting	September – October
Construction Documentation	September – January
Construction Phase	January 2021 – October 2021
**Phase work to open beach for 2021 season	
<u>Project Completion</u>	<u>November 1, 2021</u>

