

ARLINGTON RESERVOIR

Phase 2 Design & Implementation

PUBLIC MEETING #4

October 27, 2020



Schematic Design & Community Engagement Process

June – August

Design Development

Playground working group meeting #1

Playground working group meeting #2

Public Meeting #1

Public Meeting #2

Site walk with Commissioners

Playground working group (Commissioners)

Site walk with Commissioners

Public Meeting #3

100% DD Set

Site walk with Commissioners

DD Cost Estimate

Public Meeting #4

July 1st – September 4th

July 13th

July 27th

July 28th

August 11th

August 21st

August 24th

September 4th

September 8th

September 18th

October 16th

October 26th

October 27th

- **Perimeter trail & connections**
- **Invasive species & bank stabilization**
- **Main parking**
- **Beach area & playground**
- **Site amenities**



THE PHASE 2 PROJECT

PUBLIC MEETING #4

October 27, 2020



TOWN OF ARLINGTON ARLINGTON RESERVOIR - PHASE 2



PERIMETER TRAIL: CONNECTIONS

PUBLIC MEETING #4

October 27, 2020



TOWN OF ARLINGTON ARLINGTON RESERVOIR - PHASE 2



PERIMETER TRAIL & CONNECTIONS

PUBLIC MEETING #4
October 27, 2020



EXISTING STONEDUST TRAIL SURFACE



STABILIZED CRUSHED GRANITE TRAIL SURFACE

PERIMETER TRAIL & CONNECTIONS

PUBLIC MEETING #4
October 27, 2020



TIMBER CRIBBING STEPS

TOWN OF ARLINGTON
ARLINGTON RESERVOIR - PHASE 2



PERIMETER TRAIL: OVERLOOK/FISHING PIER

PUBLIC MEETING #4

October 27, 2020



TIMBER
OVERLOOK
EXAMPLE



OVERLOOK LOCATION & VIEWSHED



INVASIVE SPECIES & BANK STABILIZATION

PUBLIC MEETING #4

October 27, 2020

LEGEND

- PROPERTY LINES
- EX. MAJOR CONTOUR (5' INTERVAL)
- EX. MINOR CONTOUR (1' INTERVAL)
- TOB TOP OF BANK
- 100' TOP OF BANK BUFFER
- AREA 'A' BANK RESTORATION: > 12" VERTICAL BANK CUT - ACTION PROPOSED
- AREA 'B' BANK RESTORATION: < 12" VERTICAL BANK CUT - ACTION PROPOSED
- AREA 'C' BANK RESTORATION: STABLE SLOPE - REVEGETATION PROPOSED
- AREA 'D' BANK RESTORATION: STABLE SLOPE - NO ACTION PROPOSED
- AE AE FLOOD ZONE: 1% ANNUAL CHANCE OF FLOODING, WITH BASE FLOOD ELEVATION
- EMBANKMENT

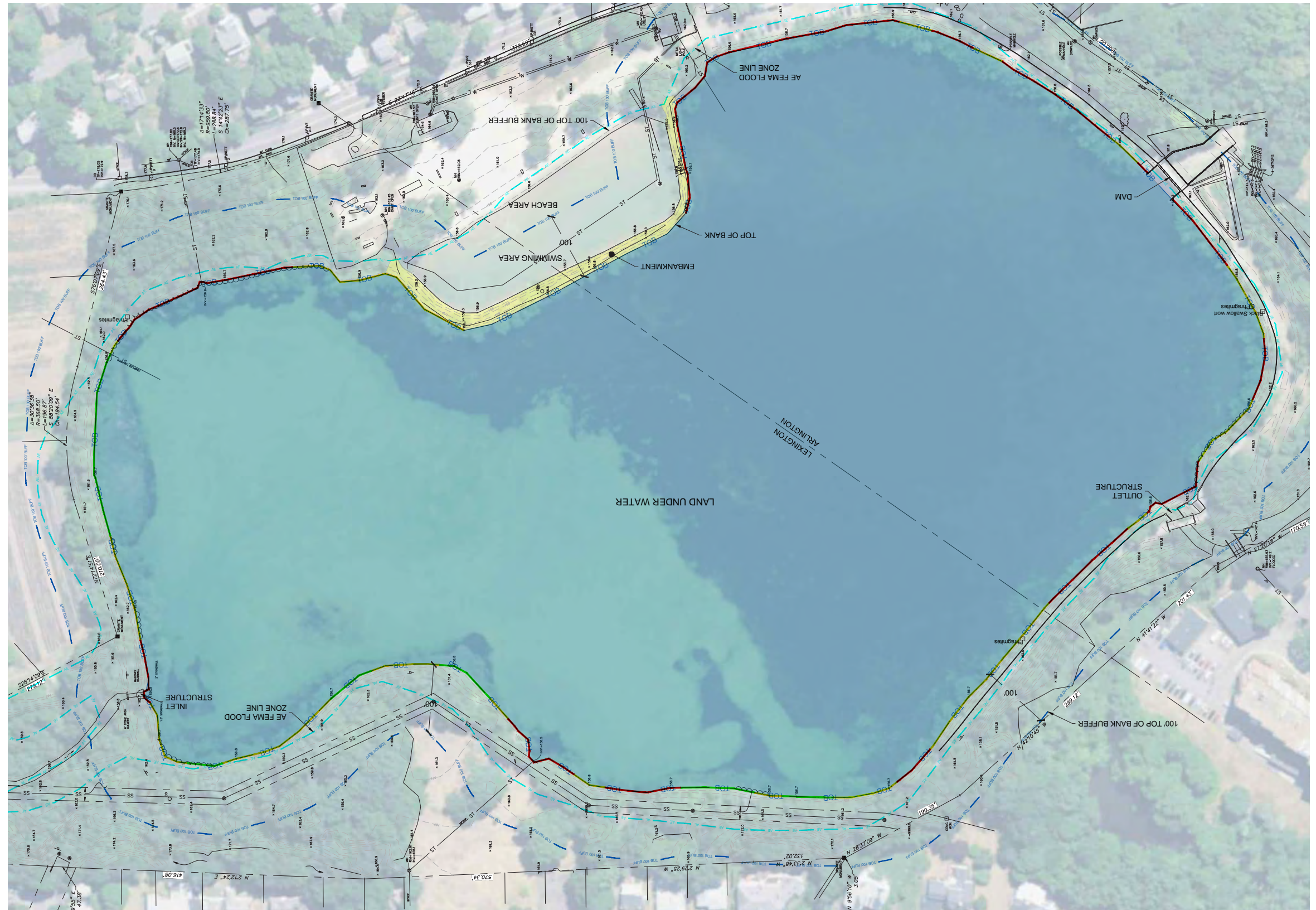

TOWN OF ARLINGTON ARLINGTON RESERVOIR - PHASE 2











INVASIVE SPECIES & BANK STABILIZATION

PUBLIC MEETING #4

October 27, 2020

LEGEND

-  PROPERTY LINES
-  EX. MAJOR CONTOUR (5' INTERVAL)
-  EX. MINOR CONTOUR (1' INTERVAL)
-  AREA 'A' BANK RESTORATION: > 12" VERTICAL BANK CUT - ACTION PROPOSED
-  AREA 'B' BANK RESTORATION: < 12" VERTICAL BANK CUT - ACTION PROPOSED
-  AREA 'C' BANK RESTORATION: STABLE SLOPE - REVEGETATION PROPOSED
-  AREA 'D' BANK RESTORATION: STABLE SLOPE - NO ACTION PROPOSED
-  SIGNIFICANT INVASIVE POPULATION AREA



- AREA A: 30,450 SF/2,030 LF
- AREA B: 26,100 SF/1,740 LF
- AREA C: 1,950 SF/130 LF
- AREA D: 10,200 SF/680 LF

TOWN OF ARLINGTON
ARLINGTON RESERVOIR - PHASE 2



INVASIVE SPECIES & BANK STABILIZATION

PUBLIC MEETING #4

October 27, 2020

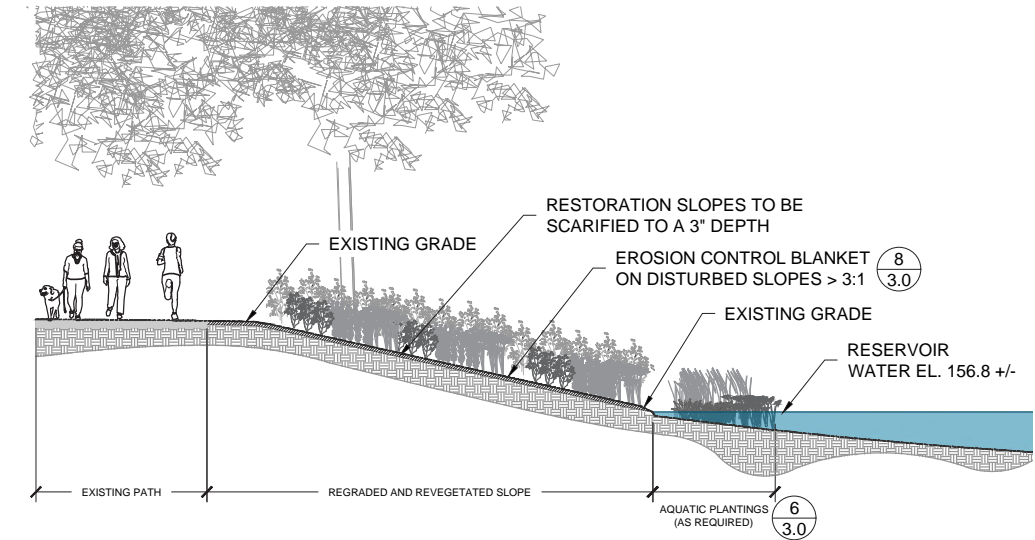
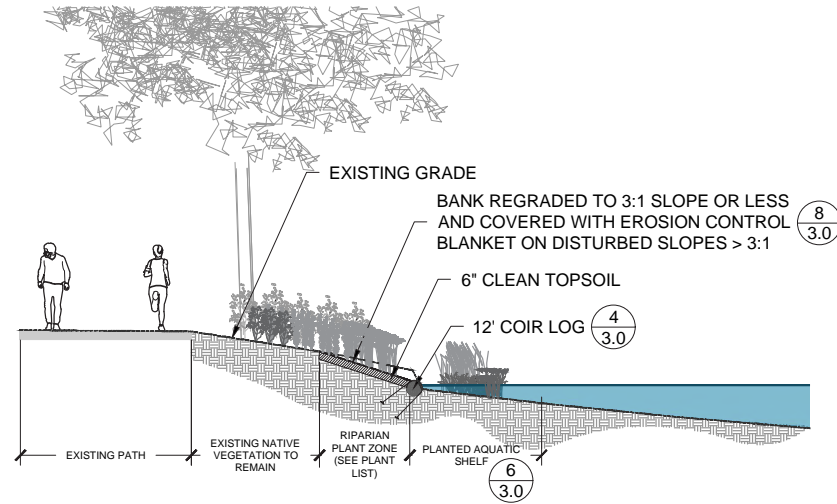
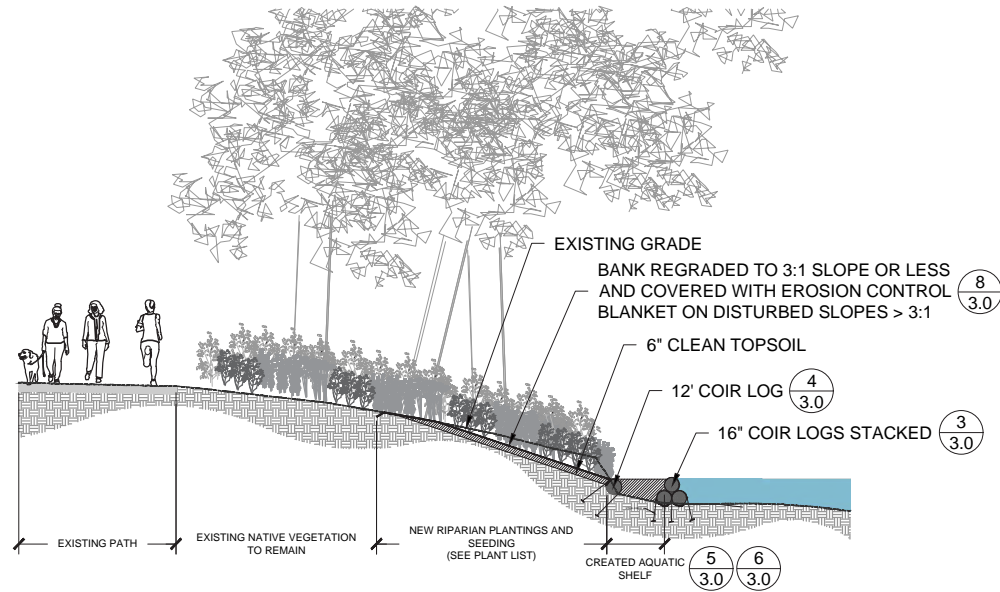

1 AREA 'A' BANK RESTORATION: > 12" VERTICAL BANK CUT (TYP.)
Scale: NTS

2 AREA 'B' BANK RESTORATION: < 12" VERTICAL BANK CUT (TYP.)
Scale: NTS

3 AREA 'C' BANK RESTORATION: STABLE SLOPE - REVEGETATION (TYP.)
Scale: NTS

PLANT RESTORATION SCHEDULE

Cover Type	Abbrev.	Scientific Name	Common Name	Plant Size @ Installation	Area 'A'	Area 'B'	Area 'C'	Area 'D'
Total Enhancement Area (lf)					2,030	1,740	130	680
Total Enhancement Area Approx. (sf)					30,450	26,100	1,950	10,200
Trees								
	Ar	<i>Acer rubrum</i>	Red Maple	4'-6' ht. min.	11	9	3	--
	Ba	<i>Betula alleghaniensis</i>	Yellow Birch	4'-6' ht. min.	11	9	--	--
	Bp	<i>Betula populifolia</i>	Grey Birch	4'-6' ht. min.	11	9	--	--
	Ns	<i>Nyssa sylvatica</i>	Black Gum	4'-6' ht. min.	11	9	3	--
	Pd	<i>Populus deltoides</i>	Cottonwood	4'-6' ht. min.	11	9	--	--
	Qr	<i>Quercus rubra</i>	Red Oak	4'-6' ht. min.	11	9	3	--
	Sd	<i>Salix discolor</i>	Pussywillow	4'-6' ht. min.	11	9	3	--
	Sn	<i>Salix nigra</i>	Black Willow	4'-6' ht. min.	11	9	3	--
Shrubs								
	Ca	<i>Clethra alnifolia</i>	Sweet Pepperbush	3'-4' ht. min.	33	27	6	--
	Cs	<i>Comus sencea</i>	Red Osier Dogwood	3'-4' ht. min.	33	27	6	--
	Iv	<i>Ilex verticillata</i>	Winterberry	3'-4' ht. min.	33	27	6	--
	Vd	<i>Viburnum dentatum</i>	Northern Arrowwood	3'-4' ht. min.	33	27	6	--
Herbaceous								
- Shoreline/Fringe	Cp	<i>Caltha palustris</i>	Marsh Marigold	2" plug	2,100	1,800	150	--
	Ep	<i>Eupatorium perfoliatum</i>	Boneset Aster	2" plug	2,100	1,800	150	--
	Mr	<i>Mimulus ringens</i>	Monkey Flower	2" plug	2,100	1,800	150	--
- Water Depth 0'-6"	Am	<i>Acorus americana</i>	Sweetflag	2" plug	2,100	1,800	150	--
	Lc	<i>Lobelia cardinalis</i>	Cardinal Flower	2" plug	2,100	1,800	150	--
	Iv	<i>Iris versicolor</i>	Blue Flag Iris	2" plug	2,100	1,800	150	--
- Water Depth 6"-8"	Pc	<i>Pontederia cordata</i>	Pickersweed	2" plug	1,350	1,050	450	--
	Sa	<i>Schoenoplectus acutus</i>	Hard-stem Bulrush	2" plug	1,350	1,050	450	--
	Sc	<i>Scirpus cyperinus</i>	Woolgrass	2" plug	1,350	1,050	450	--
	Sl	<i>Sagittaria latifolia</i>	Duck Potato	2" plug	1,350	1,050	450	--
	Sm	<i>Sparganium americanum</i>	Burreed	2" plug	1,350	1,050	450	--
- Water Depth > 3'	No	<i>Nymphaea odorata</i>	White Water Lily	tuber		5,220	5,850	--
Seed Mix								
New England Erosion Control/Restoration Mix For Detention Basins and Moist Sites (Lbs)				18lbs/acre	13.0	11.0	1.0	--

New England Semi-Shadow Grass and Forbs Mix

Botanical Name	Common Name	Indicator
<i>Elymus virginicus</i>	Virginia Wild Rye	FACW-
<i>Elymus canadensis</i>	Canada Wild Rye	FACU+
<i>Festuca rubra</i>	Red Fescue	FACU
<i>Chamaecrista fasciculata</i>	Partridge Pea	FACU
<i>Liatris spicata</i>	Spiked Gayfeather/Marsh Blazing Star	FAC+
<i>Onoclea sensibilis</i>	Sensitive Fern	FACW
<i>Aster prenanthoides (Symphyotrichum prenanthoides)</i>	Zigzag Aster	FAC
<i>Eupatorium fistulosum (Eutrochium fistulosum)</i>	Hollow-Stem Joe Pye Weed	FACW
<i>Eupatorium perfoliatum</i>	Boneset	FACW
<i>Juncus tenuis</i>	Path Rush	FAC

Apply: 30 lbs/acre

MAIN PARKING AREA

PUBLIC MEETING #4

October 27, 2020



ARLINGTON RESERVOIR - PHASE 2



MAIN PARKING AREA: ENTRY



MAIN PARKING AREA: BOAT RAMP

PUBLIC MEETING #4
October 27, 2020

ARTICULATED CONCRETE BLOCK



RESERVOIR SPILLWAY

BEACH AREA

PUBLIC MEETING #4

October 27, 2020



TOWN OF ARLINGTON ARLINGTON RESERVOIR - PHASE 2



BEACH AREA: BATH HOUSE/CONCESSIONS

PUBLIC MEETING #4
October 27, 2020

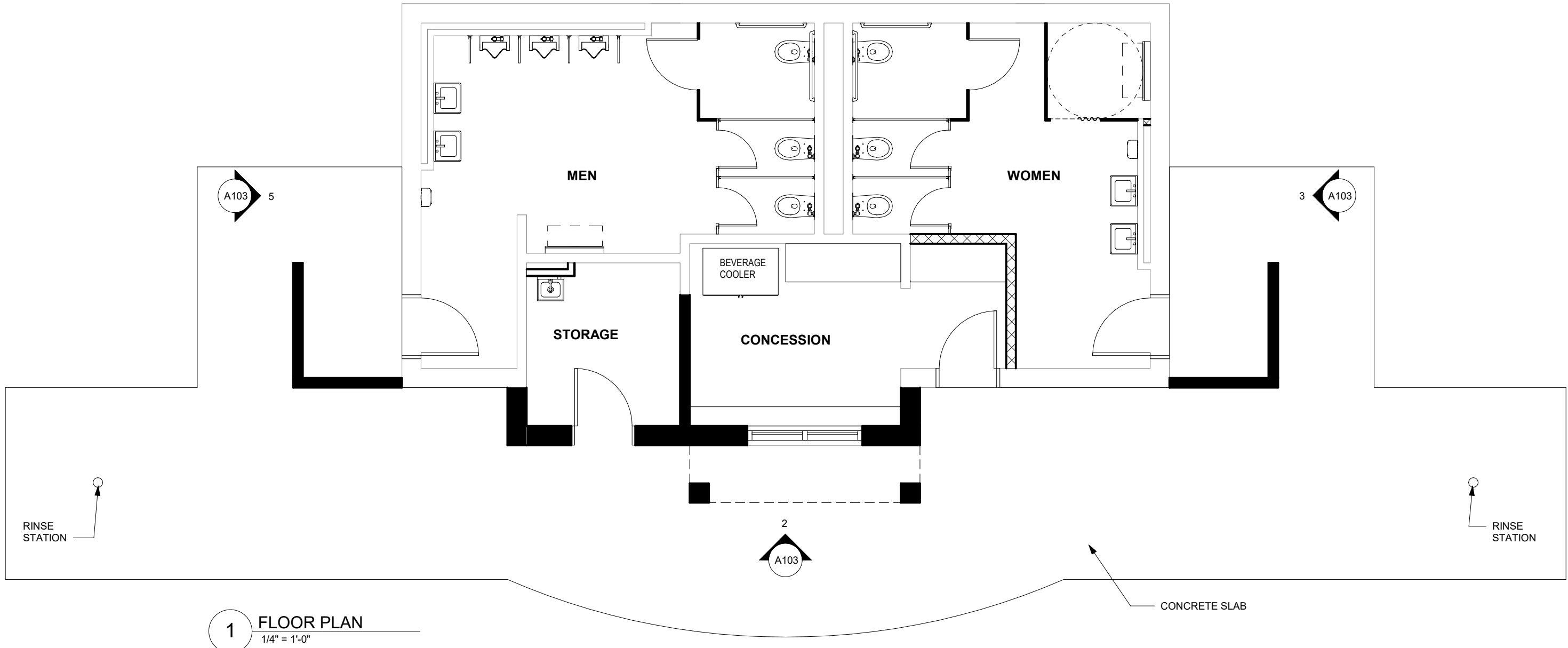

BEACH AREA: BATHHOUSE/CONCESSIONS

PUBLIC MEETING #4

October 27, 2020

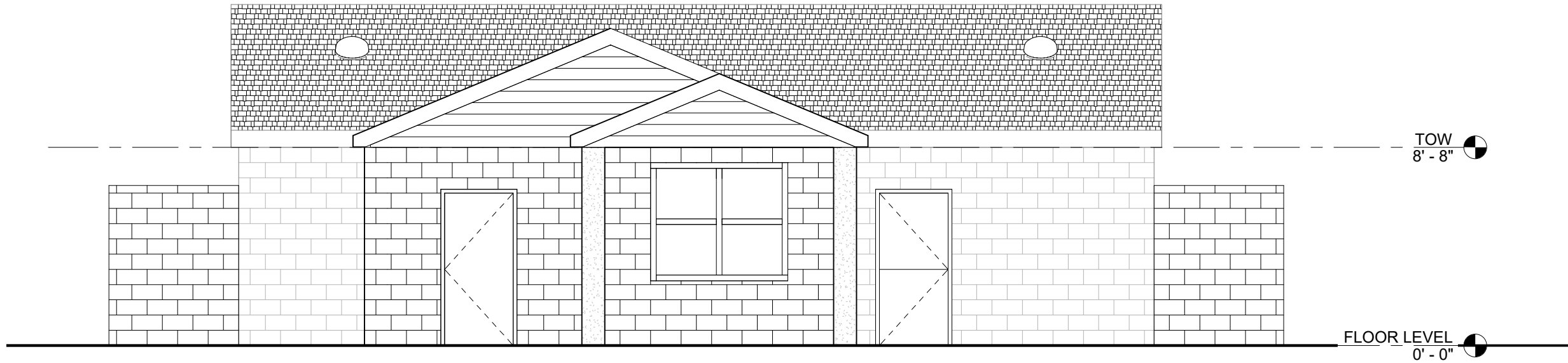

2 WEST ELEVATION
1/4" = 1'-0"

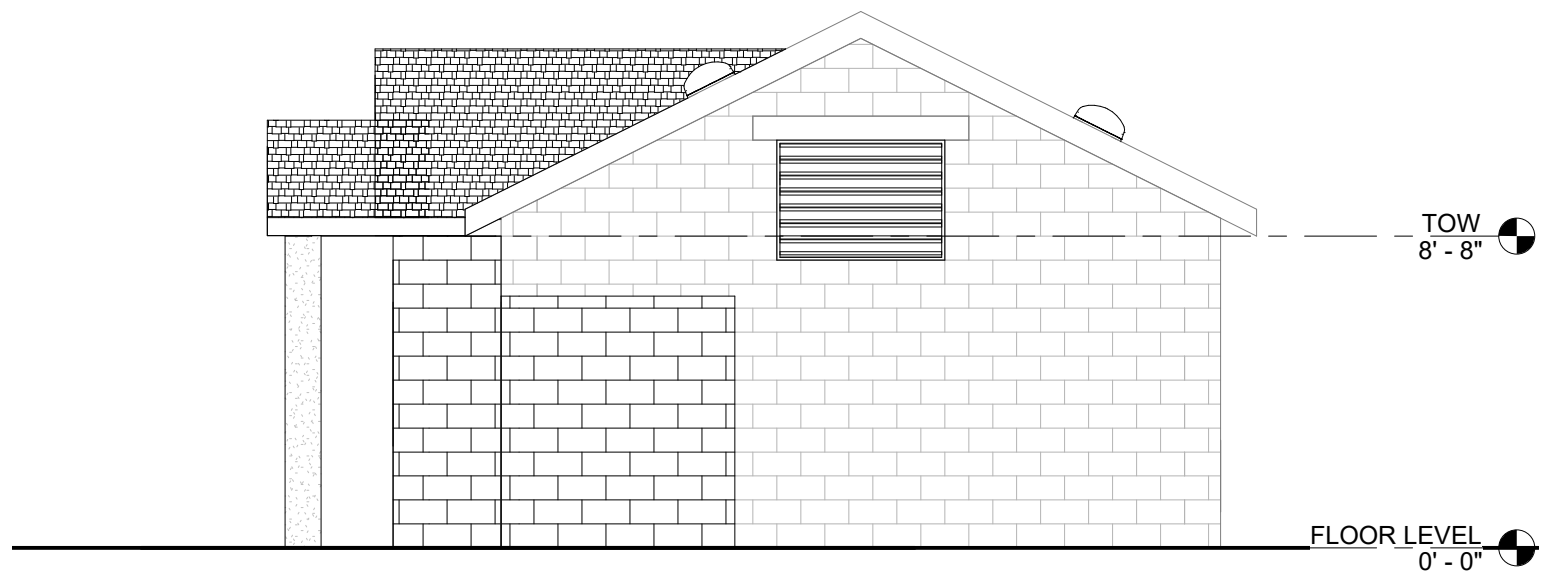

3 NORTH ELEVATION
1/4" = 1'-0"

BEACH AREA: PICNIC PAVILION

PUBLIC MEETING #4
October 27, 2020



TOWN OF ARLINGTON
ARLINGTON RESERVOIR - PHASE 2



BEACH AREA: MULTI-USE POROUS COURT SPACE

PUBLIC MEETING #4

October 27, 2020

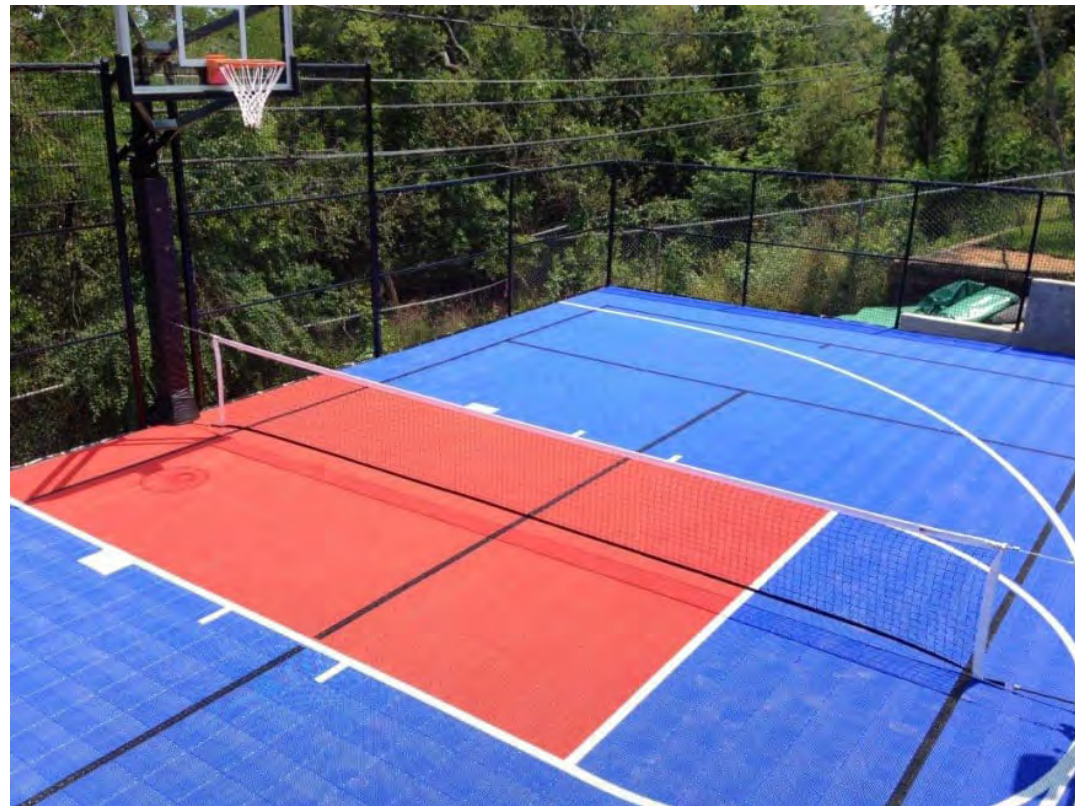

Image 1



Image 2



Image 3

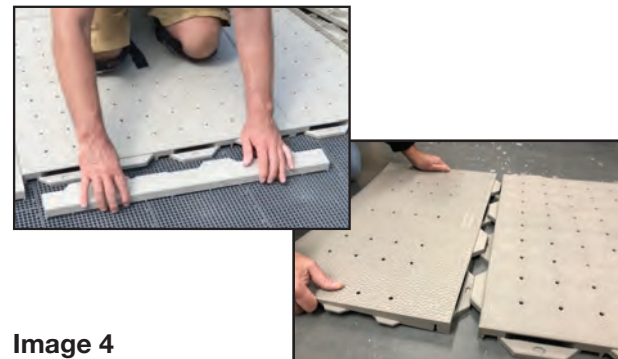
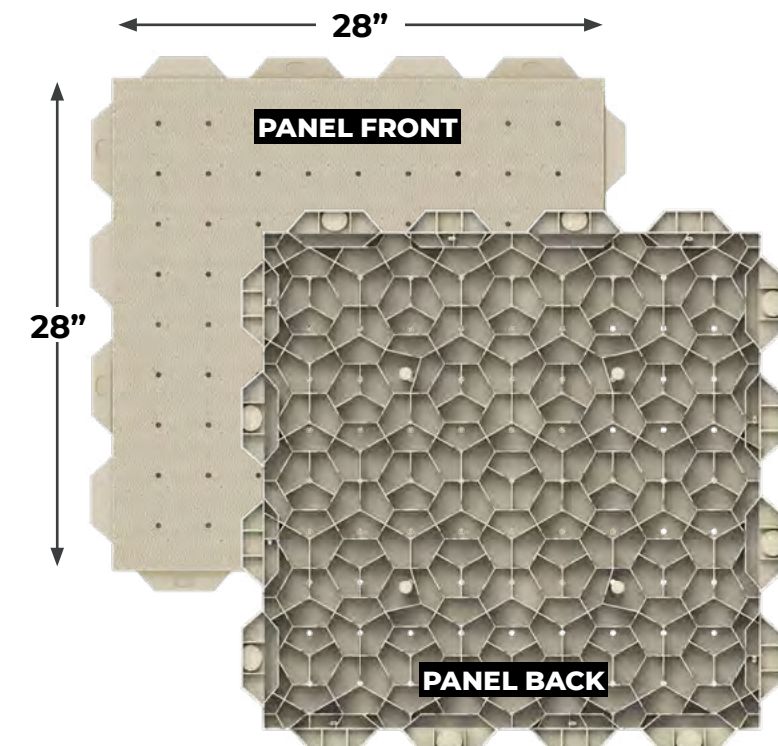
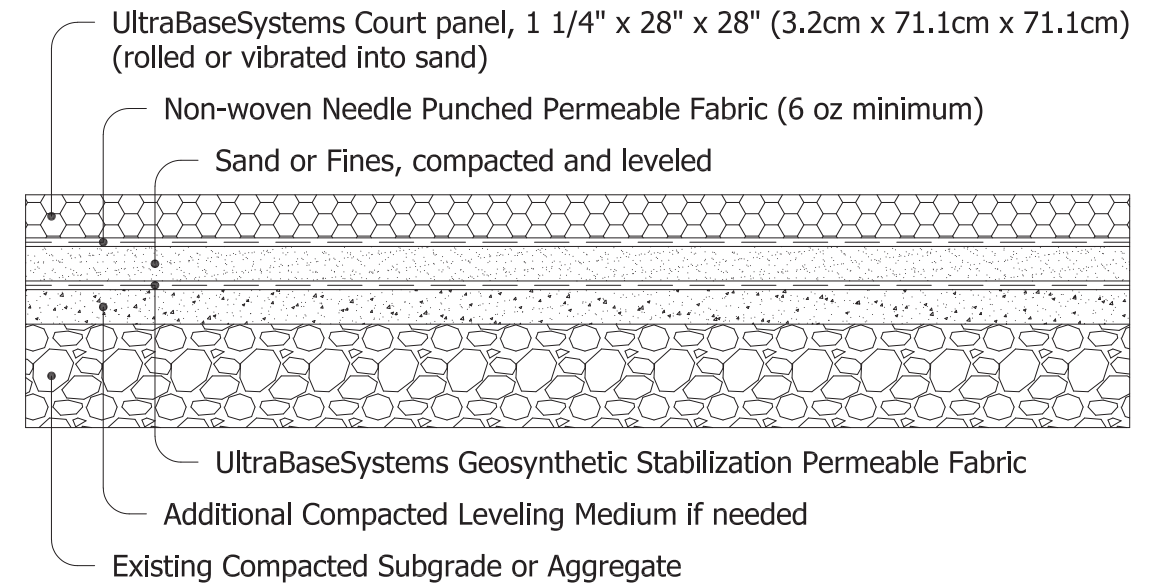

Image 4



BEACH AREA: TREES AT THE BEACH

PUBLIC MEETING #4
October 27, 2020



TREES NEAR BEACH ENTRY



TOWN OF ARLINGTON
ARLINGTON RESERVOIR - PHASE 2



BEACH AREA: TREES AT THE BEACH

PUBLIC MEETING #4
October 27, 2020



TREES TOWARDS CENTER OF BEACH

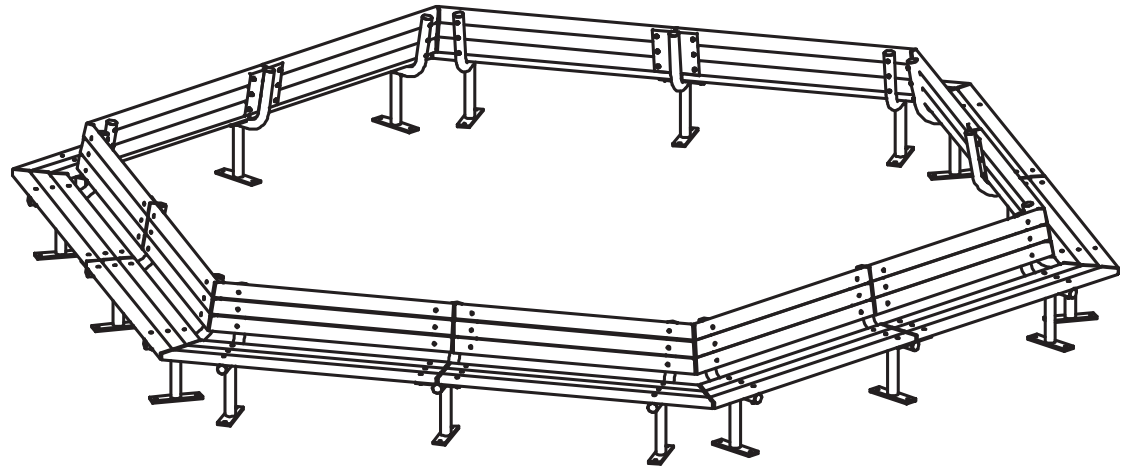
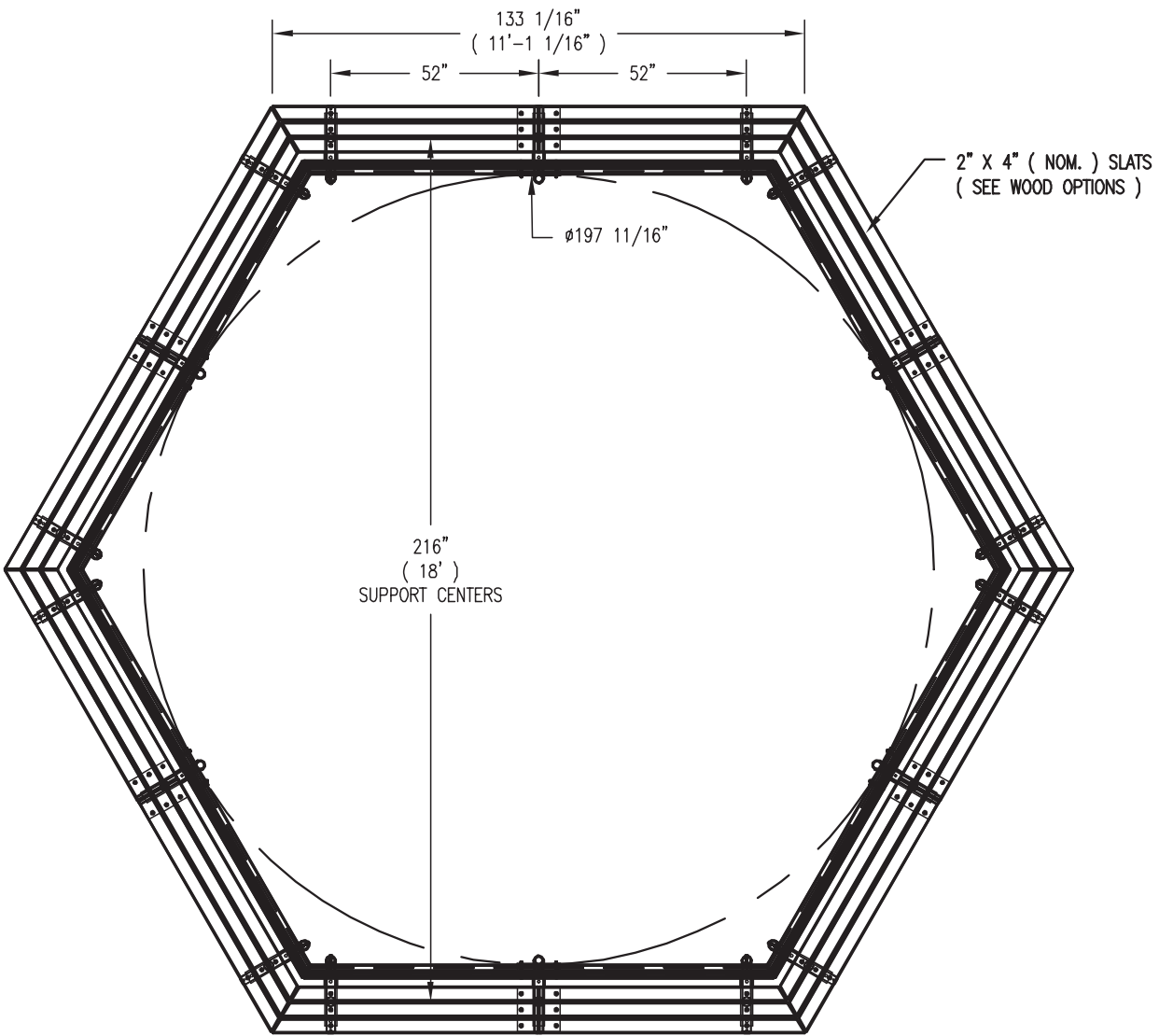

BEACH AREA: TREES AT THE BEACH

PUBLIC MEETING #4

October 27, 2020



TREES NEAR EXISTING PLAYGROUND

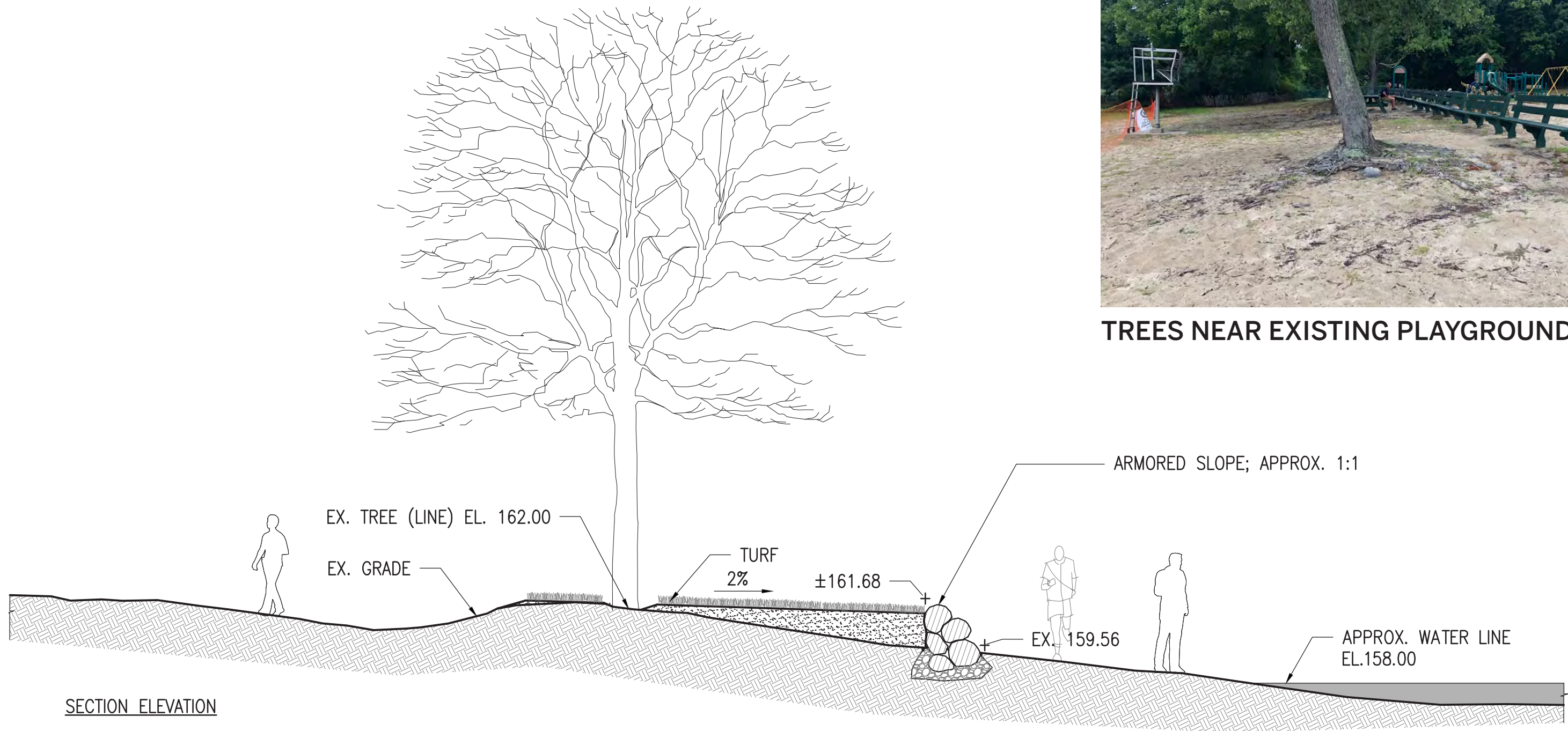

SECTION ELEVATION

BEACH AREA: PLAYGROUND

PUBLIC MEETING #4

October 27, 2020



BEACH AREA: PLAYGROUND

PUBLIC MEETING #4

October 27, 2020



BOAT (2-5 y.o.)



PLAY STRUCTURE (2-5 y.o.)



SAND & WATER PLAY



SPRING RIDERS



BELT SWINGS

GROUP SWINGS (NEST)
(ACCESSIBLE)



PENDULUM SWING



PARKOUR (5-12 y.o.)

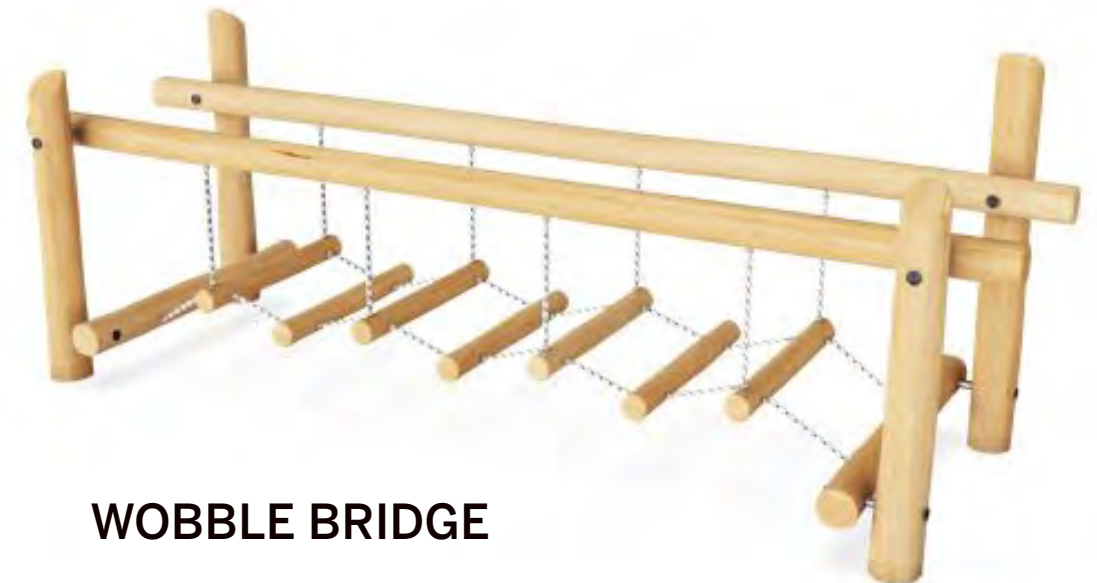

WOBBLE BRIDGE

BEACH AREA: SAND & WATER PLAY

PUBLIC MEETING #4

October 27, 2020



RUBBER SURFACING & RUBBER SPHERES



BEACH AREA: PLAYGROUND

PUBLIC MEETING #4

October 27, 2020



TOWN OF ARLINGTON
ARLINGTON RESERVOIR - PHASE 2



BEACH AREA: PLAYGROUND

PUBLIC MEETING #4

October 27, 2020



TOWN OF ARLINGTON
ARLINGTON RESERVOIR - PHASE 2



BEACH AREA: PLAYGROUND

PUBLIC MEETING #4
October 27, 2020



TOWN OF ARLINGTON
ARLINGTON RESERVOIR - PHASE 2



SITE AMENITIES

PUBLIC MEETING #4
October 27, 2020



CHECK-IN STAND



TRAILHEAD KIOSK

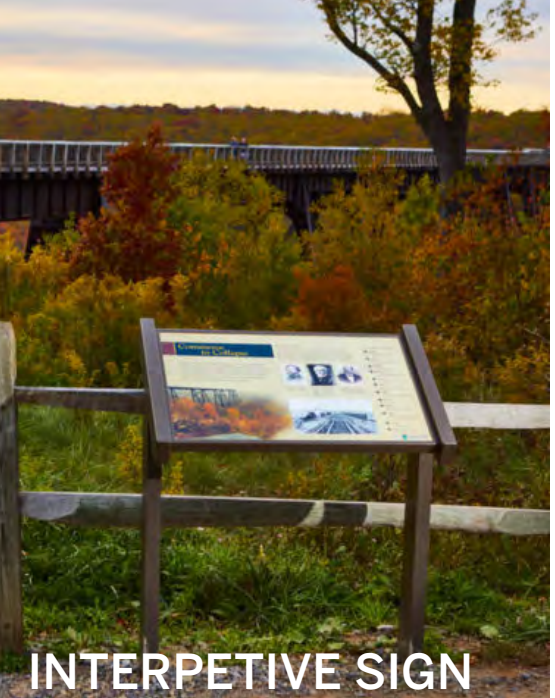

INTERPETIVE SIGN



MILE MARKER



GRANITE BENCHES



BOULDERS

SITE FURNISHINGS

PUBLIC MEETING #4







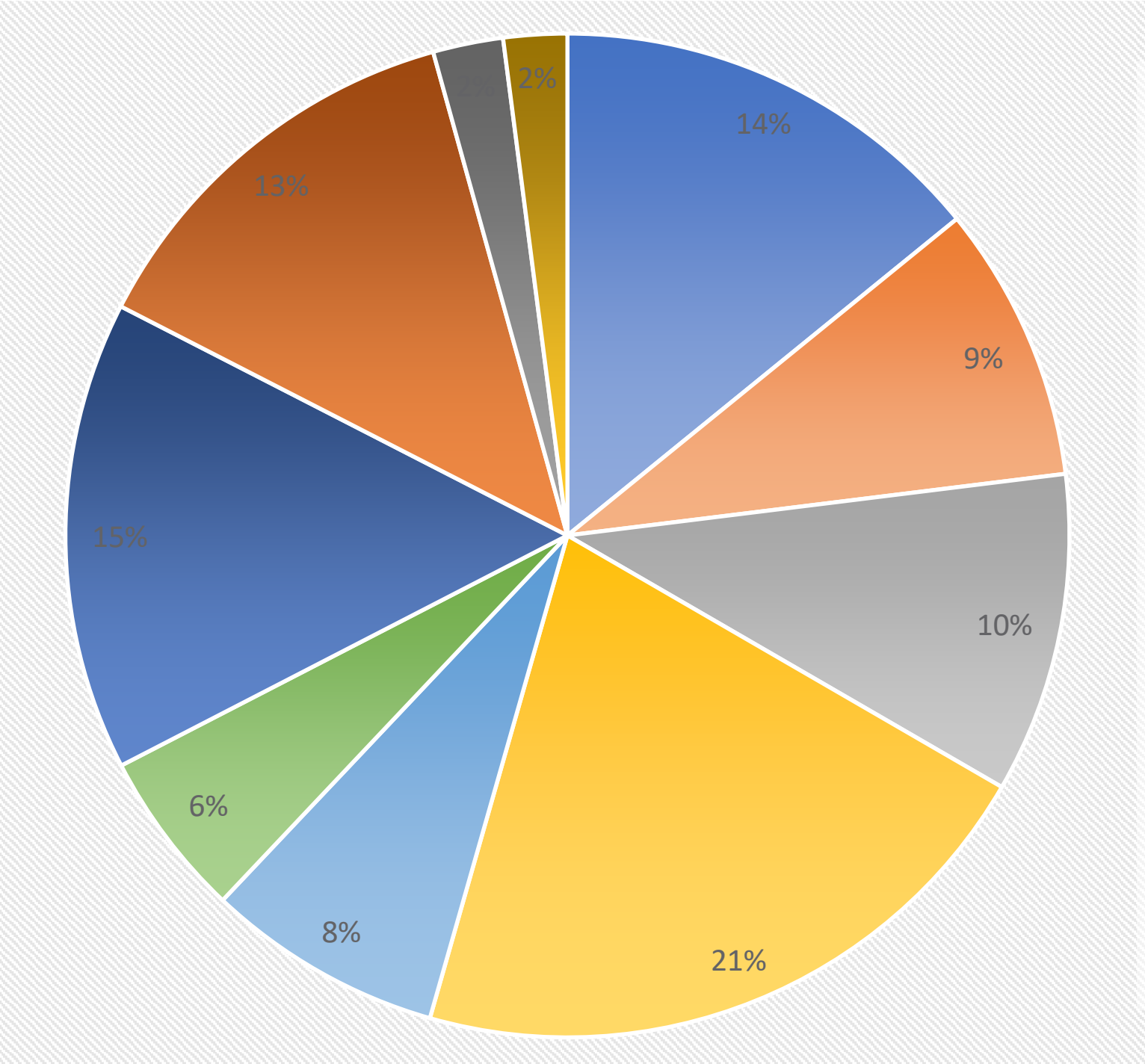



October 27, 2020



BUDGET



BUDGET: \$3.5M

	BANK STABILIZATION & REVEGETATION:	\$ 955,000
	BEACH IMPROVEMENTS:	\$ 685,000
	BATH HOUSE/CONCESSIONS & FILTRATION BUILDING	\$ 640,000
	PLAY SPACE:	\$ 595,000
	TREE PRUNING, INVASIVE REMOVAL & REVEGETATION:	\$ 465,000
	DEMOLITION & SITE PREPARATION:	\$ 405,000
	PERIMETER TRAIL IMPROVEMENTS:	\$ 320,000
	PARKING LOT:	\$ 250,000
	BOAT RAMP:	\$ 100,000
	UTILITIES & MISCELLANEOUS ITEMS:	\$ 100,000

Existing Buildings: Filtration building & Bath house/concessions

Construction Documentation	October — November 12 th
Bid Phase	November 16 th — December 16 th
Construction Phase	Start January/February 2021

Site Work

Permitting	November — December
Construction Documentation	November — January
Bid Phase	January — February
Construction Phase	Start March/April

**Phase work to open beach for 2021 season

Project Completion November 1, 2021

THE PHASE 2 PROJECT

PUBLIC MEETING #4

October 27, 2020



TOWN OF ARLINGTON ARLINGTON RESERVOIR - PHASE 2



