

### Section 3.2.10 Recreation and Open Space Amenities

The 1165R Massachusetts Avenue development enjoys several different open space options, that include the new Mill Brook Walk, two interior lawns, and the Minuteman Commuter Bikeway.

Improved public access for pedestrians and cyclists will be provided along the Mill Brook, within the site itself (Figure 1). The walkway will extend from the Ryder Street/Site Access Driveway intersection to the site's eastern boundary and will be completely handicap-accessible. The walk will feature lighting, benches, bicycle racks, and new trees and plants. A decorative railing will separate the walk from Mill Brook and will incorporate interpretive signage that describes the history of the Theodore Schwamb Mill with text and photographs (Figure 2).

There are two interior lawn spaces, one located adjacent to the resident drop-off, west of the main entry to Building 4 and the other is located at the east end of the property, adjacent to the Mill Brook and Building 3 (Amenities Building).

Each lawn will feature new trees and plants, benches and bike racks. These are spaces where the public can mingle with residents and may feature outdoor games in favorable weather.

The property also offers an interior courtyard feature that is exclusive to the residents. This area will be accessible from the main lobby and is enclosed by Building 4 and the Amenities Building. The courtyard will be a place for residents to gather individually or for property events and will feature loose tables and chairs and overhead catenary lights (Figures 1 and 2).

The Minuteman Commuter Bikeway is located less than a quarter of a mile from the site and is accessible from Ryder Street. The Bikeway is a 10-mile long paved recreation and bicycle commuting path that passes through Arlington and Lexington and connects Alewife Station in West Cambridge, MA to South Road in Bedford, MA.

FIGURE 1

Lawn 1  
(at resident drop-off)

Resident Courtyard

Mill Brook Walk

Lawn 2 (east end of site)

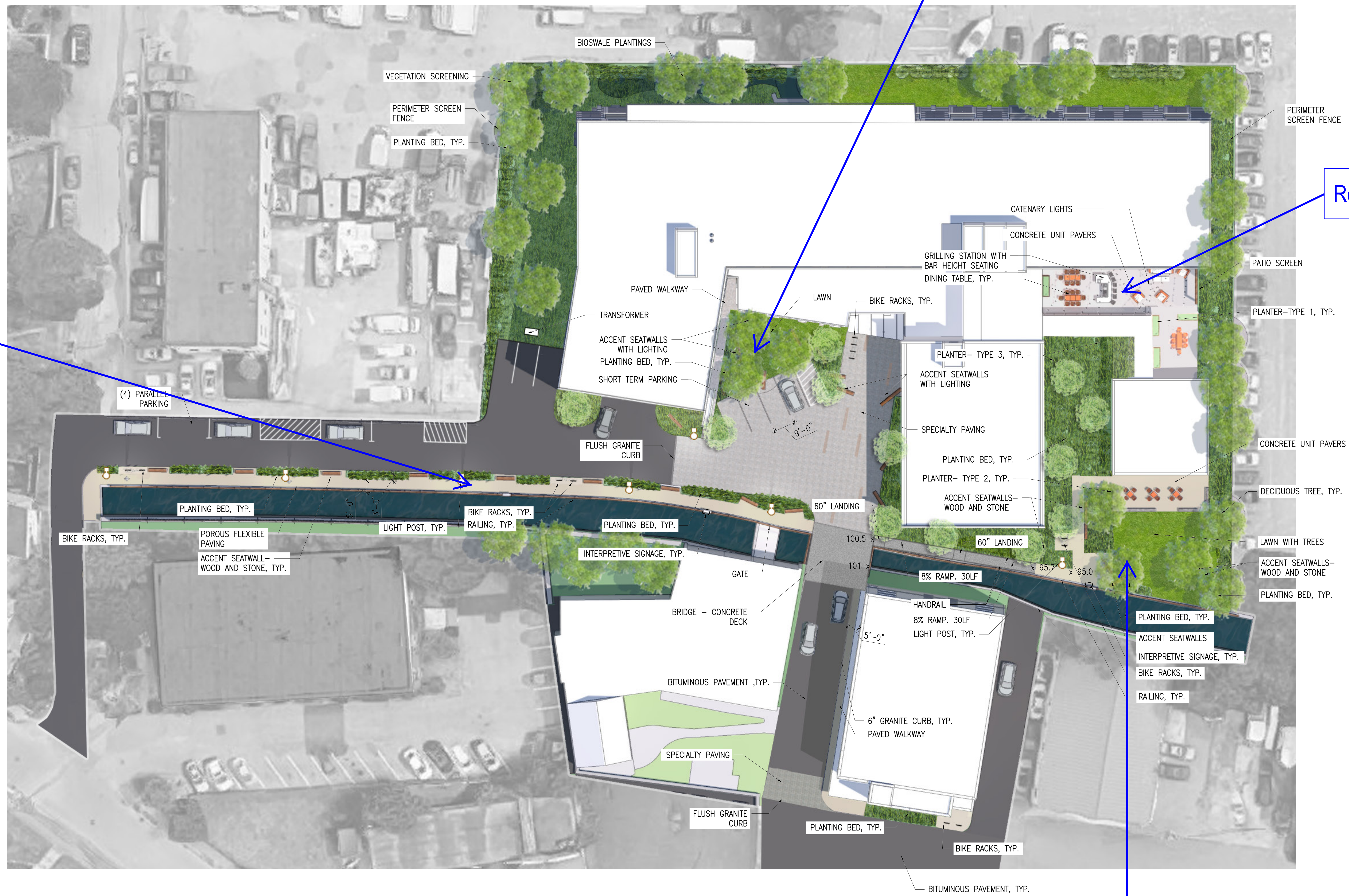

**REVISIONS**

1	
2	
3	
4	
5	DATE

**DRAWING TITLE**  
**Landscape Plan**

**DRAWING INFORMATION**

June 16, 2020  
 DATE OF ISSUE  
 MassHousing  
 DESCRIPTION  
 1"=20' 0"  
 SCALE  
 3426.00  
 PROJECT #  
 Author  
 RB KZ  
 DRAWN BY  
 [NAME]  
 FILE NAME

**DRAWING NUMBER**

**L101**

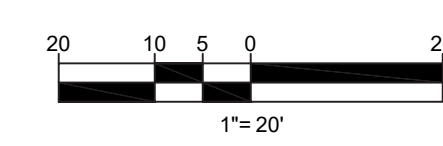

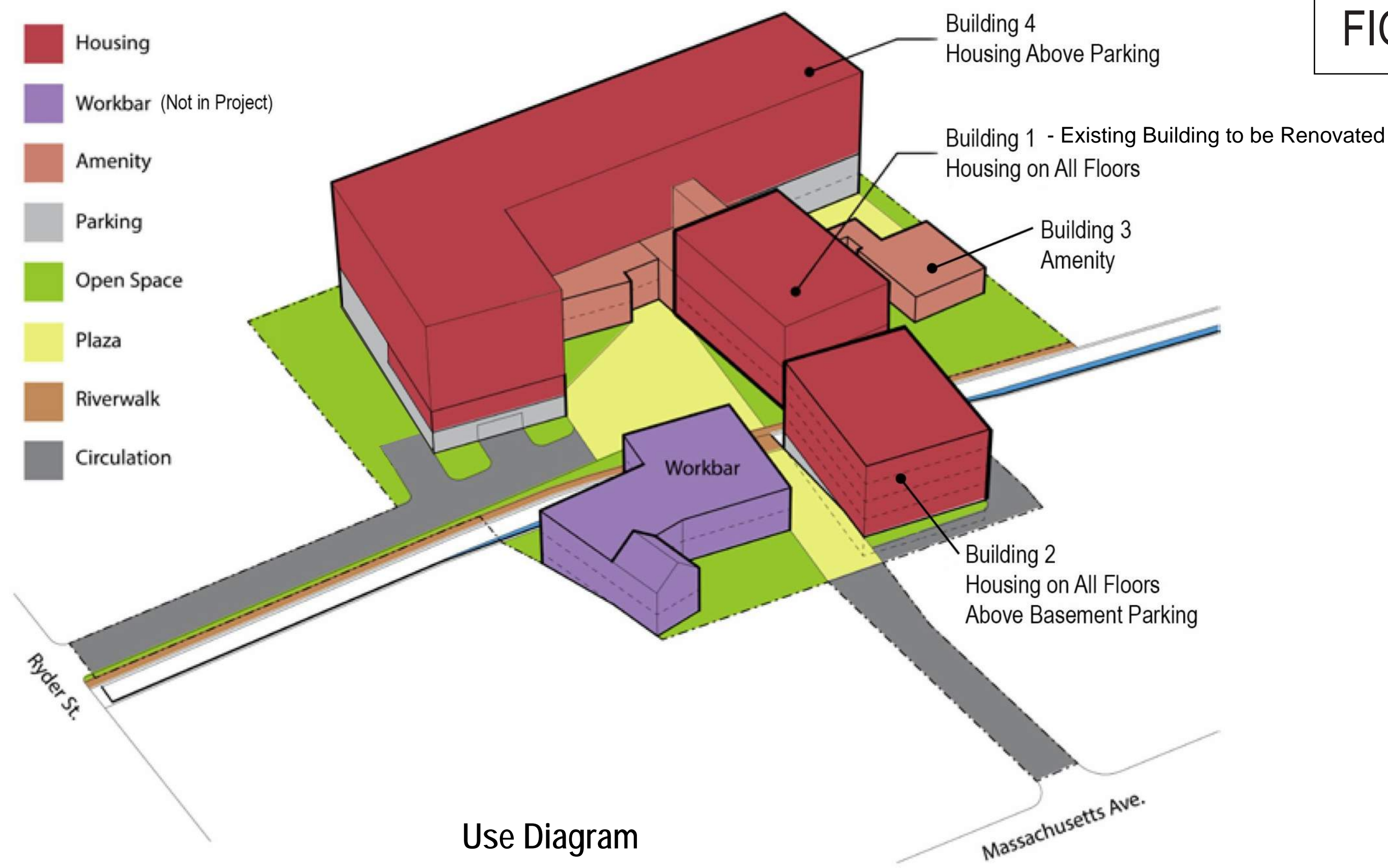

FIGURE 2



WIDENING THE BRIDGE: Existing & Proposed



View at "Entry" to 1165R



View of Building 4 and Building 1 with Common Entry



View along Mill Brook between Building 1 and 2



View along Mill Brook looking East



View of Eastern Courtyard Spaces



View of Building Exterior Amenity Space

**ARCHITECT**  
**bh+a**  
 Bargmann Hendrie + Archetype, Inc.  
 9 Channel Center Street  
 Boston, MA 02210  
 617-350-0450 Tel

**PROJECT NAME**  
**Redevelopment of 1165R Massachusetts Avenue**  
 1165R Massachusetts Avenue, Arlington, MA 02476

**CLIENT**  
**1165R Mass MA Property LLC**

c/o Spaulding & Slye Investments  
 One Post Office Square  
 26th Floor  
 Boston, MA 02109

**PROJECT TEAM**  
**Structural Engineer**  
 Veitas & Veitas  
 639 Granite St  
 Braintree, MA 02184  
 (781) 843-2863

**MEP/FP Engineer**  
 Wozny/Barbar & Associates, Inc.  
 Consulting Engineers  
 1078 Washington St  
 Hanover, MA 02339  
 (781) 826-4144

**Civil Engineer**  
 Bohler Engineering  
 352 Tanglewood Road  
 Southborough, MA 01772  
 (508) 480-9900

**Landscape Architect**  
 Kyle Zick Landscape Architecture  
 36 Bromfield Street, Suite 202  
 Boston, MA 02108

**REVISIONS**

1	
2	
3	
4	
5	

DATE

**DRAWING TITLE**  
**3D Views**

**DRAWING INFORMATION**

REGISTERED ARCHITECT  
 STATE OF MASSACHUSETTS  
 No. 5380  
 MICHAEL BARKER  
 ARCHITECT

June 18, 2020  
 DATE OF ISSUE  
 MassHousing  
 DESCRIPTION: Michael Barker  
 SCALE: 3/4" = 1'-0" (3/4" = 1'-0")  
 PROJECT # FILE NAME

**DRAWING NUMBER**  
**A001**