



# Wildlife Habitat Garden at the Arlington Reservoir

Martine Gougault  
Landscape Designer  
Beausoleil Gardens

# Meadow Side Blazing Star



## Blazing Star Mixture



2 Reviews [Write a Review](#)

 **LIGHT** Full Sun

 **SIZE** 10-12 cm Bulb

 **ZONE** 3-9

 **BLOOM TIME** Mid to late summer

 **HEIGHT** 26 - 30 inches

 **SOIL REQUIREMENT** Well drained

 **ATTRACT BEES**

We'll carefully pack and ship your order at the

# Butterfly Weed

## Asclepias tuberosa (Butterfly Weed)

*Butterfly Flower, Butterfly Root, Butterfly Weed, Chieger Flower, Flux Root, Indian Paintbrush, Indian Potato, Orange Root, Pleurisy Root, Swallow Root, Tuber Root, White Root, Wind Root, Windward Root*



Easy care, drought tolerant and deer resistant, *Asclepias tuberosa* (Butterfly Weed) is a bushy perennial prized for its brilliant clusters of bright orange to yellow-orange flowers which bloom continuously throughout summer. Sitting atop upright flowering stems, clad with stiff, lance-shaped leaves, the colorful umbels, 2-5 inches across (5-12 cm), are followed by attractive seed pods in fall. The abundant foliage provides a dark-green backdrop which nicely

Add to Collection ▾

Buy Plants

### Requirements

<b>Hardiness</b>	3 – 9 <a href="#">What's My Zone?</a>
<b>Heat Zones</b>	3 – 9 <a href="#">What's My Zone?</a>
<b>Climate Zones</b>	1, 1A, 1B, 2, 2A, 2B, 3, 3A, 3B, 4, 5, 6, 7, 8, 9, 10, 11, 12, 13, 14, 15, 16, 17, 18, 19, 20, 21, 22, 23, 24, A1, A2
<b>Plant Type</b>	Perennials
<b>Plant Family</b>	Asclepias
<b>Exposure</b>	Full Sun
<b>Season of Interest</b>	Summer (Early,Mid,Late)
<b>Height</b>	1' – 2' (30cm – 60cm)
<b>Spread</b>	1' – 2' (30cm – 60cm)
<b>Spacing</b>	18" – 24" (45cm – 60cm)
<b>Water Needs</b>	Low
<b>Maintenance</b>	Low
<b>Soil Type</b>	Clay, Loam, Sand
<b>Soil pH</b>	Acid, Neutral
<b>Soil Drainage</b>	Well-Drained
<b>Characteristics</b>	Dried Arrangements, Cut Flowers, Showy

# More smaller plants along the paths .



[Enlarge Photo](#)



 [Print Page](#)

You May Also Like

## Lobelia, Cardinal Flower

★★★★☆ 3.8 (12) [Write a review](#)

**BUY ANY 3 PERENNIAL PLANTS OR BULBS & SAVE 20%**

Grows anywhere, adored by hummingbirds and butterflies.

The lovely native cardinal flower forms brilliant spikes of red florets cover 36" tall spikes like butterfly wings.

Item #	Order	Quantity
22105	1 Plant	<input type="text" value="1"/>

### Zone

4-8

### Sun

Full Sun, Part Sun

### Height

36-40 inches

### Spread

18-24 inches

### Bloom Season

Fall, Summer

### Resistant To

Deer, Rabbit, Wet Soil

# Low lying Aster.

## Doellingeria umbellata (Flat-Topped White Aster)

*Parasol Whitetop, Flat-Topped White Aster, Flat-Topped Aster, Parasol Aster, Cornel-Leaf Whitetop, Aster umbellatus*



Doellingeria umbellata (Flat-Topped White Aster) is an upright perennial boasting showy flat-topped clusters of white, daisy-like flowers with yellow centers in late summer to fall. The blossoms attract butterflies and other pollinators. Blooming for 4-8 weeks, the flowers fade to a pleasant greenish-white color for weeks after the peak bloom. are

Add to Collection ▾

Buy Plants

### Requirements

<b>Hardiness</b>	3 - 9 <a href="#">What's My Zone?</a>
<b>Plant Type</b>	Perennials
<b>Plant Family</b>	Asters
<b>Exposure</b>	Full Sun, Partial Sun
<b>Season of Interest</b>	Summer (Late) Fall
<b>Height</b>	2' - 5' (60cm - 150cm)
<b>Spread</b>	2' - 4' (60cm - 120cm)
<b>Spacing</b>	36" - 48" (90cm - 120cm)
<b>Water Needs</b>	Average
<b>Maintenance</b>	Low
<b>Soil Type</b>	Clay, Loam, Sand
<b>Soil pH</b>	Acid, Neutral
<b>Soil Drainage</b>	Moist but Well-Drained, Moisture Retentive
<b>Characteristics</b>	Showy
<b>Native Plants</b>	United States, Midwest, Illinois, Indiana, Iowa, Michigan, Minnesota, Missouri, Nebraska, North Dakota, Ohio, South Dakota, Wisconsin, Northeast, Connecticut,

# False indigo

Plant form: *Amorpha fruticosa*.

By Roland Boutwell. Copyright © 2021 Roland Boutwell. For Reuse: [Contact](#)



# Globe Thistle, Echinacea



## Garden Information

<b>Hardiness</b>	5 – 8 <a href="#">What's My Zone?</a>
<b>Heat Zones</b>	5 – 9 <a href="#">What's My Zone?</a>
<b>Climate Zones</b>	4, 5, 6, 7, 8, 9, 10, 11, 12, 13, 14, 15, 16, 17, 18, 19, 20, 21, 22, 23, 24
<b>Exposure</b>	Full Sun
<b>Season of Interest</b>	Summer (Mid,Late)
<b>Water Needs</b>	Low
<b>Maintenance</b>	Low
<b>Soil Type</b>	Chalk, Loam, Sand
<b>Soil Ph</b>	Acid, Neutral
<b>Soil Drainage</b>	Well-Drained
<b>Characteristics</b>	Dried Arrangements, Cut Flowers, Fragrant, Showy
<b>Tolerance</b>	Deer, Drought
<b>Attracts</b>	Birds, Butterflies, Hummingbirds
<b>Landscaping Ideas</b>	Beds and Borders
<b>Garden Styles</b>	Informal and Cottage , Prairie and Meadow

# More Joe-Pye Weed in middle of the grasses



## Eutrochium fistulosum (Joe-Pye Weed)

*Joe-Pye Weed, Trumpetweed, Queen Of The Meadow, Hollow Joe-Pye Weed, Eupatoriadelphus fistulosus, Eupatorium fistulosum*



Towering over the garden, *Eutrochium fistulosum* (Joe-Pye Weed) is an upright, clump-forming perennial boasting huge domed clusters of small, vanilla-scented, pinkish-lavender flowers in mid-summer to early fall. Borne atop erect, strong stems which are hollow, the long-lasting blossoms are attractive to butterflies and pollinators in search of nectar. They give way to attractive, soft buff colored seed heads which persist well into winter. Narrow, lance-shaped leaves, up to 10 in. long (25 cm), are whorled along the erect stem. Native to eastern North America, *Eutrochium fistulosum* provides a wonderful garden presence and late season flowers at a time when choices may be limited. Use it in the informal setting of a cottage garden or allow it to naturalize in a woodland garden.

Add to Collection ▾

Buy Plants

### Requirements

<b>Hardiness</b>	4 - 8 <a href="#">What's My Zone?</a>
<b>Plant Type</b>	Perennials
<b>Plant Family</b>	Eupatorium - Joe-Pye Weeds
<b>Exposure</b>	Full Sun, Partial Sun
<b>Season of Interest</b>	Summer (Mid,Late) Fall
<b>Height</b>	4' - 7' (120cm - 210cm)
<b>Spread</b>	2' - 4' (60cm - 120cm)
<b>Spacing</b>	48" (120cm)
<b>Water Needs</b>	Average, High
<b>Maintenance</b>	Low
<b>Soil Type</b>	Chalk, Clay, Loam, Sand
<b>Soil pH</b>	Acid, Alkaline, Neutral
<b>Soil Drainage</b>	Moist but Well-Drained, Poorly Drained
<b>Characteristics</b>	Fragrant, Showy
<b>Native Plants</b>	United States, Midwest, Illinois, Indiana, Michigan, Missouri, Ohio, Northeast, Connecticut, Delaware, Maine, Massachusetts, Maryland, New Hampshire, New Jersey, New York, Pennsylvania, Rhode Island, Vermont, Southeast, Alabama,



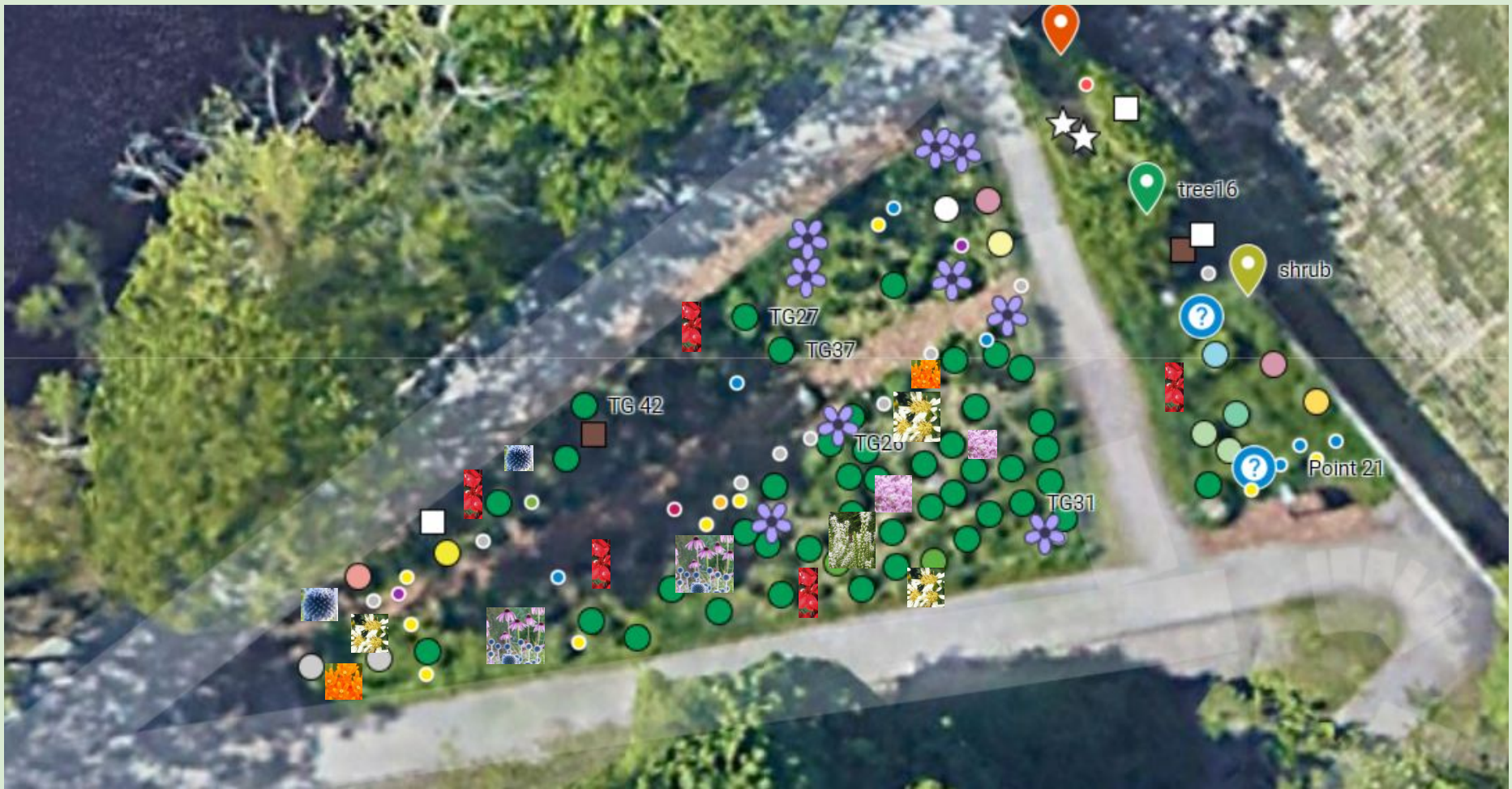

tree16



shrub



TG27

TG37

TG 42

TG26

TG31



Point 21



