

**EXCESS SNOW THAT CANNOT BE STORED ON-SITE IS TO BE REMOVED FROM THE SITE**

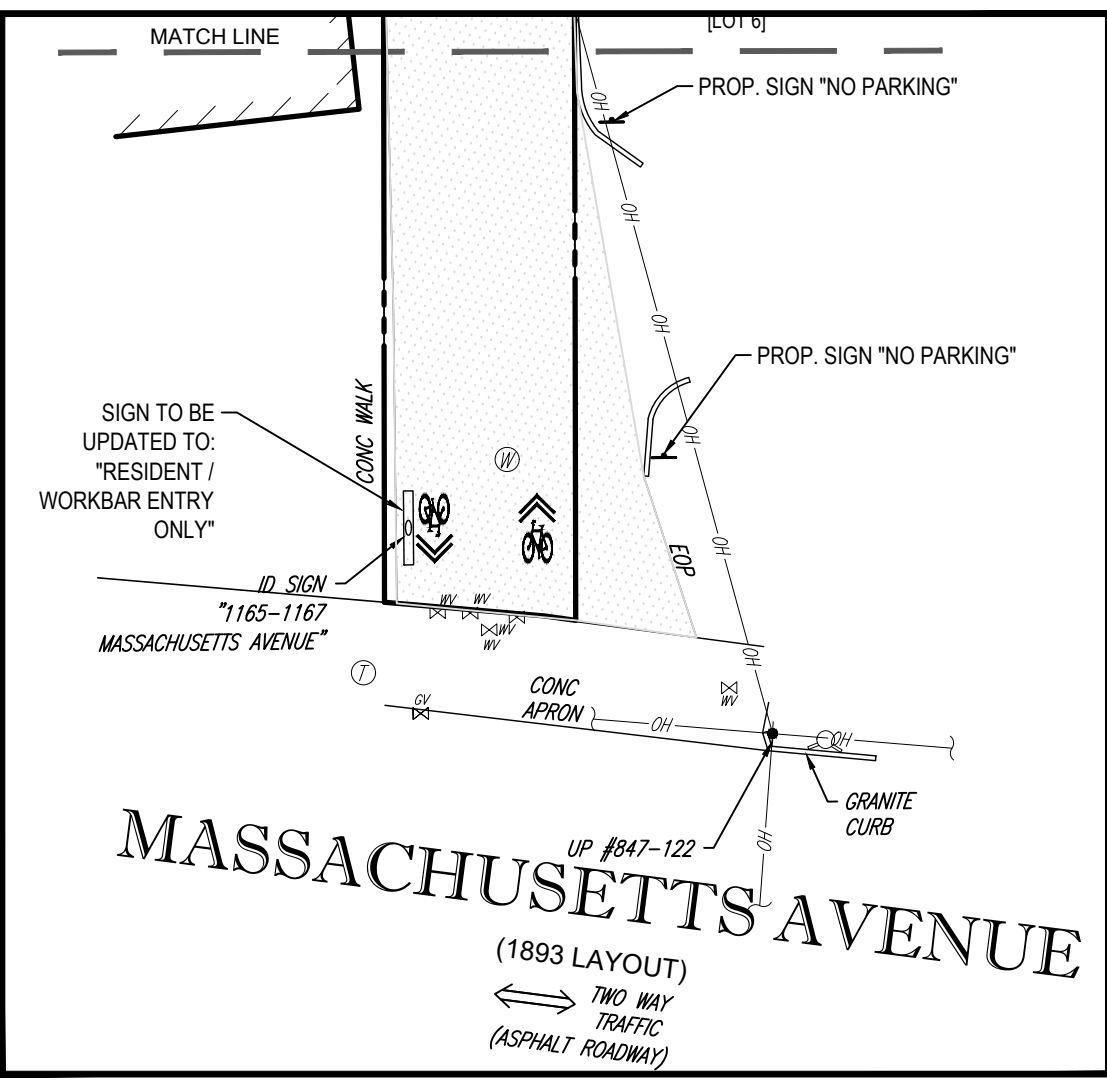

**THIS PLAN TO BE UTILIZED FOR SITE LAYOUT PURPOSES ONLY. REFER TO GENERAL NOTES SHEET FOR ADDITIONAL NOTES**

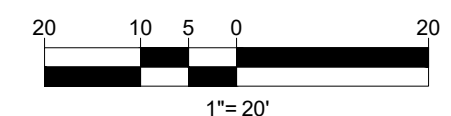

**BOHLER**  
 SITE CIVIL AND CONSULTING ENGINEERING  
 PROGRAM MANAGEMENT  
 LANDSCAPE ARCHITECTURE  
 SUSTAINABLE DESIGN  
 PERMITTING SERVICES  
 TRANSPORTATION SERVICES

**REVISIONS**

REV	DATE	COMMENT	CHECKED BY
2	06/15/20	SITE PLAN & GRADING	AWP
3	07/15/20	CONSERVATION COMMISSION	JMJ
4	08/21/20	CONSTRUCTION PHASING	JMJ
5	10/05/20	ZBA SUBMITTAL PROGRESS SET	AWP
6	04/01/21	ZBA COMMENT RESPONSE	RMM
7	04/13/21	UPDATED SIGNAGE	CFD
8	05/13/21	WATER LINE AND SIGNAGE	RMM
9	05/26/21	124 UNIT BUILDING	AWP
10	06/11/21	REV. PER TOWN COMMENTS	CFD

**811**  
 Know what's below.  
 Call before you dig.  
 ALWAYS CALL 811  
 It's fast. It's free. It's the law.

**PERMIT SET**  
 THIS DRAWING IS INTENDED FOR MUNICIPAL AND/OR AGENCY REVIEW AND APPROVAL. IT IS NOT INTENDED AS A CONSTRUCTION DOCUMENT UNLESS INDICATED OTHERWISE.

PROJECT No.: W191330  
 DRAWN BY: AWP  
 CHECKED BY: JMJ  
 DATE: 02/17/2020  
 CAD ID: W191330-CV-10

**PROPOSED SITE PLAN DOCUMENTS**  
 FOR  
**1165R MASS MA PROPERTY LLC**  
 PROPOSED RESIDENTIAL DEVELOPMENT  
 1165R MASSACHUSETTS AVE.  
 MIDDLESEX COUNTY  
 TOWN OF ARLINGTON, MA  
 MAP #57, BLOCK #2, LOT #10B  
 AND PART OF LOT #15

**BOHLER**  
 352 TURNPIKE ROAD  
 SOUTHBOROUGH, MA 01772  
 Phone: (508) 480-9900  
 Fax: (508) 480-9080  
 www.BohlerEngineering.com

**J.G. SWERLING**  
 PROFESSIONAL ENGINEER  
 MASSACHUSETTS LICENSE No. 41697  
 NEW HAMPSHIRE LICENSE No. 14695  
 MAINE LICENSE No. 13819  
 CONNECTICUT LICENSE No. 30785  
 RHODE ISLAND LICENSE No. 11425

SHEET TITLE:  
**SITE LAYOUT PLAN**  
 SHEET NUMBER:  
**C-301**  
 REVISION 10 - 06/11/21

P:\191330\DRAWINGS\PLAN SET\SET\W191330-CV-10.dwg - LAYOUT: C-301-SITE