



FOOT of the ROCKS

TOWN OF ARLINGTON

JUNE 2, 2022

RAY DUNETZ LANDSCAPE ARCHITECTURE, INC.

Foot of the Rocks, Arlington, VT

MEETING ETIQUETTE

- Please **REMAIN MUTED** during the presentation.
- There will be an opportunity for **QUESTIONS & COMMENTS** at the end.
- If you have a question, please **RAISE YOUR HAND** and the host will unmute you.
- **CHAT ROOM** will be open throughout the presentation. We'll share chat comments at the end of the presentation.

THIS MEETING
IS BEING
RECORDED

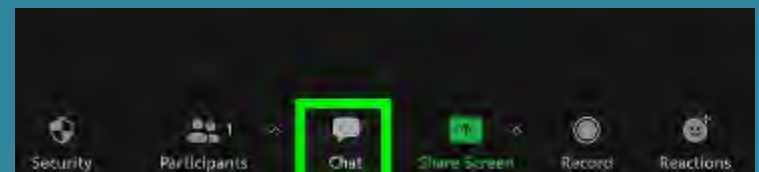
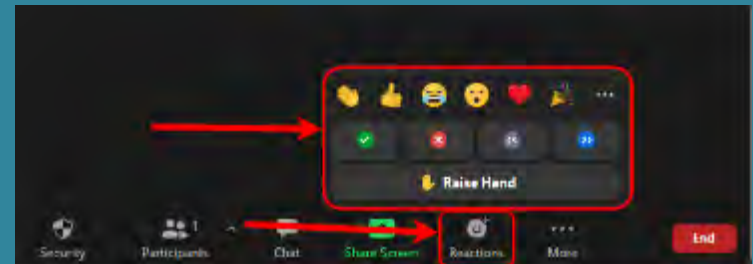

AGENDA

Introduction
Timeline
History
Existing Conditions
Concepts
Precedents
Questions & Discussion



TIMELINE

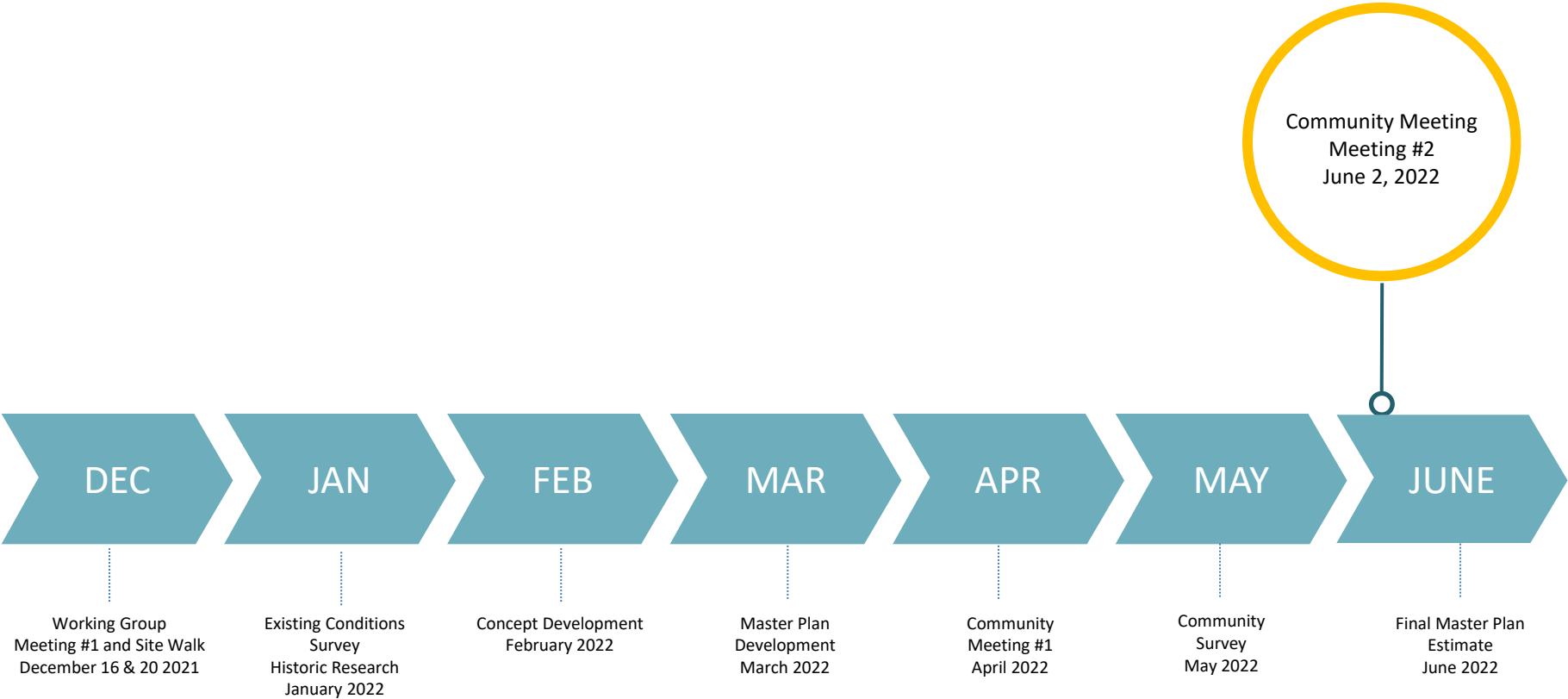

PROJECT GOAL

To properly commemorate the rich **HISTORY** of the space in an inviting manner via the development of conceptual design options derived through a robust public participation process that builds support and consensus for a future project.

HISTORICAL CONTEXT



Approximately 1,800 British troops and about the same number of colonial minutemen and militia soldiers fought on this spot on April 19th, 1775 resulting dozens of deaths and an even greater number of casualties.

HISTORICAL CONTEXT

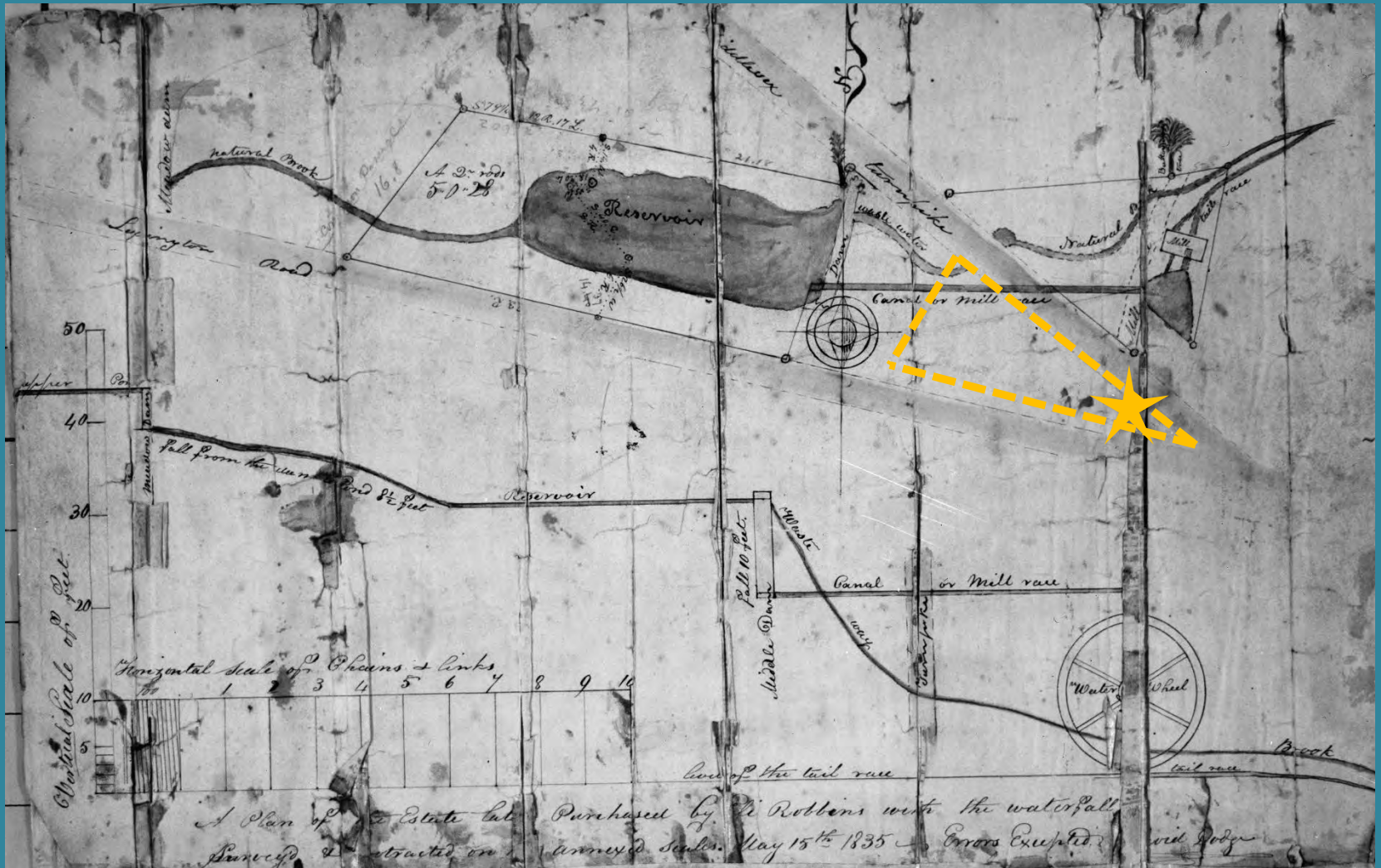

HISTORICAL CONTEXT

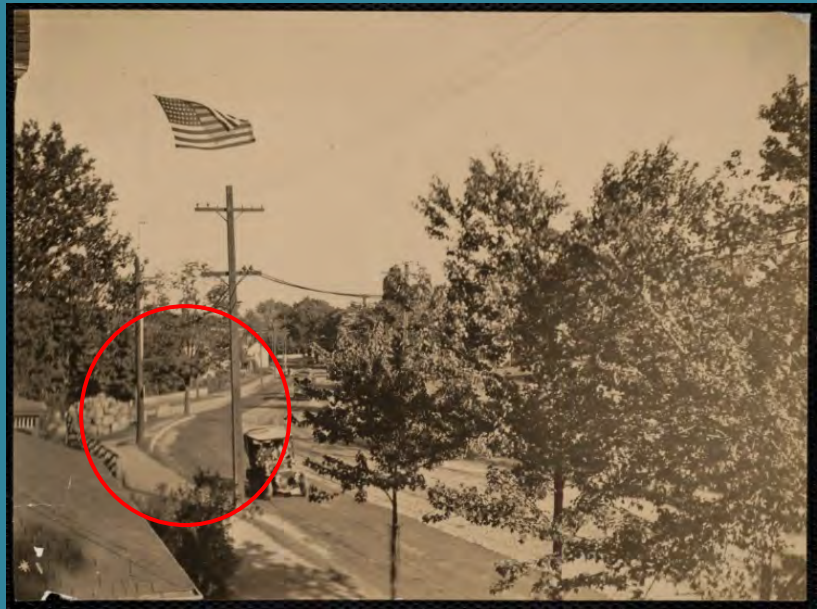

Arlington Historical Society

EXISTING CONDITIONS



EXISTING CONDITIONS



EXISTING CONDITIONS



MASTER PLAN DESIGN OBJECTIVES

- Historic Interpretation
- Accessibility and Safety
- Gathering Accommodation
- Flexible Space
- Sustainable Approach

CONCEPTS

CONCEPT A

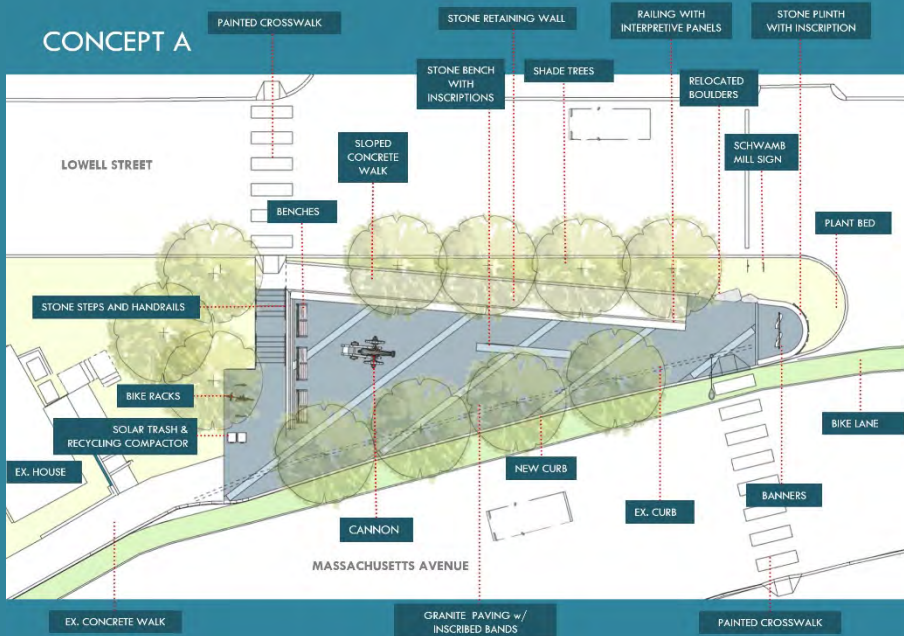

CONCEPT B

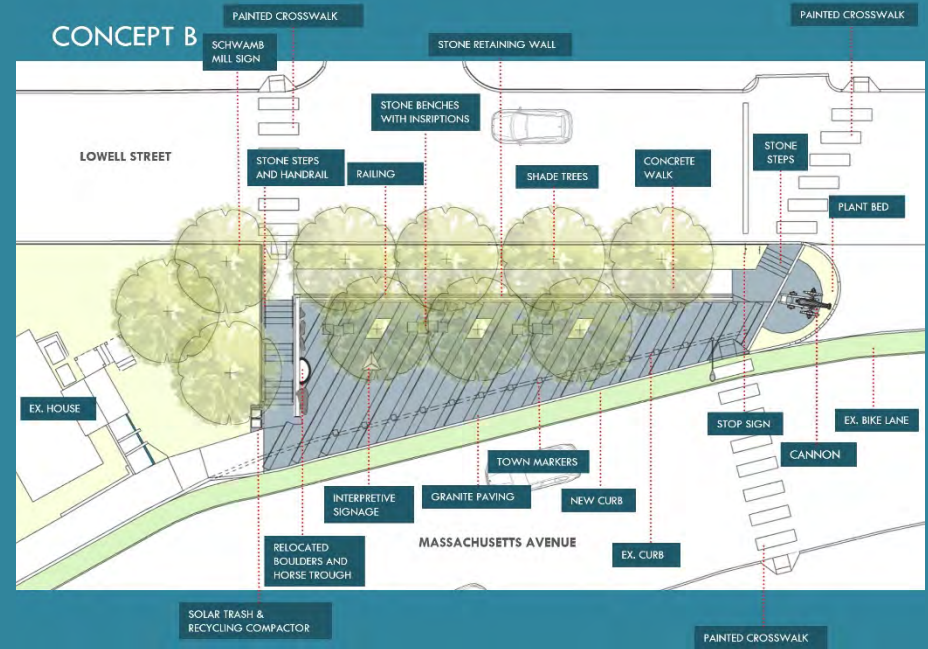

COMMUNITY INPUT SURVEY



Foot of the Rocks Master Plan

Please share your Arlington voices in the design process for this important historic landmark located at 1241 Mass Ave. We met with the Community on April 14th and received a lot of great feedback. If you were unable to attend the meeting you may still view the slides and learn more on the project page located at <https://tinyurl.com/3hbubwsj>. Additional feedback is sought by May 18th and a 2nd public input session is planned on June 2nd, which we will present a preferred concept that will include feedback gathered to date.

MASTER PLAN

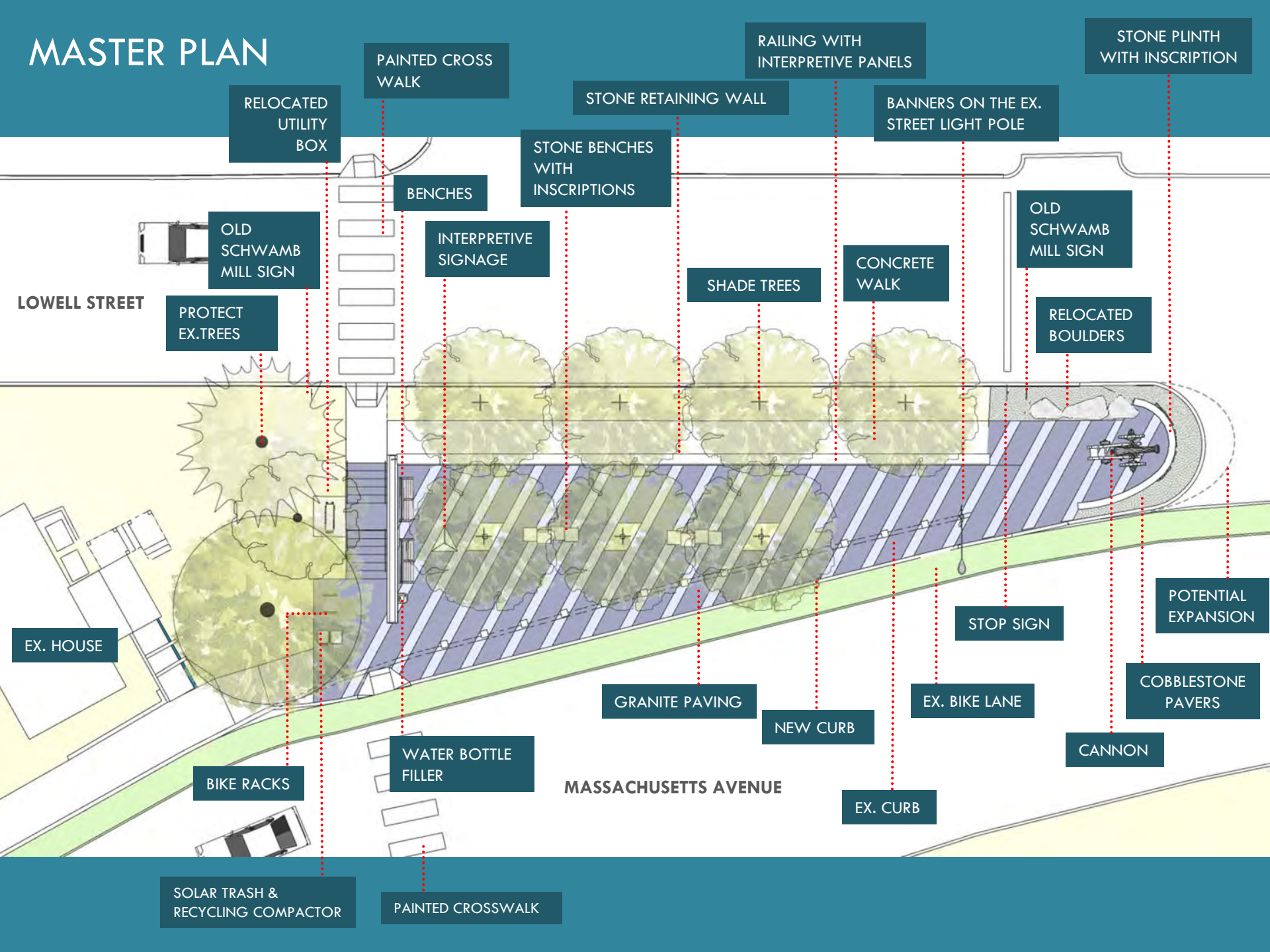

LOWELL STREET

MASSACHUSETTS AVENUE

OLD SCHWAMB MILL SIGN

PROTECT EX.TREES

EX. HOUSE

BIKE RACKS

SOLAR TRASH & RECYCLING COMPACTOR

PAINTED CROSS WALK

RELOCATED UTILITY BOX

BENCHES

INTERPRETIVE SIGNAGE

STONE BENCHES WITH INSCRIPTIONS

WATER BOTTLE FILLER

PAINTED CROSSWALK

STONE RETAINING WALL

RAILING WITH INTERPRETIVE PANELS

SHADE TREES

GRANITE PAVING

NEW CURB

EX. CURB

BANNERS ON THE EX. STREET LIGHT POLE

CONCRETE WALK

STOP SIGN

EX. BIKE LANE

STONE PLINTH WITH INSCRIPTION

OLD SCHWAMB MILL SIGN

RELOCATED BOULDERS

POTENTIAL EXPANSION

COBBLESTONE PAVERS

CANNON

VIEW FROM MASS AVE.

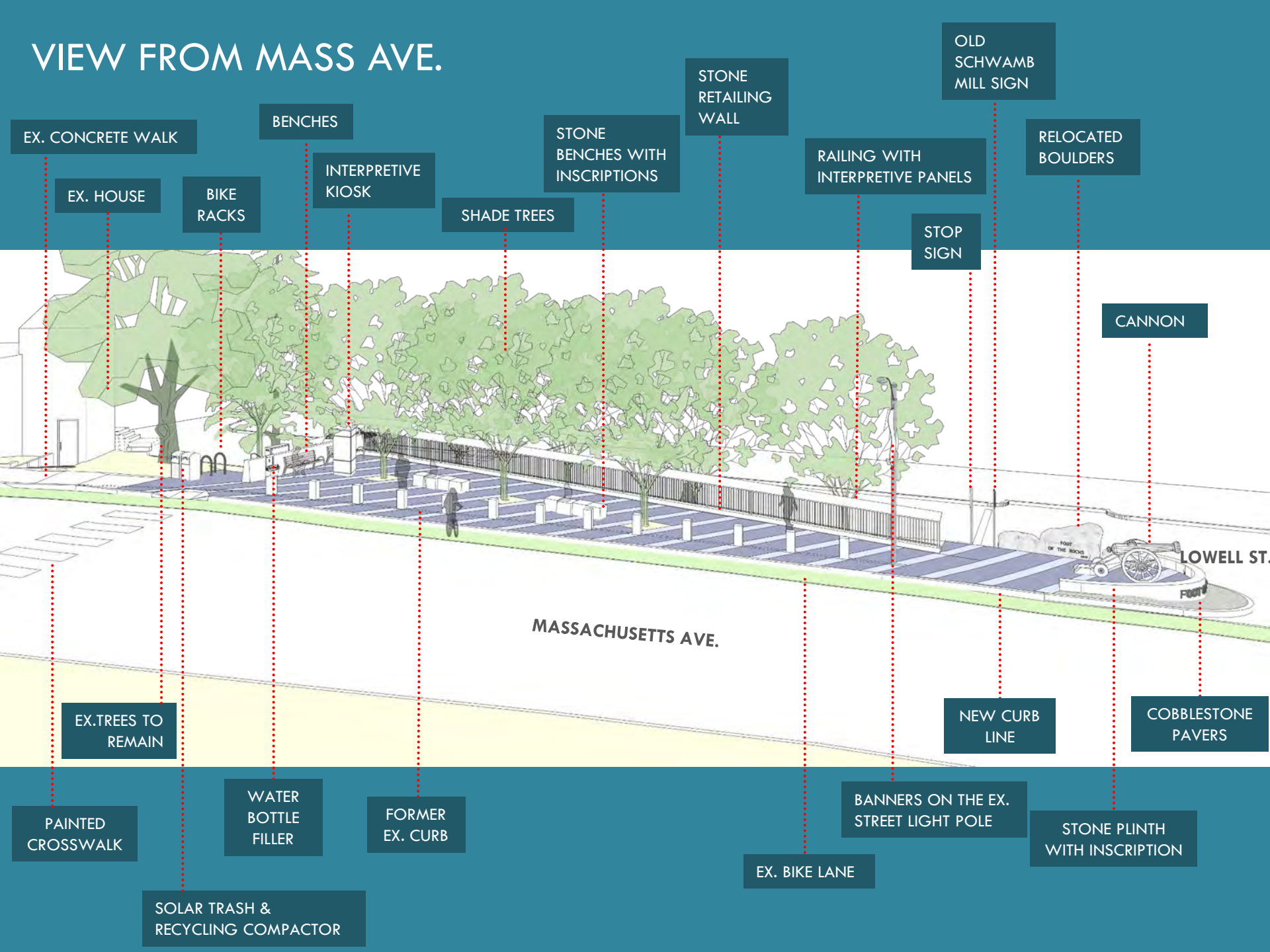

EX. CONCRETE WALK

BENCHES

STONE BENCHES WITH INSCRIPTIONS

STONE RETAILING WALL

OLD SCHWAMB MILL SIGN

RELOCATED BOULDERS

EX. HOUSE

BIKE RACKS

INTERPRETIVE KIOSK

SHADE TREES

RAILING WITH INTERPRETIVE PANELS

STOP SIGN

CANNON

EX. TREES TO REMAIN

MASSACHUSETTS AVE.

NEW CURB LINE

COBBLESTONE PAVERS

PAINTED CROSSWALK

WATER BOTTLE FILLER

FORMER EX. CURB

BANNERS ON THE EX. STREET LIGHT POLE

STONE PLINTH WITH INSCRIPTION

SOLAR TRASH & RECYCLING COMPACTOR

EX. BIKE LANE

LOWELL ST.

VIEW FROM LOWELL STREET

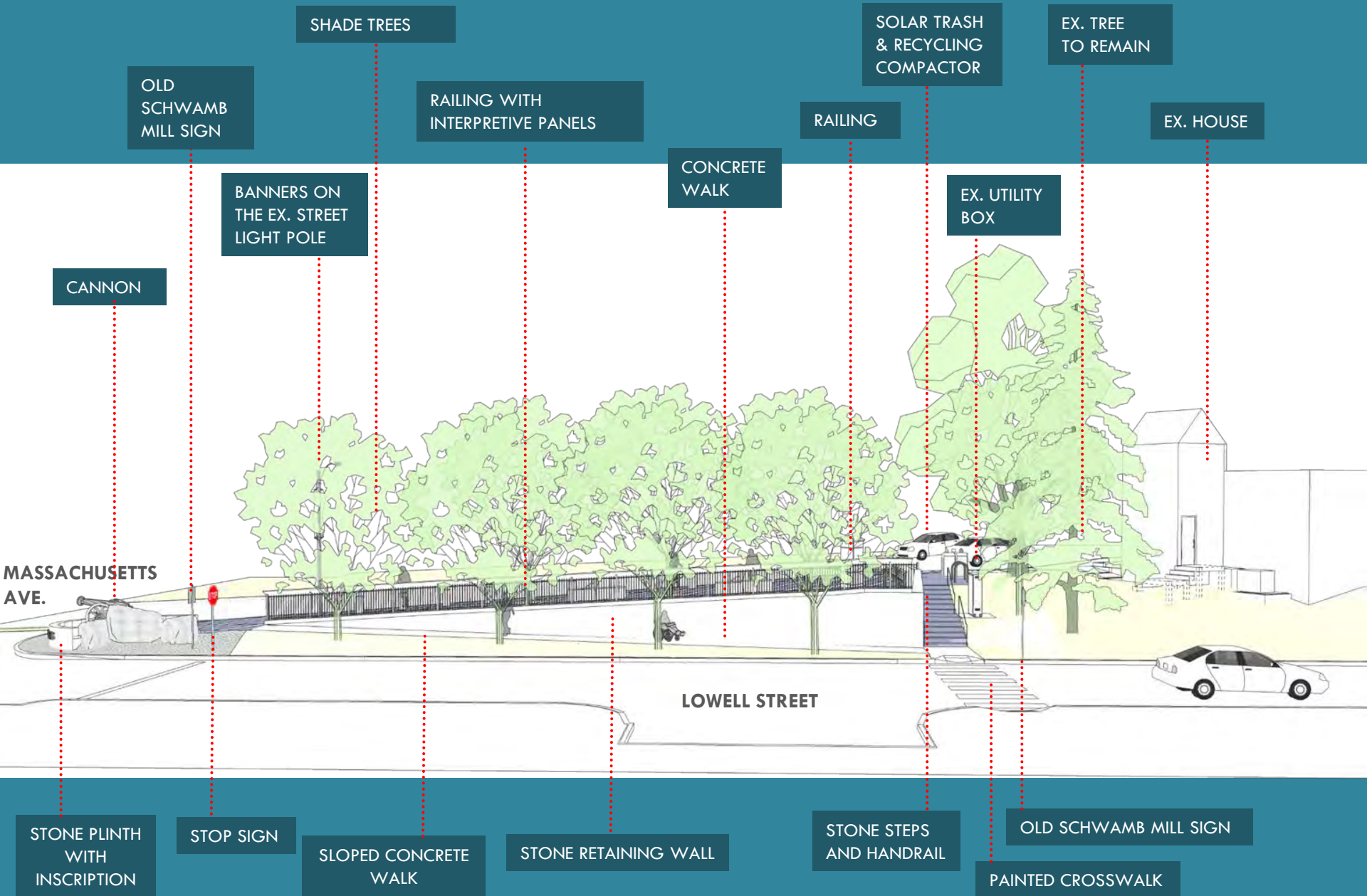

VIEW FROM MASS. AVE HEADING WEST



MASSACHUSETTS AVE.

LOWELL ST.

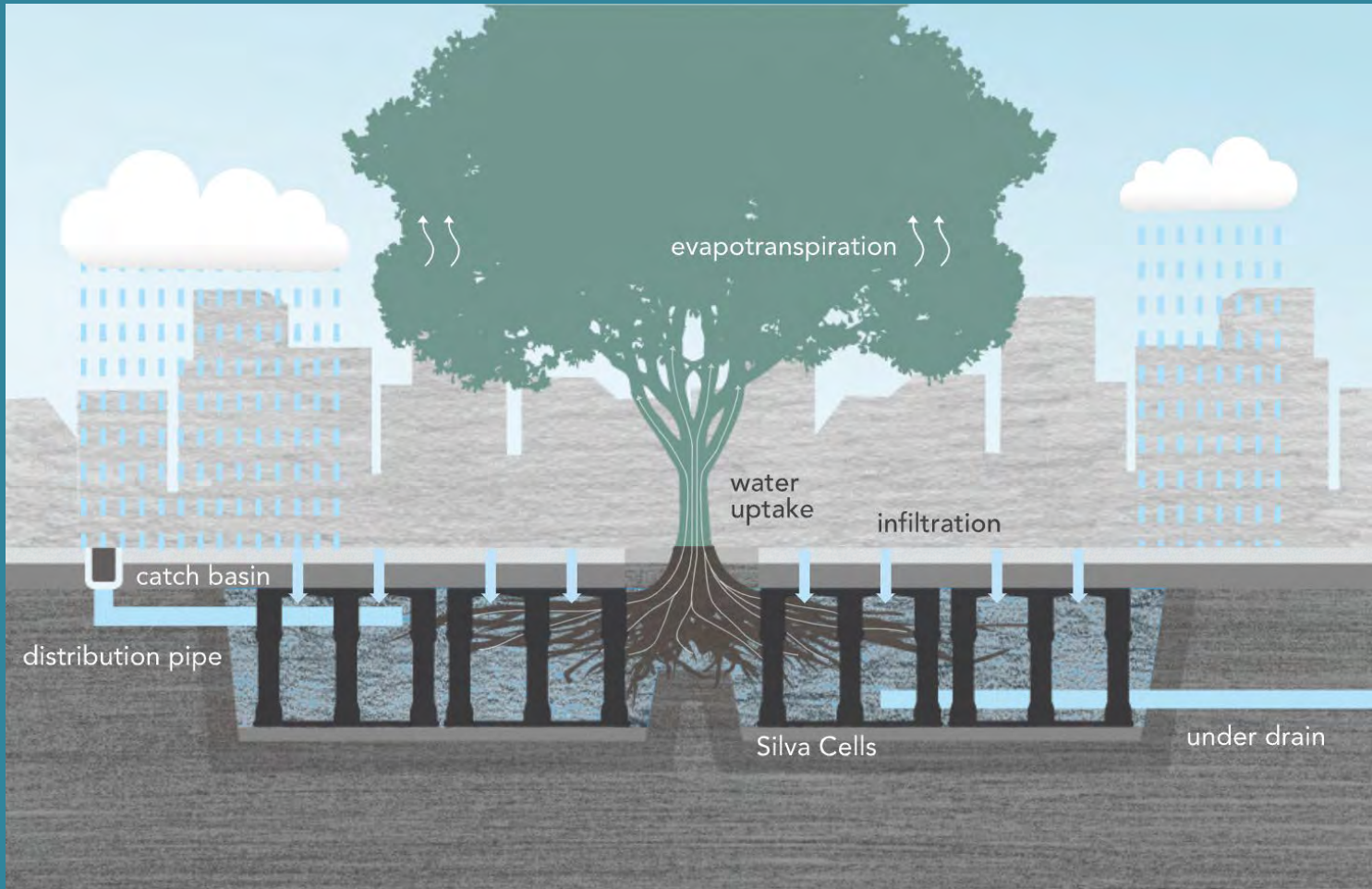

STORMWATER MANGEMENT DIAGRAM

STORMWATER MANAGEMENT – PLAN

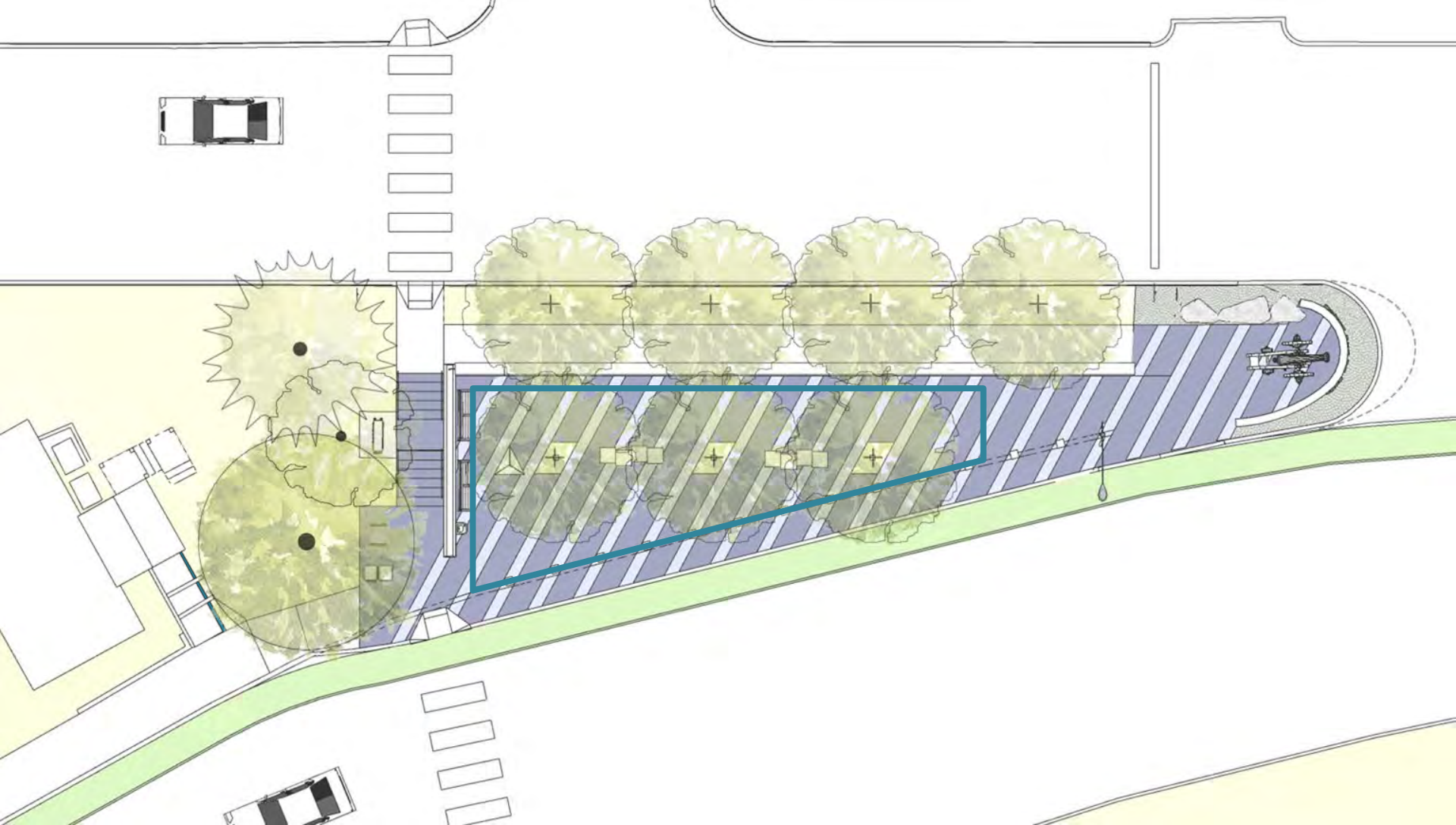

STORMWATER MANAGEMENT – SITE SECTION

SUSPENDED
PAVEMENT AND
PERMEABLE PAVERS

INFILTRATION

EVAPOTRANSPIRATION

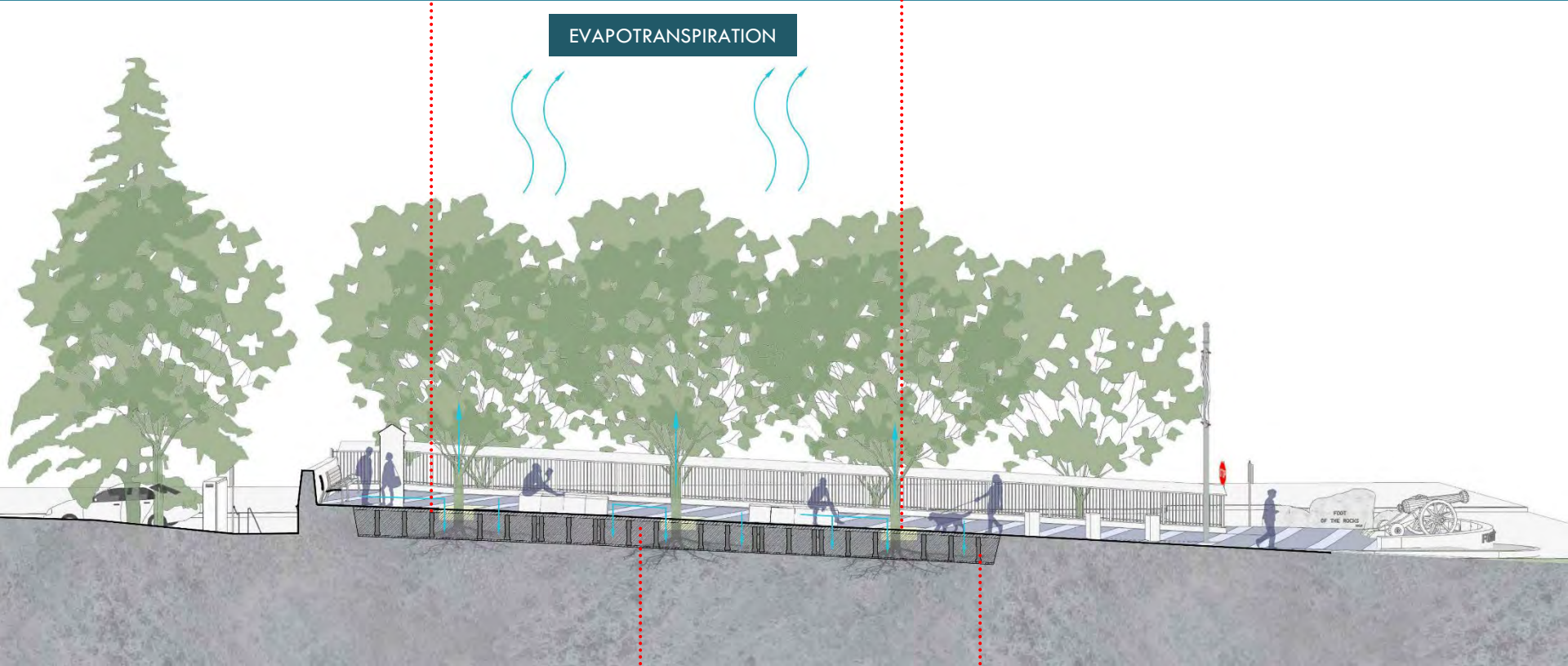

BIORETENTION SOIL MIX

SILVA CELLS

PRECEDENT IMAGES

INTERPRETIVE SIGN AND STONE MARKERS

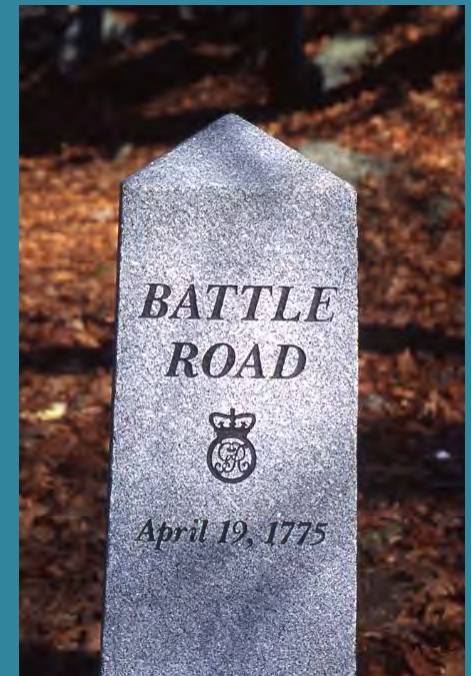

SEATING AND WALLS



SITE AMENITIES



PLANTING



NEXT STEPS

- Cost Estimate
- Funding
- Schematic Design
- Development & design of interpretive information
- Working Group & Community meetings
- Design Development
- Construction Drawings and Bid Documents
- Construction

QUESTIONS & DISCUSSION

THANK YOU!