

1021 & 1025 MASSACHUSETTS AVENUE  
 ARLINGTON, MASSACHUSETTS  
 DRAWN BY: [ ] DATE: 02-02-2023  
 CHECKED BY: [ ] PROJECT No: 21-32

REVISIONS	DATE	BY	DESCRIPTION

**PATRIOT Engineering**  
 35 BEDFORD STREET, SUITE 4  
 LEXINGTON, MASSACHUSETTS 02420  
 T: (978) 726-2654  
 www.patriot-eng.com

CONCEPTUAL SITE PLAN  
 LOCATED IN  
 ARLINGTON, MA  
 (MIDDLESEX COUNTY)  
 PREPARED FOR  
 MAJ INVESTMENT, LLC

SHEET  
 CP-1

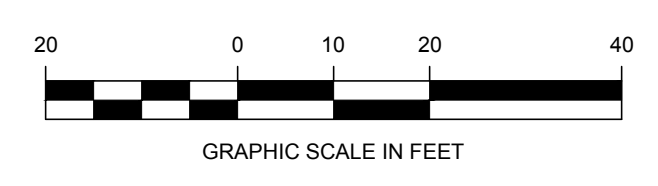
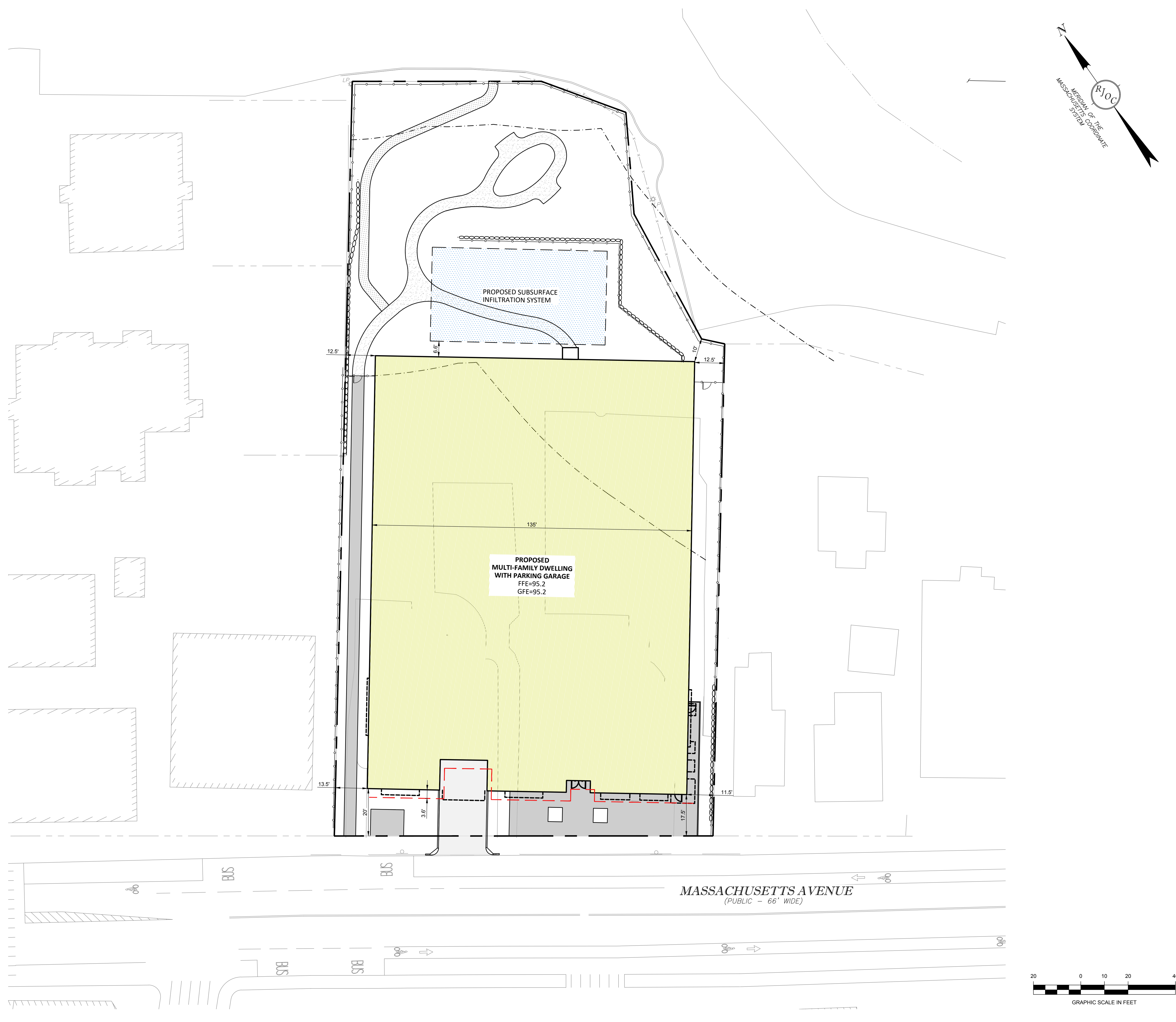

1021 & 1025 MASSACHUSETTS AVENUE  
ARLINGTON, MASSACHUSETTS  
DRAWN BY: [REDACTED] DATE: 02-02-2023  
CHECKED BY: [REDACTED] PROJECT No: 21-32

REVISIONS	DATE	BY	DESCRIPTION

**PATRIOT Engineering**  
35 BEDFORD STREET, SUITE 4  
LEXINGTON, MASSACHUSETTS 02420  
T: (978) 726-2654  
www.patriot-eng.com

CONCEPTUAL SITE PLAN  
LOCATED IN  
ARLINGTON, MA  
(MIDDLESEX COUNTY)  
PREPARED FOR  
MAJ INVESTMENT, LLC