



Arlington Town Yard Facility

51 GROVE ST., ARLINGTON, MA 02476

On Site Assistance Contact:
Mike Dupuis
Commodore Builders
mdupuis@commodorebuilders.com
C: (508) 294 3836

Construction Update 05/01/23



PHASE 2 BUILDING CONSTRUCTION: MAY 2023 – JUNE 2023

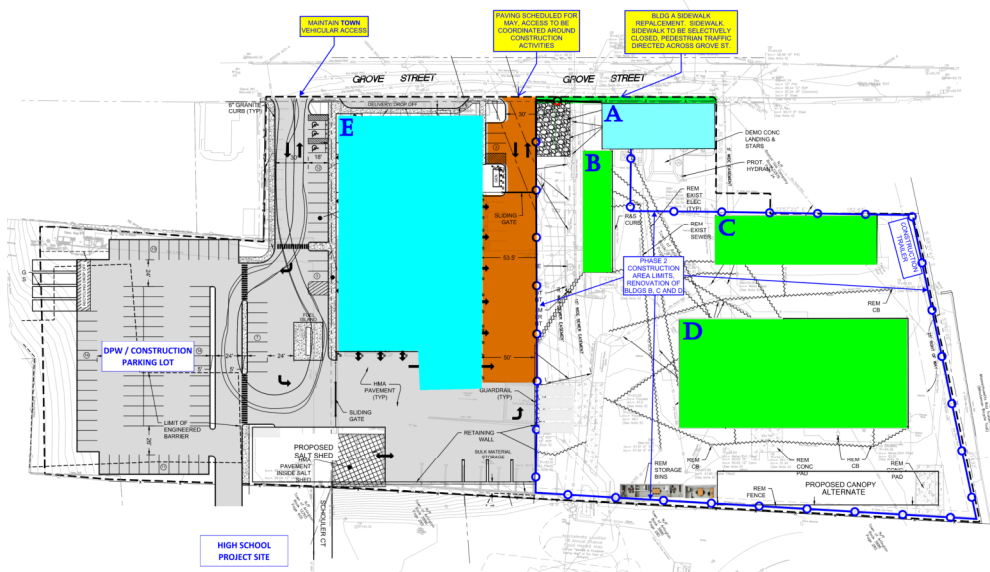

STAY INFORMED

Construction updates will be provided monthly and posted at: arlingtonma.gov/projects
They will also be included in Town of Arlington Notices (email). You may subscribe to Town Notices at: arlingtonma.gov/connect

CONSTRUCTION DETAILS

Phase 2 shall include the renovation of Buildings B, C and D. Also, the Brook Culvert will be lined and access between Buildings A and B will be reworked.

CONSTRUCTION SAFETY

The health and safety of the community and workers on site are of the highest priority. There will be continuous air monitoring and dust control in place with misters. Commodore safety department will undertake regular safety visits.

CONSTRUCTION 4 WEEK SCHEDULE – STARTING WEEK OF MAY 1, 2023

The above layout identifies demolition areas in the work site and impacts along Grove Street. Additional work to be performed in the upcoming weeks includes:

CONSTRUCTION ACTIVITIES:

- Building E – Final Inspections
- Building E – Fuel Island Completion
- Building E – Punchlist Completion
- Building E – Landscaping, Fencing & Site Lighting
- Building A – Complete Window/Storefront & Finishes
- Sitework – Underground Tank & Material Stockpile Removal
- Sitework – Complete Curbing, Final Grading, Binder & Finish Pavement

PUBLIC IMPACTS:

- During sitework, trucks will be entering and leaving the site regularly
- Sidewalk replacement along Grove St.
- Additional weekend construction, weather permitting





Photo #1 – Building E View from Grove Street (4/5/23)



Photo #2 – Building E Curbing and Sidewalk in Progress (4/5/23)



Photo #3 – PEMB Exterior in Progress (4/5/23)



Photo #4 – Exterior Concrete Pads Placed (4/5/23)



Photo #5 –PEMB Maintenance in Progress (4/5/23)



Photo #6 –Flooring in Progress (4/5/23)



Photo #7 – Stairs and Railings in Progress (4/5/23)



Photo #8 – Stairs and Railings in Progress (4/5/23)



Photo #9 – Wash Bay MEPFP in Progress (4/5/23)



Photo #10 – PEMB Wash Bay Exterior (4/5/23)