



# Arlington Town Yard Facility

51 GROVE ST., ARLINGTON, MA 02476

On Site Assistance Contact:  
Mike Dupuis  
Commodore Builders  
mdupuis@commodorebuilders.com  
C: (508) 294 3836

Construction Update 05/29/23

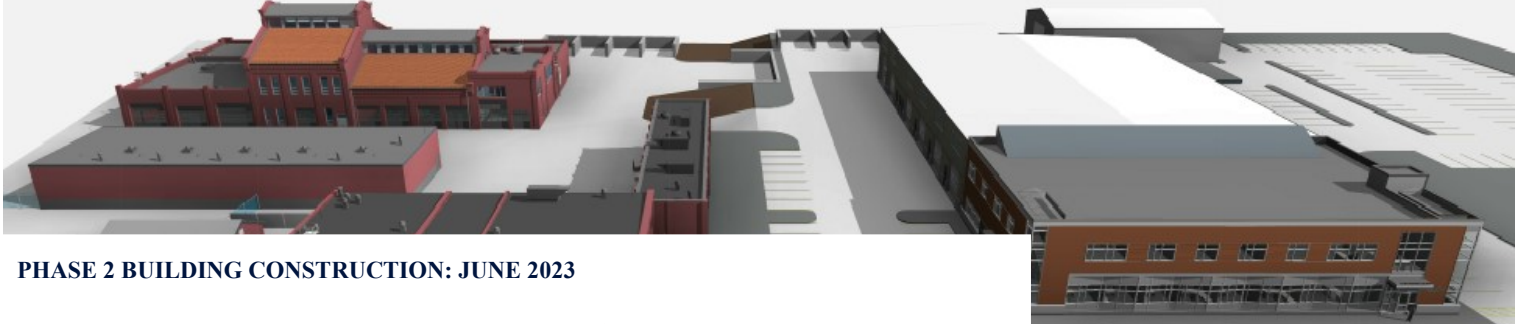

## PHASE 2 BUILDING CONSTRUCTION: JUNE 2023

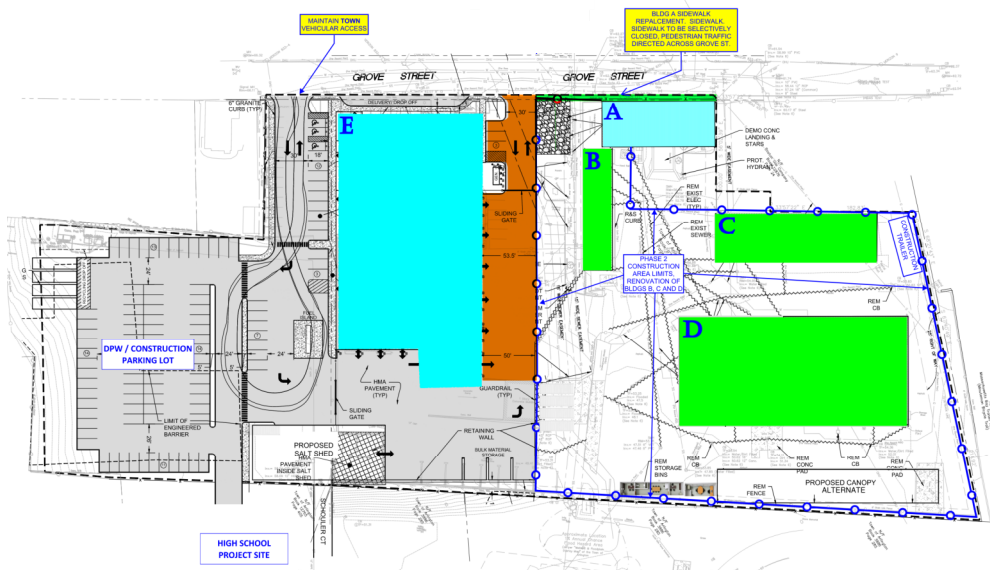

### STAY INFORMED

Construction updates will be provided monthly and posted at: [arlingtonma.gov/projects](http://arlingtonma.gov/projects)  
They will also be included in Town of Arlington Notices (email). You may subscribe to Town Notices at: [arlingtonma.gov/connect](http://arlingtonma.gov/connect)

### CONSTRUCTION DETAILS

Phase 2 shall include the renovation of Buildings B, C and D. Also, the Brook Culvert will be lined and access between Buildings A and B will be reworked.

### CONSTRUCTION SAFETY

The health and safety of the community and workers on site are of the highest priority. There will be continuous air monitoring and dust control in place with misters. Commodore safety department will undertake regular safety visits.

### CONSTRUCTION 4 WEEK SCHEDULE – STARTING WEEK OF MAY 29, 2023

The above layout identifies demolition areas in the work site and impacts along Grove Street. Additional work to be performed in the upcoming weeks includes:

#### CONSTRUCTION ACTIVITIES:

- Building E – Final Inspections & Punchlist Completion
- Building A – Final Inspections and Punchlist Completion
- Building B – Temp Protection and Make Safe MEPFP for Upcoming Demo & Abatement
- Sitework – Landscaping, Hardscaping, and additional Sidewalk Work
- Sitework – Two Power Pole Relocations

#### PUBLIC IMPACTS:

- During sitework, trucks will be entering and leaving the site regularly
- Sidewalk replacement along Grove St.
- Additional weekend construction, weather permitting





Photo #1 – Building E Maintenance Bay - Typical (05/12/23)



Photo #2 – Building E Maintenance (5/12/23)





Photo #3 – Building E Maintenance (5/12/23)



Photo #4 – Building E Admin. Skylights Installed (5/3/23)





Photo #5 – Building E Admin – Dispatch (5/12/23)



Photo #6 – Building A Facilities Work Shop Level 1 (5/12/23)





Photo #7 – Building A Facilities Work Shop Mezzanine (5/4/23)



Photo #8 – Building A Convenience Kitchen 1<sup>st</sup> Floor (5/15/23)