

Menotomy Rocks Park Play Area

Community Meeting

6 DECEMBER 2023



Agenda

- Project Team Introduction
- Firm Background
- Design Roadmap & Project Overview
- Context
- Park History
- Existing Conditions & Site Analysis
- Community Feedback
- Playground Inspiration
- Concept Layouts
- Schedule + Next Steps



Project Team Introduction

JOE CONNELLY

Director of Recreation

LESLIE MAYER

Park Commission Member

JEN ROTHENBERG

Park Commission Member

SARAH CARRIER

Park Commission Associate Member

ADAM LANE

Friends of Menotomy

JOANN ROBINSON

Historical Commission

TIM ROSS

ADA Coordinator



IAN RAMEY

ASLA, PLA, LEED AP
Principal in Charge



EMILY HUNT

ASLA, PLA, CPSI
Project Manager



OLIVIA SO

Landscape Designer

Consultants

CIVIL ENGINEERING

Hancock Associates

SURVEYING

Reed Land Surveying, Inc.

Firm Background



Healy Playground



Dorchester Park Playground



Ryan Playground



King Open Elementary Schoolyard



Montshire Science Park

Menotomy Rocks Park Play Area

TOWN OF ARLINGTON | 6 DECEMBER 2023

Design Road Map

Courtesy of Sarah Carrier

DATA GATHERING & ANALYSIS



- Existing Conditions
- Site Analysis

VISIONING



- Methodology
- Spatial Programming
- Precedents
- Public Input

CONCEPT DEVELOPMENT

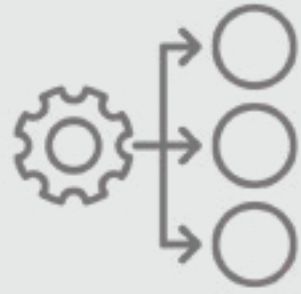

- Key Design Moves
- Activation Studies

LANDSCAPE STRATEGIES



- Movement, Access & Accessibility
- Play typologies
- Sustainability & Planting Strategy

CONSTRUCTION



- Design Documents
- Park Construction

we're excited to hear from you!



Project Overview

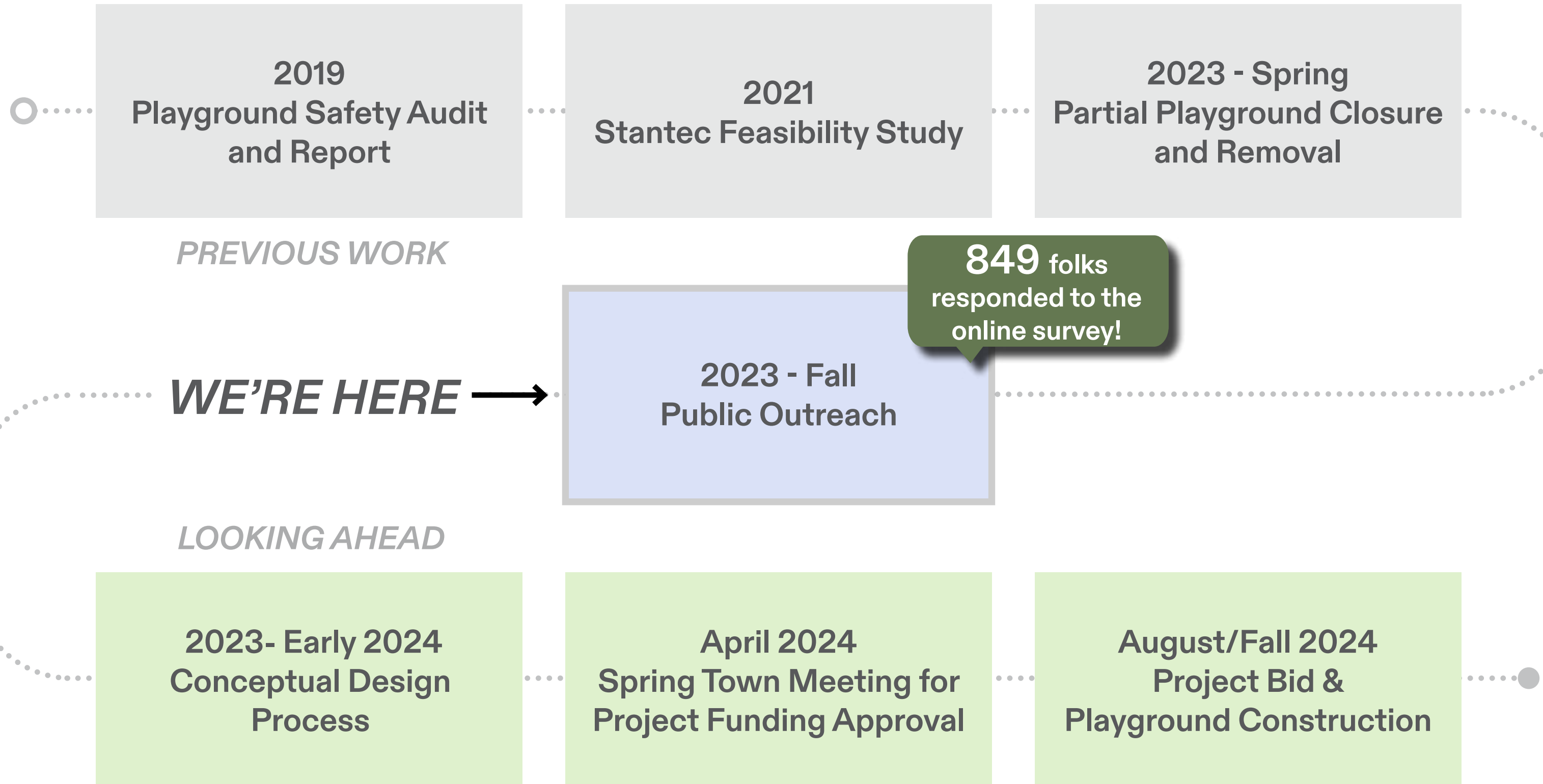

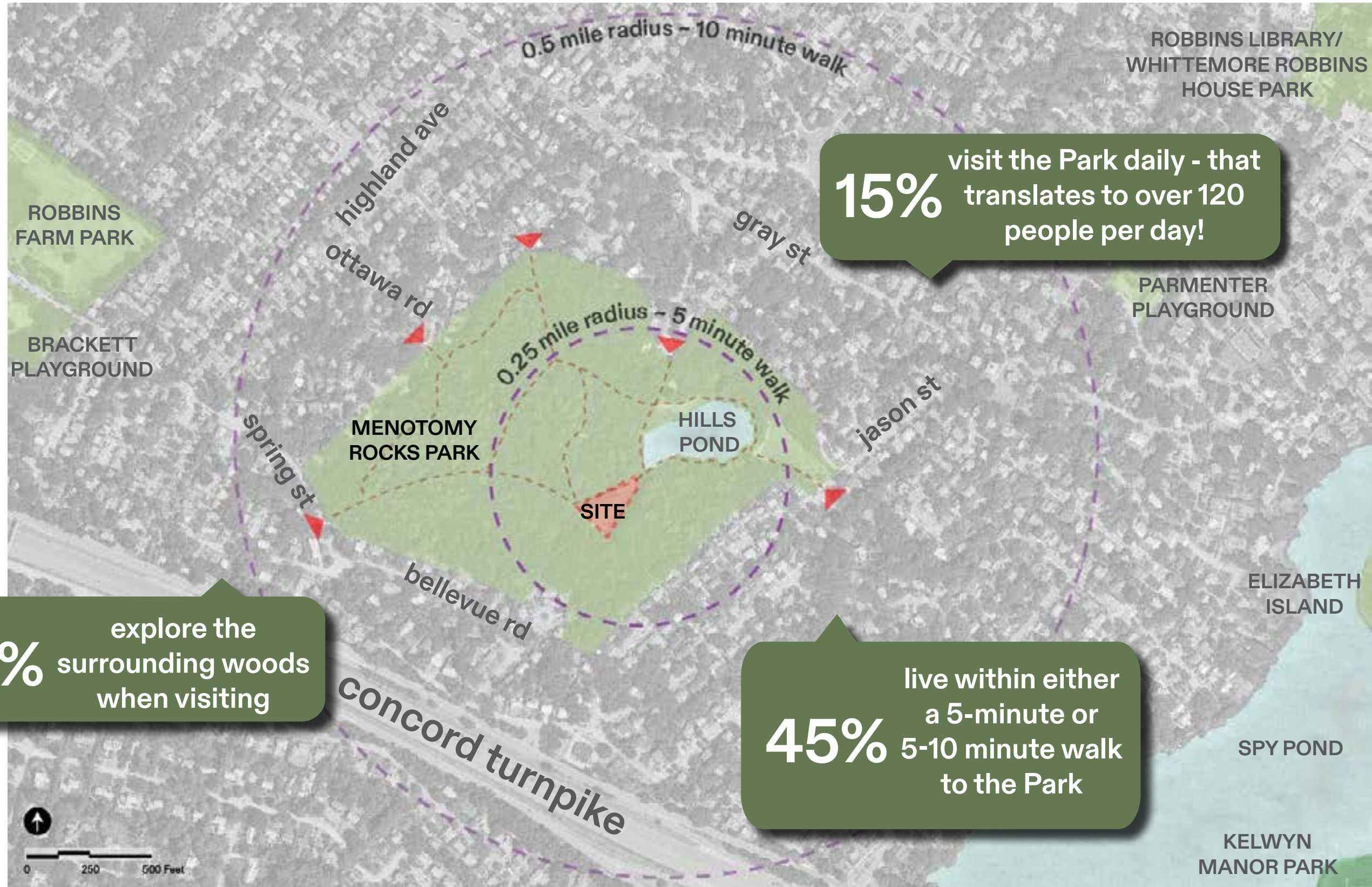



Courtesy of Robbins Library, Arlington, Massachusetts

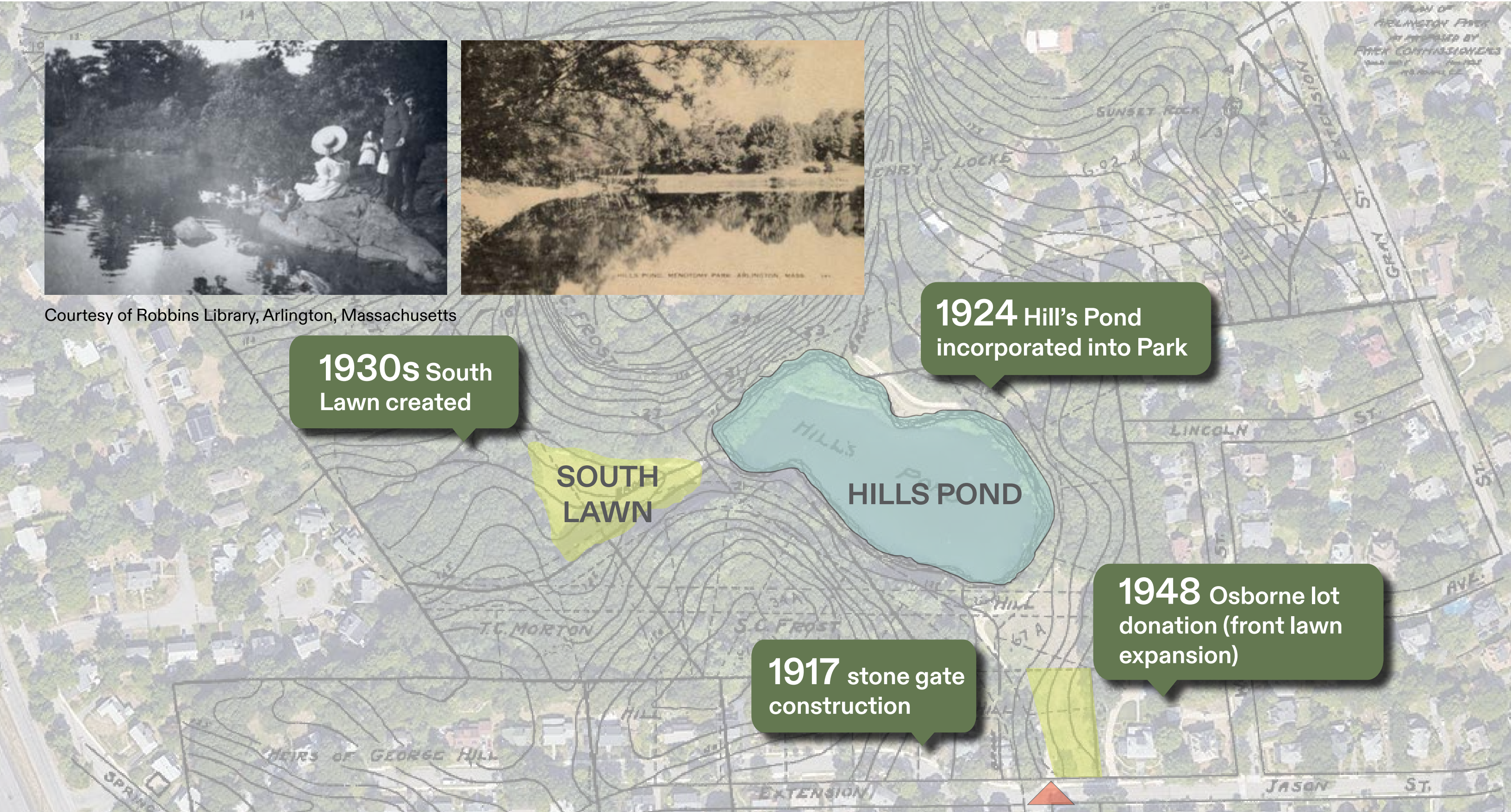

1930s South Lawn created

SOUTH LAWN

1917 stone gate construction

1924 Hill's Pond incorporated into Park

1948 Osborne lot donation (front lawn expansion)



Left: Stantec Report (2021)



1993 Friends of Menotomy Rocks Park (FoMRP)

1952 first play area installed
1977 play area additions and fitness equipment in 1977

SOUTH LAWN

HILLS POND

1994 Hill's Pond dredged and restored

1994 lawn reconstructed during pond dredging project
1996 playground renovation

did you know: many of the pine trees are over 100 years old! They were planted in 1909 following gypsy moth damage

Wildlife haven:
Screech Owl, Barred Owl, Great Horned Owls
Swans
Great Blue Heron, Green Heron
Redwing Blackbirds
Red-bellied Woodpecker
Turtles
Chipmunks
Raccoons
Frogs
...and more!

Great Horned Owls and awareness about rat poison

Invasive plant removal volunteer groups

What else have you seen at the park?

which animals have you seen in the Park? Tell us in the chat!

Courtesy of Sarah Carrier

“Please keep nature and natural materials at the forefront of your design process.”



“This is a rare spot in which kids (and adults) have the opportunity to play in nature. There’s no need to overbuild, or even build much at all.”



“Our kids love the lean-to’s in the park area. I could see tunnels, logs, and other woodsy type of imaginative play being so great here.”



“We love woodhenge and have had a Girl Scout meeting there once a month for 3 years!”

“ Please do not cut trees back. I use them for shade and shelter from rain/snow. This site is one of only places we can go during the summer midday where my child can play in the shade.”



“Menotomy Rocks park is at the top places in Arlington to go to connect with nature and feel the spirit of Menotomy.”



“ I love to go on runs through the park and bring my dog for walks there, and the natural state of the park and woods is my favorite part.”



“The park is a treasure. We loved the playground when our kids were younger in part because it was less-busy than Robbins Farm.”

35% of respondents bring dogs to the park and over **60%** prefer no fencing at the play area or lawn space

Existing Conditions | Site Analysis

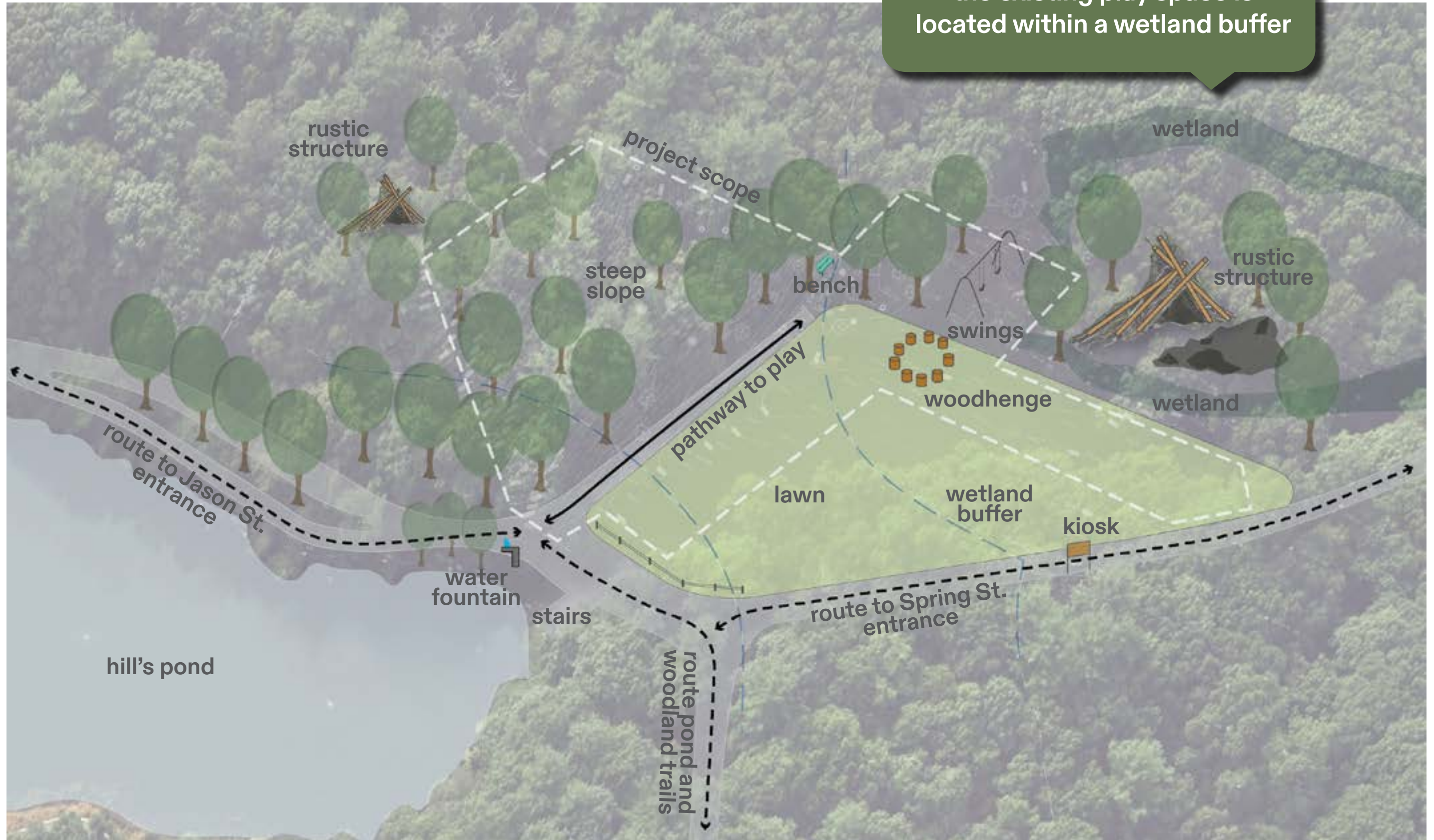

Menotomy Rocks Park Play Area

TOWN OF ARLINGTON | 6 DECEMBER 2023

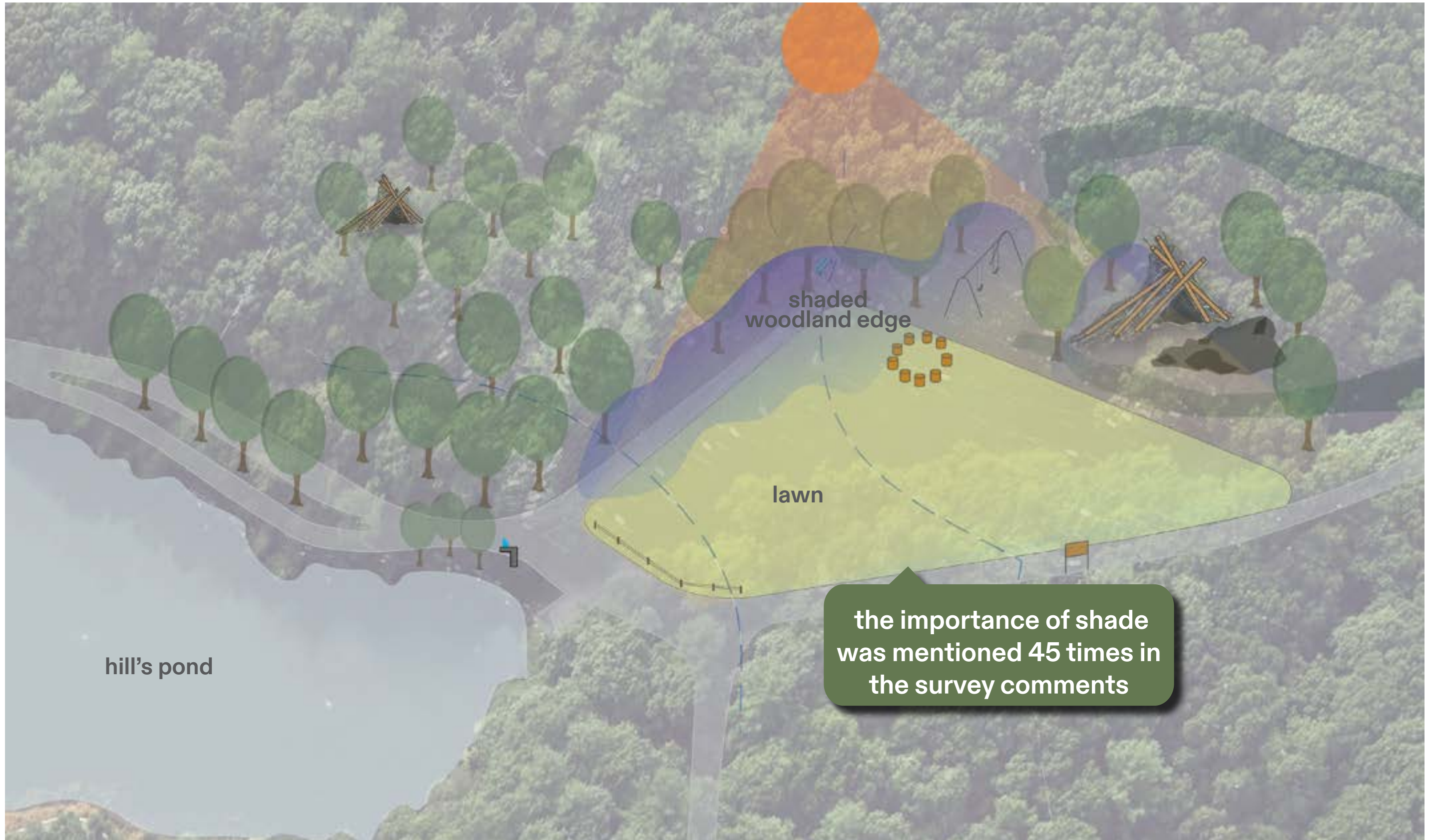

Existing Conditions | Wetlands

the wetlands were confirmed by a botanist/wetland scientist and survey crew in Fall 2023



Community Feedback | Meet and Greet

limited play opportunities for the 5-12 age group - many drive children to nearby neighborhood parks for suitable play equipment

preserve existing trees

take inspiration from nature

appreciate the current amount of shade over the existing play equipment and maintain current tree canopy



Menotomy Rocks Park Play Area

TOWN OF ARLINGTON | 6 DECEMBER 2023

Community Feedback

- top **3** current activities
- #1** explore the surrounding woods
 - #2** use playground equipment
 - #3** nature play



belt swings and group/basket swings are the top preferences

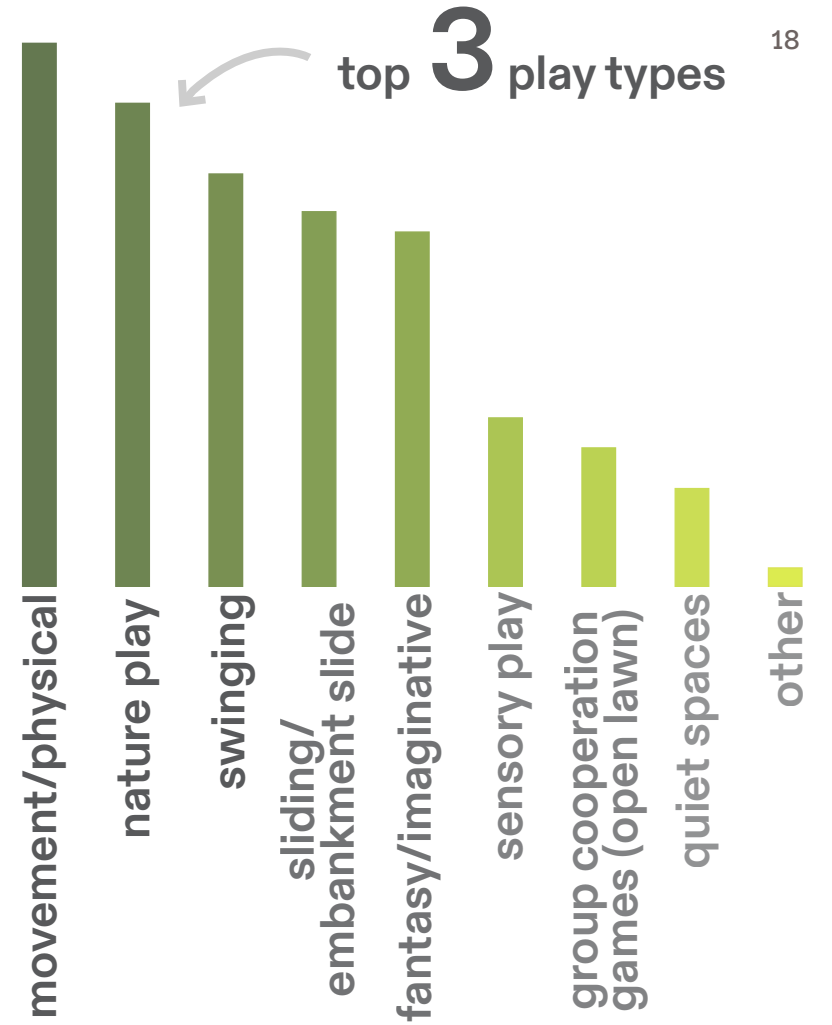

please remember our babies and toddlers - baby swings, some smaller slides, etc.

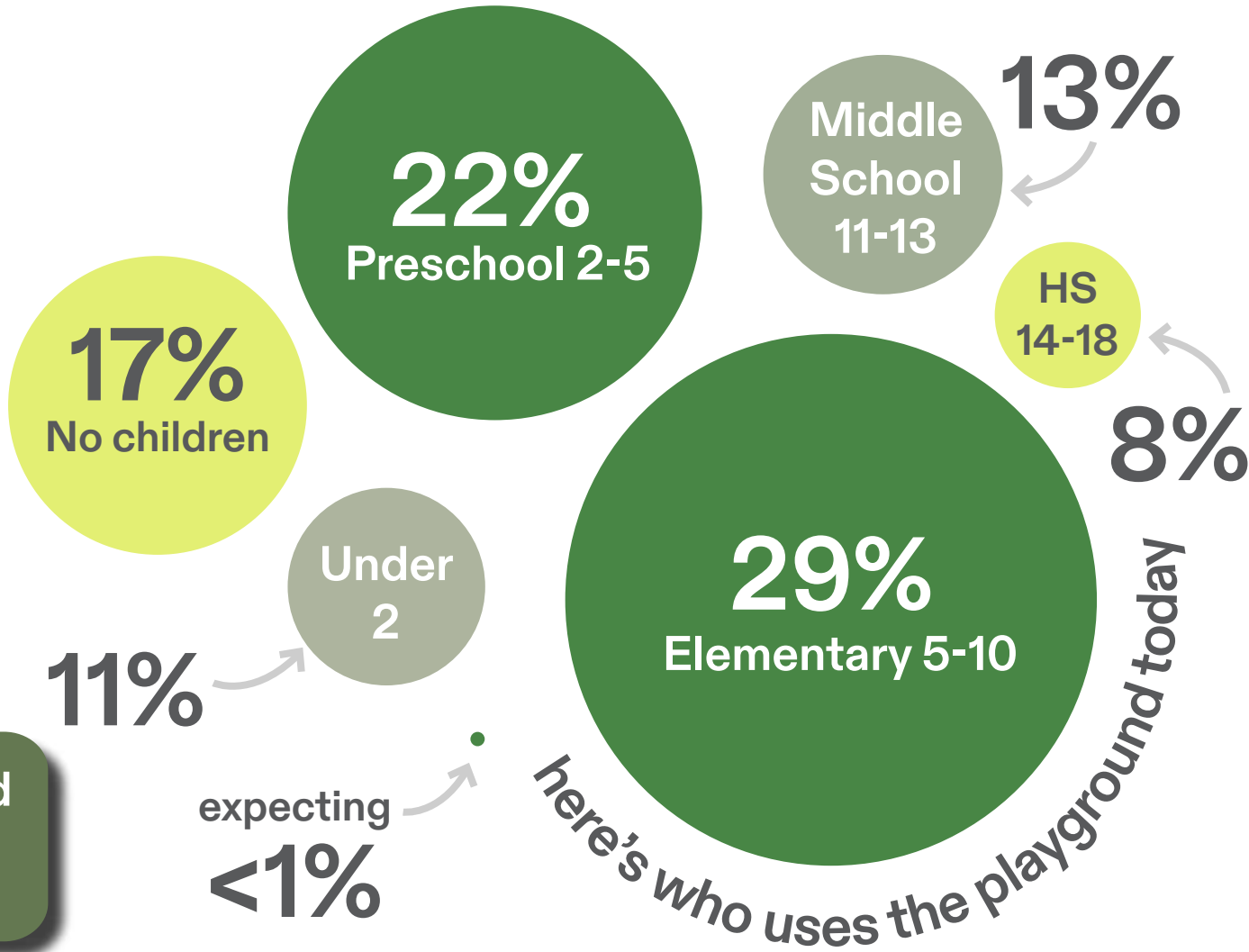

50% would prefer small group picnic seating and this was the most desired amenity



Community Feedback

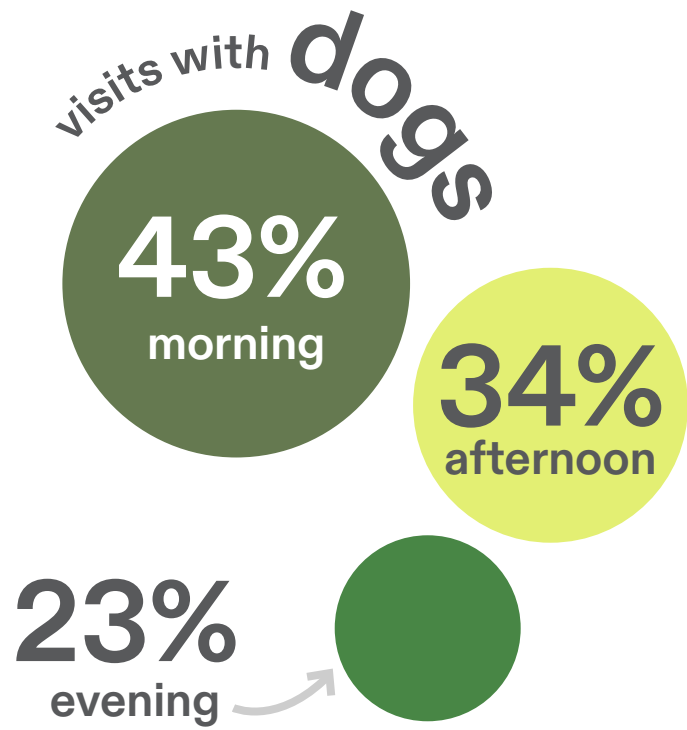

we also heard **bird watching**

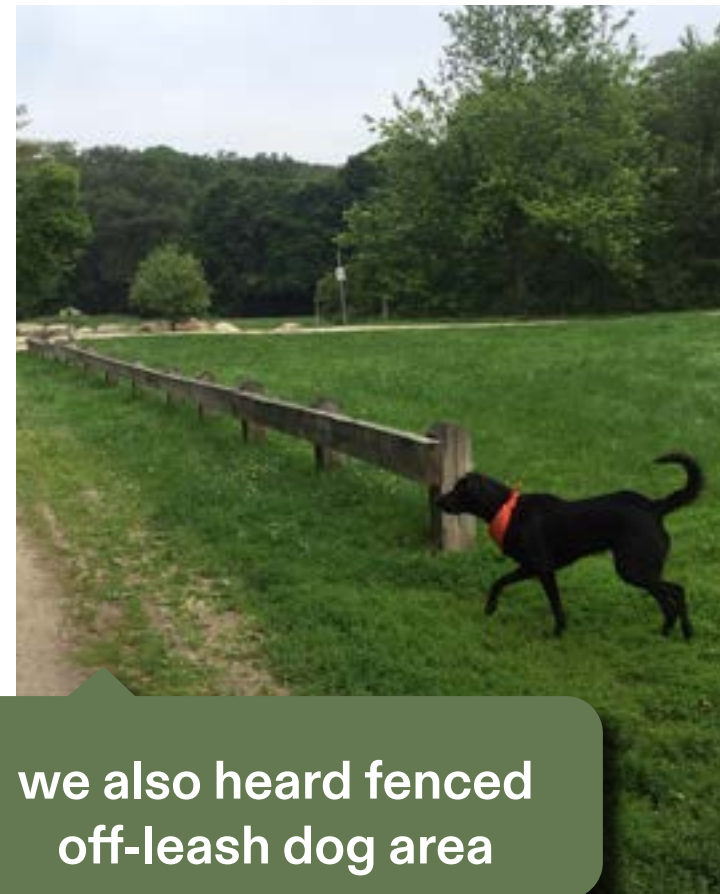
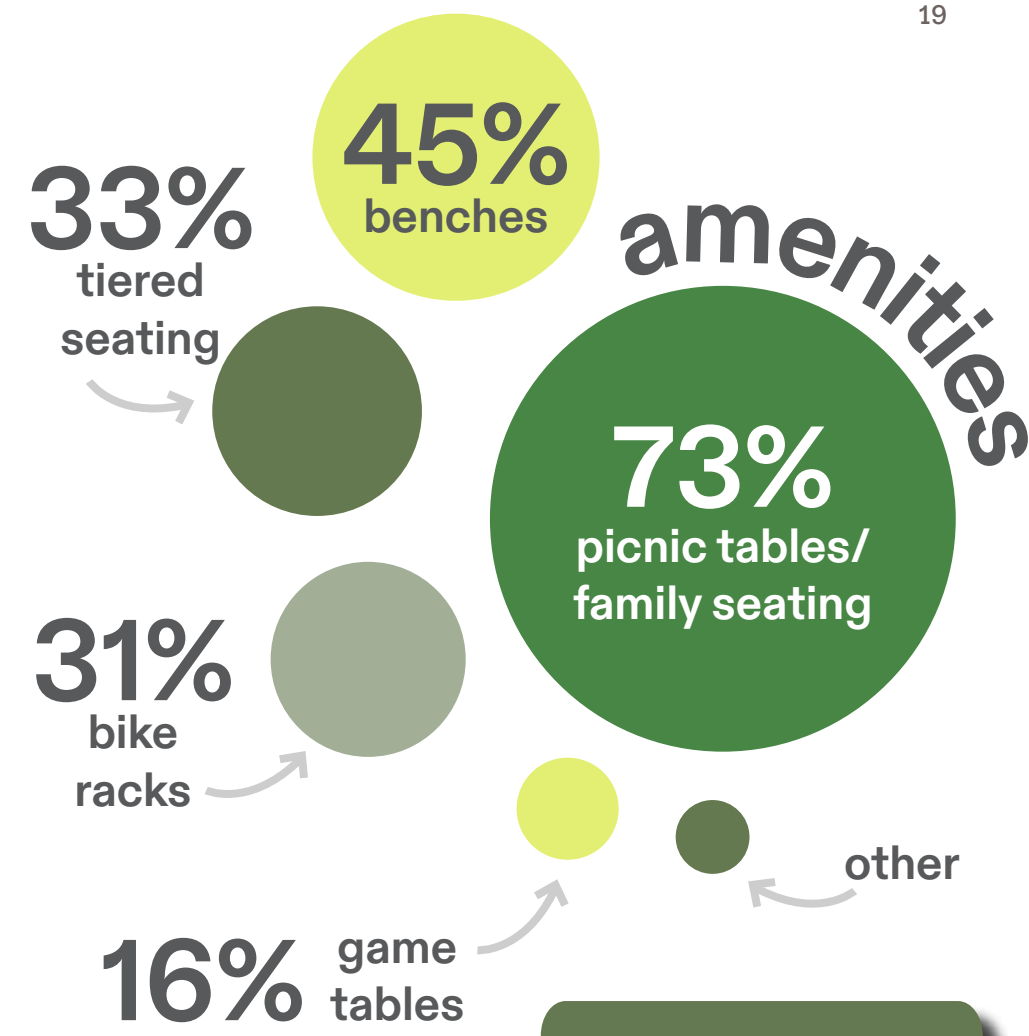

we also heard fenced off-leash dog area

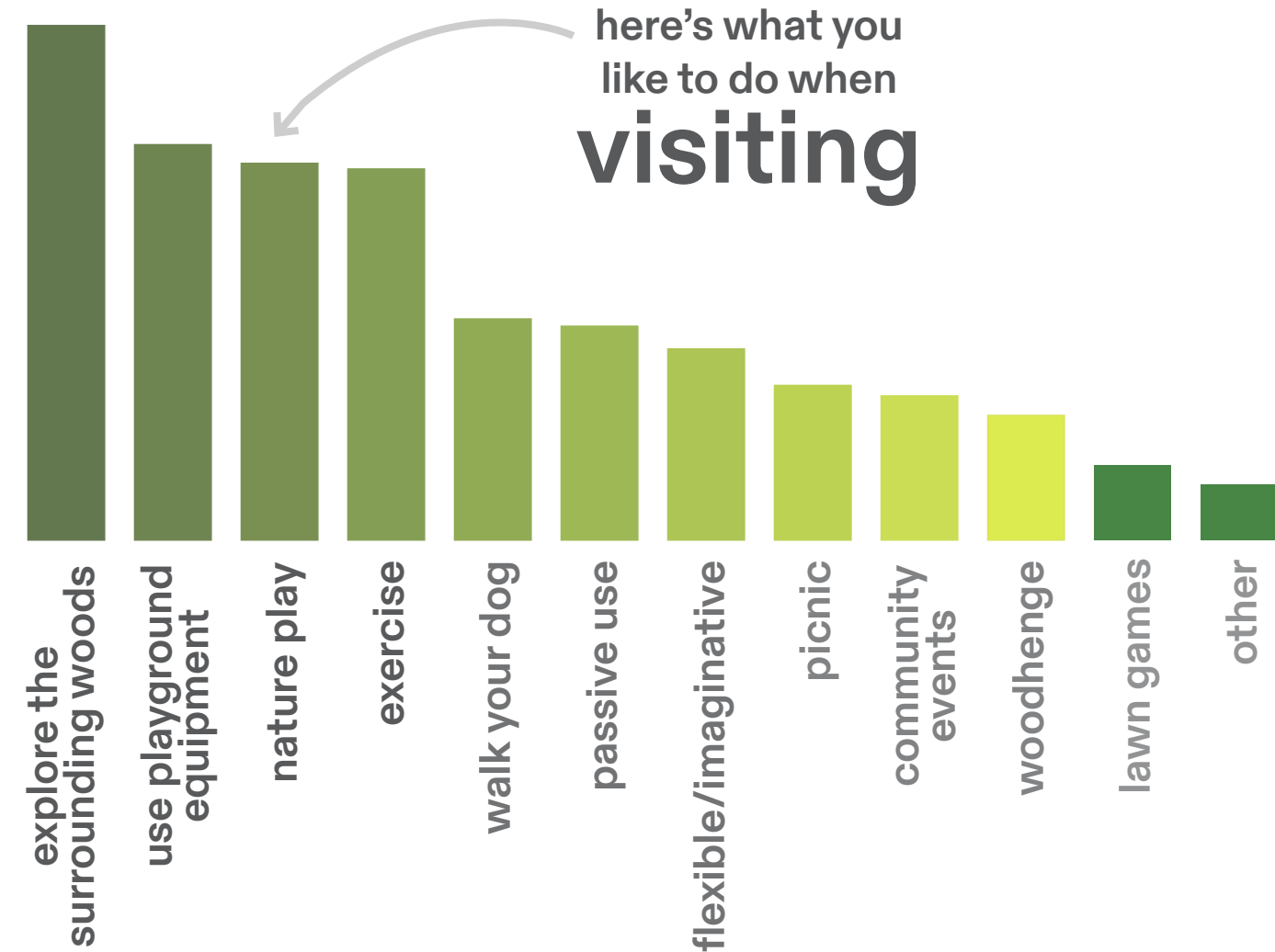

we also heard **sledding areas**



Menotomy Rocks Park Play Area

TOWN OF ARLINGTON | 6 DECEMBER 2023

Play Area Inspiration

“Something unique for multiple kids and imaginative play like the undulating giant lashed rope swing at the Rez”



“Classic metal slippery slide would be fun. New slides don’t slide anymore. Kids love a real slide”



“Exercise stations for all ages”



“We love Joey’s in Belmont as an example of wood playground and swings”

did you know: the existing fitness equipment was built in 1977 making it almost 50 years old!

Play Area Inspiration

nearly 75% prefer natural materials for the play equipment

“Wooden climbing structure shaped like a nest... Little bridge or boardwalk between boulders”



“Please don’t overdevelop this beautiful park. Most of us go there to enjoy the woods and nature!”



“The kids say ‘more monkey bars’ ... ‘lots of monkey bars’ ...”



“Menotomy Rocks Park is an excellent area to introduce outdoor adventure to kids 2 - 10 years”

Play Area Inspiration | Conceptual Layout A

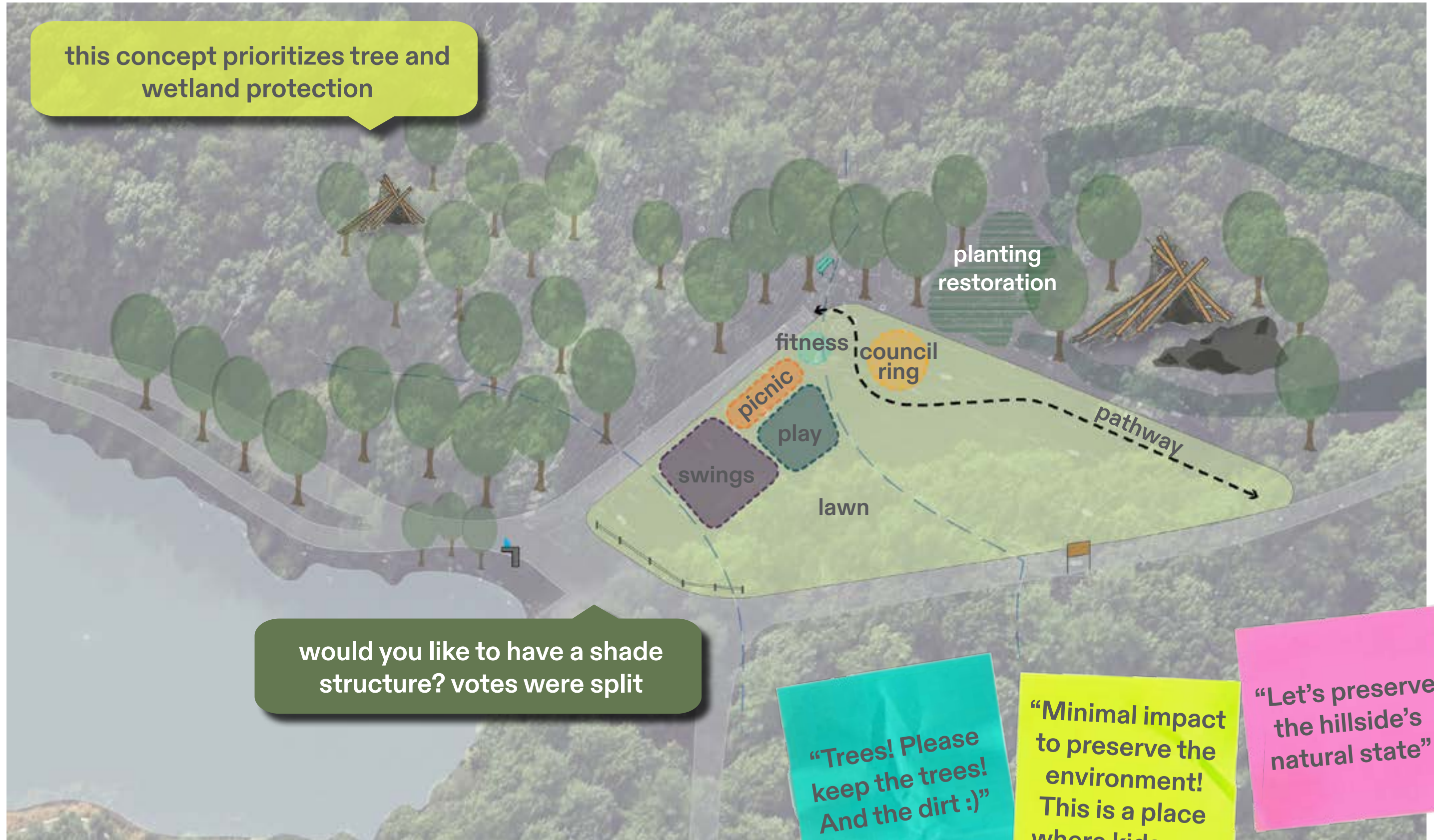

Menotomy Rocks Park Play Area

TOWN OF ARLINGTON | 6 DECEMBER 2023

Play Area Inspiration | Conceptual Layout B

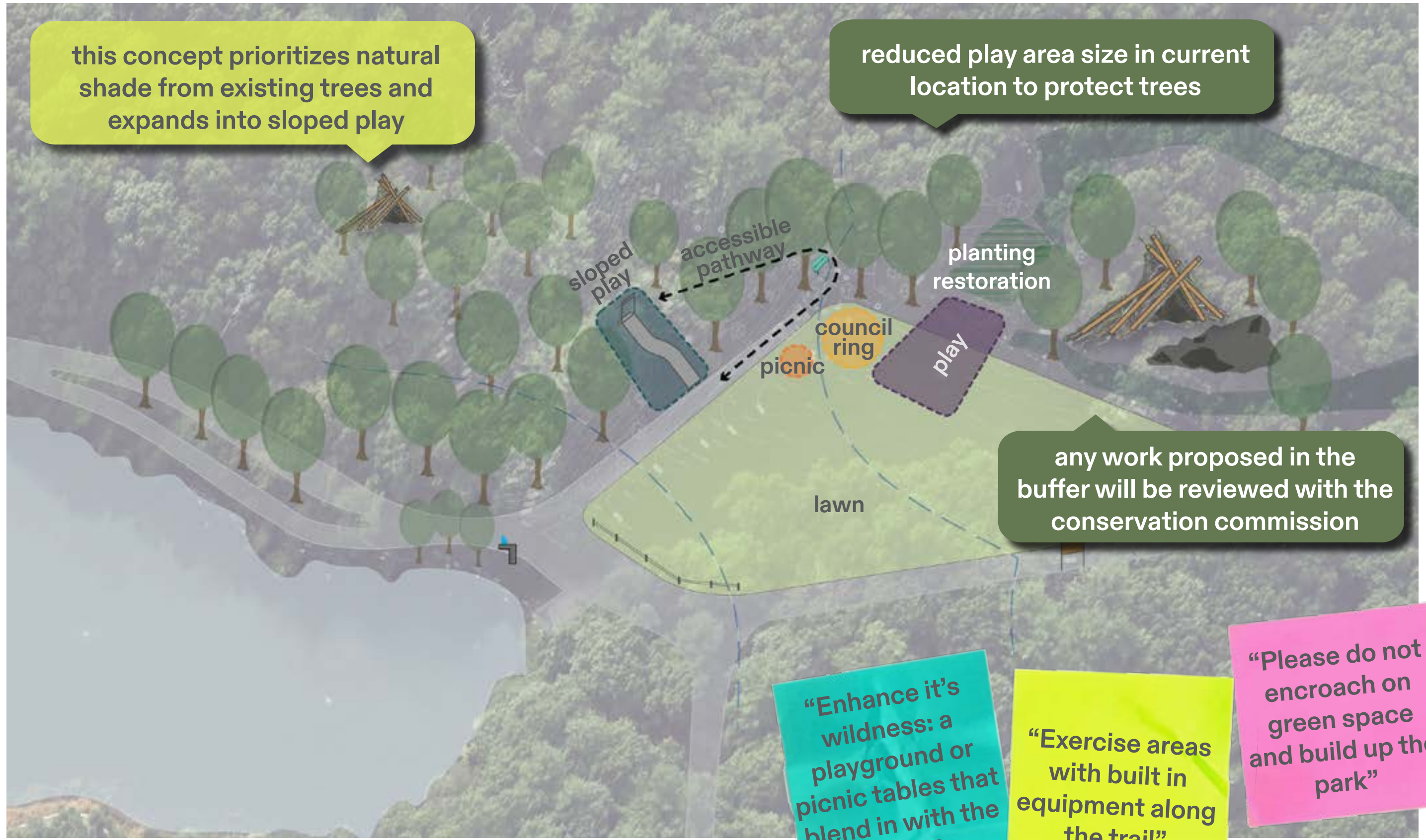

Menotomy Rocks Park Play Area

TOWN OF ARLINGTON | 6 DECEMBER 2023

Play Area Inspiration | Conceptual Layout Hybrid

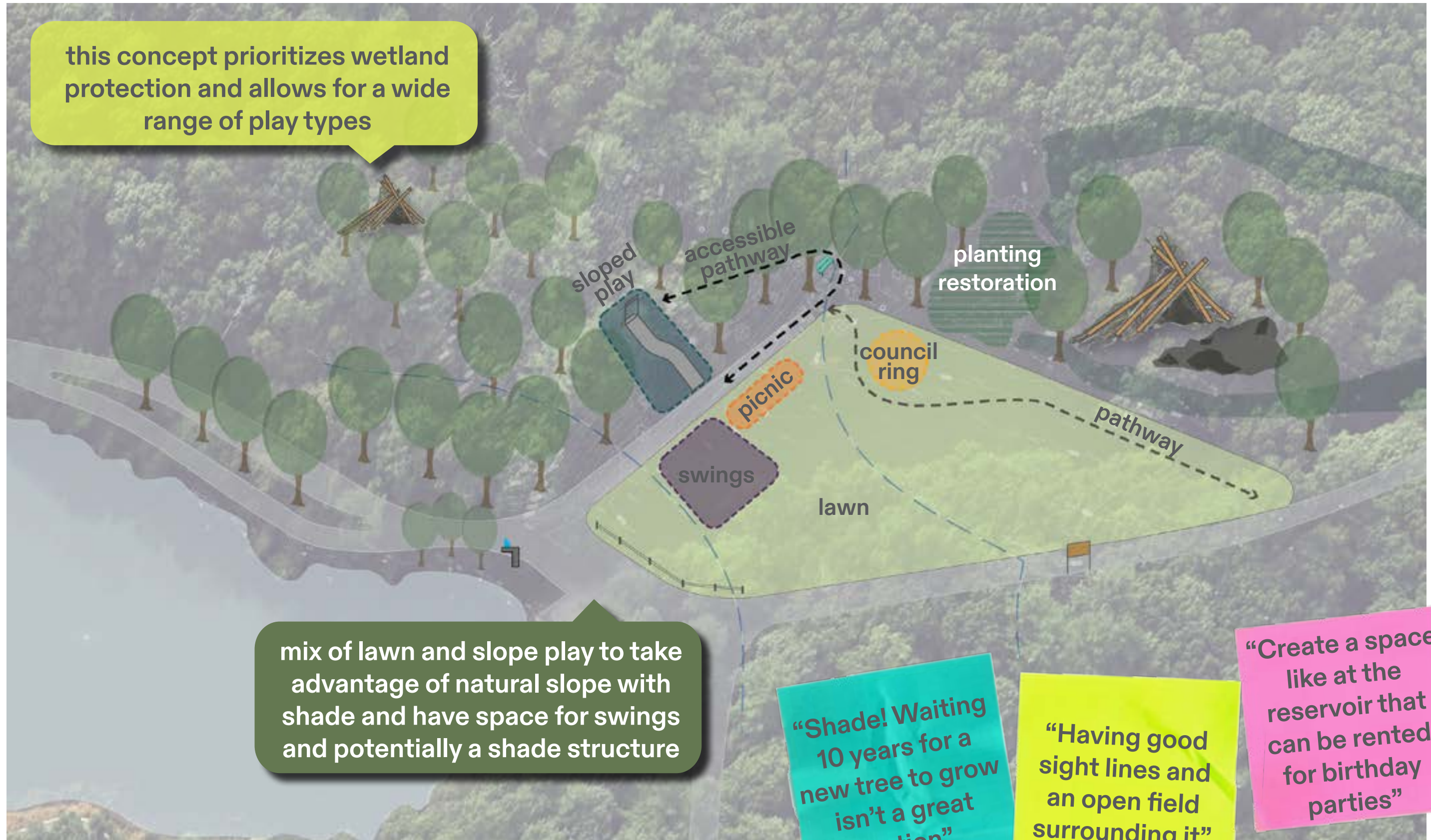

Menotomy Rocks Park Play Area

TOWN OF ARLINGTON | 6 DECEMBER 2023

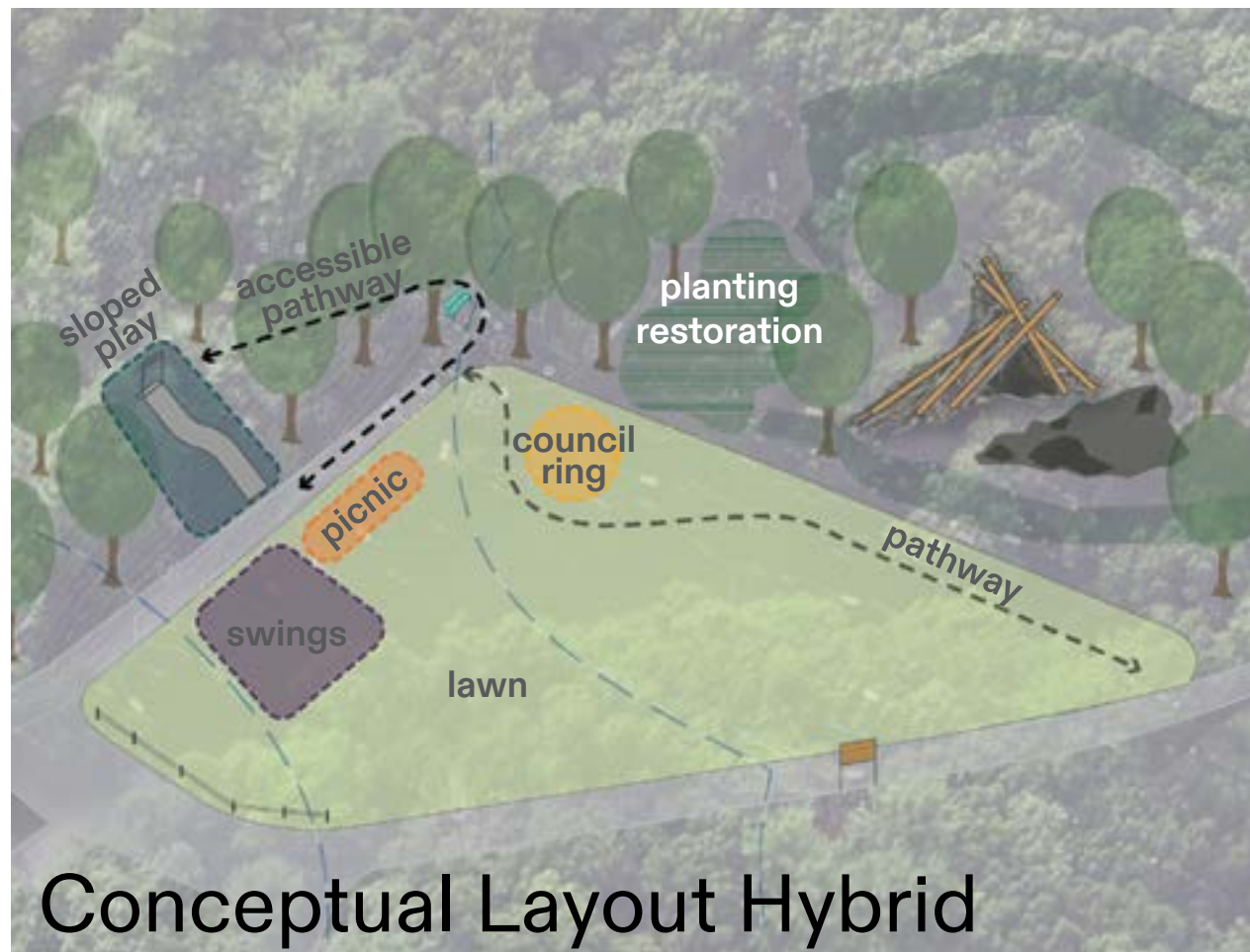
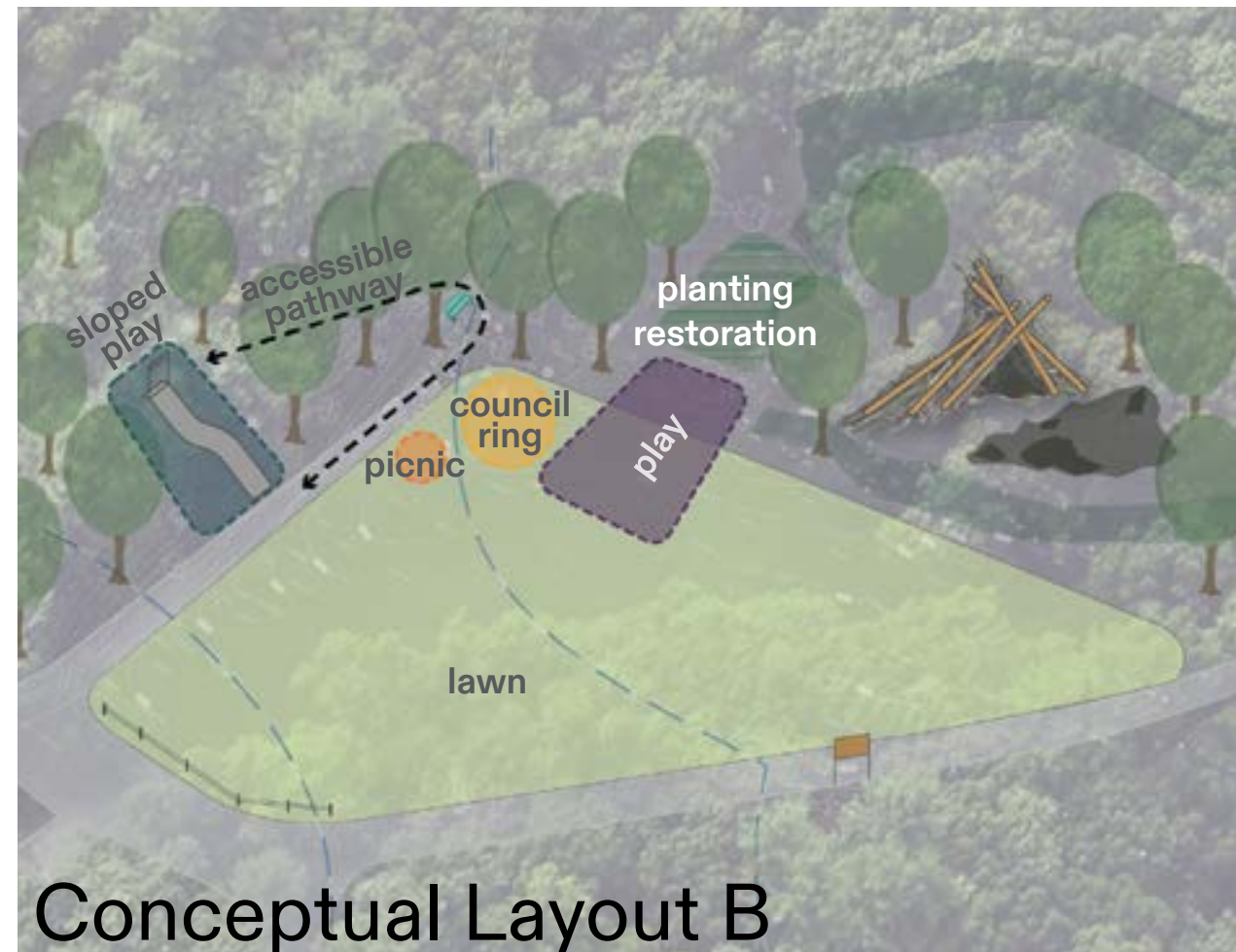
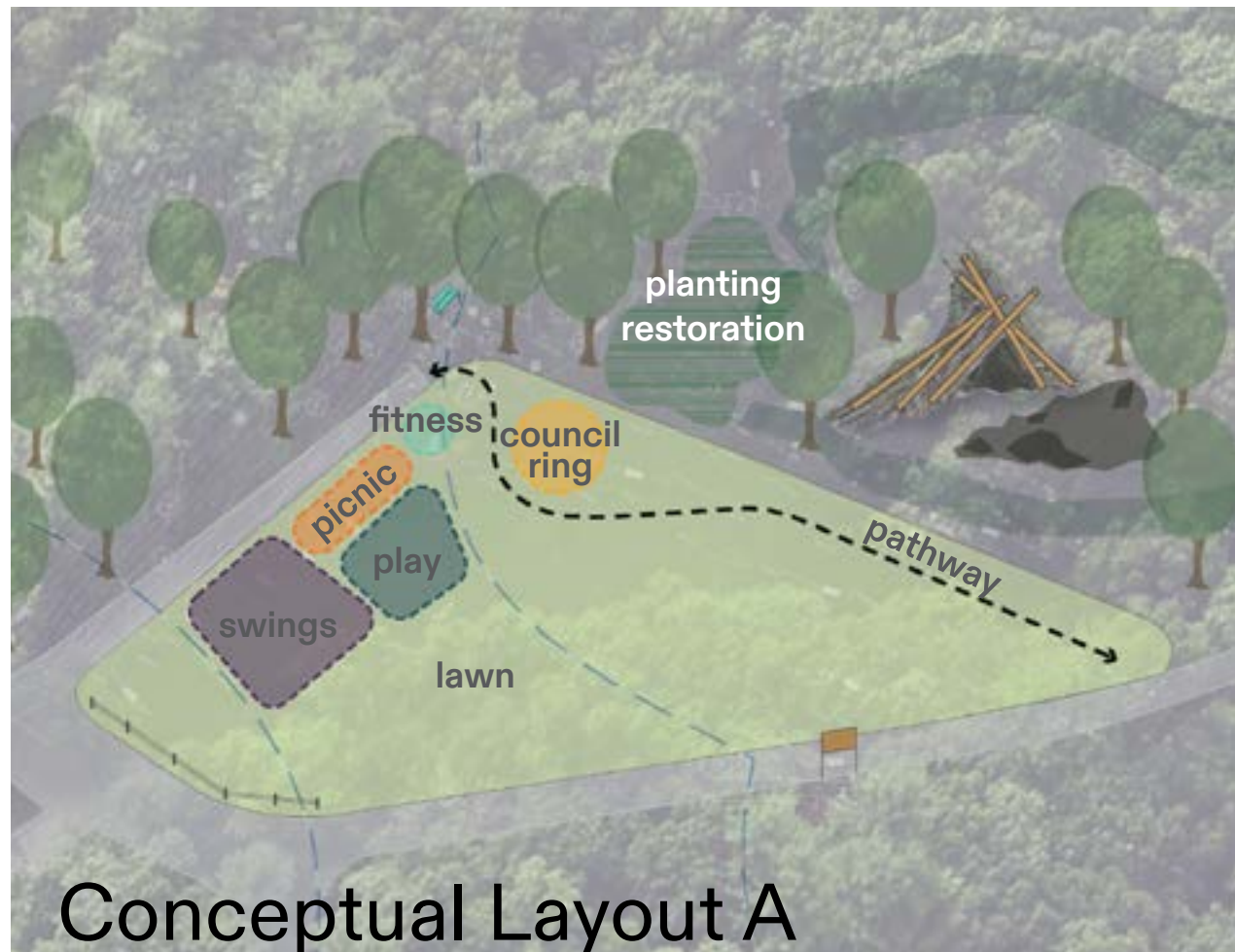

Schedule + Next Steps

